

## ZERO DOOR RESTRAINTS

These products are used on schools and public buildings, and are fitted externally on outward opening escape doors. They are set in position slightly offset from where the escape door will be when opened to 90 degrees, and can prevent the escape door from being pushed round further than this and damaging its hinges. When fitted with the Z440 door buffer or Z1402/582 birds beak holder (shown on page 214) they can be used to hold the door open at 90 degrees. These door restraints serve another purpose in that they prevent building escape doors being obstructed by bicycles and rubbish bins etc. Since they are fitted externally they are all manufactured from zinc plated mild steel, but all patterns are now available in stainless steel. Goal posts and hoops are available with mesh infill panels. References with "P" have pins at base, and with "F" have flange at base. Please note products supplied in zinc finish should be painted by the customer before supplying to site. Zinc finish is not a satisfactory final site finish as welds and joints will remain visible and may be considered unsightly. These products are not drilled as standard for buffers to allow on-site fixing in desired position.

### SINGLE POST DOOR RESTRAINERS

Single post door holder fabricated from mild steel square section, coated black as standard but can be supplied powder coated to match RAL numbers. Manufactured from 40mm square section mild steel welded and finished with cap at top, then zinc plated. Overall height 600mm with 8mm diameter pins at base for letting into concrete.

Material: Mild steel zinc plated standard or stainless steel to order.  
 Height: 600mm overall including 150mm for building in.  
 Finish: Standard finish Black (/BLK), and Zinc (/ZNC) or Stainless Steel (/SS).  
 Can be supplied powder coated to RAL numbers.

REF	DESCRIPTION
Z112P.1	With Z440 black door buffer/holder
Z112P.2	With Z1402/582 black birds beak holder
Z112P.3	Without buffer or beak holder
Z112P.4	With 35mm diameter black rubber stop only



Z112P.3 illustrated

Single post door holder fabricated from mild steel square section, coated black as standard but can be supplied powder coated to match RAL numbers. Manufactured from 40mm square section mild steel welded and finished with cap at top, then zinc plated. Overall height 450mm with 100x100x5mm flange plate at base drilled with four 10mm holes for flange surface fixing to concrete.

Material: Mild steel zinc plated standard or stainless steel to order.  
 Height: 450mm overall.  
 Finish: Standard finish Black (/BLK), and Zinc (/ZNC) or Stainless Steel (/SS).  
 Can be supplied powder coated to RAL numbers.

REF	DESCRIPTION
Z119F.1	With Z440 black door buffer/holder
Z119F.2	With Z1402/582 black birds beak holder
Z119F.3	Without buffer or beak holder
Z119F.4	With 35mm diameter black rubber stop only

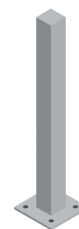

Z119F.3 illustrated

**Other widths and heights available on request.**

### GOAL POST DOOR RESTRAINERS

Goal post door holder fabricated from mild steel square section, coated black as standard but can be supplied powder coated to match RAL numbers. Manufactured from 40mm square section mild steel welded and finished, then zinc plated. Overall width 600mm, overall height 1150mm with 8mm diameter pins at base for letting into concrete.

Material: Mild steel zinc plated standard or stainless steel to order.  
 Width: 600mm overall.  
 Height: 1150mm overall including 300mm for building in.  
 Finish: Standard finish Black (/BLK), and Zinc (/ZNC) or Stainless Steel (/SS).  
 Can be supplied powder coated to RAL numbers.

REF	DESCRIPTION
Z111P.1	With Z440 black door buffer/holder
Z111P.2	With Z1402/582 black birds beak holder
Z111P.3	Without buffer or beak holder



Z111P.3 illustrated

Goal post door holder fabricated from mild steel square section, coated black as standard but can be supplied powder coated to match RAL numbers. Manufactured from 40mm square section mild steel welded and finished, then zinc plated. Overall width 600mm, overall height 850mm with 100x100x5mm flange plates at base drilled with four 10mm holes for flange surface fixing to concrete.

Material: Mild steel zinc plated standard or stainless steel to order.  
 Width: 600mm overall.  
 Height: 850mm overall.  
 Finish: Standard finish Black (/BLK), and Zinc (/ZNC) or Stainless Steel (/SS).  
 Can be supplied powder coated to RAL numbers.

REF	DESCRIPTION
Z111F.1	With Z440 black door buffer/holder
Z111F.2	With Z1402/582 black birds beak holder
Z111F.3	Without buffer or beak holder



Z111F.3 illustrated

**Other widths and heights available on request.**