

Z3780 UNIVERSAL CO-ORDINATORS

The Z3780 Universal Co-ordinator is for pairs of doors measuring up to 2438mm wide. The long arm holds the active leaf open until the short arm is depressed by the inactive leaf. When the doors are closed, the arms are hidden by the stop-mounted aluminium case. **ALTHOUGH THIS PRODUCT IS UL LISTED IN THE USA, IT IS NOT CE MARKED, DOES NOT HAVE A DoP AND SHOULD NOT BE USED ON FIRE RATED DOORS.**

The Z3760 carry bar is an optional extra available for pairs of doors where the inactive leaf can be opened before the active leaf. It is mounted on the inactive leaf and is supplied in USP matt black finish as standard. The Z3780 is a one size model and suits all pairs of doors up to 2438mm wide. This new design has adjustable arm to accommodate active door only 610mm wide; simply remove the two screws from the active arm, adjust the arm to its shortest length and re-insert the screws.

- One size for all pairs of doors up to 2438mm wide with adjustable arm to accommodate 610mm active door.
- Manufactured from steel and aluminium.
- Non-handed.
- Stop mounted.
- Overall size 38mm wide x 512mm long x 15mm deep.
- Matt black finish, code USP.
- Meets ANSI A156.3, Type 21 requirements (when used with carry bar).
- Mounting brackets not required when using stop mounted hardware.
- UL Listed for use with pairs of swinging fire doors with astragal (USA only).
- Mounted to frame with six screws.
- Supplied complete with both wood screws and machine screws for timber or steel fixing.
- Not for use with exposed vertical rod panic devices.



Z3780 Universal co-ordinator, USP matt black finish.
(Box Qty 1, outer 10)

Z3760 Optional carry bar, USP matt black finish.
(Box Qty 1, outer 10)

Z303 WEDGE TYPE DOOR SELECTORS

The Z303 gravity door selector/co-ordinator will enable a pair of self-closing non-fire rated timber doors with rebated meeting stiles to close in the correct sequence irrespective of which door closes first. This door selector has been successfully tested to BS EN 1158:1997. Product classification 351010. **THIS PRODUCT IS NOT CE MARKED, DOES NOT HAVE A DoP AND SHOULD NOT BE USED ON FIRE RATED DOORS.** It is designed to be used on non-fire rated timber doors.

The standard finishes are silver anodised aluminium (SAA) and simulated plated satin stainless steel (SSS). Also available brass effect, black anodised aluminium, gold anodised aluminium and polished chrome effect to special order. Colour coated paint finishes to standard RAL colours are available to order.

- Mounted on the face of the head frame immediately above the centre of the opening.
- Supplied with tubular selector catch, lift arm, impact plates, screws and full fixing instructions.
- Fully tested to 1 million cycles.
- Supplied with standard 102mm adjuster arm. 152mm and 203mm arms also available for thicker or wider doors.
- Suitable for up to 25mm timber fully rebated doors. Suitable for timber doors of any width up to 1000mm, max weight 100kg.

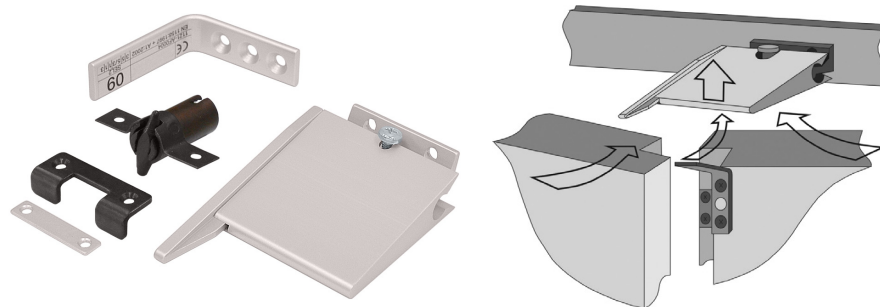

| REF | DESCRIPTION | BOX QTY |
|--------|--|---------|
| Z303 | Wedge type selector with tubular rebate catch to suit timber doors | 1 |
| Z304.6 | Adjuster arm only, 152mm long | 1 |
| Z304.8 | Adjuster arm only, 203mm long | 1 |

SAA = SATIN ANODISED ALUMINIUM

SSS = SIMULATED PLATED SATIN STAINLESS STEEL