

MAB FLOOR SPRINGS

MAB 7100 SERIES - BUDGET COMPACT - WITH LOW OPENING FORCE

Force: One body size in three power sizes EN 1-2-3 (10,16 & 20Nm).
 Max door weight: 100kg. Door size: From 750x2100mm (Force 1) to 950x2300mm (Force 3).
 Certification: Not CE marked. No DoP. Not to be used on fire doors.
 Hydraulic control: Closing from 135° in both swings. Two independent speed valves.
 Hold-open: Standard with 90° hold-open (5); also available 105° (0).
 Cement box: Included. 105mm wide x 222mm long x 55mm deep.
 Cover plate size: 122x240mm SSS included (PSS & PB to order). Ref AC530.
 Spindle: Supplied with Italian square spindle already fitted, cannot be changed.

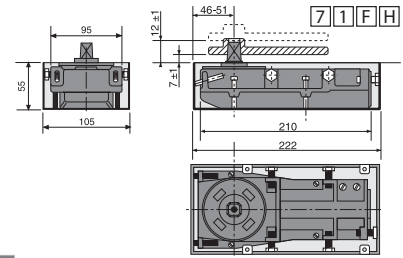

MAB 7100 SERIES		BOX QTY
7115*	Floor spring power size EN 1 with cement box, SSS cover, H/O 90°	1
7125	Floor spring power size EN 2 with cement box, SSS cover, H/O 90°	1
7135	Floor spring power size EN 3 with cement box, SSS cover, H/O 90°	1

MAB 7700 SERIES - TOTAL ADJUSTMENT - ADJUSTABLE WITH MECHANICAL BACKCHECK

Force: Adjustable power EN 2-4 (14Nm-28Nm). With mechanical backcheck.
 Max door weight: 170kg. Door size: From 600x2000mm (Force 2) to 1100x2400mm (Force 4).
 Certification: Model 7702 without hold-open has CE conformity. DoP on our website.
 Hydraulic control: Closing from 150° in both swings. Two independent speed valves.
 Hold-open: Standard with 90° hold-open (5); also available 105° (0) or without hold-open (2).
 Cement box: Included. 110mm wide x 277mm long x 70mm deep.
 Cement box adjustment: 4° angular, 10mm longitudinal, 9mm vertical.
 Cover plate size: 129x294mm SSS included (PSS & PB to order). Ref AC534.
 Spindle: Not included; specify square Italian, square French or rectangular German on page 131.

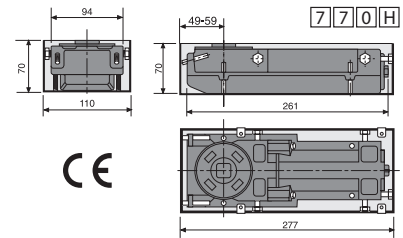

MAB 7700 SERIES (replaced 7410 series)		BOX QTY
7705	Adjustable power EN 2-4 floor spring with cement box, SSS cover, H/O 90°	1
7702	Adjustable power EN 2-4 floor spring with cement box, SSS cover, no H/O	1

MAB 4200 SERIES - NARROW & SHALLOW - FOR THIN SLABS

Force: One body size in three force sizes EN 2-3-4 (17,22 & 28Nm). 10Nm model to order.
 Max door weight: 100kg. Door size: From 850x2200mm (Force 2) to 1100x2400mm (Force 4).
 Certification: All models have EN 1154, version force EN 3-4 without hold-open have CE conformity. DoP on our website.
 Hydraulic control: Closing from 175° in both swings. Two independent speed valves.
 Hold-open: Standard with 90° hold-open (5); also available 105° (0) or without hold-open (2).
 Cement box: Included. 82mm wide x 306mm long x 47mm deep.
 Cement box adjustment: 10mm lateral, 10mm longitudinal, 5mm vertical.
 Cover plate size: 108x322mm SSS included (PSS & PB to order). Ref AC307.
 Spindle: Not included; specify square Italian, square French or rectangular German on page 131.

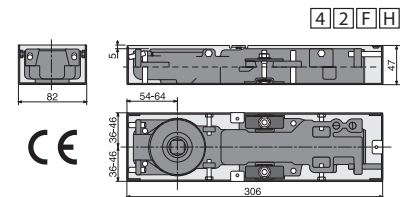

MAB 4200 SERIES		BOX QTY
4225*	Floor spring power size EN 2 with cement box, SSS cover, H/O 90°	1
4235	Floor spring power size EN 3 with cement box, SSS cover, H/O 90°	1
4245	Floor spring power size EN 4 with cement box, SSS cover, H/O 90°	1
4232	Floor spring power size EN 3 with cement box, SSS cover, no H/O	1
4242	Floor spring power size EN 4 with cement box, SSS cover, no H/O	1

MAB 750 SERIES - THE STRONGEST - ADJUSTABLE POWER FOR LARGE HEAVY DOORS

Force: Adjustable power EN 3-6 (24Nm-60Nm). With mechanical backcheck.
 Max door weight: 300kg. Door size: From 850x2200mm (Force 3) to 1400x2500mm (Force 6).
 Certification: All models have EN 1154, version without hold-open has CE conformity. DoP on our website.
 Hydraulic control: Closing from approx 175° in both swings. Two independent speed valves.
 Hold-open: Standard with 90° hold-open (5); also available 105° (0) or without hold-open (2).
 Delayed closing: Optional extra between 175° and 80°.
 Cement box: Included. 78mm wide x 345mm long x 82mm deep.
 Cement box adjustment: 6mm lateral, 5mm longitudinal, 9mm vertical.
 Cover plate size: 103x365mm SSS included (PSS & PB to order). Ref AC269.
 Spindle: Not included; specify square Italian, square French or rectangular German on page 131.

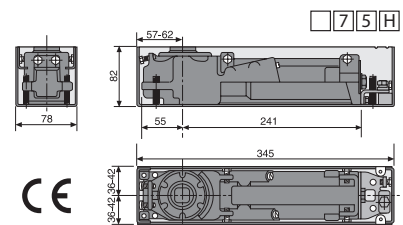

MAB 750 SERIES		BOX QTY
755	Heavy duty adj. power EN 3-6 floor spring with cement box, SSS cover, H/O 90°	1
752	Heavy duty adj. power EN 3-6 floor spring with cement box, SSS cover, no H/O	1

PLEASE SEE PAGES 158-159 FOR GLASS DOOR LOCKSETS AND PATCH FITTINGS