



2000IR

PROFESSIONAL STEAM IRON

PARTS & WIRING INFO

2000IR
INSTRUCTION MANUAL
ENGLISH

RELIABLE. RIGHT THERE WITH YOU.

At Reliable, we do what we love, and take pride in doing it right. You want what's best for the people, places and things that matter in your life - from where you live to what you wear. So do we. From the start, we approach every product with a craftsman's attention to detail and passion for making it right. Quality, functionality, design and customer service play an equally important part in delivering what's right for you. The 2000IR steam iron is no exception. Featuring a die-cast aluminum plate with 32 separate steam chambers, the 2000IR will endure the rigors of commercial use.

Mod. **2000IR**

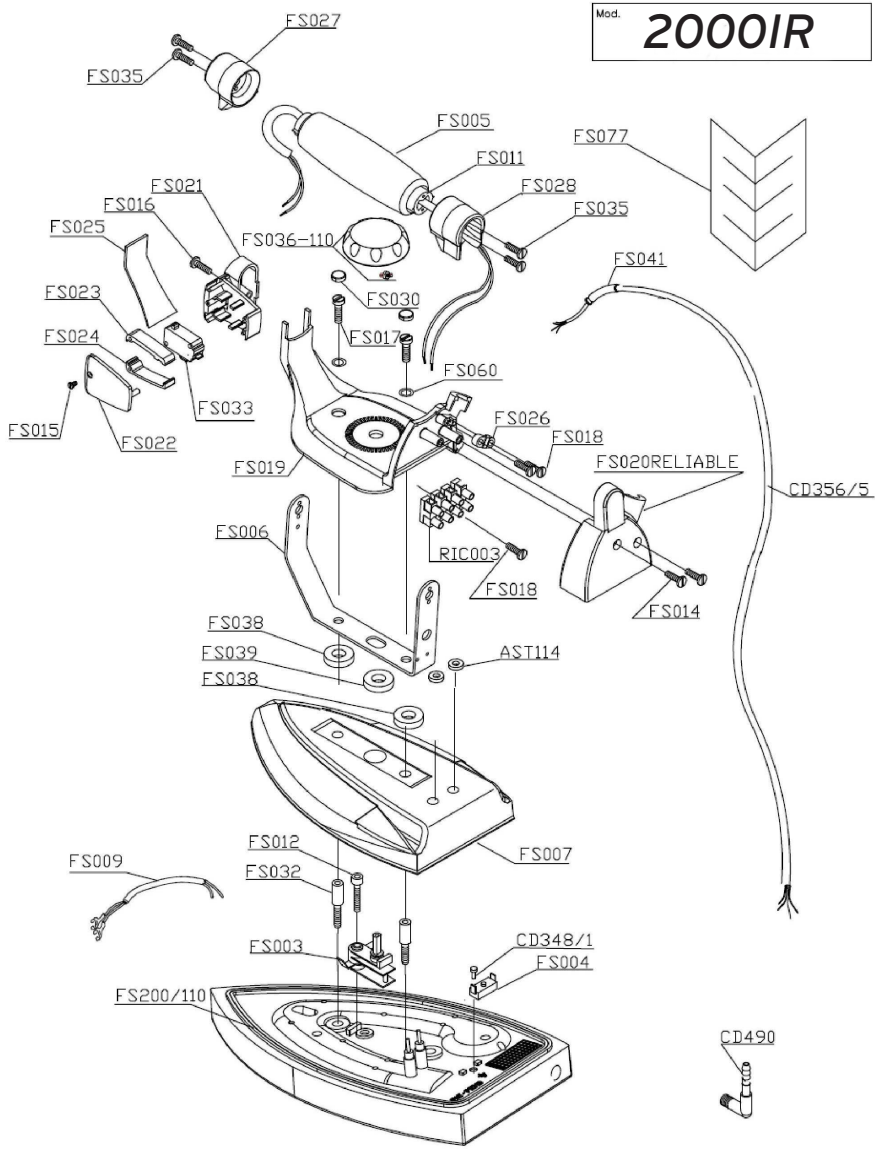

Part Number	Description		Q.ty
FS200/120	IRON PLATE 120V 800W	NR	1
CV217	HEATING ELEMENT FOR IRON PLATE NEW 800 W 120 V	NR	1
FS003	ADJUSTABLE CAMPINI THERMOSTAT 23/A TEMP. 215°C +-15°C	NR	1
FS004	MANUAL REARM THERMOSTAT FOR IRON NEW 285°C	NR	1
FS210	STEAM IRON HANDLE	NR	1
FS035	HANDLE SCREW 3.5X20	NR	3
FS027	FRONT HANDLE HOLDER	NR	1
FS011	HANDLE INSERT FOR IRON NEW L. 121 MM.	NR	1
CV169	DRAWN FOR HANDLE	MT	0,13
FS028	BACK HANDLE HOLDER	NR	1
FS005	CORK HANDLE	NR	1
FS021	STEAM BUTTON HOLDER	NR	1
FS016	SCREW TORX	NR	1
FS025	BRACKET COVER PLAQUE	NR	1
FS023	UPFOR STEAM BUTTON FOR IRON	NR	1
FS024	LOWER STEAM BUTTON FOR IRON	NR	1
FS033	MICRON	NR	1
FS022	STEAM BUTTON HOLDER COVER	NR	1
FS015	SCREW 2.2X13 T.SV	NR	2
FS019	HANDLE COVER FOR IRON NEW IN NYLON	NR	1
FS017	SCREW TBCEI 10.9 5X10 ES.3	NR	2
FS060	WASHER. Ø 5 ZNB FOR SCREW FS017	NR	2
FS038	UNDER HANDLE WASHER FOR SCREW	NR	2
FS006	BRACKET FOR IRON	NR	1
FS007	CHROMED COVER FOR IRON	NR	1
FS009	IRON WIRING NEW KK*007	NR	1
FS012	SCREW M4*25	NR	1
FS014	HANDLE SCREW 3.5X16	NR	3
FS018	TERMINAL BLOCK SCREW 2,9X13 ZNB	NR	3
CD348/1	SCREW FOR BULB THERMOSTAT TC 7.7+01 4x6 7985	NR	1
FS041	FAIRLEAD FOR CABLE	NR	1
RIC003	4 POLES TERMINAL BLOCK FV27/4 FV27XA1F04	NR	1
AST114	FAIRLEAD FOR HEATING ELEMENT	NR	2
CD490	ANGLE CONNECTION	NR	1
FS032	MALE BRASS SPACER	NR	2
FS020RELIABLE	SCREEN PRINTED BACK HANDLE	NR	1
FS026	NYLON CABLEBLOCK FOR IRON	NR	1
FS030	SCREW CAP	NR	2
CV114	BOX 24,4x16x13,6 FOR STEAM IRON	NR	1
FS039	UNDER HANDLE WASHER FOR KNOB	NR	1
GV025/23	NUT 3/8 FOR WATER LEVEL INDICATOR JOINT	NR	1
FS037	HANDLE SCREW	NR	1
CD458/1	DATA LABEL	NR	1
CV177-110	SILK SCREEN PRINTED KNOB 120v	NR	1
CD356/5	ELECTRICAL CABLE MT. 2.4 + FAIRLEAD	NR	1
CD458	DATA LABEL	NR	1
FS035	HANDLE SCREW 3.5X20	NR	1
CD458/2	DATA LABEL	NR	1

PLEASE NOTE: Field replacement with this model (2000IR) is intended to be carried out by the manufacturer, or the manufacturer's service agent and is intended to be interconnected to Reliable Corporation steam producing equipment only.

FEATURES

- Lightweight - 3.9 lb
- 32 separate steam chambers
- Right or left handed use
- Stay cool cork handle
- Thermal fuse





Reliable Corporation ("Reliable") warrants to original purchaser of its products that every product sold by Reliable (a "Reliable Product") is free from defects in material and workmanship for a period of one year from the date of purchase if properly used and maintained. Subject to the conditions and limitations set forth below, Reliable will either repair or replace any part of a Reliable Product that proves defective by reason of improper workmanship or materials. If the defective Reliable Product is no longer available and cannot be repaired effectively or replaced with an identical model, Reliable shall replace the defective Reliable Product with a current Reliable Product of equal or greater value. Repaired parts or replacement products will be provided by Reliable on an exchange basis, and will be either new or refurbished to be functionally equivalent to new. If Reliable is unable to repair or replace a Reliable Product, it will refund the current value of that Reliable Product at the time the warranty claim is made.

This limited warranty does not cover any damage to a Reliable Product that results from improper installation, accident, abuse, misuse, natural disaster, insufficient or excessive electrical supply, abnormal mechanical or environmental conditions, wear and tear resulting from normal use of the product, or any unauthorized disassembly, repair, or modification. This limited warranty does not extend to any indirect, consequential or incidental damages that may be suffered by a user or from the use of a Reliable Product, including without limitation, any liability for third party claims for damage, and is limited to the amount paid by the original purchaser Reliable Product with respect to which this limited warranty protection applies. This limited warranty does not apply with respect to products that have been altered or which are missing serial numbers or for products not purchased directly from Reliable or a dealer authorized by us to sell Reliable Products.

This limited warranty is the only warranty that applies to any Reliable Product, supersedes any and all terms that may be contained in any other document or purchase order and may not be altered or amended except expressly in writing by Reliable.

To obtain a repair or replacement under the terms of this warranty, please contact our customer service group at 1-800-268-1649 or at support@reliablecorporation.com. You will be required to submit an original receipt via fax or e-mail. The receipt must reflect that you are the original purchaser, the product was bought directly from us or from an authorized Reliable dealer and that the warranty claim is being made within the warranty period. You will be issued a return authorization number (RA#) and asked to ship the defective product together with proof of purchase and RA#, prepaid insured to the following address:

Reliable Corporation, 5-100 Wingold Avenue, Toronto, ON M6B 4K7. Freight collect shipments will be refused. The risk of loss or damage in transit will be borne by the customer. Once Reliable receives the defective product, it will initiate the repair or replacement process.

If you have any questions regarding this warranty, you may write to:

Reliable Corporation
100 Wingold Avenue, Unit 5
Toronto, Ontario
Canada M6B 4K7
www.reliablecorporation.com



RELIABLE

1 800 268 1649
www.reliablecorporation.com