

ANGELWING DESIGNS

DUNE FREAK Chuck Glider

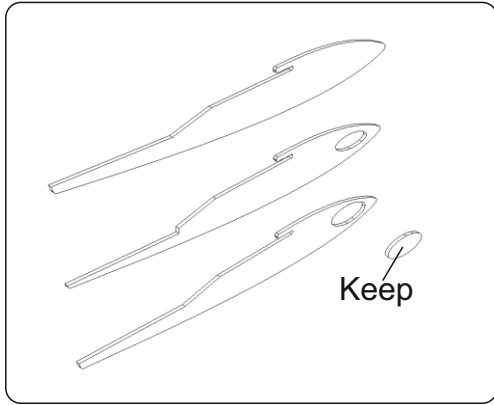

Keep

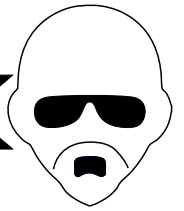
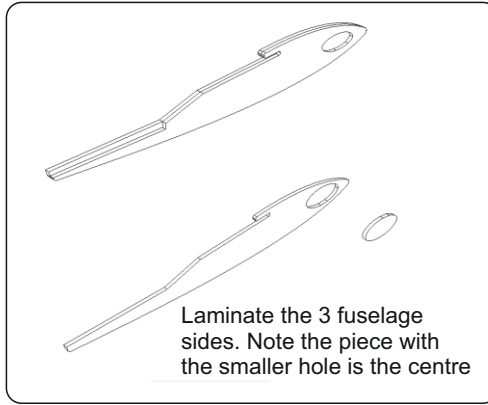

Laminate the 3 fuselage sides. Note the piece with the smaller hole is the centre

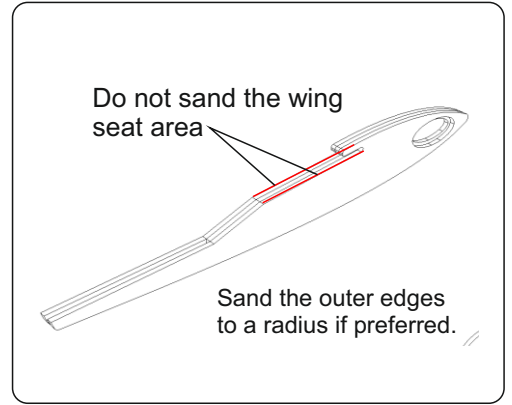

Do not sand the wing seat area

Sand the outer edges to a radius if preferred.

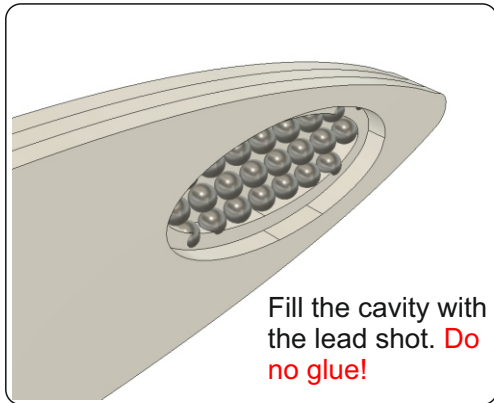

Fill the cavity with the lead shot. **Do no glue!**

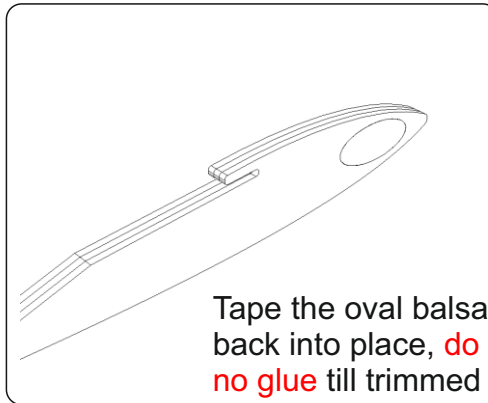

Tape the oval balsa back into place, **do no glue** till trimmed

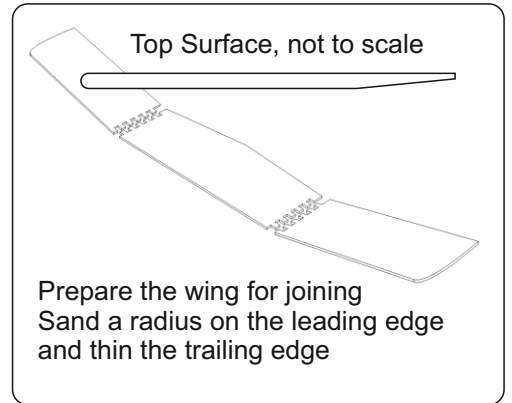

Top Surface, not to scale

Prepare the wing for joining Sand a radius on the leading edge and thin the trailing edge

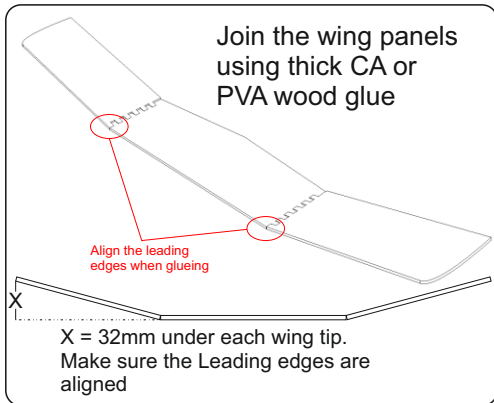

Join the wing panels using thick CA or PVA wood glue

Align the leading edges when glueing

X = 32mm under each wing tip. Make sure the Leading edges are aligned

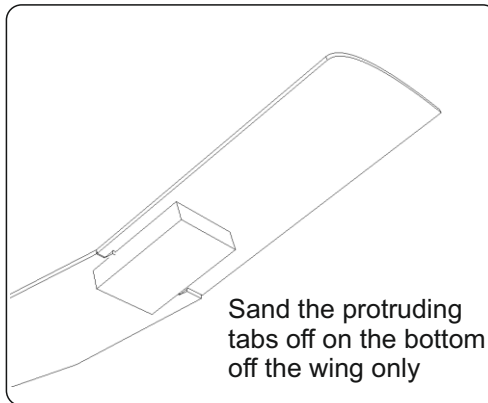

Sand the protruding tabs off on the bottom off the wing only

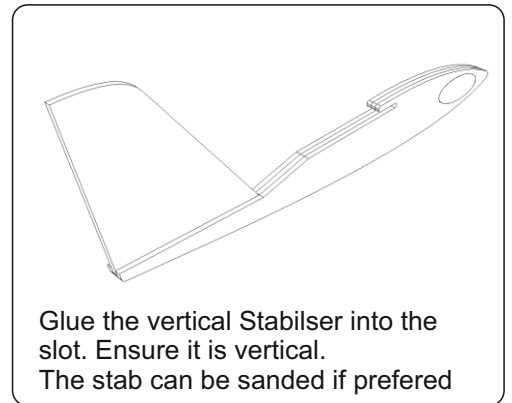

Glue the vertical Stabiliser into the slot. Ensure it is vertical. The stab can be sanded if preferred

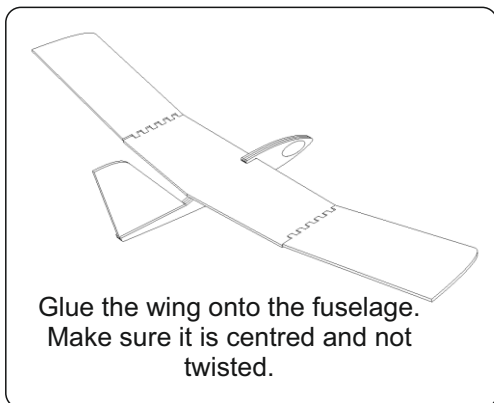

Glue the wing onto the fuselage. Make sure it is centred and not twisted.

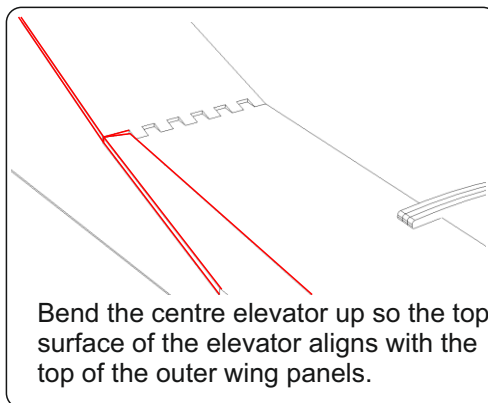

Bend the centre elevator up so the top surface of the elevator aligns with the top of the outer wing panels.

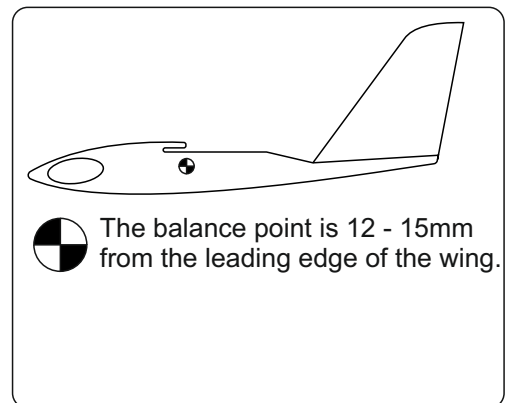

 The balance point is 12 - 15mm from the leading edge of the wing.

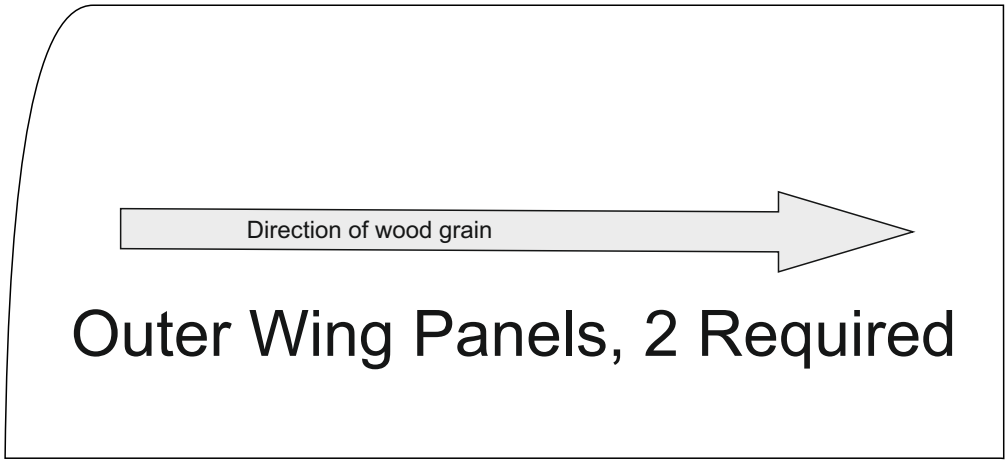
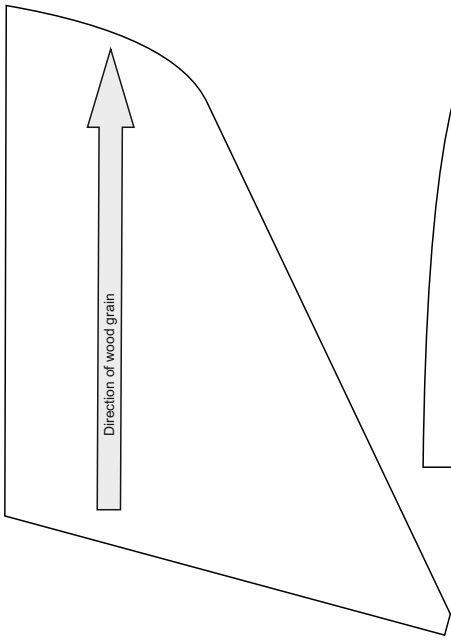

All 2mm Light Balsa

