

# TECHNICAL SPECIFICATIONS

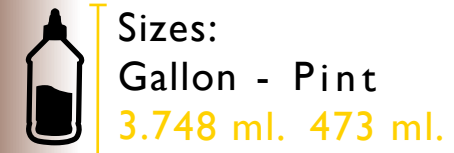

## CHERRY GLOSS PREMIUM WAX

REFERENCE No.: 143-0010



### DESCRIPTION

**Symplex® Cherry Gloss Premium Wax.** formulated with Pure Premium Grade TI Carnauba Wax and Resin, ensuring an unparalleled level of protection and enhancement for your vehicle's finish. Designed for ease of application and removal, this wax leaves no white residue on black molding, making it clear coat safe. Specifically ideal for dark colors, it imparts a deep carnauba shine and a robust, long-lasting sealant that safeguards against UV rays, rain, dust, dirt, grime, bugs, and more.

### KEY FEATURES

- Easy On, Easy Off application.
- Wet look finish.
- Enhanced look and appearance.
- Provides the highest level of gloss, most notable on darker tones such as Black, Navy, Metallic, etc.
- Leaves a thick film on the paint for outstanding protection.
- Hydrophobic properties.

### PHYSICAL & CHEMICAL PROPERTIES

- Pink colored liquid cream.
- Container with metered plastic cap.
- Can be applied by hand or polishin machine.
- Product shell life: 1 year.

### APPLICATION TECHNIQUES

The Cherry Gloss Premium Wax, was designed to provides a super gloss shine with an easy application and removal

#### SHAKE WELL BEFORE USING

- If applied manually, use a small amount in a special applicator Symplex P / N 111-0029 - UN or a microfiber cloth and lightly rub in a circular motion.
- Let dry approx. for 2 minutes and remove with a clean cloth.
- For application with polishing machine , use a finishing foam pad.
- Place a small amount and buff at low speed.

### CONTAINERS

16 oz. 32 oz. bottles are made of high strength PET. Gallon - 128 oz Bottles. (MPG) are produced in high density polyethylene (HDPE). It also provides a metering plastic cap in order to facilitate the closure of the container; preventing contamination, drying of the product, permit reopening, accurate and simple dosing.

### HANDLING AND STORAGE

See the Safety Data Sheet (MSDS)

### PREVENTIVE INFORMATION

See product label and Material Safety Data Sheet for health and safety information before using this product.

### WARRANTY AND LIMITATION OF RESOURCES

Technical Information: The technical information, recommendations, and other statements contained in this document are based upon tests or experience that Symplex® considered reliable, but the accuracy of such information or exhaustive is not guaranteed.

Product Use: Many factors beyond the control of Symplex® and only the user's knowledge and control can affect the use and performance of a product in a particular application Symplex®. Given the variety of factors that can affect the use and performance of a product, the user is solely responsible for evaluating the Symplex® product and determine whether it is fit for a particular purpose and suitable for the method of application.

### HOW TO USE



Shake well before using

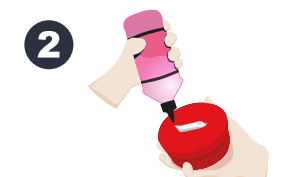

Apply using a Wax applicator



Let it dry at least for 2 minutes



Remove using a microfiber cloth