

## MACALLY SLIMKEYCACOMBO

### COMPACT USB WIRED KEYBOARD AND MOUSE COMBO FOR MAC AND PC

#### User's Guide

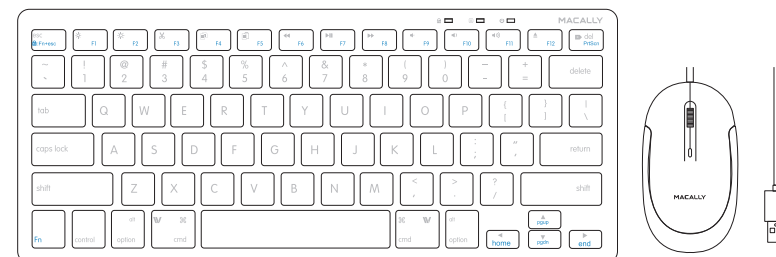

www.macally.com

#### Introduction

The Macally SLIMKEYCACOMBO has a compact USB wired keyboard SLIMKEYCA specially designed for both MAC and PC, and bundled with a USB wired optical mouse DYNAMOUSE. The keyboard is ultra slim and compact to save space on the desk and easily store inside a keyboard drawer. The additional shortcut keys further increase efficiency and productivity. DYNAMOUSE is a 3-button scroll-wheel mouse with 800/1200/1600 dpi optical sensor for precise and smooth control.

The Macally SLIMKEYCA and DYNAMOUSE are very easy to use. Simply plug them into the USB ports on your computer and you are ready to go! No software required!

Thin, compact, and versatile, the Macally SLIMKEYCACOMBO is the perfect companion for your MAC and PC!

#### Package Contents

- USB keyboard and optical mouse
- User's guide

#### Macally Product Information

##### Technical Support

Please E-mail us at techsupport@macally.com,  
In U.S.A. please call 1-909-230-6888  
Mon-Fri 8:30 AM - 5:30 PM, Pacific Standard Time

#### Macally Product Information

##### Warranty

Macally peripherals warrants that this product will be free from defects in title, materials and manufacturing workmanship for two year from the date of purchase. If the product is found to be defective then, as your sole remedy and as the manufacturer's only obligation, Macally will repair or replace the product. This warranty shall not apply to products that have been subject to abuse, misuse, abnormal electrical or environmental conditions, or any condition other than what can be considered as normal use.

##### Limitation of Liability

The liability of Macally Peripherals arising from this warranty and sale shall be limited to a refund of the purchase price. In no event shall Macally Peripherals be liable for costs of procurement of substitute products or services, or for any lost profit, or for any consequential, incidental, direct or indirect damages, however caused and on any theory of liability, arising from this warranty and sale. These limitations shall apply not with standing any failure of essential purpose of any limited remedy.

Copyright© 2020 by Macally Peripherals

#### System Requirement

- Mac OS X 10.3 to 10.15 and above
- Windows 7/8/10 and above
- Any desktop and notebook computer with USB ports available

#### Hardware Basics

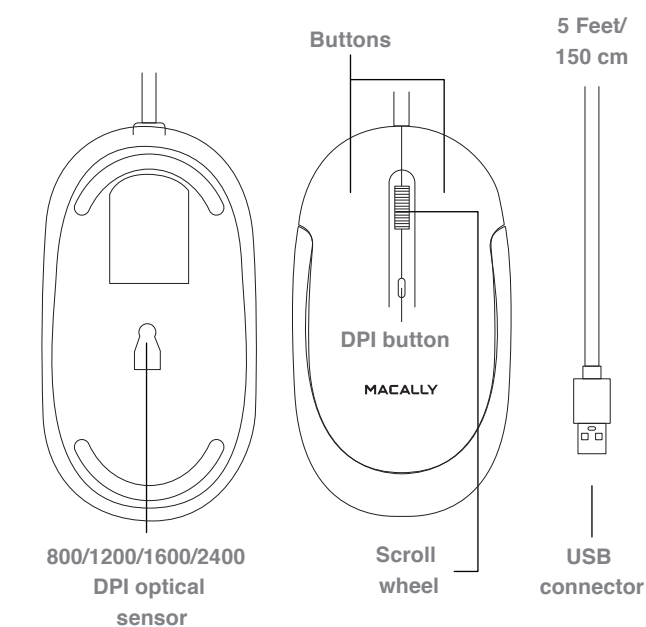

270.0 mm

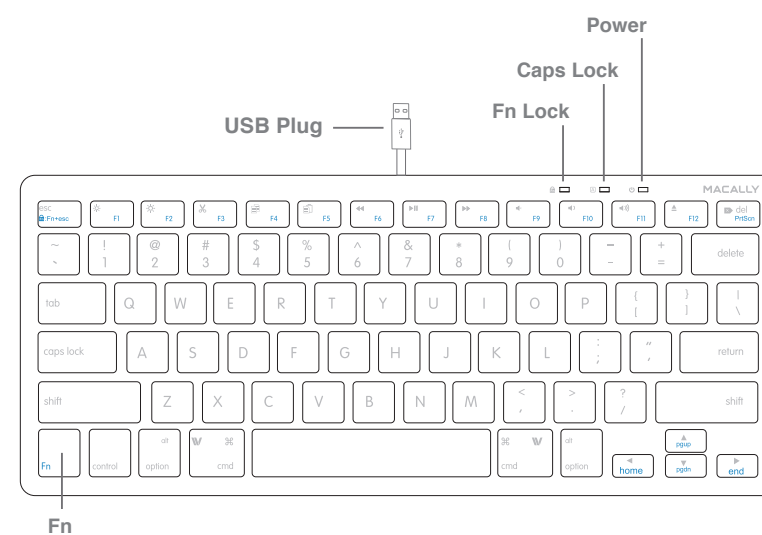

#### Fn LOCK MODE Function keys F1 to F12

Press "Fn" key with "esc" key simultaneously to switch to Fn Lock mode as default.

#### Shortcut Keys

**Shortcut mode** - Shortcut mode is the default mode. If Fn and esc keys are pressed together, Fn Lock LED is turned on, keyboard is in Fn Lock mode. You can press Fn and esc keys together again to toggle back to Shortcut mode.

- |  |                                 |
|--|---------------------------------|
| ☀️ Brightness change to Mac built-in display | 🔇 Mute                          |
| ✂️ Cut (Cmd-X)                               | 🔊 Volume Down                   |
| 📄 Copy (Cmd-C)                               | 🔊 Volume Up                     |
| 📄 Paste (Cmd-V)                              | ⏮️ Play/Pause (Spacebar)        |
| ⏮️ Previous Track (Cmd-Left Arrow)           | ⏭️ Next Track (Cmd-Right Arrow) |
| 🖨️ Screen capture for Windows PC             | 🗑️ Eject                        |

#### More about mode

1. Shortcut mode is restored to default mode after SLIMKEYCA loses power, e.g. when unplugged from a computer or a computer is shut down or restarted.
2. In either Shortcut mode or Fn Lock mode, one can also press "Fn" key with one of top row key simultaneously to perform the secondary function without switching mode.

#### Keyboard Shortcuts for MacOS X

Previous section has described default shortcuts and function keys. They are supported in MacOS X from 10.3 to 10.15 and above, no driver installation is needed. Please note, these shortcuts are not universal, certain shortcuts do not work as defined in some application. On the other hand, some shortcuts may act completely different way in different applications. You should try them out first.

#### Keyboard Setup Assistant

In Mac, the first time you plug in this new keyboard to use, desktop will pop out a "Keyboard Setup Assistant" window, Please follow the on-screen instruction to identify the keyboard before you can use the keyboard correctly.

After initial setup, if you experience any issue with keyboard or couldn't type correctly, please unplug and replug the keyboard, open keyboard icon in System Preferences, click on "Change Keyboard Type" to run Keyboard Setup Assistant to re-identify the keyboard.

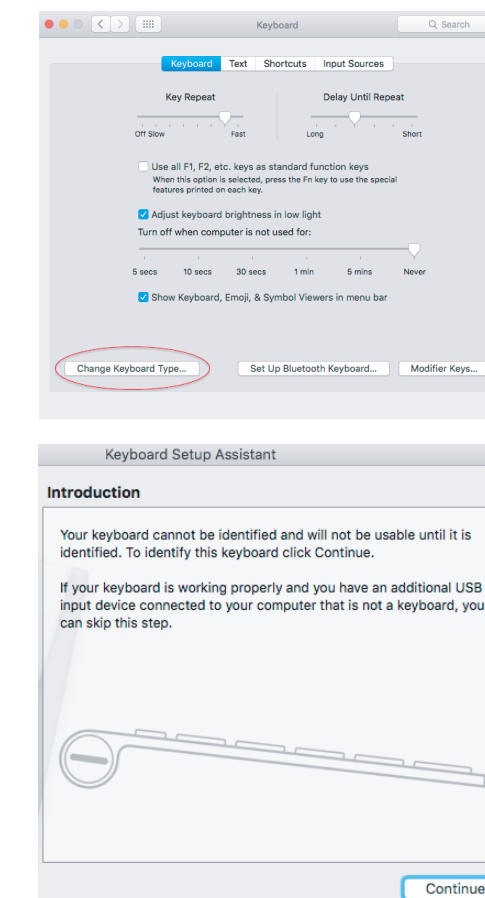

Front