

490.0 mm

80.0 mm

### Using The Phone Holder

- Place the cradle on top of the base. Secure the cradle by sliding it down until it is firmly in place.
- Try the phone holder on the dashboard to find a suitable spot to mount. Clean the desired area well with clean cloth and cleaning alcohol. Remove as much excess dust and dirt as possible from the dashboard.

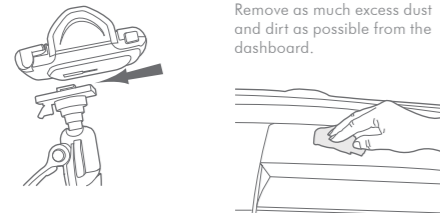

- Peel off the protective plastic film from the suction cup.

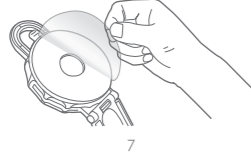

- Place the suction cup on the desired location. Press down firmly on the suction cup to have good adhesion.

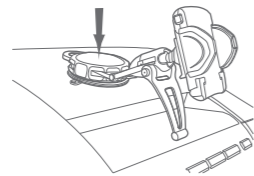

- While holding down the suction cup, rotate the top of the suction cup clockwise until it locks into place.

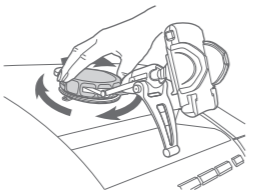

- You may rotate the top of the suction cup counterclockwise to release the lock then lift the tab to remove the adhesive base in case you want to change location for the suction cup.



- Adjust the cradle to the desired height. Press on the two side buttons of the arm simultaneously, meanwhile rotate the support arm until it sits on dashboard firmly. Then release both buttons to lock the support.

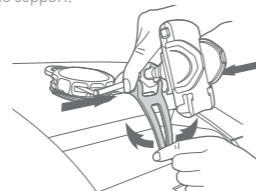

- Lower the bottom tabs of the cradle so your device can sit securely.

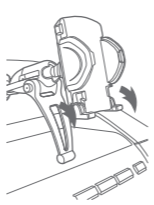

- Release grip hands by holding down both buttons on the top side of the cradle. Continue to hold until the hands reach their maximum width.

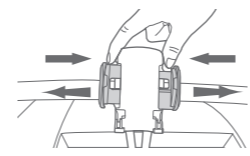

- Place your device like in the diagram so that it is resting on the bottom tabs that you lowered in step 8.

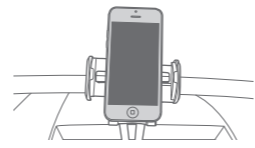

- Using your hands, gently squeeze in the grip hands from both sides until your device is securely held.

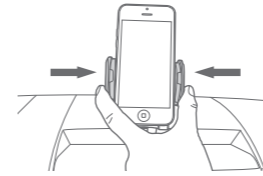

- Lift up the locking lever. You can now change the viewing angle of the cradle freely.

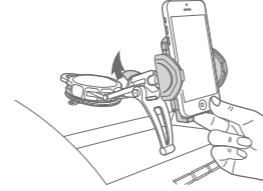

- Once you have found the desired viewing angle, push the locking lever down to lock the cradle into place.

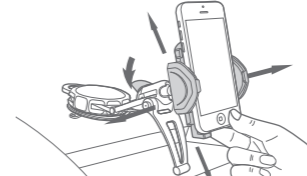

- You can now rotate your device with the cradle 360 degrees to find a desirable setup for your device. Enjoy!

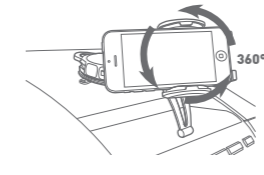

## MACALLY

### CAR DASHBOARD MOUNT PHONE HOLDER

#### User's Guide

for iPhone, iPod, Cell Phone, MP3, and GPS

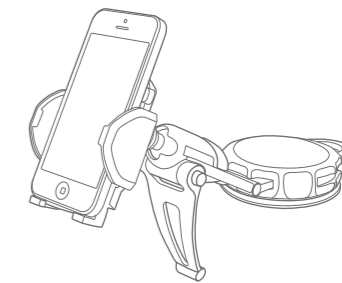

www.macally.com

Front

80.0 mm

### Introduction

Thank you for purchasing the Macally Fully Adjustable Car Dashboard Mount Phone Holder. This suction cup mount is made to hold iPhone, iPod, Cell Phones, MP3 and GPS. This supreme suction cup is designed to provide strong adhesion even on the toughest roads.

Before you begin using this product, be sure to read this user's guide in its entirety.

### Package Contents

- Car Dashboard Mount Phone Holder
- User's Guide

### Macally Product Information

#### Registration

Please register this product at [www.macally.com/register.html](http://www.macally.com/register.html).

#### Technical Support

Please E-mail us at [techsupport@macally.com](mailto:techsupport@macally.com), In U.S.A. please call 1-909-230-6778 Mon-Fri 8:30 AM - 5:30 PM, Pacific Standard Time

1

### Macally Product Information

#### Warranty

Macally peripherals warrants that this product will be free from defects in title, materials and manufacturing workmanship for one year from the date of purchase. If the product is found to be defective then, as your sole remedy and as the manufacturer's only obligation, Macally will repair or replace the product. This warranty shall not apply to products that have been subject to abuse, misuse, abnormal electrical or environmental conditions, or any condition other than what can be considered as normal use.

#### Limitation of Liability

The liability of Macally Peripherals arising from this warranty and sale shall be limited to a refund of the purchase price. In no event shall Macally Peripherals be liable for costs of procurement of substitute products or services, or for any lost profit, or for any consequential, incidental, direct or indirect damages, however caused and on any theory of liability, arising from this warranty and sale. These limitations shall apply not with standing any failure of essential purpose of any limited remedy.

Copyright© 2014 by Macally Peripherals

2

### Australia Warranty

This document details the terms and conditions of the warranty provided with this product. Please disregard any other representations contained on this product, its packaging or provided with this product, which constitute or appear to constitute a warranty.

This warranty is offered by Conexus Pty Ltd, Unit 1, 16 Aquatic Drive, Frenchs Forest NSW 2086 Australia, (02) 9975 0900, [support@conexus.com.au](mailto:support@conexus.com.au)

Subject to the exclusions and limitations set out below, we warrant to you that if you purchase a product directly from us, or from any of our authorised resellers, that it will not contain defects which are a result of faulty manufacturer workmanship or materials. This warranty subsists for 1 year from the date of purchase.

Subject to any rights you have under the Australian Consumer Law, we will not be liable for defects which are a result of damage or loss caused by factors beyond our control, any product which has not been maintained according to any care or maintenance instructions provided with the product, any alterations to a product which are not performed by us, or damage or defects caused to the product due to unusual or non-recommended use. We will not be liable for any special, indirect, consequential or economic loss or damage or loss of profits whatsoever suffered

3

by you or any other person resulting from any act or omission by us. Our total liability in respect of this Warranty against Defects is limited to the replacement of the goods.

Any claim made under this warranty must be made by returning the defective goods to us, at your expense. Please provide details of the defect and evidence of purchase to [support@conexus.com.au](mailto:support@conexus.com.au) and we will provide instructions on how to obtain a replacement. If you do not have Internet access please telephone us for further instructions.

This Warranty against Defects is provided in addition to other rights and remedies that you may have at law. Our goods come with guarantees that cannot be excluded under the Australian Consumer Law. You are entitled to a replacement or refund for a major failure and for compensation for any reasonably foreseeable loss or damage. You are also entitled to have the goods repaired or replaced if the goods fail to be of acceptable quality and the failure does not amount to a major failure.

4

### Hardware Basics

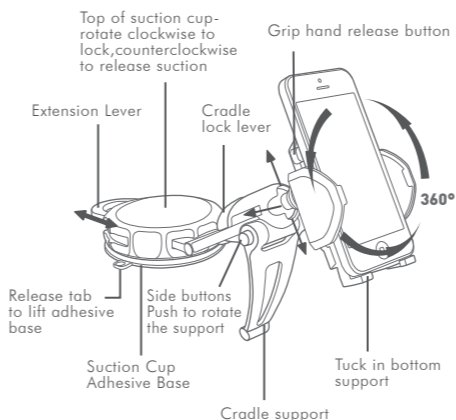

5

### Specifications

- Suitable for various models of Cell phone, iPhone, iPod, MP3 and GPS
- Maximum holding device width: 3 3/4 Inches
- Minimum holding device width: 1 3/4 Inches

#### Note:

- The mounting surface should be free of dirt or oil
- If the suction cup mount has problems staying on dashboard, clean the mounting surface and the suction cup adhesive base with alcohol, then reinstall.
- Moistening the suction cup may help adhesion in some cases.

6

www.macally.com

Back

#### Peripherals Printing Spec 印刷规格

Brief: 简述:	DMOUNT manual
Materials Spec: 用料规格:	105G 双铜纸
INKS 颜色材料: 色料:	K 单黑
Additional Process: 额外加工:	14页翻身折
Note 备注:	