

Audio Troubleshooting and Vehicle Wiring Configurations - Dynavin D8 and D9-MST2010

4-PIN PLUG: Ensure the 4-pin plug on the main wire harness labeled "9000" is plugged in on the back of the Dynavin unit as shown in the image below (circled in yellow). It will only plug in one way with the tab side down. The 4-pin plug must be plugged in here for your factory steering wheel controls to work.

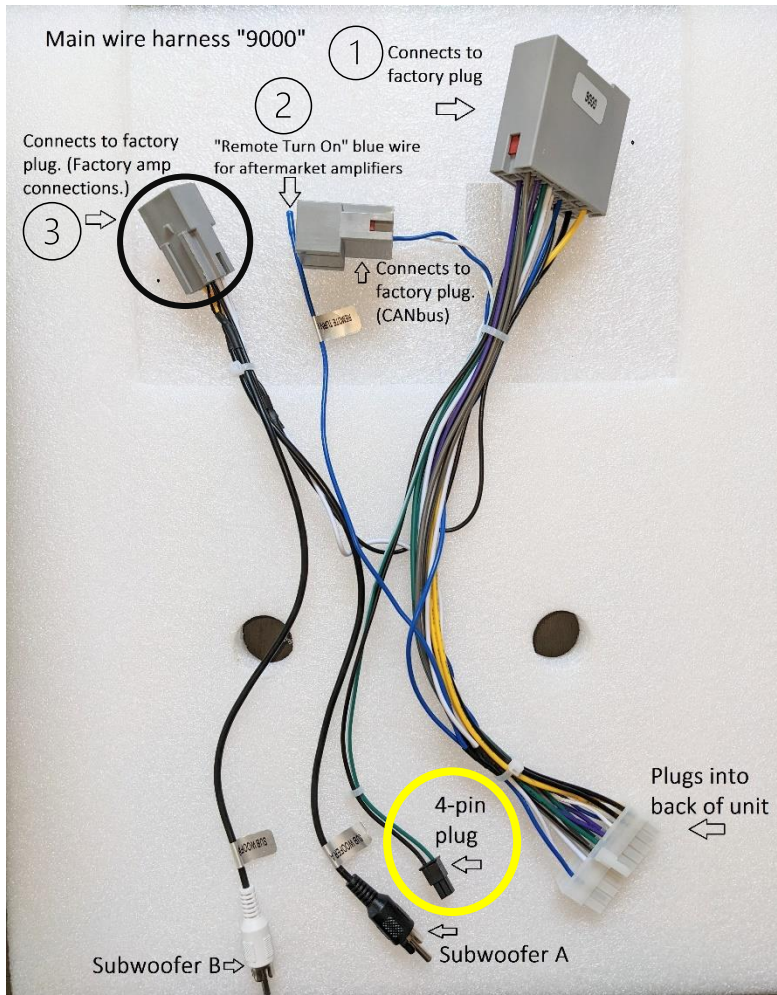

Dynavin Main Wire Harness "9000" Connections



Cars with factory amplifiers *may* require the use of the included amplifier retention harness (which is the short harness with the 2 white and 2 red RCAs). Not all amplified cars will require the amp retention harness. We recommend trying without it first.

If you have a base model, you will NOT use the factory amp connection or the subwoofer RCAs.

See the next page for more information regarding Shaker integration and when to use the amplifier retention harness.

Amplifier Retention Harness (not used with base audio, sometimes used with Shaker audio)

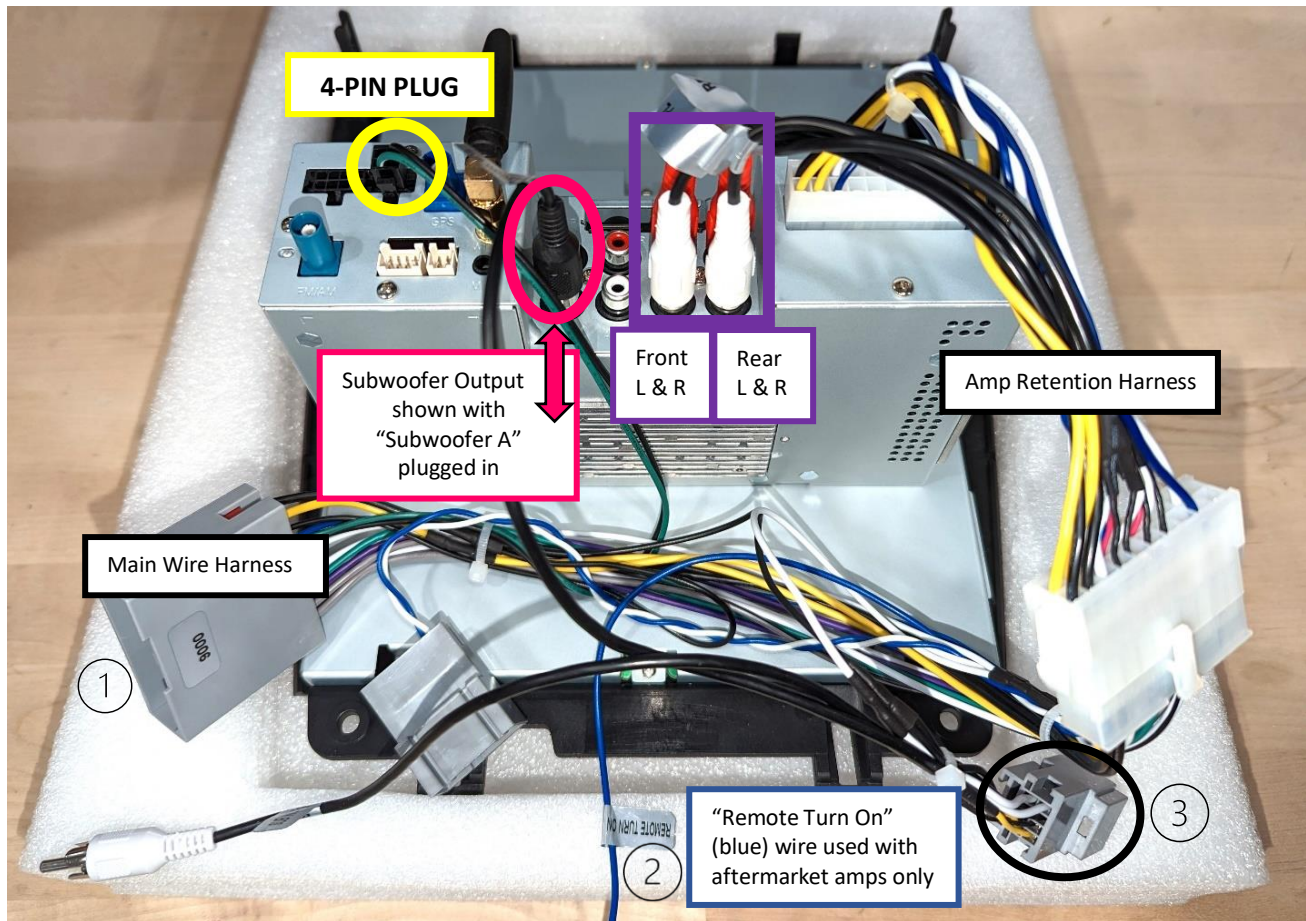

Cars with factory amplifiers *may* require the use of the included amplifier retention harness (the short harness with the 2 white and 2 red RCAs). This plugs into the “9000” main wire harness. The amplifier retention harness provides a lower-level output from the Dynavin to match the factory amplifier. It takes trial and error to determine whether your car needs it. Not all amplified cars will require the amp retention harness. We recommend trying without it first.

- If the speaker output level is too high, *use* the amplifier retention harness.
- If you’re hearing low level static noise, *use* the amplifier retention harness.
- If the audio output is very low, *remove* the amplifier retention harness and use only the main “9000” wire harness.
- If you are hearing static noise whether you use the amplifier retention harness or not, try unplugging the plug circled in black in the picture above with the “3” next to it. In some rare cases, this plug doesn’t affect the audio and only causes static. If you unplug it and your audio still works and there’s no static, then keep it unplugged.

Not hearing bass/subs? Plug in the black “Subwoofer A” RCA from the “9000” harness into the “SUB” RCA port on the back of the unit (as pictured above). If the “Subwoofer A” RCA doesn’t provide bass, use the “Subwoofer B” RCA.

Additionally, there is a “Factory Amplifier” setting in the “Sound” menu that can be enabled and adjusted to fine tune the output level of the head unit to any given installation. Adjust the slider in the “Factory Amplifier” setting as needed.