

How to Assemble your nanobébé Flexy Silicone Bottle



Cómo Usar el nanobébé
Biberón Flexible de Silicona

Customer service: nanobebe.com/support

Step 1

Connect neck ring to silicone body by **pressing & twisting** until silicone sealing lip **pops through neck ring**.

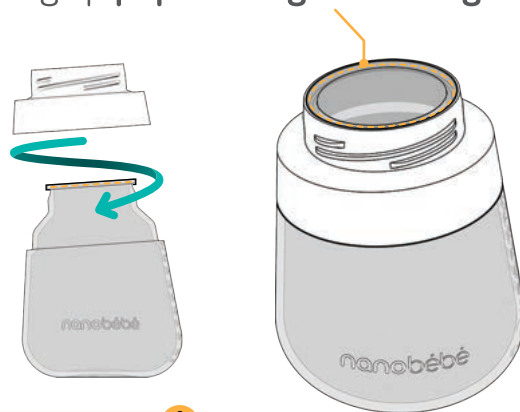

Preventing leaks 

Paso 1

Presione y torce hasta que el borde de sellado de silicona **haga un chasquido**

Step 2

Insert nipple/teat into its ring and twist onto bottle. **Secure tightly.**

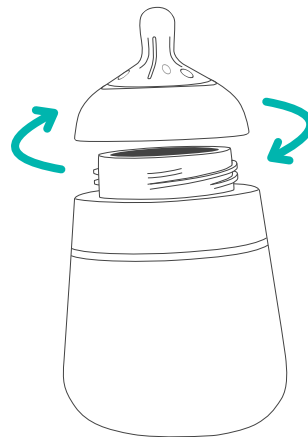

Paso 2

Asegure bien el anillo de la tetilla.

Growing with your baby

Quick connecting handles

to advance self feeding & fine motor skills

*Sold separately



50% OFF

Handles Pack

online at nanobebe.com

CODE: HANDLES50

*promotion limited by availability.

Creciendo con tu bebé

Manijas de conexión rápida para avanzar en la autoalimentación y las habilidades motoras finas

*Se vende separado

Cleaning with
nanobébé



Slim
Drying Rack

Electric
Brush

On-the-go
with baby



Diaper Bags, Cooler Bags, & more.

Baby Care
Reinvented

15%
OFF

On-the-Go
& Cleaning Gear

online at nanobebe.com

CODE: FLEXY15OFF

*promotion limited by availability.

FOR YOUR CHILD'S SAFETY AND HEALTH

Warning! Always use this product with adult supervision. Never use feeding nipple/teat as a pacifier/soother. Continuous and prolonged sucking of fluids will cause tooth decay. Do not heat on the stovetop. Do not place in a heated oven. Always check food temperature before feeding. When using formula, follow the formula milks manufacturers' instructions and allow the freshly boiled water to cool before pouring into the bottle. To ensure the bottle functions correctly and to prevent leakage, always ensure the nipple/teat ring screw is tightly and evenly closed. Expressed breastmilk can be stored in sterilized nanobébé bottles in the refrigerator for up to 48 hours (not in the door) or in the freezer for up to 3 months. Never refreeze breastmilk or add fresh breastmilk to already frozen milk. Always wash your hands thoroughly and ensure surfaces are clean before contact with sterilized components. Do not place components directly on surfaces that have been cleaned with antibacterial cleaning agents.

MAINTENANCE:

- Before each use, inspect all items.
- Pull the nipple/teat in all directions.
- Throw away at first signs of damage or weakness.
- Do not leave a nipple/teat in direct sunlight or heat, or leave in disinfectant ("sterilizing solution") for longer than recommended, as this may weaken the nipple/teat.
- Do not store with or allow to come in to contact with solvents or harsh chemicals.
- Keep all parts not in use out of reach of children.
- For safety and hygiene reasons we recommend that the nipple/teat be replaced at least every two months.
- Excessive concentration of detergents may eventually cause plastic components to crack.
- If not in use for over a week the nanobébé Flexy bottle should be stored disassembled.

CLEANING & STERILIZING

Before first use, disassemble all parts, wash in warm soapy water and rinse thoroughly. Sterilize all parts using nanobébé Steam sterilizer or boil for 5 minutes. Dishwasher safe – top rack only. After each use, sterilize using a nanobébé Steam Sterilizer or in boiling water for 5 minutes. Do not sterilize nor heat the bottle on a stove (gas or electric), doing so will impact the bottles functionality.

Responsibly made in
China for Nutris Ltd.

P.O. Box 7239
Tel Aviv, Israel 6107121

G10-00416-19