

# E50/E50w Installation Guide

*Built-in **Bluetooth**® Hi-Fi amplifier / touch panel*

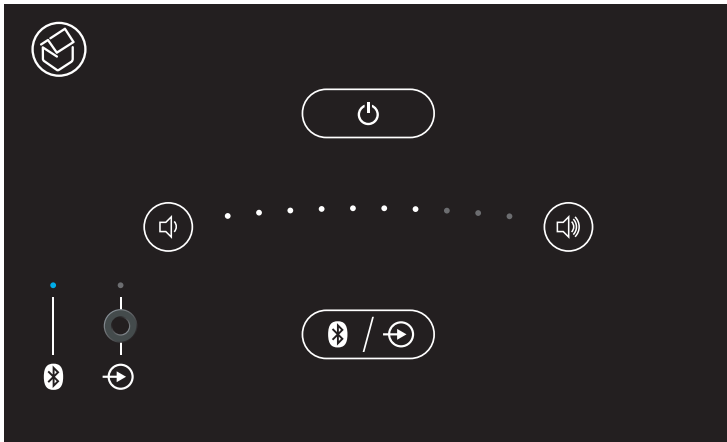

# Important Safety Instructions



**CAUTION:** To reduce the risk of electric shock, do not remove the cover. No user-serviceable parts inside. Refer to qualified personnel.

**WARNING:** To reduce the risk of fire or electric shock, do not expose this appliance to rain or moisture.



The lightning flash with arrowhead within an equilateral triangle is intended to alert the user to the presence of an uninsulated “dangerous voltage” within the product’s enclosure, that may be of sufficient magnitude to constitute a risk of electrical shock to persons.



The exclamation mark within an equilateral triangle is intended to alert the user to the presence of important operating maintenance (servicing) instructions in the guide accompanying this device.

**Read Instructions:** All the safety and operating instructions should be read before the unit is operated.

**Retain Instructions:** The safety and operating instructions should be retained for future reference.

**Heed Warnings:** All warnings on the unit and in the operating instructions should be followed.

**Follow Instructions:** All operating instructions should be followed.

**Cleaning:** Unplug the unit from the wall outlet before cleaning. The unit should be cleaned only with a lint free dry cloth.

**Attachments:** Only use attachments recommended by the manufacturer as non-recommended attachments may cause hazards.

**Water and Moisture:** Do not use the unit near water—for example, near a bath tub, wash bowl, kitchen sink, or laundry tub; in a wet basement; or near a swimming pool.

**Accessories:** Do not place the unit on an unstable surface, stand, tripod, bracket, or table. The unit may fall, causing serious injury to yourself or others, and serious damage to the unit.

**Ventilation:** Do not place in a location or position that will interfere with the unit’s ventilation. Do not operate on a bed, sofa, rug, or other similar surface.

**Power Sources:** The unit should be operated only from the type of power source indicated on the marking label. If you are not sure of the type of power supplied to your home, consult your local power company.

**Power-Cord Protection:** Power-supply cords should be routed so that they are not likely to be walked on or pinched by items placed upon or against them, paying particular attention to cords where they enter a plug, or exit from the unit.

**Lightning:** For added protection for the unit during a lightning storm, or when it is left unattended and unused for long periods of time, unplug it from the wall outlet and disconnect from other devices. This will prevent damage to the unit due to lightning and power-line surges.

**Overloading:** Do not overload wall outlets, extension cords, or integral convenience receptacles as this can result in a risk of fire or electric shock.

**Object and Liquid Entry:** Never push objects of any kind into the unit through openings as they may touch dangerous voltage points or short-out parts that could result in a fire or electric shock. Never spill liquid of any kind on the unit.

**Servicing:** Do not attempt to service the unit yourself as opening or removing covers may expose you to dangerous voltage or other hazards. Refer all servicing to qualified service personnel.

**Damage Requiring Service:** Unplug the unit from the wall outlet and refer servicing to qualified personnel under the following conditions:

- When the power-supply cord or plug is damaged,
- If liquid has been spilled, or objects have fallen into the unit,
- If the unit has been exposed to rain or water,
- If the unit does not operate normally by following the operating instructions,
- If the unit has been dropped or damaged in any way.
- When the unit exhibits a distinct change in performance— this indicates a need for service.

**Replacement Parts:** When replacement parts are required, be sure the service technician uses replacement parts specified by the manufacturer or which have the same characteristics as the original parts. Unauthorized substitutions may result in fire, electric shock, or other hazards.

**Heat:** The unit should be situated away from heat sources such as radiators, heat registers, stoves, or other units (including amplifiers) that produce heat.



This product complies with the Radio Equipment Directive (2014/53/EU) when used and installed according to the instruction manual.

NOTE: This equipment has been tested and found to comply with the limits for a Class B digital device, pursuant to part 15 of the FCC Rules. These limits are designed to provide reasonable protection against harmful interference in a residential installation. This equipment generates, uses and can radiate radio frequency energy and, if not installed and used in accordance with the instructions, may cause harmful interference to radio communications. However, there is no guarantee that interference will not occur in a particular installation. If this equipment does cause harmful interference to radio or television reception, which can be determined by turning the equipment off and on, the user is encouraged to try to correct the interference by one or more of the following measures:

- Reorient or relocate the receiving antenna.
- Increase the separation between the equipment and receiver.
- Connect the equipment into an outlet on a circuit different from that to which the receiver is connected.
- Consult the dealer or an experienced radio/TV technician for help.

The user is cautioned that changes or modifications not expressly approved by Armour Home Electronics could void the user's authority to operate the equipment.

Contains FCC ID: OC3BM1856



The *Bluetooth*® word mark and logos are registered trademarks owned by Bluetooth SIG, Inc. and any use of such marks by Armour Home Electronics Limited is under licence. Qualcomm® aptX™ is a product of Qualcomm Technologies International, Ltd. Qualcomm® and aptX™ are registered trademarks of Qualcomm Incorporated, registered in the United States and other countries, used with permission. Systemline and Q Acoustics are registered trademarks of Armour Home Electronics Limited. All other product names are trademarks or registered trademarks of their respective owners.

# Pack Contents

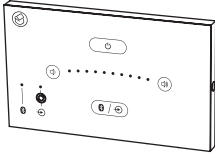

**E50/E50w touch panel x 1**

Pre-fitted with IMO plugs  
for speaker cables

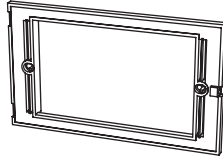

**Mounting frame x 1**

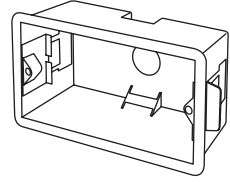

**Dry lining back box x 1**

47mm deep double gang



**M3 x 7mm screw x 1**



**M3.5 x 30mm screws x 2**



**Dust cap x 1**

Fits into front jack socket

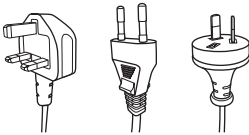
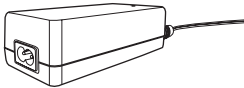

**Power supply x 1**

UK / EU / AUS / NZ



**Speaker cables x 2**

7m length



**Power extension cable x 1**

5m length

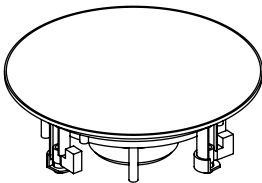

**\*Q Acoustics Qi 65CB  
in-ceiling speakers x 2**

Included with Stereo  
Speaker Pack only (SE0520/SE0560)



**3.5mm jack cable x 1**

Not supplied

\*Alternative speakers may be used if desired. Check against E50 amplifier specification to ensure compatibility.

## Introduction

Systemline E50 is an installed *Bluetooth* Hi-Fi system that is easy to fit into your room. It is particularly suited to kitchens or bedrooms but could equally be used in any other room in the house including bathrooms\*.

The following instructions assume that you are competent in general electrical installation skills. You will need to mount a touch panel into a double gang back box and route cables from this box to the speakers and mains. If you are not confident in doing this you should seek professional assistance from a qualified electrician.

It is possible to connect TV sound or another device into the rear line input. This is shown on the system schematic.

\*The E50w (white) touch panel is IP54 rated when installed and sealed in accordance with the E50w bathroom installation guide (Appendix 1). The touch panel must be located outside zone 2 of the electrical safety zones. If in doubt, you are advised to seek assistance from a qualified electrician.

# E50 System Schematic

The system is designed to be connected together as shown below:

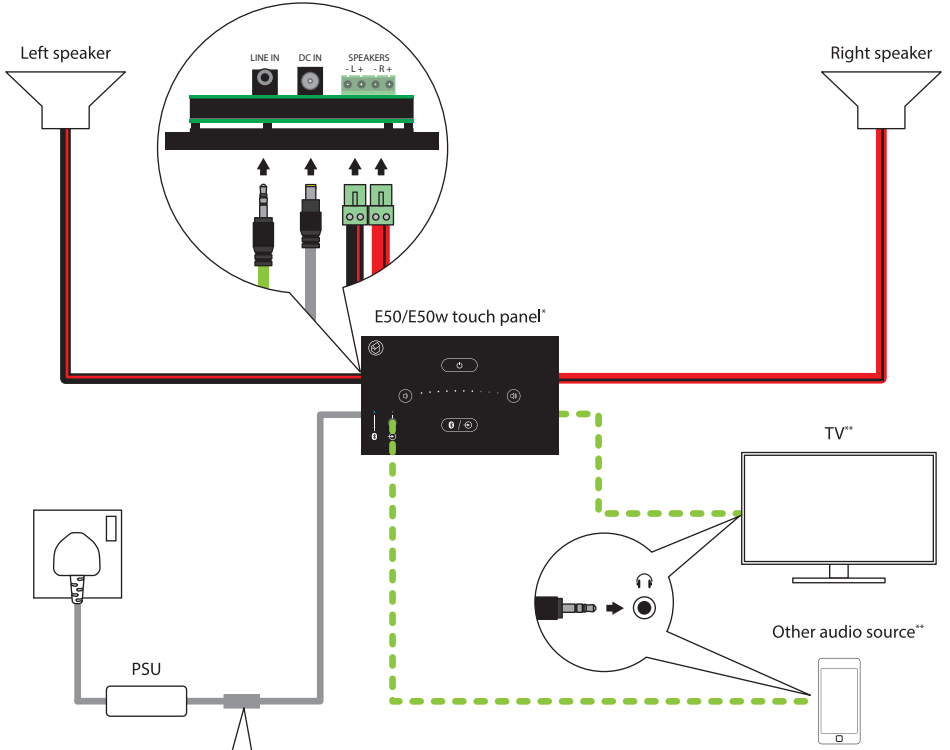





\*Front jack socket on black E50 only.

\*\*A TV or other audio source may be connected to the front or rear line input to be played through the E50 system.

⚠ Do not connect audio sources to the front and rear line inputs at the same time.

**KEY**

- Power cable 
- Speaker cable (left) 
- Speaker cable (right) 
- 3.5mm jack cable (not supplied) 

# Planning E50 Positioning and Back Box Locations

Use the guidelines below to plan the positioning of the back boxes, speakers and cabling. Dimensions should be checked prior to installation to ensure the layout works correctly with the supplied lengths of cable.

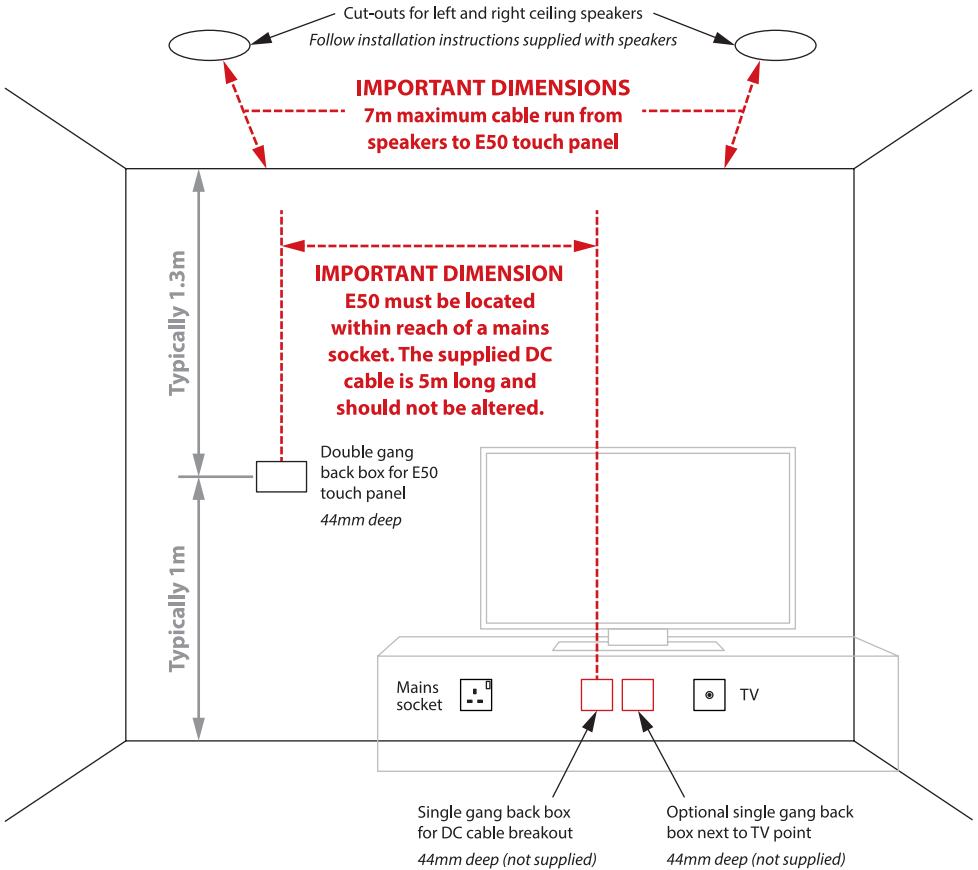

# First Fix Wiring

Cut holes for required back boxes and speakers. Run speaker cables and power cable as shown, leaving the tails accessible for second fix. Optional line-in cable may be run at this point.

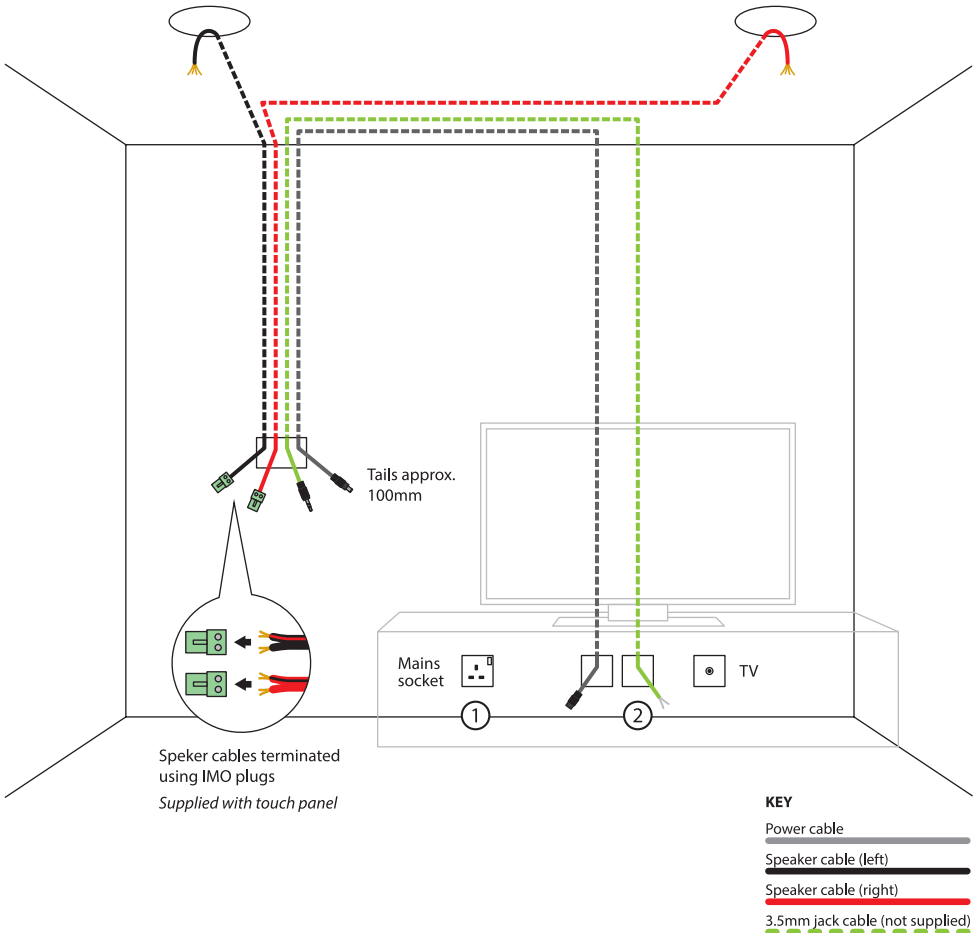

## Notes

1. Switched mains socket required next to cable break-out box.
2. Single gang back-box required next to TV aerial point for optional TV sound / AUX input.



# Second Fix

Connect cable tails to touch panel, speakers and PSU. Fix items in place, using the instructions supplied with the speakers to ensure correct speaker installation.

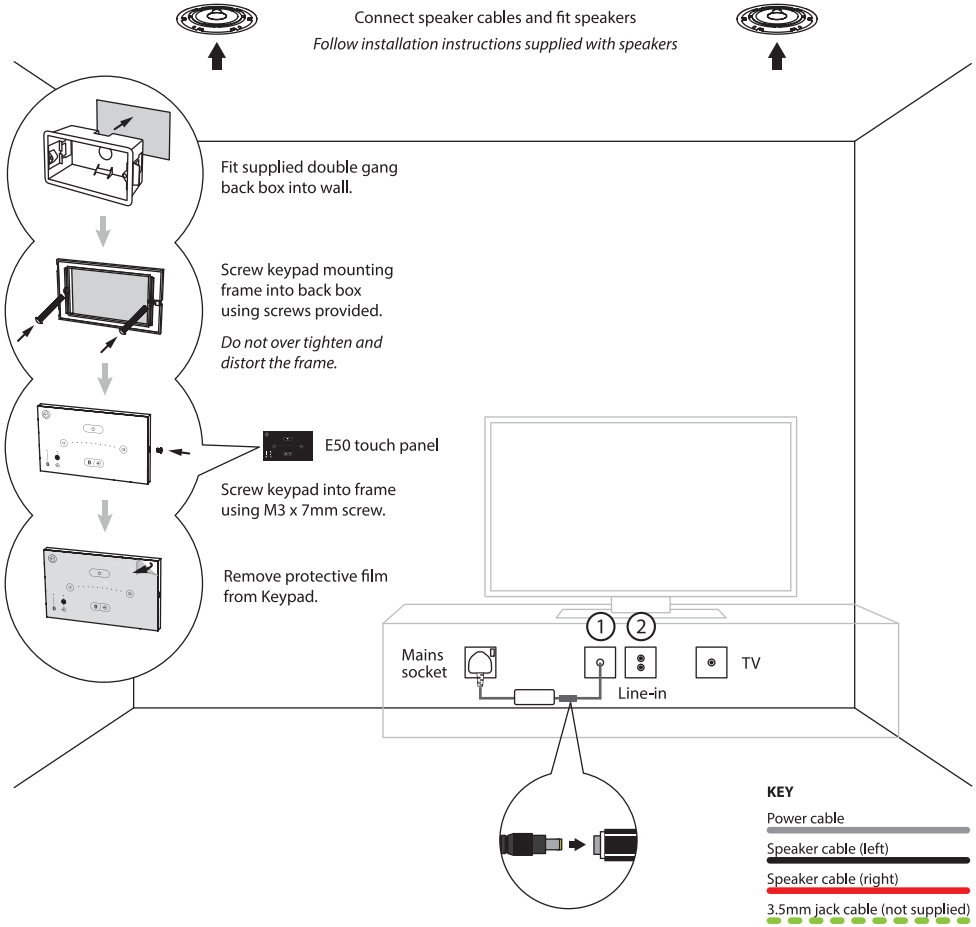

## Notes

1. Blanking plate required to cover break-out box - requires a single hole to exit DC cable.
2. Optional TV sound / Aux input requires a 25 x 50mm twin phono Euro module e.g. Philex EMSPK2W or similar.

# Appendix 1: E50w Bathroom Installation Guide

E50w is designed to be fitted into a bathroom environment, which is clearly different to most other rooms in the home. The nature of this wet environment is recognised by the respective standards authorities, who test products in terms of their suitability to be installed in such areas.

E50w complies with IP54, subject to the following conditions:

## 1. Wiring

This is defined as an Extra Low Voltage Installation, but the wiring needs to be installed in accordance with 'Part P' of the Design and Installation of Electrical Installations. If in doubt, you are advised to seek assistance from a qualified electrician.

## 2. Location

Please refer to the diagram below. The E50w should be installed **outside** of areas designated as zone 1 & 2.

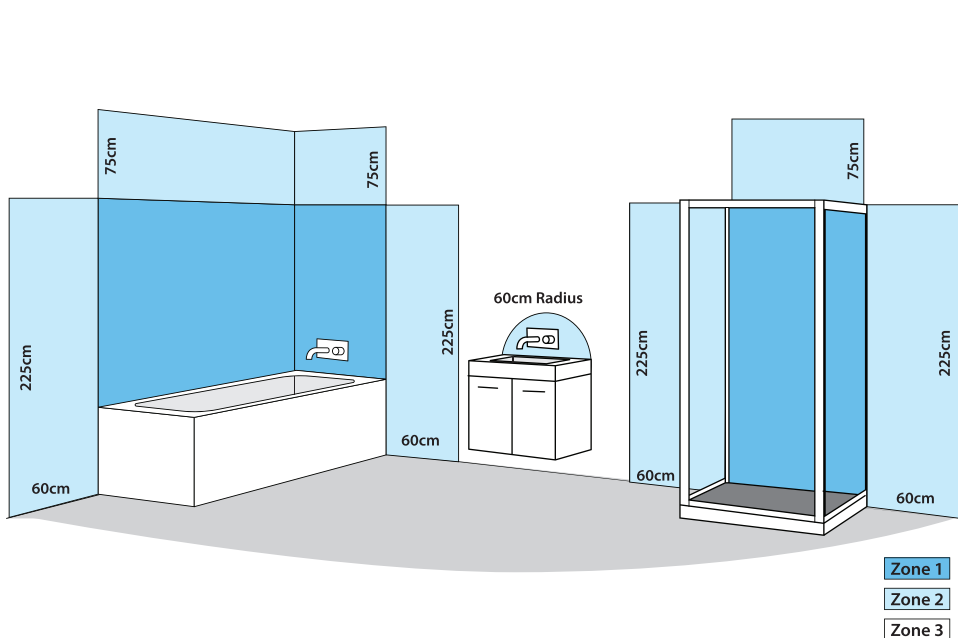

### 3. Installation

#### Step 1

Apply silicone sealant on the back of the frame.

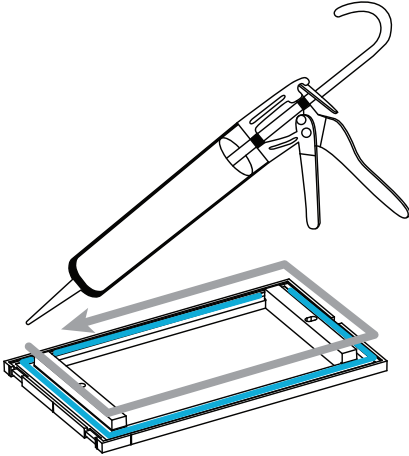

#### Step 2

Fit the frame onto the back box and secure using 2 screws.

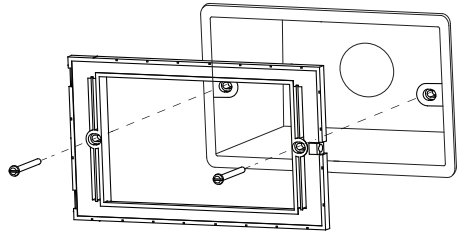

#### Step 3

Plug cables into keypad and fit into the frame.

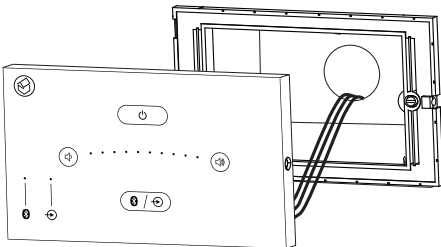

#### Step 4

Secure the front using the screw provided and smooth out the edges using a sealant smoother.

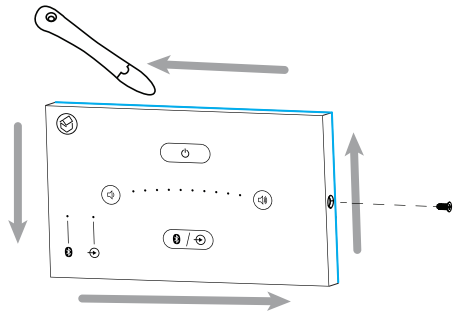

All other instructions for the connection and fitting of E50w apply, except in this instance the left & right speaker wires are connected to a single stereo Q Install speaker (Qi-65 CW-ST). See also instructions supplied with this speaker.



Stortford Hall Industrial Park  
Dunmow Road  
Bishops Stortford  
Hertfordshire  
CM23 5GZ  
United Kingdom

[www.systemline.co.uk](http://www.systemline.co.uk)



©2018 Armour Home Electronics, all rights reserved.  
Our policy is one of continuous improvement and we reserve the right to  
change the designs and specifications without notice.  
All information is given in good faith. The manufacturer accepts no  
responsibility for errors, omissions or incorrect assumptions.

Designed and engineered in the United Kingdom. Made in China (P.R.C.)

Q16007-IS\_r6