

Herdio®

5.25" 2-Way Full Range Stereo Sound
High-Performance In-wall / In-Ceiling Speakers

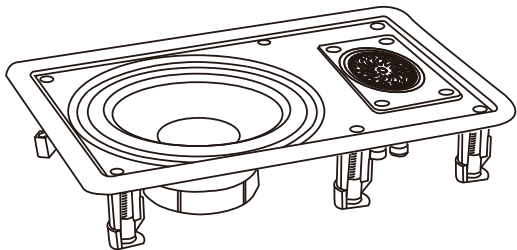

HCS5030



OWNER'S MANUAL

www.Herdiotech.com

FCC REQUIREMENT

Changes or modifications not expressly approved by the party responsible for compliance could void the user's authority to operate the equipment.

This device complies with Part 15 of the FCC Rules. Operation is subject to the following two conditions:

- (1) this device may not cause harmful interference, and
- (2) this device must accept any interference received, including interference that may cause undesired operation

Note: This equipment has been tested and found to comply with the limits for a Class B digital device, pursuant to Part 15 of the FCC Rules. These limits are designed to provide reasonable protection against harmful interference in a residential installation. This equipment generates, uses, and can radiate radio frequency energy, and if not installed and used in accordance with the instructions, may cause harmful interference to radio communications.

However, there is no guarantee that interference will not occur in a particular installation. If this equipment does cause harmful interference to radio or television reception, which can be determined by turning the equipment off and on, the user is encouraged to try to correct the interference by one or more of the following measures:

- Reorient or relocate the receiving antenna.
- Increase the separation between the equipment and receiver.
- Connect the equipment into an outlet on a circuit different from that to which the receiver is connected.
- Consult the dealer or an experienced radio/TV technician for help.

This equipment complies with FCC radiation exposure limits set forth for an uncontrolled environment. This equipment should be installed and operated with a minimum distance of 20cm between the radiator & your body. This transmitter must not be co-located or operating in conjunction with any other antenna or transmitter.

www.Herdiotech.com

BLUETOOTH CONNECTIVITY (ONLY FOR BLUETOOTH VERSION)

1. Make sure the Bluetooth Ceiling Speaker system is properly connected to a power Source, and speaker wires are connected correctly.
2. Power ON the speaker system, and you shall hear a tone indicating the Bluetooth system is ready for pairing.
3. Then, go to your Smart device's Bluetooth Network Settings, The Bluetooth Network Name will appear as ' Herdio' on your device list, and click for connection. No password is required to connect but if you are prompted enter '0000' (4 zeroes).
4. You shall hear another indication tone when a successful Bluetooth connection is established, then you are ready to enjoy the music.

WARRANTY

All Herdio speaker products have 1 year Limited Warranty against defects in materials and workmanship. Proof of purchase must accompany all claims. During the warranty period Herdio will replace any defective part and correct any defect in workmanship without charge for either parts or labor.

www.Herdiotech.com

TECHNICAL SPECIFICATIONS

Outside Facial Diameter:	8.07*11.61" (205*295mm)	
Mounting Hole Diameter:	6.81*10.43" (173*265mm)	
Mounting Depth:	2.95"(75mm)	
Impedance:	8 Ohms	
Frequency Response:	80Hz-20kHz	
Power Handling(Max):	100 W	
Magnet Material:	8 Oz	
SPL(1Watt / 1Meter):	89 dB	
Product Material:	Molded ABS Plastic Basket	

INSTALLATION GUIDE:

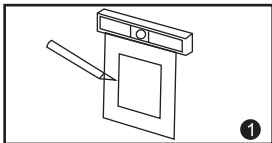

1. Cut the drywall. Note: Always allow at least one-half inch between a wall stud and the speaker cutout or the locking tabs will not be able to swivel into place.

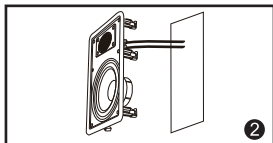

2. Connect the speaker wires to the speaker.

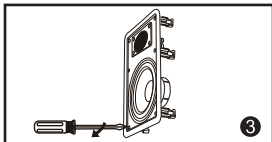

3. Screw down each of the four Phillips head screws. The locking tabs will swivel into place and secure the unit to the rear surface of the drywall. Put in the strips of adhesive to secure the grille.

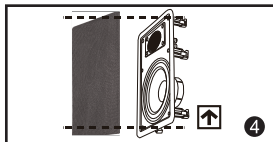

4. Press the cover according to the direction of the picture with the speaker assembly.

www.Herdiotech.com

Herdio®

5.25 Zoll 2-Weg Full-Range-Stereo-Sound
Hohe Leistung In Wand-Decken-Lautsprechern

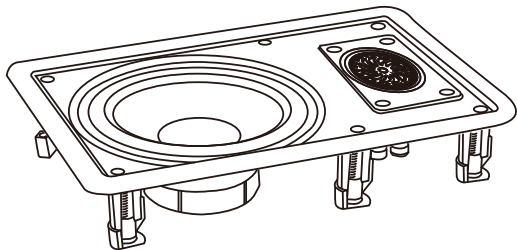

HCS5030



BENUTZERHANDBUCH

www.Herdiotech.com

Deutsch

BLUETOOTH-VERBINDUNG

(Nur Bluetooth-Version)

1. Stellen Sie sicher, dass der Bluetooth-Deckenlautsprecher an die Stromversorgung angeschlossen und das Audiokabel korrekt angeschlossen ist.

2. Wenn der Lautsprecher eingeschaltet ist, hören Sie die Aufforderung, dass das Bluetooth-System für die Verbindung bereit ist.

3. Öffnen Sie dann die Bluetooth-Einstellungen Ihres intelligenten Geräts, suchen Sie den Bluetooth-Namen "Herdio" in der Geräteliste und klicken Sie auf, um eine Verbindung herzustellen. Geben Sie ggf. das Passwort 0000 ein.

4. Nachdem die Verbindung erfolgreich hergestellt wurde, ertönt eine Sprachaufforderung, und dann können Sie Musik genießen.

www.Herdiotech.com

QUALITÄTSSICHERUNG

Für die Material-und Verarbeitungsqualität aller Herdio-Lautsprecher gibt es eine einjährige beschränkte Garantie. Der Kaufnachweis muss bei der Reklamation vorgelegt werden. Während der Garantiezeit ersetzt Herdio diebeschädigten Teile kostenlos und repariert die Produkte. Der Kundebraucht keine Lohnkosten zu bezahlen.

SPEZIFIKATIONEN

Produkt Durchmesser:	8.07*11.61" (205*295mm)
Durchmesser Der Bohrung:	6.81*10.43" (173*265mm)
Tiefe Der Montage:	2.95"(75mm)
Impedanz:	8 Ohms
Frequenzgang:	80Hz-20kHz
Max. Ausgangsleistung:	100 W
Magnet Material:	8 Oz
SPL(1Watt / 1Metro):	89 dB
Produkts Material:	Molded ABS Kunststoff

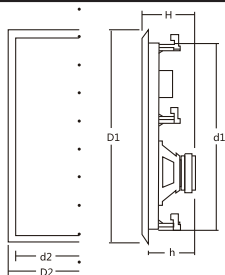

www.Herdiotech.com

INSTALLATION:

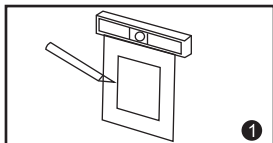

1. Zu lochenden Gipsplatten
Schneiden Hinweis: Halten Sie
einen Abstand von 0.5 Zoll
zwischen dem Wandnagel und
dem Lautsprecherausschnitt
ein, sonst kann die Verriegelung
nicht dreht und einrastet.

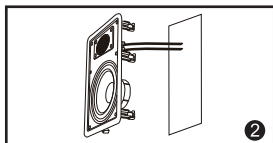

2. Lautsprecherkabel an
Lautsprecher angeschlossen.

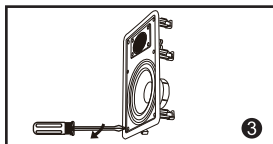

3. Ziehen Sie die vier
Kreuzschrauben fest, dann
dreht sich die Verriegelungs-
platte und fixiert das Gerät
an der Rückseite der
Gipsplatte.

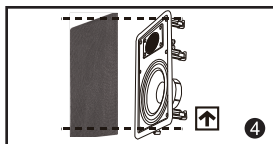

4. Drücken Sie die Abdeckung
entsprechend
der Bildrichtung mit der
Lautsprechermontage.

www.Herdiotech.com

Herdio®

**5.25 "Altoparlante A Parete
Ad Alte Prestazioni Stereo**

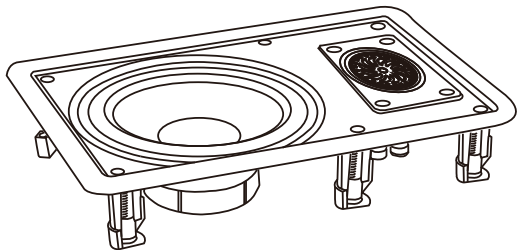

HCS5030



MANUALE DI ISTRUZIONI

www.Herdiotech.com

Italiano

CONNESSIONE BLUETOOTH (Solo Versione Bluetooth)

1. Accertarsi che l'altoparlante da soffitto Bluetooth sia collegato all'alimentazione e che il cavo dell'altoparlante sia collegato correttamente.

2. Quando il sistema di altoparlanti è acceso, sentirai il messaggio che il sistema Bluetooth è pronto per la connessione.

3. Quindi, apri le impostazioni di rete Bluetooth del tuo dispositivo smart, trova il nome Bluetooth "Herdio" nell'elenco dei dispositivi e fai clic su Connetti. Se hai bisogno di una password, inserisci 0000.

4. Al termine della connessione, verrà visualizzato un messaggio vocale, quindi è possibile iniziare a ascoltare la musica.

www.Herdiotech.com

GARANZIA DI QUALITÀ

Esiste una garanzia limitata di un anno per i materiali e la lavorazione di tutti i prodotti per altoparlanti herdio. La prova di acquisto deve essere fornita al momento del reclamo. Durante il periodo di garanzia, Herdio sostituirà le parti danneggiate gratuitamente, riparerà i problemi di fabbricazione del prodotto e il cliente non deve pagare il costo del lavoro.

SPECIFICHE TECNICHE

Diametro Facciale Esterno:	8.07*11.61" (205*295mm)
Diametro Del Foro:	6.81*10.43" (173*265mm)
Profondità Di Montaggio:	2.95"(75mm)
Impedenza:	8 Ohms
Risposta In Frequenza:	80Hz-20kHz
Potenza Massima In Uscita:	100 W
Materiale Magnetico:	8 Oz
SPL(1Watt / 1Metro):	89 dB
Prodotto Materiale:	Cestino di plastica di ABS

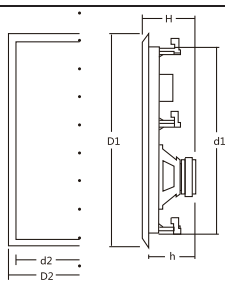

www.Herdiotech.com

PROCEDURA GUIDATA DI INSTALLAZIONE:

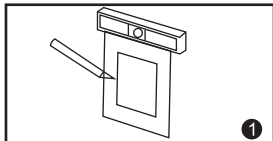

1. Tagliare il cartongesso aperto.
Nota: lasciare 0.5 pollici tra i perni e il ritaglio dell'altoparlante, altrimenti il fermo non ruoterà e si manterrà in posizione.

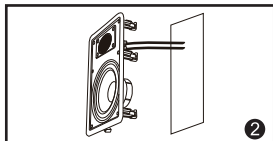

2. Cavo dell'altoparlante è collegato all'altoparlante.

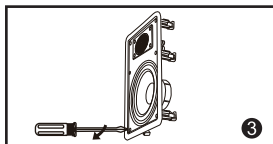

3. Stringere le quattro viti Phillips, quindi la linguetta di bloccaggio ruota e fissa l'unità alla superficie posteriore del cartongesso.

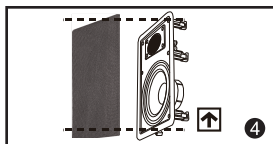

4. Premere il cappuccio nella direzione dell'immagine con il gruppo altoparlante.

www.Herdiotech.com

Herdio®

**Haut - Parleur Mural Haute Performance
Stéréo à 2 Voies De 5.25 Pouces**

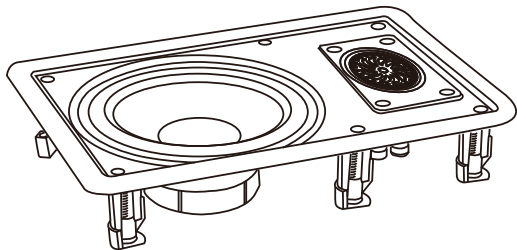

HCS5030



MANUEL D'INSTRUCTIONS

www.Herdiotech.com

CONNEXION BLUETOOTH(Uniquement) APPLICABLE À LA VERSION(Bluetooth)

1. Assurez-vous que le haut-parleur de plafond Bluetooth est branché sur la prise électrique et que le câble du haut-parleur est correctement mis à la terre.
2. Après avoir allumé le système de haut-parleur, vous entendrez l'invite vocale indiquant que le système Bluetooth est prêt à effectuer la connexion.
3. Ensuite, accédez aux Paramètres du réseau Bluetooth de votre appareil intelligent, trouvez le nom "Herdio" Bluetooth dans la liste des appareils, cliquez pour établir la connexion. Si un mot de passe est requis, veuillez entrer 0000.
4. Une fois la connexion établie, vous pourrez entendre une invite vocale, ainsi, vous pourrez commencer à apprécier la musique.

www.Herdiotech.com

GARANTIE DE QUALITÉ

La garantie limitée d'un an couvre les défauts de matériaux et de fabrication les produits de haut-parleur de Herdio. La preuve d'achat doit être fournie pour demander un service de garantie. Pendant la période de garantie, Herdio remplacera les pièces endommagées et réparera le produit gratuitement si nécessaire, le client n'a pas besoin de payer des frais de main-d'œuvre.

SPÉCIFICATIONS TECHNIQUES

Diamètre Facial Extérieur:	8.07*11.61" (205*295mm)
Diamètre Du Trou Ouvert:	6.81*10.43" (173*265mm)
Profondeur D'Installation:	2.95"(75mm)
Impédance:	8 Ohms
Réponse En Fréquence:	80Hz-20kHz
Puissance De Sortie Maximale:	100 W
Matériau Magnétique:	8 Oz
SPL(1Watt / 1Metro):	89 dB
Matériaux De Produit:	Panier en plastique ABS moulé

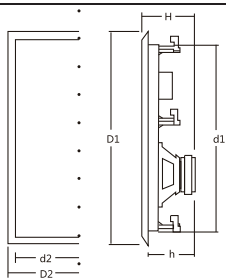

www.Herdiotech.com

COMMENT INSTALLER:

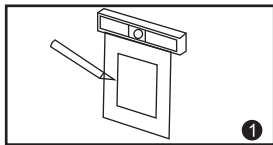

1. Coupez le panneau de plâtre au trou ouvert
Remarque: Laissez un espace de 0.5 pouce entre le clou mural et l'entaille du haut-parleur, sinon le verrou ne pourra pas être tourné et fixé en place.

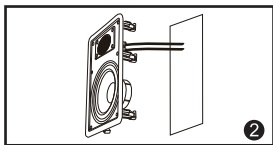

2. Connectez le fil du haut-parleur au haut-parleur.

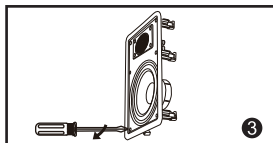

3. Après que les quatre vis cruciformes sont serrés, la pièce de verrouillage tournera. Fixez le dispositif à la surface arrière de la plaque de plâtre.

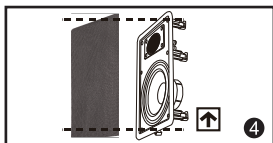

4. Appuyez sur le couvercle dans le sens de l'image avec l'ensemble Haut-parleur.

www.Herdiotech.com

Herdio®

**Altavoces Estéreo De Alto
Rendimiento De 5.25 Pulgadas**

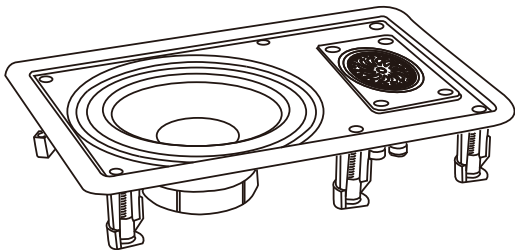

HCS5030



MANUAL DE INSTRUCCIONES

www.Herdiotech.com

CONEXIÓN DE BLUETOOTH (Sólo Para Versión De Bluetooth)

1. Asegúrese de que Bluetooth electrónica de audio de techo esté conectada a la fuente de alimentación y que el cable del altavoz esté conectado correctamente.
2. Después de encender el sistema de electrónica de audio, escuchará el tono de aviso de que el sistema de Bluetooth está esperando para conectarse.
3. Luego, abra la configuración de red de Bluetooth de su dispositivo inteligente, busque el nombre de Bluetooth "Herdio" en la lista de dispositivos y haga clic en Conectar, si necesita la contraseña, ingrese 0000 por favor.
4. Después de conectar exitosamente, habrá un tono de aviso de voz y luego podrá empezar a disfrutar de la música.

www.Herdiotech.com

GARANTÍA DE CALIDAD

Sobre los materiales y la mano de obra de todos los productos de electrónica de audio de Herdio, se proporciona la garantía limitada de un año. El cliente se debe presentar un comprobante de compra al hacer un reclamo. Durante el período de garantía, Herdio reemplazará las piezas dañadas de forma gratuita, reparará la mano de obra del producto y el cliente no tendrá que pagar los costos de mano de obra.

EEPECIFICACIONES TÉCNICAS

Diámetro Facial Exterior:	8.07*11.61" (205*295mm)
Diámetro Del Agujero:	6.81*10.43" (173*265mm)
Profundidad De Instalación:	2.95"(75mm)
Impedancia:	8 Ohms
Respuesta De Frecuencia:	80Hz-20kHz
Máxima Potencia De Salida:	100 W
Materiales Magnéticos:	8 Oz
SPL(1Vatio / 1Metro):	89 dB
Producto Material:	ABS plastics cesta

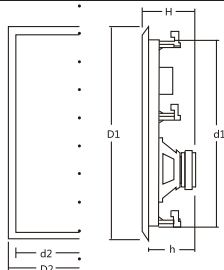

www.Herdiotech.com

GUÍA DE INSTALACIÓN:

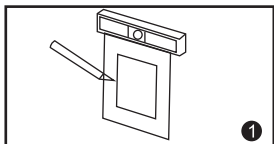

1. Corte el panel de yeso con agujero. Nota: Quede 0.5 pulgadas entre el clavo de la pared y el abierto de corte de electrónica de audio, de lo contrario el bloqueo no podrá girar y fijar en su lugar.

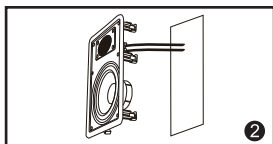

2. El cable de electrónica de audio está conectada con la electrónica de audio.

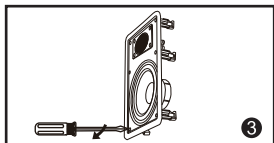

3. Apriete los cuatro Phillips tornillos, luego la pieza de bloqueo girará y fijará el dispositivo a la superficie posterior del panel de yeso.

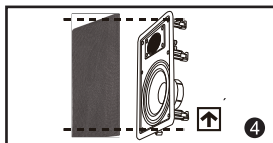

4. Presione la tapa en la dirección de la imagen con el conjunto del altavoz.

www.Herdiotech.com