

# Panic Exit Devices



We take the worry out of  
protecting what's valuable to you.  
Lockwood: *no worries*<sup>®</sup>



ASSA ABLOY

25YEAR

MECHANICAL  
WARRANTY

[www.lockweb.com.au](http://www.lockweb.com.au)

# Contents



## 9000/9100 Series

Rim Type Panic Exit Device

page 5



## 9300/9400 Series

Vertical Type Panic Exit Device

page 7

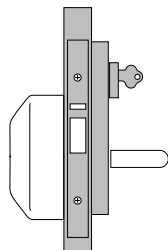

## 9500/9600 Series

Rim Type Panic Exit Device with Mortice Lock

page 9



## 9000/9100 Series

Electromechanical Rim Type Panic Exit Device

page 14



## 9300/9400 Series

Electromechanical Rim Vertical Type Panic Exit Device

page 16



## 781/791 Series

Panic Bolts

page 20

# Panic Exit Devices

Lockwood's 9000 Series Panic Exit Devices are designed to provide a ready means of escape at all times and still maintain high levels of security. Mechanism design ensures easy installation, clean styling and ease of operation. Suitable for single or double doors.

Designed to comply with world class standards for both safety and fire.

The main purpose of a panic exit device is to give safe and effective escape through a doorway with minimum effort and without prior knowledge of the device.

In a panic situation, a group of people will react differently from an individual. When two or more people are running to an escape door, probably in darkness and/or smoke, it is possible that the first one to reach the door will not necessarily operate the panic device, but can push the surface of the door while other people will be trying to operate the panic bar by hand or body pressure.

The Lockwood 9000 Series Panic Exit Devices will enable a door to be opened at all times by hand or body pressure along the inside face of the panic device and not require the use of a key or any other object.

All Lockwood 9000 Series Panic Exit Devices are designed for ease of opening by the young, elderly and handicapped.

## Performance

### Normal Situations

Low opening pressure is ideal for children, older people and the handicapped.

Under these conditions a light push of 8 kg (maximum) will operate the push bar.

### Panic Situations

Device operates in panic situations even if door is subject to loads of 100 kg.

Under these conditions a maximum of 22 kg will operate the push bar.

## Typical Door Installations

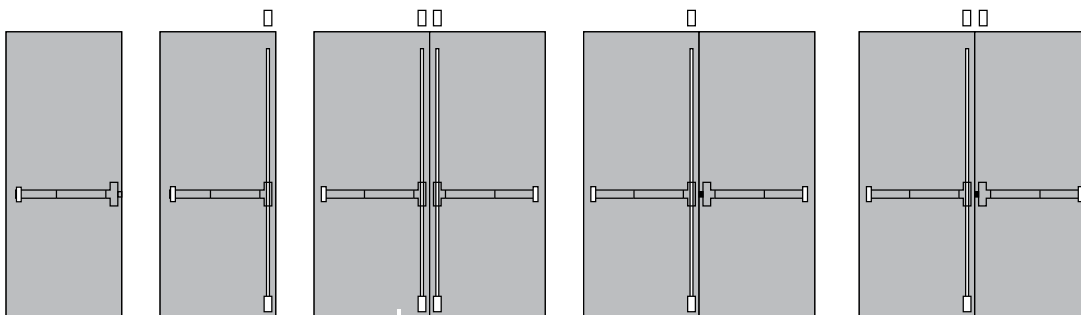

Single Door  
with Rim Device  
9000EOSIL  
9100EOSIL

Single Door with  
Vertical Device  
9300EOSIL  
9400EOSIL

Pair of Non-rebated Doors  
with 2 Vertical Devices  
9300EOSIL  
9300EOSIL  
9400EOSIL  
9400EOSIL

Pair of Rebated Doors  
1 Vertical Device and  
1 Rim Device  
9300EOSIL  
9000EOSIL  
9400EOSIL  
9100EOSIL

Pair of Rebated Doors  
1 Vertical Device, Mortice  
Lock and Rebate Strike  
9300EOSIL  
9500MLSIL  
9400EOSIL  
9600MLSIL

# 9000 Series Panic Exit Devices

## Applications

It is important that the width of the passage of the door is not unduly reduced by the projection of the operating bar. This is why the standards set the projection at 100mm (EN1125:1997). Lockwood has reduced this projection to 60mm with its push bar 9000 Series, allowing for a panic bar in a narrow passage without modification of the door or the number of units of passage.

Suitable for single or double doors, timber, metal, narrow profile, glass security and fire doors.

## Features and Specifications

- Deadlatching on all bolts
- Safety clutch outside lever trim plate protects the unit from damage that could render the device inoperable
- Adjustable on site
- Automatic top and bottom latches maintaining the bolt drawn in when the door is open (vertical version)
- Surface mounted for ease of installation
- Pick resistant bottom latch

## Outside Trims

- Key entry with pull plate and key/lever entry with mechanism safety override
- Hold-back (dogging)
- Euro cylinder key hold-back available on all types
- Hold-back is not an approved function on fire doors

## Keying

### Standard Keying

- Cylinders, if required, are to be ordered separately
- Supplied individually keyed with two keys per lock
- 78,000 key combinations
- Key blank KB2015P

### Restricted Special Keying

Lockwood locks can be keyed to a number of controlled and/or specially keyed systems. These range from legally protected keys to protect against unauthorised duplication, which can also include specially designed key systems such as master key systems, which allow for different levels of mechanical access control.

## Product Details

<b>Auxiliary Bolt</b>	Double chrome plated steel <ul style="list-style-type: none"> <li>• Standard maximum height 2300mm (vertical rod version)</li> </ul>
<b>Door Height</b>	<ul style="list-style-type: none"> <li>• For doors between 2300 to 3000mm in height, order extension rod kit part no. 9000/50SIL</li> <li>• Installed with centre line of exit device at 1023mm above finished floor level</li> </ul>
<b>Door Stile</b>	Suitable for both 90° and flush head door stiles minimum head clearance requirement of 30mm. <ul style="list-style-type: none"> <li>• Standatd 35mm to 45mm</li> <li>• Extended spindle kit for up to 90mm doors</li> <li>• Mortice lock version 32 to 48mm doors specify door thickness when other than standard.</li> </ul>
<b>Door Thickness</b>	
<b>Finish</b>	Silver Polyester Powdercoat with black touch bar (SIL)
<b>Handing</b>	All functions are reversible and non-handed except 9500/9600 Series Mortice Lock versions.
<b>Latchbolt</b>	Double chrome plated steel <ul style="list-style-type: none"> <li>• The body is manufactured of steel</li> <li>• Internal mechanisms made of steel or brass</li> <li>• Main cover made of decorated electroplated steel pressing</li> </ul>
<b>Materials</b>	<ul style="list-style-type: none"> <li>• Secondary cover made of decorated Zamak</li> <li>• Horizontal bar made of decorated steel</li> <li>• Lever plate operating mechanism is made from electroplated steel pressings with high density zinc alloy cover</li> </ul>
<b>Product Width</b>	<ul style="list-style-type: none"> <li>• Standard maximum 838mm (to suit 900mm door)</li> <li>• 1141mm (to suit 1200mm door)</li> </ul>

## Standards and Compliance



Fire Rated.

**S2**

(Security) Australian Lock Standard (AS4145.2.1993)

**D3**

(Durability) Australian Lock Standard (AS4145.2.1993)



Anti-Corrosion.



Meets European Standard EN1125:1997



NF & QE Listed



Meets NFP26-215



ANSI A156 Grade Requirements

Conforms to Australian and Worldwide Standard (EN1125:1997)

# 9000/9100 Series Rim Type Panic Exit Device

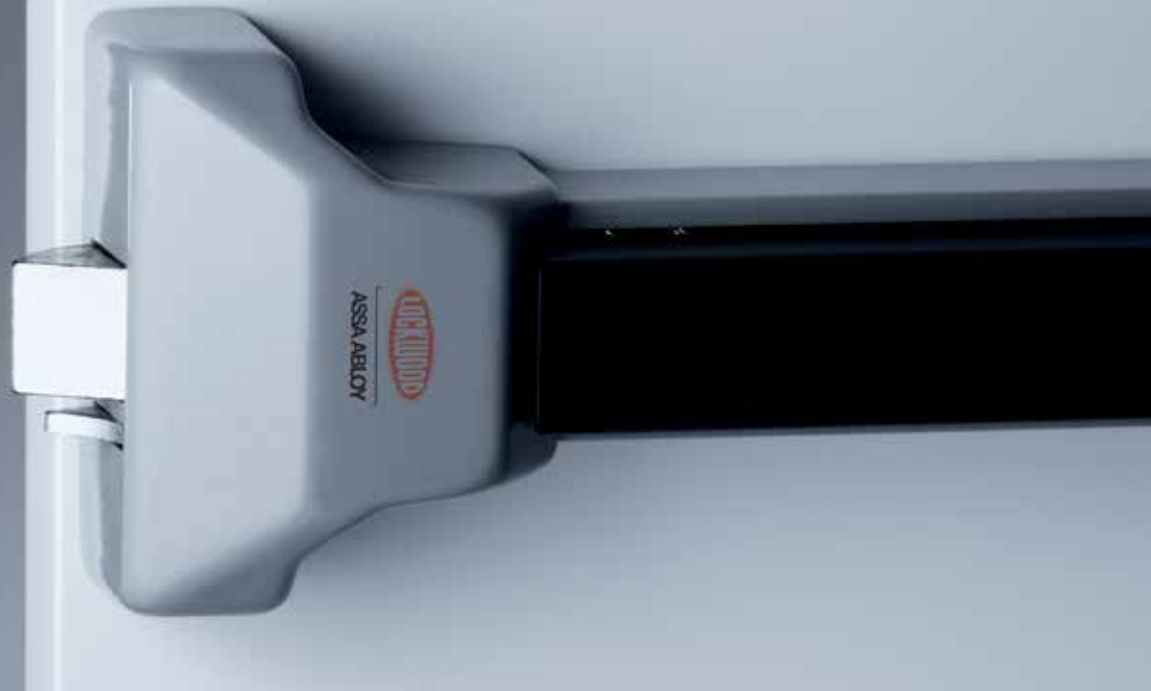

## Description

The Lockwood 9000/9100 Rim Type Panic Exit Device is designed to provide a ready means of escape at all times by the single action of pushing on a horizontal bar fitted across the full width of a door.

## Features and Specifications

Suitable for single and double door applications.

Slim, neat design, surface mounted, dead latching, cylinder key hold-back (dogging), wide selection of furniture, non-handed.

The basic 9000 Series Horizontal Panic Exit Device is suitable for timber, metal and security glass doors with mid rail.

## Product Details

<b>Auxiliary Bolt</b>	Double chrome plated steel
<b>Door Stile</b>	Suitable for both 90° and flush head door stiles minimum head clearance requirement of 30mm.
<b>Door Thickness</b>	<ul style="list-style-type: none"> <li>• Standard 35mm to 45mm</li> <li>• Extended spindle kit for up to 90mm doors</li> <li>• Mortice lock version 32 to 48mm doors specify door thickness when other than standard.</li> </ul>
<b>Finish</b>	Silver Polyester Powdercoat with black touch bar (SIL)
<b>Handing</b>	Non Handed
<b>Latchbolt</b>	Double chrome plated steel
<b>Materials</b>	<ul style="list-style-type: none"> <li>• The body is manufactured of steel</li> <li>• Internal mechanisms made of steel or brass</li> <li>• Main cover made of decorated electroplated steel pressing</li> <li>• Secondary cover made of decorated Zamak</li> <li>• Horizontal bar made of decorated steel</li> <li>• Lever plate operating mechanism is made from electroplated steel pressings with high density zinc alloy cover</li> </ul>
<b>Outside Trims</b>	<ul style="list-style-type: none"> <li>• Key entry with pull plate and key/ lever entry with mechanism safety override</li> <li>• Hold-back (dogging)</li> <li>• Euro cylinder key hold-back available on all types</li> <li>• Hold-back is not an approved function on fire doors</li> </ul>
<b>Product Width</b>	<ul style="list-style-type: none"> <li>• Standard maximum 838mm (to suit 900mm door)</li> <li>• 1141mm (to suit 1200mm door)</li> </ul>

## Standards and Compliance



Fire Rated.

# 9000/9100 Series Rim Type Panic Exit Device

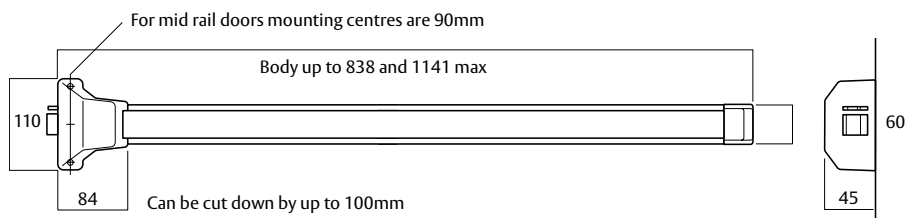

Pack includes double door strike.

## Horizontal Push Bar

Part Number	Description
9000EOSIL	Single point locking to suit 900mm door
9100EOSIL	Single point locking to suit 1200mm door
9000CDEOSIL*	Single point locking with key hold-back (dogging) to suit 900mm door
9100CDEOSIL*	Single point locking with key hold-back (dogging) to suit 1200mm door

\* Order hold-back cylinder separately  
Optional 201-252SC Cylinder for Key Entry (order separately)

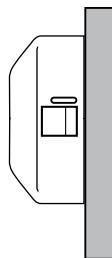

## Horizontal Push Bar Key Entry with Pull Plate

Part Number	Description
9000NLSIL	Single point locking to suit 900mm door
9100NLSIL	Single point locking to suit 1200mm door
9000CDNLSIL*	Single point locking with key hold-back (dogging) to suit 900mm door
9100CDNLSIL*	Single point locking with key hold-back (dogging) to suit 1200mm door

\* Order hold-back cylinder separately.  
Optional 201-252SC Cylinder for Key Entry (order separately)

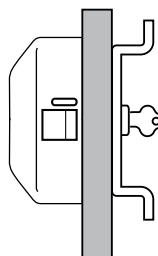

## Horizontal Push Bar

Part Number	Description
9000LASIL	Single point locking to suit 900mm door
9100LASIL	Single point locking to suit 1200mm door
9000CDLASIL*	Single point locking with key hold-back (dogging) to suit 900mm door
9100CDLASIL*	Single point locking with key hold-back (dogging) to suit 1200mm door

\* Order hold-back cylinder separately  
Cylinder 9555-5002SC locks or unlocks lever (order separately)

**Note:** Hold-back is not an approved function on fire doors.

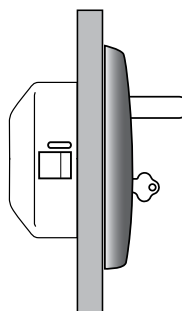

## Standards and Compliance

 Disabled Access

# 9300/9400 Series Vertical Type Panic Exit Device



## Description

The Lockwood 9300/9400 Vertical Type Panic Exit Device is designed to provide a ready means of escape at all times by the single action of pushing on a horizontal bar fitted across the full width of a door.

## Features and Specifications

Slim, neat design, surface mounted, dead latching, automatic top and bottom latches maintaining the bolt drawn in when the door is open, pick resistant bottom latch, cylinder key hold-back (dogging), wide selection of furniture, non-handed.

The basic 9000 Series Horizontal Panic Exit Device is suitable for timber, metal and security glass doors with mid rail.

## Product Details

<b>Auxiliary Bolt</b>	Double chrome plated steel
<b>Door Height</b>	<ul style="list-style-type: none"> <li>Standard maximum height 2300mm (vertical rod version)</li> <li>For doors between 2300 to 3000mm in height, order extension rod kit part no. 9000/50SIL</li> <li>Installed with centre line of exit device at 1023mm above finished floor level</li> </ul>
<b>Door Stile</b>	Suitable for both 90° and flush head door stiles minimum head clearance requirement of 30mm.
<b>Door Thickness</b>	<ul style="list-style-type: none"> <li>Standard 35mm to 45mm</li> <li>Extended spindle kit for up to 90mm doors</li> <li>Mortice lock version 32 to 48mm doors specify door thickness when other than standard.</li> </ul>
<b>Finish</b>	Silver Polyester Powdercoat with black touch bar (SIL)
<b>Handing</b>	All functions are reversible and non-handed except 9500/9600 Series Mortice Lock versions.
<b>Latchbolt</b>	Double chrome plated steel
<b>Materials</b>	<ul style="list-style-type: none"> <li>The body is manufactured of steel</li> <li>Internal mechanisms made of steel or brass</li> <li>Main cover made of decorated electroplated steel pressing</li> <li>Secondary cover made of decorated Zamak</li> <li>Horizontal bar made of decorated steel</li> <li>Lever plate operating mechanism is made from electroplated steel pressings with high density zinc alloy cover</li> </ul>
<b>Product Width</b>	<ul style="list-style-type: none"> <li>Standard maximum 838mm (to suit 900mm door)</li> <li>1141mm (to suit 1200mm door)</li> </ul>

## Standards and Compliance



Fire Rated.

# 9300/9400 Series Vertical Type Panic Exit Device

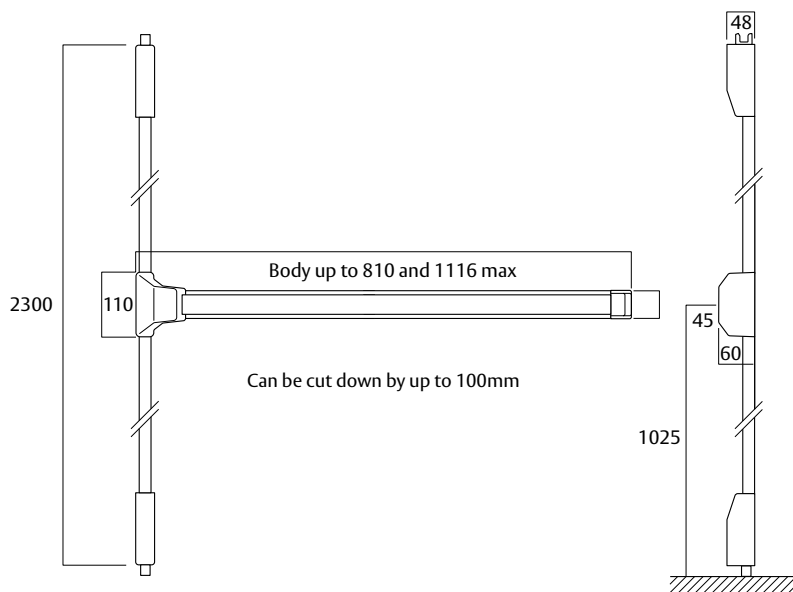

Pack includes standard and flush head top strike.

## Vertical Push Bar

Part Number	Description
9300EOSIL	Two point vertical locking to suit 900mm door
9400EOSIL	Two point vertical locking to suit 1200mm door
9300CDEOSIL*	Two point vertical locking with key hold-back (dogging) to suit 900mm door
9400CDEOSIL*	Two point vertical locking with key hold-back (dogging) to suit 1200mm door

\* Order hold-back cylinder separately

**Note:** Hold-back is not an approved function on fire doors.

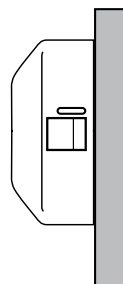

## Vertical Push Bar Key Entry with Lever Plate

Part Number	Description
9300LASIL	Two point vertical locking to suit 900mm door
9400LASIL	Two point vertical locking to suit 1200mm door
9300CDLASIL*	Two point vertical locking with key hold-back (dogging) to suit 900mm door
9400CDLASIL*	Two point vertical locking with key hold-back (dogging) to suit 1200mm door

\* Order hold-back cylinder separately.

Cylinder 9555-502SC Cylinder for Key Entry Lock or Unlock Lever (order separately)

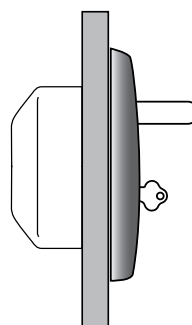

## Standards and Compliance



Disabled Access



# 9500/9600 Series Rim Type Panic Exit Device with Mortice Lock



## Description

The Lockwood 9500/9600 Rim Type Panic Exit Device is specifically designed to be used in conjunction with the Lockwood 3572 High Security Cylinder Mortice Lock and Lockwood 1800/2800 Series Brass Door Furniture.

An additional benefit of this will enable the designer/specifier the convenience to use the same Lockwood brass lever/knob designs that have been selected for the project.

## Operation

Inside: "exit by" rim device operates mortice lock. Outside: "entry by" lever/knob operates mortice lock.

Locking: see cylinders functions opposite. To choose suitable Lockwood Brass Door Furniture, select from the range.

## Keying

### Standard Keying

- Cylinders, if required, are to be ordered separately
- Supplied individually keyed with two keys per lock
- 78,000 key combinations
- Key blank KB2015P

## Product Details

**Auxiliary Bolt** Double chrome plated steel

**Door Stile** Suitable for both 90° and flush head door stiles minimum head clearance requirement of 30mm.

**Door Thickness**

- Standard 35mm to 45mm
- Extended spindle kit for up to 90mm doors
- Mortice lock version 32 to 48mm doors specify door thickness when other than standard.

**Finish** Silver Polyester Powdercoat with black touch bar (SIL)

**Handing** All models are suitable for left handed doors (L/H), each kit contains a conversion kit to change to right hand door (R/H) applications.

**Latchbolt** Double chrome plated steel

**Materials**

- The body is manufactured of steel
- Internal mechanisms made of steel or brass
- Main cover made of decorated electroplated steel pressing
- Secondary cover made of decorated Zamak
- Horizontal bar made of decorated steel
- Lever plate operating mechanism is made from electroplated steel pressings with high density zinc alloy cover

**Outside Trims**

- Key entry, key entry with pull plate and key/lever entry with mechanism safety override
- Hold-back (dogging)
- Euro cylinder key hold-back available on all types
- Hold-back is not an approved function on fire doors

**Product Width**

- Standard maximum 838mm (to suit 900mm door)
- 1141mm (to suit 1200mm door)

## Standards and Compliance



Fire Rated.

## Restricted Special Keying

Lockwood locks can be keyed to a number of controlled and/or specially keyed systems. These range from legally protected keys to protect against unauthorised duplication, which can also include specially designed key systems such as master key systems, which allow for different levels of mechanical access control.

Please refer to section 7 for keying systems or contact your local sales office or customer service for specific information.

# 9500/9600 Series Rim Type Panic Exit Device with Mortice Lock

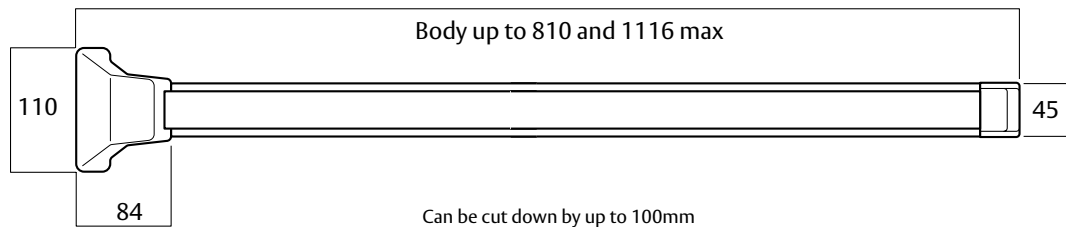

## Horizontal Rim Type Panic Exit Device with Mortice Lock

Part Number	Description
9500MLLSIL	Left hand single point locking to suit 900mm door
9600MLLSIL	Left hand single point locking to suit 1200mm door

### Description

These functions include a panic bar, mortice lock, all mounting brackets and screws. Cylinders, exterior brass furniture not included (order separately).

### Handing

All models are suitable for left hand (L/H) door applications. Each kit contains a kit to convert to right hand (R/H) door applications.

**Note:** Suitable for both single and double door installations of 900 or 1200mm width. When fitting to double doors fit to active leaf and fit either 9300/9400 Series Vertical Rod Exit Device to inactive leaf. For double doors the Lockwood double door strike, 3570-2902 (fire rated) or 3570-4902 (non fire rated) needs to be fitted.

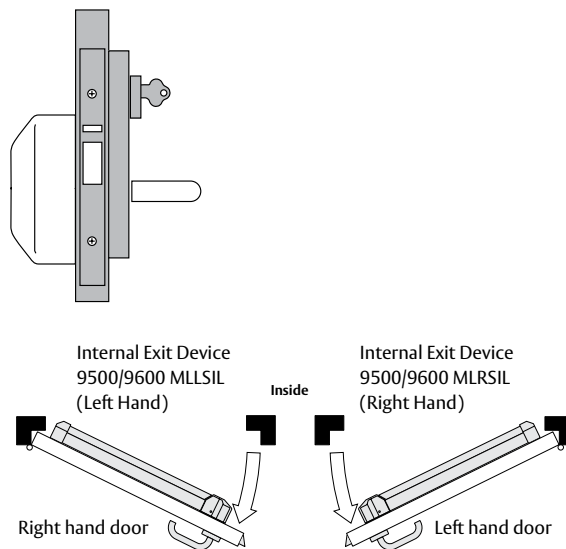

## Cylinder

Part Number	Description
570-2	Outside cylinder "X" key entry retract bolt
572-2	Outside cylinder "Z" locks/unlocks outside handle
9000-2402(RH)	Hold-back cylinder
9000-2402(LH)	Hold-back cylinder

### Description

570 Series Cylinder (order separately) to suit 9500/9600 Series Mortice Locks. The cylinders are suitable for left handed doors. A conversion kit is included to convert to right handed doors.

The following mortice lock oval shaped brass cylinder functions are available

### Plate Furniture Ordering Example

1801/##SC - External Plate with Cylinder Hole.

Select required lever. Refer to section 3 for lever styles and details on the brass plate furniture.

**Note:** Specify finish after part number



# 9500/9600 Series Rim Type Panic Exit Device with Mortice Lock

## Latching Detail Single and Double Door Versions

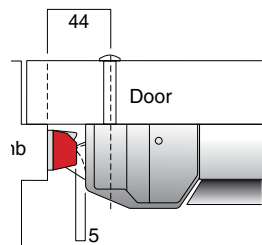

Single door rim type  
9000/90SIL Strike

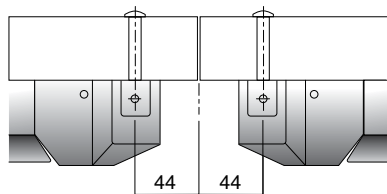

Double door two vertical

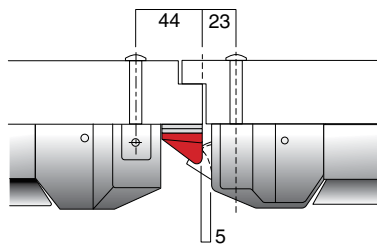

Double door rebated vertical and rim type  
9000/94SIL Strike

## Latching Detail for Vertical Rod Versions

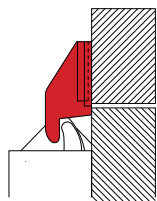

9000/96SIL

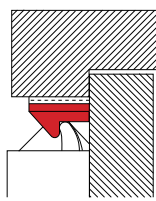

9000/93SIL

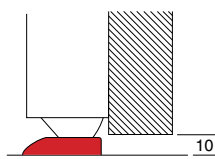

9000/92SIL

## Outside Lever Trim Plates



9000/10SIL Lever Plate  
Safety clutch in outside lever trim plate protects the unit from damage that could otherwise render the device inoperable.

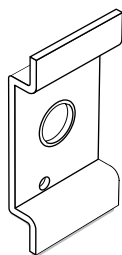

9000/15SIL  
Cylinder Pull Plate

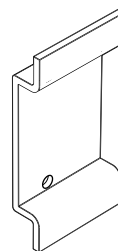

9000/20SIL  
Plain Pull Plate

# 9000 Series Access Control Panic Exit Device

## Applications

Emergency exit doors in establishments open to the public which are locked electrically (hospitals, retirement homes, museums, educational establishments, supermarkets and retail stores).

Emergency exit doors in banks, administration buildings and industrial sites.

Isolated doors or doors functioning autonomously with 'break glass' box and connected to the buildings fire detection system.

## Keying

### Restricted Special Keying

Lockwood locks can be keyed to a number of controlled and/or specially keyed systems. These range from legally protected keys to protect against unauthorised duplication, which can also include specially designed key systems such as master key systems, which allow for different levels of mechanical access control.

### Special Keying

Can be keyed alike, master keyed and grand master keyed in Lockwood high security, V7 and Status 6 keying systems.

## Product Details

<b>Door Thickness</b>	Standard 35 to 45mm doors. Mortice lock version 32 to 48mm doors. Specify door thickness when other than standard.
<b>Finish</b>	Silver Polyester Powdercoat with red touch bar
<b>Voltage</b>	The power supply must be regulated rectified DC voltage. 24Vdc +/- 10%, 145mA

## Standards and Compliance



Fire Rated

**S2**

(Security) Australian Lock Standard (AS4145.2.1993)

**D3**

(Durability) Australian Lock Standard (AS4145.2.1993)



Anti-Corrosion



Electromagnetic compatibility to European CE compliance, the equivalent of C-Tick compliance.

Conforms to Australian Standard BCA D2 -21 (d) for Egress Doors.

# 9000 Series Access Control Panic Exit Device

## Door Control System

Designed to be integrated with building safety and control systems.

## Electronic Security

### Blocking Function (failsafe)

Ensuring exit control by electromechanical locking of the push bar, a solenoid locks the push bar, push bar unlocks on interruption of power supply and reverts to mechanical panic bar ensuring immediate exit.



### Dogging Function (hold-back delayed)

Ensures access control through motorisation of the push bar retracts the bolt for free access for a number of seconds then resets the push bar in blocked position for selective entrance control.

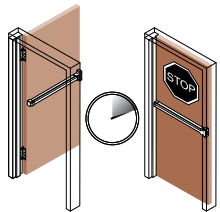

### Dogging Function (hold-back timed)

Ensures access control through motorisation of the push bar and retraction of bolts for permanent free access (e.g. during opening times) or for a defined length of time for selective entrance control.

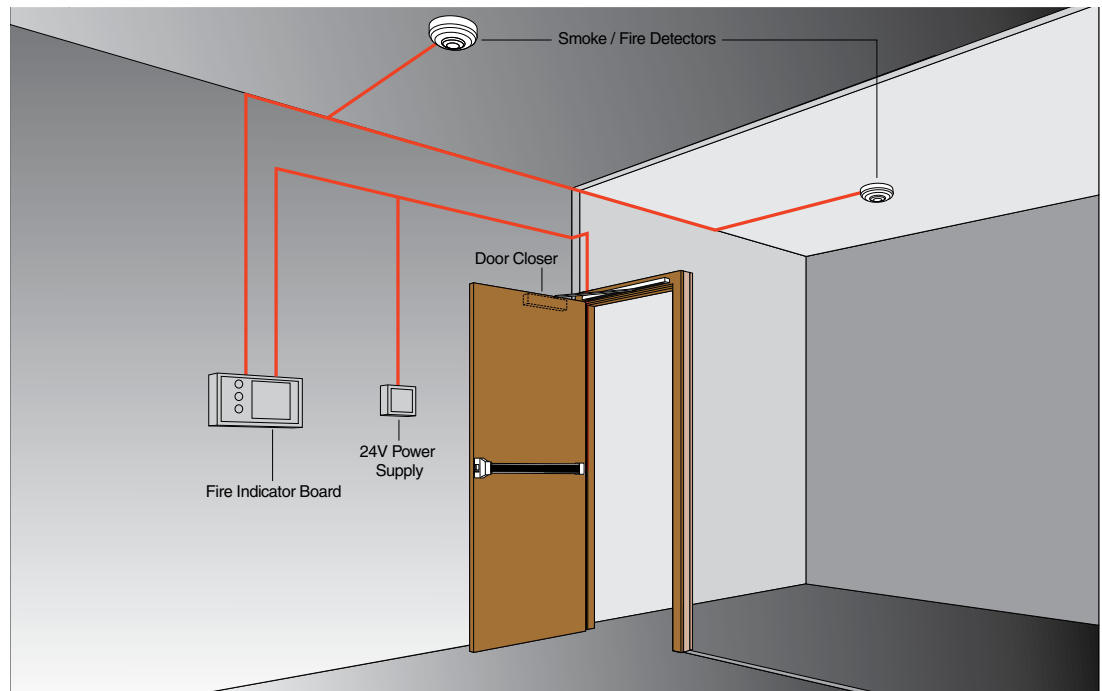
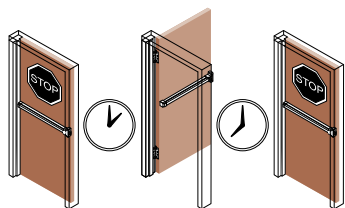

## Monitoring

The dogging versions of the exit bars are equipped with a sensor in the door to provide monitoring on the status of the door opening and closing.

## Central Control

Installation through a central control station enabling total control of vulnerable exit doors is possible, enabling video viewing of all doors, request to exit can be authorised or denied following usual checks at the control centre whilst the building is occupied.

# 9000/9100 Series Electromechanical Rim Type Panic Exit Device



## Description

The Lockwood 9000/9100 Electromechanical Rim Type Panic Exit Device is designed for locking of emergency exits in accordance with BCA Standards D2 -21 (d) for Egress, Fire and Safety Regulations for Public Buildings. Provides a ready means of escape at all times by the single action of pushing on a horizontal bar fitted across the full width of a door.

## Features and Specifications

- Suitable for single and double door applications of 900 or 1200mm width doors.
- 9000/9100 adjustable on site.
- 9700 factory made to order.
- The basic 9000 Series Horizontal Panic Exit Device is suitable for timber, metal and security glass doors with mid rail.
- All functions are reversible and non-handed.
- Deadlatching on all bolts.

## Product Details

<b>Door Width</b>	900mm or 1200mm
<b>Finish</b>	Silver Polyester Powdercoat with red touch bar
<b>Handing</b>	Non Handed

## Standards and Compliance



Fire Rated.

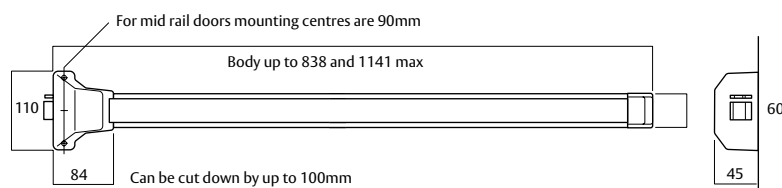

Pack includes double door strike.

# 9000/9100 Series Electromechanical Rim Type Panic Exit Device

## Horizontal Push Bar

**Part Number**      **Description**

**9000EO/24BSIL**      Single point locking, 900mm door 24V

**9100EO/24BSIL**      Single point locking, 1200mm door 24V

### Description

#### Blocking Version (adjustable on site)

Optional 201-252SC Cylinder for Key Entry (order separately)

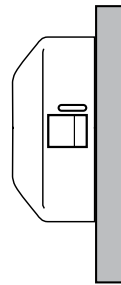

## Standards and Compliance



Fire Rated

## Horizontal Push Bar

**Part Number**      **Description**

**9700EO/24BDMSIL**      Single point locking, 24V

### Description

#### Blocking Dodging Monitoring Version

Door width to be nominated (not approved fire doors)

Optional 201-252SC Cylinder for Key Entry (order separately)

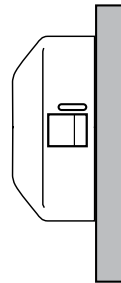

## Outside Lever Trim Plates



**9000/10SIL Lever Plate**  
Safety clutch in outside lever trim plate protects the unit from damage that could otherwise render the device inoperable.

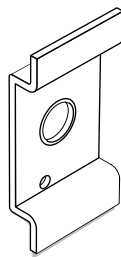

**9000/15SIL**  
Cylinder Pull Plate

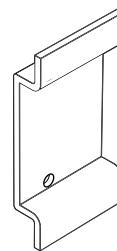

**9000/20SIL**  
Plain Pull Plate

# 9300/9400 Series Electromechanical Vertical Type Panic Exit Device



## Description

The Lockwood 9300/9400 Electromechanical Vertical Type Panic Exit Device is designed for locking of emergency exits in accordance with BCA Standards D2 -21 (d) for Egress, Fire and Safety Regulations for Public Buildings. Provides a ready means of escape at all times by the single action of pushing on a horizontal bar fitted across the full width of a door.

## Features and Specifications

- Suitable for single and double door applications of 900 or 1200mm width doors.
- 9300/9400 adjustable on site.
- 9800 factory made to order.

## Door Height

Standard maximum height up to 2300mm extension to 3000mm.

Installed with centre line of exit device at 1023mm above finished floor level.

The basic 9000 Series Horizontal Panic Exit Device is suitable for timber, metal and security glass doors with mid rail.

All functions are reversible and non-handed.

Deadlatching on all bolts.

## Product Details

<b>Door Height</b>	2300mm (standard) 3000mm (with extension)
<b>Door Stile</b>	Suitable for both 90° and flush head door stiles minimum head clearance requirement of 30mm.
<b>Door Width</b>	900mm or 1200mm
<b>Finish</b>	Silver Polyester Powdercoat with red touch bar.
<b>Handing</b>	Reversible and Non Handed.
<b>Latches</b>	Top - automatic Bottom - automatic, pick resistant

## Standards and Compliance



Fire Rated.

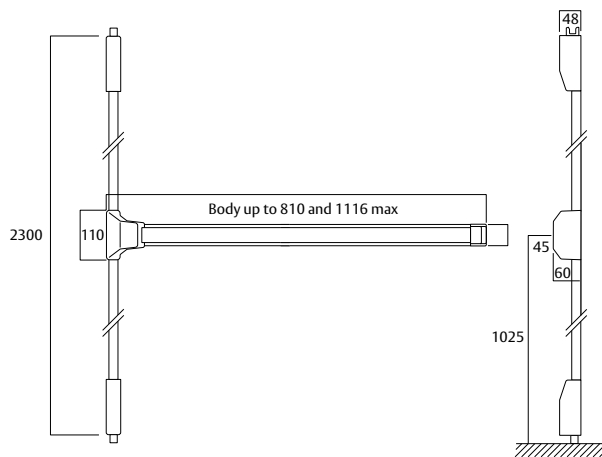

Pack includes standard and flush head top strike.



# 9300/9400 Series Electromechanical Vertical Type Panic Exit Device

## Vertical Push Bar

Part Number	Description
9300EO/24BSIL	2 point locking, 900mm door 24V
9400EO/24BSIL	2 point locking, 1200mm door 24V

### Blocking Function (failsafe)

Ensuring exit control by electromechanical locking of the push bar, a solenoid locks the push bar, push bar unlocks on interruption of power supply and reverts to mechanical panic bar ensuring immediate exit.

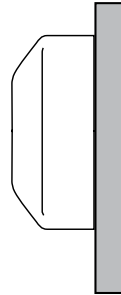

## Standards and Compliance



Fire Rated

### Description

#### Vertical Blocking Version (adjustable on site)

Optional 8219-303SC Cylinder for Key Entry (order separately)

## Vertical Push Bar

Part Number	Description
9800EO/24BDMSIL	2 point locking, 24V

### Dogging Function (hold-back delayed)

Ensures access control through motorisation of the push bar, retracts the bolt for free access for a number of seconds then resets the push bar in blocked position for selective entrance control.

### Dogging Function (hold-back timed)

Ensures access control through motorisation of the push bar and retraction of bolts for permanent free access (e.g. during opening times) or for a defined length of time for selective entrance control.

### Monitoring

The dogging versions of the exit bars are equipped with a sensor in the door to provide monitoring on the status of the door opening and closing.

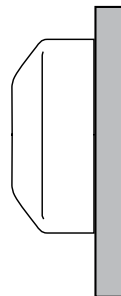

### Description

#### Vertical Blocking Dogging Monitoring Version (not approved for fire doors)

Optional 201-252SC Cylinder for Key Entry (order separately)

# 9300/9400 Series Electromechanical Vertical Type Panic Exit Device

## 9900 Monitored Dummy Push Bars

Part Number	Description
9900MDPSIL	Monitored Dummy Push Bar to suit 900mm doors
9950MDPSIL	Monitored Dummy Push Bar to suit 1050mm doors

## Outside Lever Trim Plates



**9000/10SIL Lever Plate**  
Safety clutch in outside lever trim plate protects the unit from damage that could otherwise render the device inoperable.

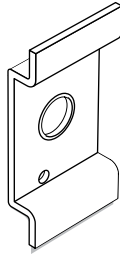



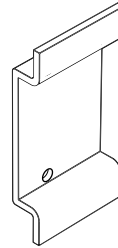



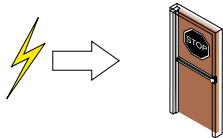
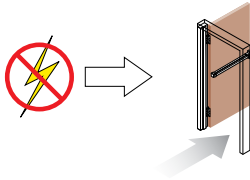

**9000/15SIL**  
Cylinder Pull Plate

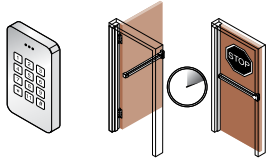

**9000/20SIL**  
Plain Pull Plate

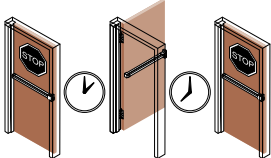
# Panic Exit Devices

Function	Description	Suggested Options
<p><b>Blocking</b> (Fail Safe)</p> <p> <b>Fire Rated</b> In accordance with Australian Standard.</p>	<p>Power "ON" locks push bar no exit</p>  <p>Power "OFF" unlocks push bar for exit</p> 	<p>Fire Detector </p> <p>Break Glass </p> <p>Digital Keypad </p>
<p><b>Dogging</b> (Hold-back delayed)</p> <p>Not approved for fire doors</p>	<p>Bolt retracts, permitting free access for a number of seconds then resets the push bar in blocked position</p>  <p>Includes door monitoring</p>	<p>Digital Keypad </p> <p>Card Reader </p>
<p><b>Dogging</b> (Hold-back timed)</p> <p>Not approved for fire doors</p>	<p>Bolt retracts, permitting permanent free access (e.g. during opening times) or for a defined length of time.</p>  <p>Includes door monitoring</p>	<p>Digital Keypad </p> <p>Card Reader </p>

# 781/791 Series Panic Bolts



## Description

The Lockwood 781/791 Panic (Skeleton) Bolts are designed and packaged specifically for the commercial and residential door market. Each pack contains items necessary for timber door fixing.

## Application

A comprehensive range of panic (skeleton) bolts where a high degree of strength and durability is required, ideally suited to doors where barrel bolts would be inadequate.

Available with both visible and concealed fixing suitable for timber, metal doors and gates in commercial, industrial, institutional and residential buildings, where there is a need for high grade, durable fittings. These bolts are generally installed on the inactive leaf of double doors or doors where there is no need for primary egress.

## Description

Single action bolt with positive locking into keeper at the top or bottom of the door. When fixed to the door the bolt is supported by a high grade stainless steel spring which holds the bolt in the locked position.

## Product Details

**Bolt Throw** The distance the bolt moves from the fully retracted position to the fully locked position. Standard throw is 50 mm.

**Bolt Material** Highest grade brass material.

**Finish** Satin Chrome Plate (SC)

**Fixing** Available in both visible and concealed fixing with 6 point fixing up to 1000 mm in length. Concealed fixing is ideal for an installation where a more aesthetic appearance is required. Sufficient screws are supplied with all bolts. Each bolt is supplied with a floor plate and top guide. These can also be purchased as spare parts.

**Lengths**

- 230mm
- 300mm
- 450mm
- 600mm
- 1000mm

**Offset Bolt** Available in the following lengths: 450 mm and 600 mm (visible fix only)

## Standards and Compliance

**S2** (Security) Australian Lock Standard (AS4145.2.1993)

**D3** (Durability) Australian Lock Standard (AS4145.2.1993)

# 781/791 Series Panic Bolts

## 781 Concealed Fix Panic Bolt

**Description** Concealed Fix Panic Bolt with Standard 50mm Throw

**Bolt Length** 230mm, 300mm, 450mm, 600mm, 1000mm

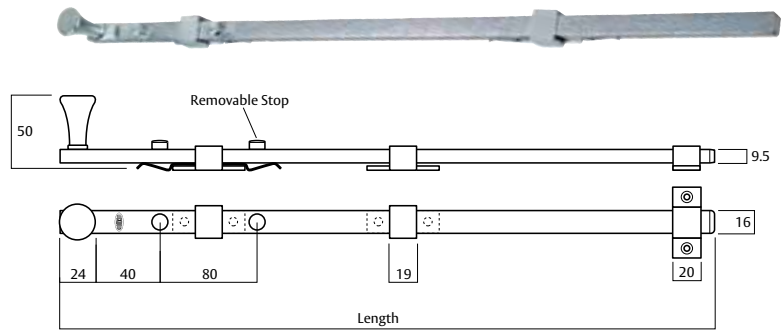

## 791 Visible Fix Panic Bolt

**Description** Visible Fixing Panic Bolt with Standard 50mm Throw

**Bolt Length** 230mm, 300mm, 450mm, 600mm, 1000mm

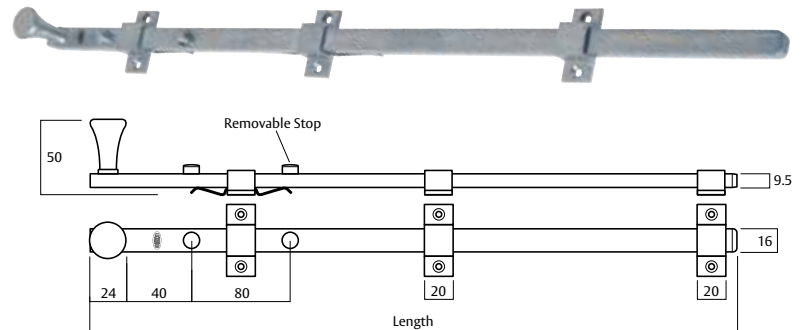

## 791 Visible Fix Offset Skeleton Bolt

**Description** Visible Fixing Panic Bolt with Standard 50mm Throw

**Bolt Length** 450mm, 600mm

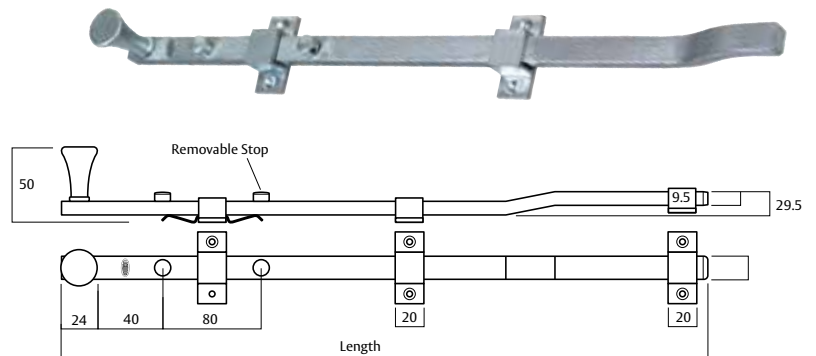

Retracted position Fully locked position

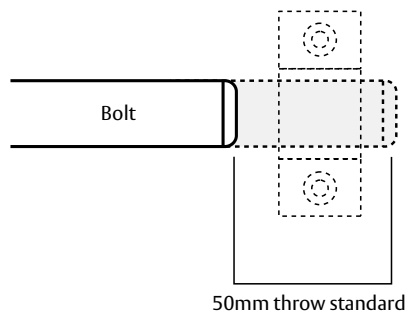

# Ordering Procedure

## Ordering Procedure

Bolt Type	Offset Skeleton Bolt	Bolt Length	Finish
791	O/S	230	SC

Keying System		Bolt Length	
Concealed Fix Bolt	781	mm	230
Visual Fix Bolt	791	mm	300
		mm	450
		mm	600
		mm	1000
Keying System		Finish	
Twin	T1	Satin Chrome	SC
6 pin Master Key	6MK		
6 Pin Keyed Alike	6KA		
6 Pin Keyed to Differ	6KD		



**ASSA ABLOY**

**Lockwood** is the leading brand in the Australian locking industry. With an established reputation for high quality products, this iconic brand provides a wide range of locking solutions to residential housing, commercial building and industrial application markets. Lockwood is supported by an extensive distribution and after-sales support network. Our customers include retailers, architects, trade and industrial personnel, locksmiths and security dealers.

**ASSA ABLOY** is the global leader in door opening solutions, dedicated to satisfying end-user needs for security, safety and convenience.

**ASSA ABLOY** is represented in all major regions, in both mature and emerging markets, with leading positions in Australia, Europe and North America.

**25YEAR  
MECHANICAL  
WARRANTY**

### **The Lockwood 25 Year Mechanical Warranty**

Our belief that we manufacture the finest premium products available in today's market place is backed by the Lockwood 25 Year Mechanical Warranty, ensuring that Lockwood continues to keep Australians safe by delivering security and peace of mind.

For warranty terms and conditions, please visit [www.lockweb.com.au](http://www.lockweb.com.au) or call **1300WARRANTY**

**ASSA ABLOY Australia Pty Ltd**  
235 Huntingdale Road  
Oakleigh, Victoria, 3166  
Australia

**1300 LOCK UP (1300 562 587)**  
[lockweb.com.au](http://lockweb.com.au)

**ASSA ABLOY New Zealand Ltd**  
6 Armstrong Road  
Albany, Auckland, 0632  
New Zealand

**[info.nz@assaabloy.com](mailto:info.nz@assaabloy.com)**  
**Telephone +64 9415 7111**  
**[assaabloy.co.nz](http://assaabloy.co.nz)**

#### **Disclaimer**

Whilst every effort has been made to ensure that the information contained in this brochure is accurate at the time of publication, ASSA ABLOY Australia Pty Limited ("ASSA ABLOY") recommends that you consult ASSA ABLOY or its agents prior to placing an order to ascertain current information on specific products, as ASSA ABLOY reserves the right to make any changes without notice. ASSA ABLOY will not be liable for any injury, loss or damage whatsoever, arising from any errors or omissions in the information contained in the brochure or arising from the use or application of the information contained herein.

