

## Fitting guide for AirFit P10 for AirMini



- Align your left (L) and right (R) pillows with your left and right nostrils.



- Pull the headgear straps over your head. Your lower headgear strap should sit comfortably at the back of your head. The top strap should sit comfortably on your crown.



- To achieve a comfortable fit, adjust the headgear straps. For a looser fit, spread the upper and lower straps apart. To tighten, draw them closer together.

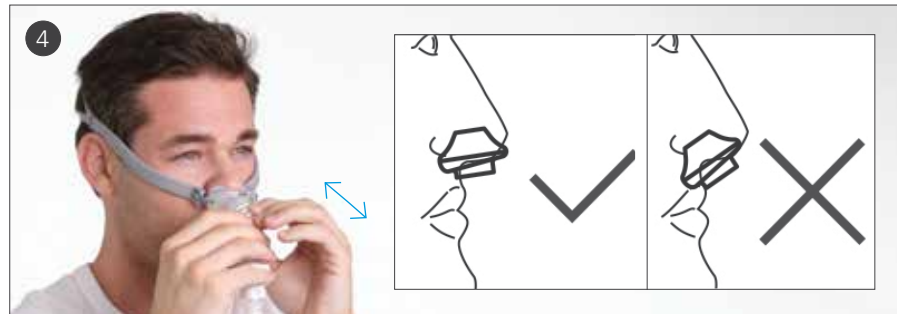

- To ensure a comfortable fit, briefly pull your mask away from your nose and reseat the pillows.
- Ensure the nasal pillows fit securely into your nostrils with both pillows positioned upright.



- Your mask is now fitted and ready to use. When the device is running, a light breeze should be felt near the venting area around the tube connection.

## Inserting HumidX or HumidX Plus



- To insert your waterless humidifier, simply open your vent module with a twist.



- Insert your choice of humidifier: HumidX or HumidX Plus. It's recommended to begin therapy with HumidX and switch to HumidX Plus if necessary.



- Reassemble your module with another twist.

**Note:** For complete user instructions, refer to the AirFit P10 for AirMini User Guide.



## A simple and easy design

AirFit P10 for AirMini™ offers an expanded feature-set – combining the pocket-sized portability and the new HumidX™ waterless humidification of ResMed's AirMini Solution with the comfort and visual freedom of the existing AirFit P10 mask design.

Available exclusively with AirMini, AirFit P10 for AirMini helps deliver compact, travel-friendly therapy – for patients who want to enjoy the benefits of therapy wherever they go.



# The legacy of AirFit P10

Designed to be 50%<sup>1</sup> quieter and 50% lighter than ResMed's most popular mask at the time, itself the winner of a 2014 reddot award, the AirFit P10 has grown to be one of our most celebrated mask products. A clinical study found that 79% of patients who were using the AirFit P10 after 2 weeks were still using therapy after 8 months.<sup>2</sup> On average, patients slept more than 40 minutes longer per night using the AirFit P10.<sup>1</sup>

With its elegant design and popularity, it was ideally positioned to be redesigned and updated – as the ultimate companion mask for the new portable AirMini travel system.

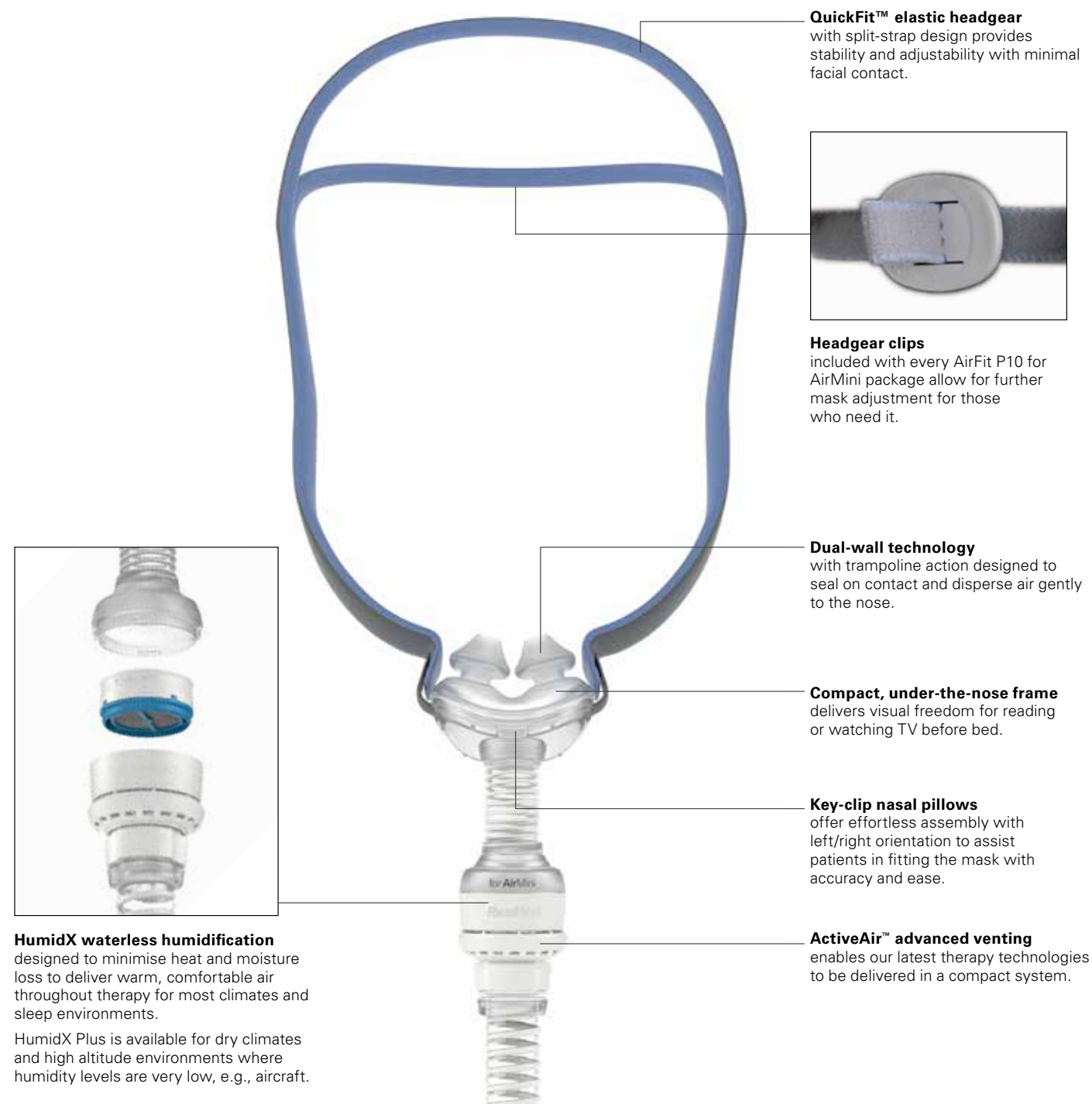

**QuickFit™ elastic headgear** with split-strap design provides stability and adjustability with minimal facial contact.

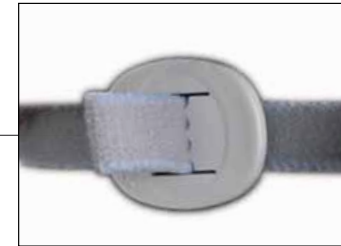

**Headgear clips** included with every AirFit P10 for AirMini package allow for further mask adjustment for those who need it.

**Dual-wall technology** with trampoline action designed to seal on contact and disperse air gently to the nose.

**Compact, under-the-nose frame** delivers visual freedom for reading or watching TV before bed.

**Key-clip nasal pillows** offer effortless assembly with left/right orientation to assist patients in fitting the mask with accuracy and ease.

**ActiveAir™ advanced venting** enables our latest therapy technologies to be delivered in a compact system.

**HumidX waterless humidification** designed to minimise heat and moisture loss to deliver warm, comfortable air throughout therapy for most climates and sleep environments.

HumidX Plus is available for dry climates and high altitude environments where humidity levels are very low, e.g., aircraft.

# Designed for easy fitting, cleaning and assembly

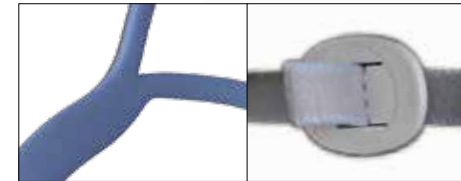

QuickFit elastic headgear	AirFit P10 headgear clip(s)
<b>62935</b>	<b>62962</b> (1 pk of 2 clips)
<b>62936</b> (for Her)	<b>62965</b> (10 pk of 2 clips)



HumidX	HumidX Plus
<b>38846</b> (1 pk)	<b>38847</b> (1 pk)
<b>38809</b> (3 pk)	<b>38812</b> (3 pk)
<b>38810</b> (6 pk)	<b>38813</b> (6 pk)
<b>38808</b> (50 pk)	<b>38811</b> (50 pk)



**Pillows**

<b>62930 (XS)</b> Extra Small
<b>62931 (S)</b> Small
<b>62932 (M)</b> Medium
<b>62933 (L)</b> Large

## Product codes

AirFit P10 for AirMini Mask Pack: - AirFit P10 for AirMini mask x1 - HumidX x1 - HumidX Plus x1 - AirMini Tube x1	<b>38824</b>
P10 Connector for AirMini	<b>38845</b>

<sup>1</sup> ResMed internal clinical study comparing AirFit P10 to Swift™ FX.

<sup>2</sup> Al. Wimmers, K. Hall, C. Ziegenbein, H. Woehrle - Increase in the number of patients remaining on CPAP therapy. ResMed White Paper, ResMed Science Centre, ResMed, Munich, Germany.

**AirFit™ P10**  
for AirMini