

**PRINTRONIX®**  
AUTO ID

# T4000

COMPACT THERMAL PRINTER

**PRODUCTIVITY**

**ADAPTABILITY**

**DEPENDABILITY**





T4000



T4000

## Small, Fast and Ready to Boost Productivity

The T4000 is our most compact and affordable industrial printer with the ability to print 5,000 labels a day at speeds of up to 8 inches per second. If you're looking to improve productivity...look no further. The T4000 includes Printronix System Architecture (PSA), with multiple connectivity options, remote printer management tools and automated alerts to keep your enterprise, operating at optimum efficiency and productivity.



### ENTERPRISE-LEVEL PRODUCTIVITY

- Industry-leading print speed of 8 ips
- Easily prints 5,000 labels a day in demanding environments
- Compatible with PrintNet Enterprise, printer management tool
- Fast ARM Cortex A-7 processor
- Automated alerts keep your enterprise efficient and productive
- Uptime is maximized with 450m ribbons and 8" label roll capacity



### ADAPTABLE FEATURES

- Extensive standard connectivity: Ethernet, USB Host, USB device, serial
- Optional connectivity: Enterprise level WiFi: 802.11 a/b/g/n/ac, Bluetooth 4.2
- Enterprise-level WiFi encryption and security protocols
- 9 printer emulations for seamless integrations
- Compact size makes it a good fit for multiple industries



### DEPENDABLE DESIGN

- Rugged metal enclosure with bifold side panel
- Built on Printronix System Architecture (PSA) Platform for proven dependability
- Proprietary printhead algorithms deliver high-quality barcodes
- Large LCD color screen and easy-to-use control panel
- High MTBF of up to 12,000hrs
- Wide operating temperature range from 0°C to 40°C

## KEY FEATURES

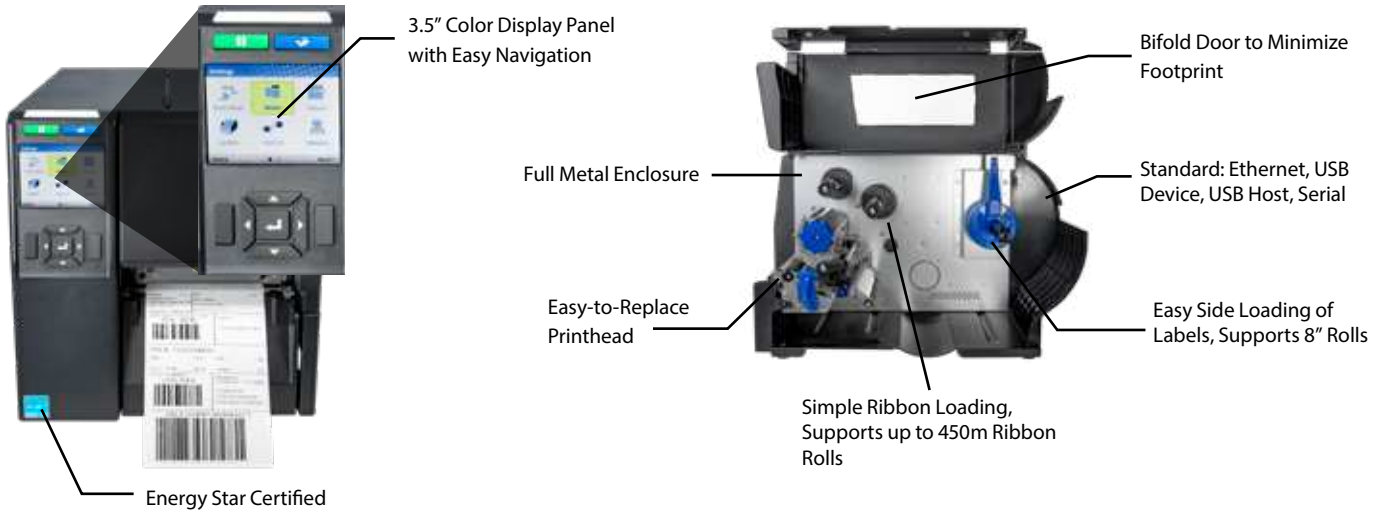

### WHAT DOES ENTERPRISE-LEVEL PRODUCTIVITY MEAN?

- The printer includes the tools to install, configure and troubleshoot multiple printers at once
- Printers are fast and reliable for maximum productivity
- The time required to perform day-to-day tasks has been minimized
- Includes multiple connectivity options and advanced security protocols





**PSA**  
Printronix  
System Architecture

**NOW INCLUDED!**





PSA is an intelligent design platform that combines advanced features with a common set of building blocks to simplify printer installation, operation, and improve productivity. Partners familiar with one Printronix printer can easily work with any of our printers.

## ENTERPRISE PRODUCTIVITY

### EASE OF INSTALLATION

-  Drop-in installation with minimal setup & multiple emulations
-  Easy to configure control panel or with interactive webpage
-  Full suite of connectivity options & security protocols

### EASE OF MAINTENANCE

-  Remotely troubleshoot & monitor printer status
-  Push firmware & re-configure printers in batches
-  Easy printer swap with quick change memory card (QCMC)
-  Commonality of operation between all Printronix printers

### RELIABLE LABEL PRODUCTION

-  Easy to use large color LCD display with intuitive icon-driven menu
- Fast print speed and time-to-first-print
- More uptime with easy load media and large ribbon rolls
- Dependable production up to 5,000 labels per day

# T4000 Industrial Thermal Printer



## PRODUCT BENEFITS

- \* High performance ARM Cortex-A7
- \* 128MB RAM/ 128MB Flash Memory
- \* Printronix System Architecture (PSA)
- \* Color 3.5in LCD nine-key control panel
- \* Four-inch print width
- \* 203 DPI or 300 DPI
- \* Transfer and Direct Printing
- \* Ethernet 10/100 BaseT (Standard)
- \* Steel Frame Enclosure
- \* Bifold Media Door
- \* WiFi 802.11 a/b/g/n/ac (Option)
- \* Bluetooth 4.2 (Option)
- \* 4-32 GB SD memory card capability
- \* Andale & Premium Asian Fonts (Option)
- \* ENERGY STAR Certified

## PRINTER SPECIFICATIONS

Max. Print Speed	8 IPS @ 203 DPI, 6IPS @ 300 DPI
Print Method	Transfer and Direct
Resolution	203 DPI / 300 DPI
Max. Print Width	4.1" (104mm)

## MEDIA SPECIFICATIONS

Media Type	Roll or Fan-Fold Labels, Tags, Paper, Film, Tickets
Min. Media Width	1.0" (25.4mm)
Max. Media Width	4.72" (120mm)
Min. Media Length	Continuous 0.25", Tear-Off / Peel-Off 1.0"
Max. Media Length	Up to 50"
Media Thickness	0.00236" (0.06mm) to 0.011" (0.279mm)
Media Roll Core Diameter	3.0" (76.2mm)
Max. Media Roll Diameter	8.0" (203mm)
Media Sensing	Gap, Mark

## RIBBON SPECIFICATIONS

Ribbon Type	Wax, Wax/Resin, Resin
Min. Ribbon Width	1.6" (40mm)
Max. Ribbon Width	4.33" (110mm)
Max. Ribbon Length	450 Meters
Ribbon Core Diameter	1.0in

## PHYSICAL CHARACTERISTICS

Width	10.40" (264mm)
Height	10.9"(276mm)
Depth	17.9"(455mm)
Printer Weight	22 lbs.(10Kg)
Shipping Weight	28 lbs.(13Kg)

## PRINTER LANGUAGE

Printer Languages (Native / Competitor)	PGL/ZGL/TGL/IGL/STGL/DGL/IEGL/MGL/EGL
API's	XML
Legacy Line Printer Emulations	VGL (Code V), P-Series / XQ, Epson FX, Serial Matrix, Proprinter
Job Control Languages	PJL, PTX-SETUP

## COMMUNICATION AND CONNECTIVITY/INTERFACE

Standard Interface I/O	Serial RS232, USB Device (Type B), USB Host (Type A) and Ethernet 10/100Base T
Optional Interface I/O	WiFi (802.11a/b/g/n/ac), (WiFi Alliance Certified) Bluetooth 4.2
WiFi Security Encryption	WEP 40/128bit, TKIP, AES CCMP
WiFi Security Authentication	WPA/WPA2 PSK, EAP-TTLS, EAP-PEAP, LEAP, PEAPv1/PEAP-TLS, PEAPv0/MS-CHAPv2

## OPERATING ENVIRONMENT

Operating Temperature	32 to 104°F (0 to 40°C)
Operating Humidity	25-85% Non-Condensing
Storage Temperature	-40 to 140°F (-40 to +60°C)
Storage Humidity	10 - 90% Non-Condensing

## MEDIA HANDLING MODES

Standard	Continuous, Tear-Off
Optional	Peel/Rewind (paper labels, 6ips, rewinds liner from 8in roll) Cutter (thickness as per media spec, life 500,000 cuts)

## POWER REQUIREMENT

Line Input	Auto Range 100 - 240 VAC (48 - 62 Hz)
------------	---------------------------------------

## REGULATORY COMPLIANCES

Emissions	FCC, CE, IC, CCC, KC
Safety	cTUVus, CE, IC, EAC, SMARK, NOM, CCC, KC, BIS, BSMI
Environmental	RoHS, WEEE, Energy Star
WiFi/BT	FFC, IC, CE, CCC
Energy Savings	Energy Star 2.0

## BAR CODE SYMBOLOGIES

1D Barcodes	BC-412, Code 11, Code 39, Code35, Code 93, Codabar, Code 128 Subsets A/B/C, Industrial 2 of 5, Interleave 2 of 5, German 1-2/5, EAN-8, EAN-13, UCC/EAN-128, UPC-A, UPC-E, UPCSHP, UPS 11, MSI, Matrix 2 of 5, PLESSEY, POSTNET, 4-state PostBar, Australian 4-state, FIM, ITF14, TELEPEN, PLANET, USPS Intelligent Mail, LOGMARS
2D Barcodes	PDF-417, MicroPDF-417, Maxicode, DataMatrix, QR Codes, Aztec, GS1 Databar (RSS-14)

## FONT, GRAPHIC SUPPORT

Graphic Formats	PCX, TIFF, BMP, PNG
Font Technologies	Intellifont, TrueType, Unicode
Standard Fonts	OCRA, OCRB, Courier, Letter Gothic, CG Times, CG Triumvirate/Bold/Condensed
Premium Asian Fonts (SD card)	Simplified Chinese, Japanese, Korean, Thai

## REMOTE MANAGEMENT SOFTWARE

PrintNet Enterprise	Enterprise Grade Remote Management Solution
---------------------	---

## OPTIONS AND ACCESSORIES

- \* WiFi 802.11 a/b/g/n/ac
- \* Bluetooth 4.2
- \* Cutter
- \* Peel/Rewind
- \* Andale Asian Font Cards (SD Card)
- \* Premium Asian Font Cards (SD Card)
- \* QCMC (Quick Change Memory Card) (SD-Card)



[printronixautoid.com](http://printronixautoid.com)



© 2019 Printronix Auto ID, Inc. All rights reserved. Printronix Auto ID and all product names, numbers and logos are trademarks or registered trademarks of Printronix, Inc. Product appearance and/or specifications are subject to change without notice. Windows® is a registered trademark of Microsoft Corporation™ in the United States and other countries. All other trademarks, product names and company names and logos herein, are the property of their respective owners. (9/19)