



# MINI SLASHA OPERATORS MANUAL

PM-000054-G

# 1 TO THE PURCHASER

Congratulations on the purchase of your new DIGGA Mini Slasher! This product was carefully designed and manufactured to give you years of dependable service. To keep it running efficiently please read the instructions in the manual to keep it in top working condition.

Be sure to observe all safety precautions and maintenance procedures as described in this manual.

No responsibility will be taken by Digga for any omissions or errors in this manual as all data is correct at time of print, however Digga reserve the right to revise this manual without further notice.

The Mini Slasher has multifit mounting. Please contact your DIGGA dealer for any further information pertaining to this product or for further information on other Digga products.

## ABOUT THIS MANUAL

This manual has been designed to help you do a better, safer job. **Read this manual carefully and become familiar with its contents.** Remember; never let anyone operate this unit without reading the "Safety Precautions" and "Operating Instructions" sections of this manual. Unless noted otherwise, right and left sides are determined from the position of the operator when behind the product facing forward.

<b>DIGGA</b>	<b>CE</b>
www.digga.com	
<b>Model</b>	<input type="text"/>
<b>Serial No.</b>	<input type="text"/>
<b>Flow (max)</b>	<input type="text"/>
<b>Pressure (max)</b>	<input type="text"/>
<b>Power</b>	<input type="text"/>
<b>Weight</b>	<input type="text"/>
<input type="checkbox"/> Approximate Oil Capacity: <input type="text"/>	

DE-2001188 MADE IN AUSTRALIA

Your Digga Mini Slasher is a user non serviceable part. Unauthorised disassembly will void warranty. All service and warranty must be performed by an authorised DIGGA service agent. Contact your local Digga dealer for details. To facilitate warranty or service, record the model and serial number of your unit in the space provided on this page. This information may be obtained from the identification plate located on the product.

**IMPORTANT: WHEN SERVICING OR ASSEMBLING YOUR PRODUCT, REMEMBER TO USE ONLY GENUINE DIGGA REPLACEMENT PARTS. SUBSTITUTE PARTS MAY NOT MEET THE STANDARDS REQUIRED FOR SAFE, DEPENDABLE OPERATION. USE OF NON GENUINE DIGGA PARTS WILL VOID WARRANTY AND DIGGA WILL ACCEPT NO LIABILITY WHAT SO EVER FOR CONSEQUENTIAL OR SPECIAL DAMAGES.**

MODEL \_\_\_\_\_

SERIAL NUMBER \_\_\_\_\_

DATE PURCHASED \_\_\_\_\_

The parts department needs this information to insure accurate parts can be sent to the authorised service agent.

## 2 TABLE OF CONTENTS

	PAGE
1 TO THE PURCHASER	3
2 TABLE OF CONTENTS	4
3 PREPARATIONFOR USE	5
4 SAFETY PRECAUTIONS - GENERAL INFORMATION	6
5 SAFETY WORKING WITH THE ATTACHMENT	11
6 INSTALLATION AND OPERATING INSTRUCTIONS	12
7 SPARE PARTS	16
8 MAINTENANCE	18
9 SAFETY STICKER LOCATION	20
10 TROUBLESHOOTING	22
11 TECHNICAL SPECIFICATIONS	23
12 WARRANTY	24

### MODELS COVERED IN THIS MANUAL

MINI SLASHA STANDARD MODEL			MINI SLASHA EXCAVATOR MODEL		
ML-00242	ML-000358	ML-000354	ML-000325	ML-000357	ML-000355

### 3 PREPARATION FOR USE

To avoid any inconvenience before operation, please check that you have received the following items which you may have ordered. Items may differ depending on the type of machine your Mini Slasher is to be fitted to:

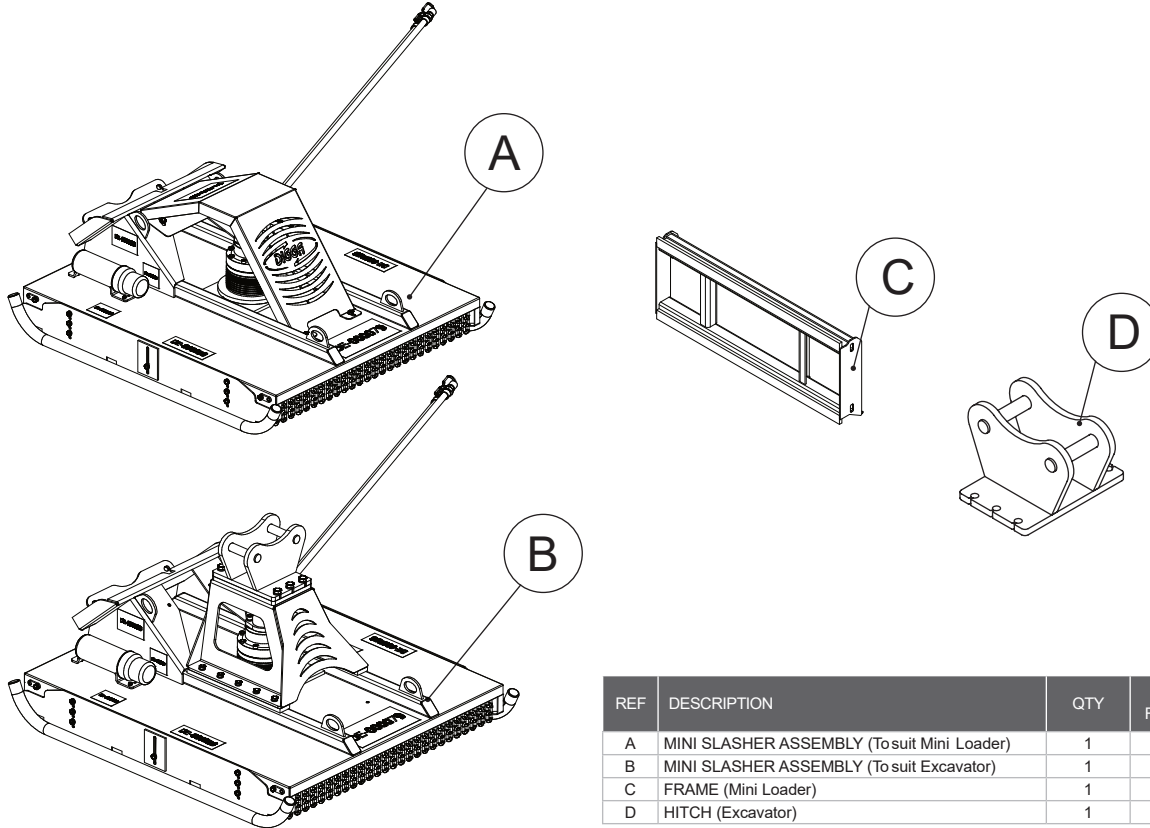

REF	DESCRIPTION	QTY	STD FRAME	EXC HITCH
A	MINI SLASHER ASSEMBLY (To suit Mini Loader)	1	•	•
B	MINI SLASHER ASSEMBLY (To suit Excavator)	1	•	•
C	FRAME (Mini Loader)	1	•	NA
D	HITCH (Excavator)	1	NA	•

## 4 SAFETY PRECAUTIONS - GENERAL INFORMATION

**TAKE NOTE! THIS SAFETY ALERT SYMBOL FOUND THROUGHOUT THIS MANUAL IS USED TO CALL YOUR ATTENTION TO INSTRUCTIONS INVOLVING YOUR PERSONAL SAFETY OR OTHERS. FAILURE TO FOLLOW THESE INSTRUCTIONS CAN RESULT IN INJURY OR DEATH.**

**THIS SYMBOL MEANS:**



**ATTENTION!  
BECOME ALERT!  
YOUR SAFETY IS INVOLVED!**

**SIGNAL WORDS:** Note the use of signal words DANGER, WARNING, and CAUTION with the safety messages. The appropriate signal word for each has been selected using the following guidelines:

**DANGER:** Indicates an imminently hazardous situation, which if not avoided, will result in death or serious injury. This signal word is to be limited to the most extreme situations, typically for machine components which, for functional purposes, cannot be guarded.

**WARNING:** Indicates a potentially hazardous situation, which if not avoided, could result in death or serious injury, and includes hazards that are exposed when guards are removed. It may also be used to alert against unsafe practices and indicate potential failure or damage to equipment.

**CAUTION:** Indicates a potentially hazardous situation, which if not avoided, may result in minor or moderate injury. It may also be used to alert against unsafe practices.

This section is composed of various warnings and safety tips. **Read and learn all the information in this section before you attempt to use your attachment.** Also read your machines owner's manual before using your equipment. This knowledge will help you operate your unit safely. **Do not take this information lightly, it is presented for your benefit and for the benefit of others working around you.**

The "Safety Alert Symbol"  will be used throughout this manual. It will appear with the word **DANGER**, **WARNING**, or **CAUTION**, and a safety message pertaining to the specific topic being covered. Take the time to read these messages as you come across them.

## 4 SAFETY PRECAUTIONS - GENERAL INFORMATION

### WARNING



#### KNOW WHERE UTILITIES ARE

Observe overhead electrical and other utility lines. Be sure equipment will clear them. When digging, call DIAL BEFORE YOU DIG ON 1100 (in Australia), or your local UTILITIES location service provider for location of buried utility lines, gas, water, and sewer, as well as any other hazard you may encounter.

#### EXPOSURE TO RESPIRABLE CRYSTALLINE SILICA DUST ALONG WITH OTHER HAZARDOUS DUSTS MAY CAUSE SERIOUS OR FATAL RESPIRATORY DISEASE.

It is recommended to use dust suppression, dust collection and if necessary personal protective equipment during the operation of any attachment that may cause high levels of dust.

### WARNING



#### REMOVE PAINT BEFORE WELDING OR HEATING

Hazardous fumes/dust can be generated when paint is heated by welding, soldering or using a torch. Do all work outside or in a well ventilated area and dispose of paint and solvent properly. Remove paint before welding or heating. When sanding or grinding paint, avoid breathing the dust. Wear an approved respirator. If you use solvent or paint stripper, remove stripper with soap and water before welding. Remove solvent or paint stripper containers and other flammable material from area. Allow fumes to disperse at least 15 minutes before welding or heating.

### WARNING



#### END OF LIFE DISPOSAL

At the completion of the useful life of the unit, drain all fluids and dismantle by separating the different materials (rubber, steel, plastic, etc.). Follow all federal, state and local regulations for recycling and disposal of the fluid and components.

#### OPERATING THE MINI SLASHER

### WARNING



- An operator must not use drugs or alcohol, which can change his or her alertness or coordination. An operator taking prescription or over-the-counter drugs should seek medical advice on whether or not he or she can safely operate equipment.
- All bystanders should be kept a minimum of 15 meters (50 feet) away from the working area of the Slasher.
- Do not allow Site workers to climb or ride on Slasher at any time, including while stationary, in operation or being moved.
- Operate only from the operator's station.
- Avoid steep hillside operation which could cause the machine to overturn. Consult your machines operator's and safety manuals for maximum incline allowable.
- Flow and pressure gauges, fittings, and hoses must have a continuous operating pressure rating of at least 25% higher than highest pressures of the system.

## 4 SAFETY PRECAUTIONS - GENERAL INFORMATION

### WARNING



### OPERATING THE SLASHER (CONTINUED)

- Reduce speed when driving over rough terrain, on a slope, or turning, to avoid overturning the vehicle.
- Travel only with the Slasher in a safe transport position to prevent uncontrolled movement. Drive slowly over rough ground and on slopes.
- Do not drive close to ditches, excavations, etc., cave in could result.
- Before exiting the machine, lower the attachment to the ground, apply the parking brakes, turn off the prime mover's engine, and remove the key.
- Do not smoke when refueling the prime mover. Allow room in the fuel tank for expansion. Wipe up any spilled fuel. Secure cap tightly when done.
- Remove the Slasher from the prime mover before transporting to and from the job site.

### WARNING



- The Slasher must be stopped before making adjustments to the attachment.
- All Slashing operations must be stopped in the event of local thunderstorm, or lightning activity. During operation, weather conditions shall be monitored: operations shall cease during electrical storms or when electrical storms are imminent.
- Slasher shall be used only for their designed intent and shall not be loaded beyond their rated capacity. Overloading or exceeding the manufacturers specifications will void all warranty.

### STORAGE OF THE SLASHER

### WARNING



- Seal hydraulic couplers from contaminants and secure all hydraulic hoses off the ground to help prevent damage.
- Clean the unit thoroughly, removing all mud, dirt, and grease.
- Inspect for visible signs of wear, breakage, or damage. Order any parts required and make the necessary repairs to avoid delays upon removal from storage.
- Tighten loose nuts and cap screws.
- Replace decals that are damaged or in unreadable condition.
- Store unit in a dry and protected place. Leaving the unit outside will materially shorten its life.

## 4 SAFETY PRECAUTIONS - GENERAL INFORMATION

### WARNING



#### GROUND PERSONNEL AND BYSTANDERS

- Be alert to others in the work area. Be sure others know when and where you will be working. Make sure no one is behind equipment or within 15 meters (50 feet) of it operating.
- Loose fitting clothing, long hair, jewellery and equipment which might become entangled in moving equipment are prohibited while working near the Slasher.
- Operators, helpers, and other personnel working near Slasher must wear steel-toe safety shoes, safety glasses, and hard hats as a minimum. Hearing protection, respirators, and personnel protective clothing will be specified in the site-specific Health and Safety Plan.

### WARNING



#### MAINTAINING THE SLASHER

- Before performing maintenance, lower the attachment to the ground, apply the parking brakes, turn off the engine, and remove the key.
- Never adjust a relief valve for pressure higher than recommended by the machine's manufacturer.

#### TRANSPORTING

Follow all local government regulations that may apply along with recommended tie down points and any equipment safety precautions at the front of this handbook when transporting your attachment.

#### TIE DOWN POINTS

### WARNING



- Tie down points are identified by tie down decals where required. Securing to trailer at other points is unsafe and can damage attachment.
- Do not attach tie down accessories around cylinders or in any way that may damage hoses or hydraulic components.
- Attach tie down accessories to unit as recommended.
- Check unit stability before transporting.

Verify that all tie down accessories (chains, slings, ropes, shackles and etc.) are capable of maintaining attachment stability during transporting and are attached in such a way to prevent unintended disengagement or shifting of the unit. Failure to do so could result in serious personal injury or death.



## 4 SAFETY PRECAUTIONS - GENERAL INFORMATION

### TO THE OPERATOR

The primary responsibility for safety with this equipment falls to the operator. Make sure that the equipment is operated only by trained individuals that have read and understand this manual. Don't hurry the learning process or take the unit for granted.

It is the skill, care, common sense, and good judgement of the operator that will determine how efficiently and safely the job is performed. Know your equipment before you start. Know its capabilities and how to operate all the controls.

Visually inspect your equipment before you start, ensure correct assembly and installation of the attachment and never operate equipment that is not in proper working order.

Practice the operation of your new attachment and become familiar with the controls and the way it handles on your machine. If there is any portion of this manual or function you do not understand, contact your local authorized dealer or the manufacturer.

1. Never operate the Attachment without first reading and understanding the entire operator's manual. Always
2. Always wear the correct Personal Protective Equipment (PPE).
3. Do not paint over, remove or deface any safety signs or warning decals on your equipment.
4. Follow all safety decals. Keep them clean and replace them if they become worn, damaged or illegible.
5. Know your equipment inside and out. Know how to operate all controls and know emergency shut down procedures.
6. Keep all stepping surfaces, pedals, and controls free from dirt, grease and oil. Keep equipment clean to help avoid injury from slipping or a fall when getting on or off equipment.
7. Operate the attachment only in daylight or with sufficient artificial light.
8. Always carry loads close to the ground. Do not step off machine platform with load raised.
9. Turn off engine before performing maintenance. All maintenance can be performed with the machine arms lowered. If lift arms must be left raised for any reason, use a positive lift arm lock to secure the arms in place. Serious damage or personal injury could result from lift arms accidentally lowering.
10. Do not exceed rated operating capacity of the host machine, as machine may become unstable resulting in loss of control.
11. Always lower the loader arms or machine boom to the ground, shut off the engine and remove the key before getting off the unit.

## 5 SAFETY - WORKING WITH THE ATTACHMENT

### WHEN MOUNTING THIS PRODUCT TO YOUR MACHINE

- Refer to the operator's manuals of your machine, and your quick-attach for special or detailed mounting instructions.
- This product should fit onto the tool bar/quick-attach mechanism of your machine.
- If this product does not fit properly, contact your Digga Dealer before operating.
- Where 'Dead Man' connections are connected or installed it is illegal to disengage, tamper with or remove them.

### WHEN ADJUSTING, SERVICING OR REPAIRING THIS PRODUCT

- Make no modifications to your Slasher.
- When making repairs use only authorised Digga service agents, and genuine Digga parts.
- Replacement parts must also have safety signs attached.

## 6 INSTALLATION AND OPERATING INSTRUCTIONS

The DIGGA Mini Slasha receives its power from the parent machine through the auxiliary valve circuit with quick release couplers normally located on the machine arms near the front. Hook up hoses to auxiliary hydraulics.

***Engine must be shut off. Pressure may need to be released.***

Ensure your machines flow, pressures and load ratings do not exceed the maximum ratings stated on your Mini Slasha serial tag. It is the responsibility of the operator to ensure the unit's maximum rated flows, pressures and load ratings are never exceeded. Exceeding these ratings will void warranty.

**IF YOU ARE IN ANY DOUBT CONTACT YOUR NEAREST DIGGA DEALER FOR ASSISTANCE.**



**SAFETY FIRST!! READ AND UNDERSTAND THE SAFETY INSTRUCTIONS BEFORE BEGINNING ANY MINI SLASHA MOUNTING**

### MINI SLASHER INSTALLATION

1. Place this product on a firm, level surface that is large enough to safely accommodate this product, loader and all workers involved in the mounting process.
2. Be sure all connection points are properly secured.
3. Refer to the operator's manual(s) for your loader and quick-attach and follow the mounting instructions contained therein.
4. Carefully raise the loader arms and cycle the tilt cylinders to check clearances and to verify that all mounting procedures have been successfully completed.

### MINI SLASHER HYDRAULIC CONNECTION

1. Disconnect the hydraulic hose quick couplers from one another and attach the quick couplers to your loader as per the instructions in your machine operator's manual.
2. Carefully raise the loader arm and cycle the tilt cylinders to check hose clearances and to check for any interference.
3. To assure optimum motor life, run hydraulic motor for one hour on approx 1/3 RPM before application of full load.



**NOTE: IT IS IMPORTANT TO MAKE SURE THE LOCKING MECHANISM ON YOUR QUICK ATTACH IS ENGAGED, THEREFORE LOCKING THE ATTACHMENT ONTO THE MACHINE.**



**DO NOT LOCK THE AUXILIARY HYDRAULICS OF YOUR MACHINE IN THE "ON" POSITION. FAILURE TO OBEY THIS WARNING COULD RESULT IN DEATH OR SERIOUS INJURY.**



**SAFETY FIRST!! READ AND UNDERSTAND THE SAFETY INSTRUCTIONS BEFORE BEGINNING ANY SLASHING OPERATION.**



**FAILURE TO OBEY THE FOLLOWING PROCEDURES COULD RESULT IN DEATH OR SERIOUS INJURY**

Never lift this product:

- More than 500mm off the ground whilst blades are spinning OR to a height where visibility is obstructed, which ever is lower.
- Do NOT raise the Mini Slasher in a vertical position whilst the blades are spinning.
- The Mini Slasher is not designed to be used as a hedge trimming tool.

## MINI SLASHER OPERATION

### GENERAL INFORMATION

The Digga Mini Slasher is perfect for cutting tall grass and brush. The Mini Slasher attaches to the toolbar/quick attach mechanism of your mini loader or quick hitch of your mini excavator (depending upon which version you ordered) Due to this arrangement, thorough knowledge of the mini loader or mini excavator controls is necessary for machine operation. Read and understand your mini loader or mini excavator's operator's manual before attempting to use the Mini Slasher.

### OPERATING TIPS

- Increase the life of your bidirectional blades by cutting brush in one direction and cutting grass and smaller vegetation in another (This will keep the blades sharp for cutting grass)
- If your preferred direction of blade rotation is not set up correctly for your mini loader "default", the hoses may be reversed at the loader end.
- Continuous rotation of the blades are required during operation to prevent overheating of the hydraulic system. If the Mini Slasha stalls, disengage auxiliary hydraulics from the mini loader, remove the debris from the blade. Start the mini loader, engage the auxiliary hydraulics and continue slashing.



**DANGER! ROTATING BLADE HAZARD, STAY BACK LOOSE OBJECTS CAN BE DISCHARGED!**



**WARNING! OPERATING THE MINI SLASHA ON A HIGH FLOW HYDRAULIC SYSTEM MAY CAUSE SEVERE INJURY OR DEATH DUE TO INCREASED RPM. DO NOT OPERATE THE MINI SLASHA ON HIGH FLOW HYDRAULIC SYSTEMS**

## 6 INSTALLATION AND OPERATING INSTRUCTIONS

### CUTTING OPERATION

1. Raise the back of the unit off the ground approx. 100mm to allow the material to clear from under the cutterdeck as you travel forward.
2. Place the front skid shoes 25mm - 50mm off the ground. This is the preferred position for cutting grass and heavy vegetation.



**CAUTION: NEVER DRIVE YOUR MINI LOADER WITH THE FRONT OF THE MINI SLASHA TO THE POINT THAT YOUR VIEW IS OBSTRUCTED. ALWAYS MAKE SURE THAT YOU CAN SEE WHAT YOU ARE CUTTING.**

**CAUTION: CHECK THE WORK AREA. NEVER OPERATE THE CUTTER IN POPULATED AREAS WHERE THROWN OBJECTS COULD INJURE PERSONS OR DAMAGE PROPERTY.**

**CAUTION: NEVER RAISE THE MINI SLASHA AND EXPOSE YOURSELF OR ANYONE ELSE TO THE ROTATING BLADES. IF YOU CAN SEE THE BLADES, THEN THE BACK OF THE UNIT IS RAISED TOO HIGH.**

3. Confirm that bystanders are at least a minimum safe distance of 15m (50ft) from the equipment.
4. Start the engine.
5. Ensure that the auxiliary hydraulics valve to power the Mini Slasher is disengaged and that the engine is at idle.
6. Engage the auxiliary hydraulics. Increase the engine speed to the desired speed.
7. Proceed to commence slashing and comply with all safety procedures .

### CUTTING LARGE BRUSH

1. When cutting large brush tilt the front of the Mini Slasher up 300-600mm (1-2 ft.).
2. Slowly drive into the brush & use the tilt function of the mini loader to bend/push the brush over. As the brush bends the blades will cut it off.
3. The brush can now be mulched by driving the mini loader forward several feet and then reversing back, hence mulching any brush which may not have gotten mulched on the forward movement
4. Repeat if necessary.



**CAUTION: NEVER RAISE THE MINI SLASHA AND EXPOSE YOURSELF OR ANYONE ELSE TO THE ROTATING BLADES. IF YOU CAN SEE THE BLADES , THEN THE BACK OF THE UNIT IS RAISED TOO HIGH.**



**CAUTION: ALWAYS CHECK THAT THE CHAINS ARE IN GOOD WORKING CONDITION. NEVER REMOVE THE CHAINS FROM THE SLASHER. FAILURE TO OBEY THESE INSTRUCTIONS COULD RESULT IN SEVERE INJURY.**

### REMOVAL AND STORAGE

1. Set the attachment on the ground and follow the standard shut down procedure in your loader operators manual.
2. With the loader OFF, disengage the attachment lock pins, release hydraulic pressure from the auxiliary hydraulic system and disconnect the hydraulic couplers from the loader.
3. Start the machines engine and make sure that the lift arm is lowered and in contact with the loader frame.
4. Roll the attachment mechanism forward and slowly back up until the attachment is free from the machine.
5. Remove and store the attachment in a dry and protected place. Leaving the Mini Slasha outside will materially shorten its life.

### WHEN ATTACHMENTS NOT ON PARENT MACHINE:

It is a requirement of the Australian Work place Health and Safety act 1995 that safe systems of work are employed when handling any attachments. Complete compliance with Work place Health and Safety issues is compulsory and all due care and attention must be observed at all times in any method of moving, transporting or storing any such device when not attached to a parent machine. We recommend attachments are well secured when being moved or in transit and furthermore prior to moving, storing, loading/unloading or parking it is suggested that the attachment is strapped/secured to a pallet or enclosed in a suitable container to minimise any movement or loss of the load during such activity. NO responsibility for loss or damage to persons or property in any regard can be attributed to Digga.

### TRANSPORTING THE ATTACHMENT

1. Follow all federal, state and local regulations when transporting the unit on public roads.
2. Use extra care when loading or unloading the machine onto a vehicle. Disconnect hydraulic couplers during transportation.



**CAUTION: IF THE MINI SLASHA IS TO BE LIFTED ONTO A VEHICLE, USE THE LIFTING LUGS PROVIDED ON THE UNIT.**

## 7 SPARE PARTS

### MINI SLASHA - BLADE ASSEMBLY PARTS LIST

ITEM	PART NO.	DESCRIPTION	QTY
1	FA-000095	NUT NYLOC 5/8 UNC GR5 ZP	2
2	FA-000189	NUT NYLOC M12 ZINC PLATED	8
3	FA-000487	SCREW FLAT HEAD SOCKET M12 X 50 G10.9 ZP	8
4	ML-000234	MINI SLASHER - STRONG BACK SUPPORT WELDMENT	1
5	ML-000243	MINI SLASHER-CUTTING BLADE	2
6	ML-000248	MINI SLASHER -FLY WHEEL	1
7	SL-000243	SLASHER -CUTTING BLADE BOLT - 1250MM BLADE	2

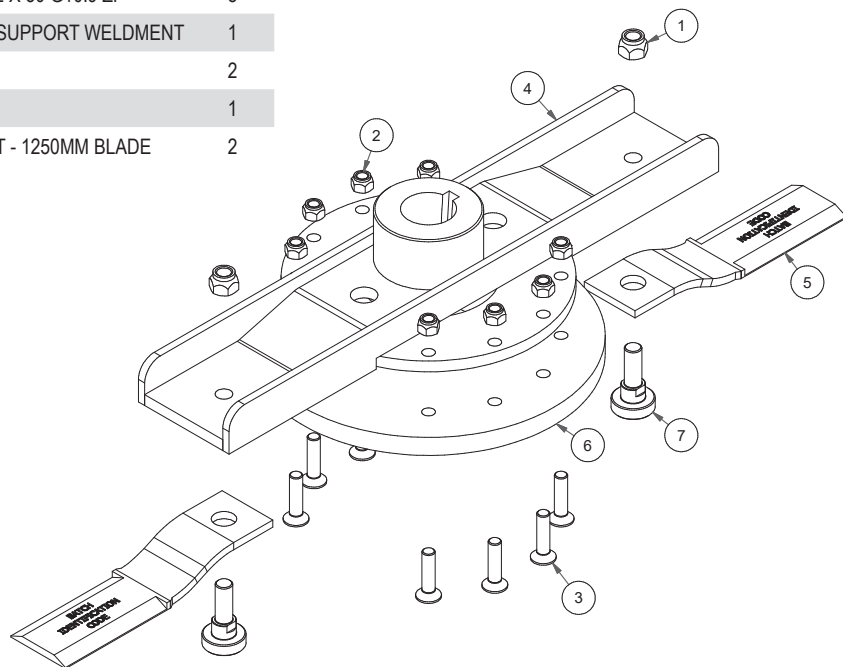

For further information on spare parts please contact one of the Digga sales office below your closest authorised Digga Dealer.

## **DIGGA INTERNATIONAL SALES OFFICES**

### **ASIA PACIFIC**

#### **DIGGA HEAD OFFICE - BRISBANE**

4 Octal St, Yatala QLD 4207

**PH:** (07) 3807 3330

**EMAIL:** info@digga.com

#### **DIGGA NEW SOUTH WALES**

19 McKay Close,  
Wetherill Park NSW 2164

**PH:** 1300 2 DIGGA

**EMAIL:** nsw@digga.com

#### **DIGGA VICTORIA**

27 Metcalf Street,  
Dandenong, VIC 3175

**PH:** 1300 2 DIGGA

**EMAIL:** vic@digga.com

**WEB:** www.digga.com

### **NORTH AMERICA**

#### **DIGGA NORTH AMERICA**

2325 Industrial Parkway SW  
Dyersville IA 52040

**PH:** + 1 563 875 7915

**WEB:** www.diggausa.com

**EMAIL:** info@diggaus.com

### **EUROPE**

#### **DIGGA EUROPE**

Unit 6, Smitham Bridge Road  
Hungerford Trading Estate,  
Hungerford, Berkshire RG17 0QU  
England, United Kingdom

**PH:** +44 (0) 1488 688 550

**WEB:** www.diggaurope.com

**EMAIL:** info@diggauk.com





**SAFETY FIRST!! READ AND UNDERSTAND THE SAFETY INSTRUCTIONS BEFORE BEGINNING ANY MINI SLASHA MAINTENANCE**

### BEFORE FIRST USE

- Inspect the attachment for shipping damage. If damage does exist, do not operate until the damaged parts have been replaced or repaired.

### BEFORE EACH USE

- Make sure that all nuts and bolts are in place and properly tightened.
- Make sure that all other fasteners are in place and are performing their specified function.
- Make sure that all hydraulic fittings are tightened and that there are no leaks in any fittings or hoses.
- Make sure that all safety signs are in place, are clean, and are legible. (SEE THE SAFETY SIGN SECTION)
- Replace any damaged parts and excessively worn parts.
- Grease all lubrication points.
- Check your fold back cutting blades for wear and replace as needed
- Ensure chains are in good working condition. Never remove chains from slasher.



### WARNING!

If injured by injected fluid, see a doctor at once. If your doctor is not familiar with this type of injury, ask him to research it immediately to determine proper treatment.

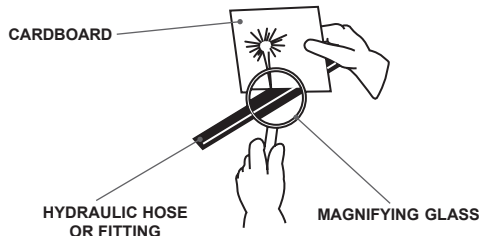

Escaping fluid under pressure can have sufficient force to penetrate the skin causing serious personal injury. Fluid escaping from a very small hole can be almost invisible. Use a piece of cardboard or wood, rather than hands to search for suspected leaks.

Keep unprotected body parts, such as face, eyes, and arms as far away as possible from a suspected leak. Flesh injected with hydraulic fluid may develop gangrene or other permanent disabilities.



### IMPORTANT: OIL CHANGE SCHEDULE

#### GEARBOX OIL SCHEDULE FOR MINI SLASHERS:

THE GEARBOX OIL CAPACITY IS ENGRAVED ONTO THE SERIAL TAG LOCATED ON THE SIDE OF THE MINI SLASHER.

#### Initial (Bed-in) oil change:

The first oil change must be carried out within the first 30 hours of operation. Thereafter, every 300 hours.

FIRST OIL CHANGE	Within the first 30 hours of use
2ND OIL CHANGE PLUS SUBSEQUENT OIL CHANGES	After 300 hours of use thereafter
GEARBOX OIL:- ISO 320 SYNTHETIC OIL - EXTREME PRESSURE (EP)	

## MINI LOADER SLASHER MODEL

1. Clean the area of application with non-flammable solvent, then wash the same area with soap & water.
2. Allow the surface to fully dry.
3. Remove the backing from the safety sign, exposing the backing surface.
4. Apply the safety sign to the position shown in the diagram above and smooth out any bubbles.

- Keep all safety signs clean and legible.
- Replace all missing, illegible, or damaged safety signs.
- Replacement parts for parts with safety signs attached must also have safety signs attached.
- Safety signs are available from your dealer or from Digga Australia.

ITEM NO	ORDER CODE	DESCRIPTION	QTY
1	DE-000168	Serial Tag	1
2	DE-000039	Caution: Read Ops Manual	2
3	DE-000040	Caution: Attachment Riding	2
4	DE-000079	Caution: 15m Distance	2
5	DE-000130	Warning: Slasher Tilting	1
6	DE-000257	Hearing & Eye Protection	2
7	DE-000258	Danger Rotating Blade	2

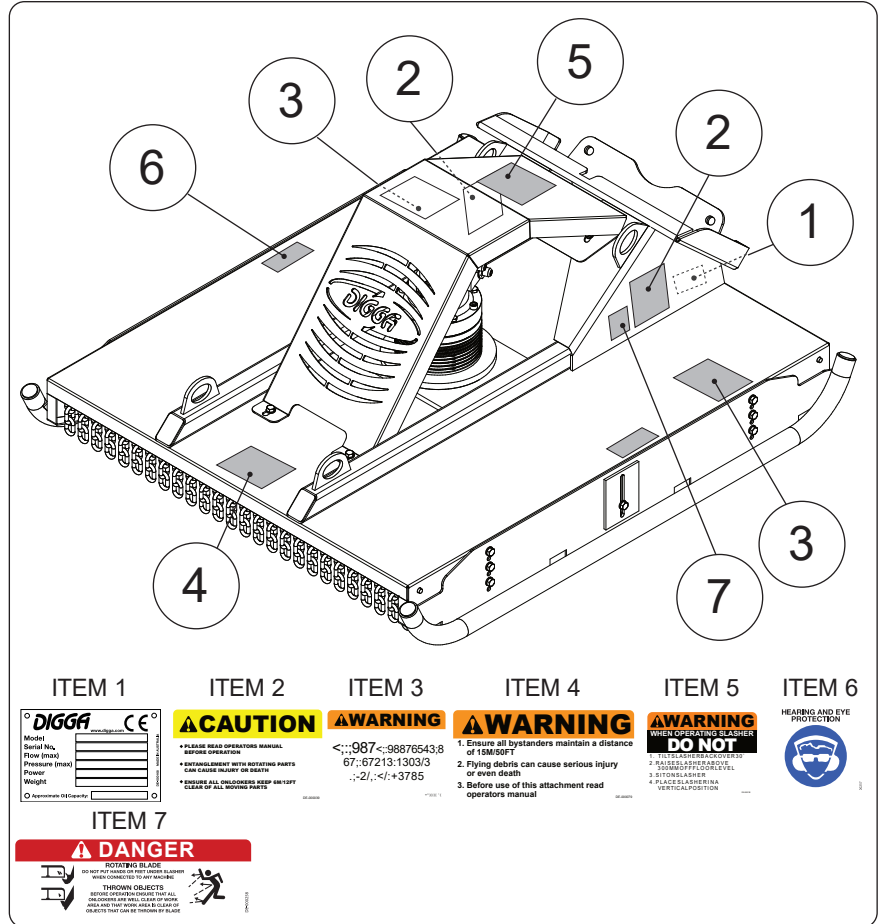

## EXCAVATOR SLASHER MODEL

### PLACEMENT OR REPLACEMENT OF SAFETY SIGNS

1. Clean the area of application with non-flammable solvent, then wash the same area with soap & water.
2. Allow the surface to fully dry.
3. Remove the backing from the safety sign, exposing the backing surface.
4. Apply the safety sign to the position shown in the diagram above and smooth out any bubbles.

### INSTRUCTIONS

- Keep all safety signs clean and legible.
- Replace all missing, illegible, or damaged safety signs.
- Replacement parts for parts with safety signs attached must also have safety signs attached.
- Safety signs are available from your dealer or from Digga Australia.

ITEM NO	ORDER CODE	DESCRIPTION	QTY
1	DE-000168	Serial Tag	1
2	DE-000039	Caution: Op Manual	2
3	DE-000083	Caution: Slasher Riding	2
4	DE-000079	Caution: 15m Distance	2
5	DE-000130	Warning: Slasha Tilts	1
6	DE-000257	Hearing & Eye Protection	2
7	DE-000258	Danger Rotating Blade	2

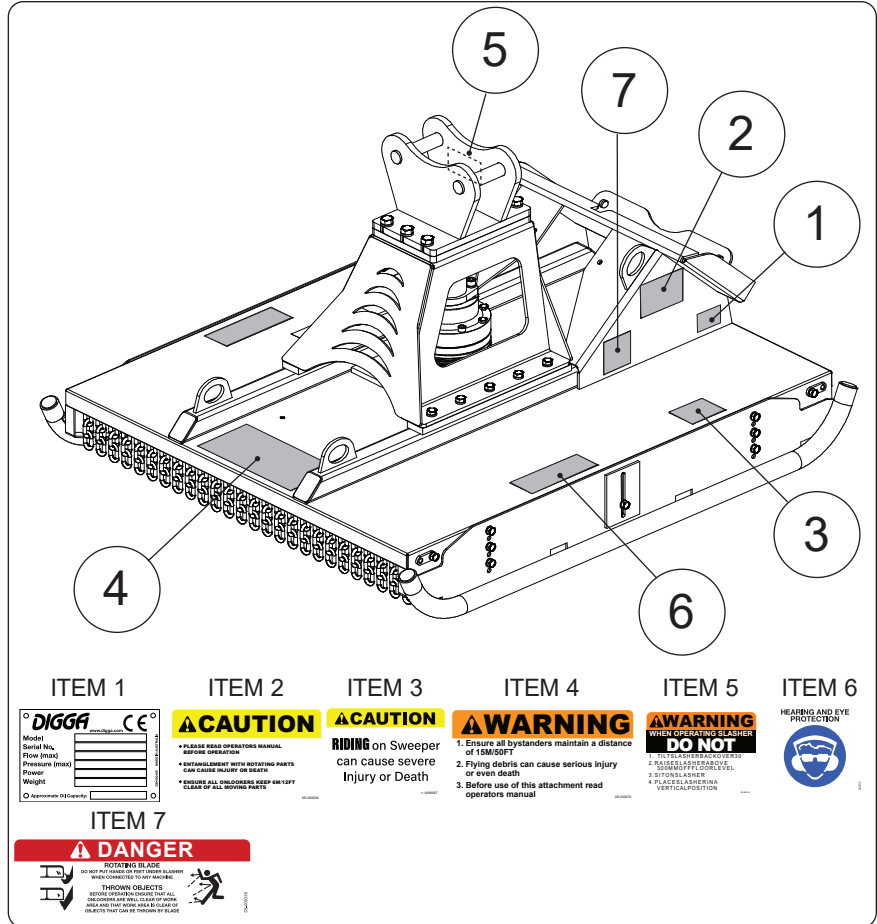

## 10 TROUBLESHOOTING

MINI SLASHER		
TROUBLE	POSSIBLE CAUSE	REMEDY
Cutting Blades Stalling	Debris around the blades	Remove Debris
	Going to fast through thick/long material	Adjust Travelling / RPM speed OR Make smaller passes
	Material too Large in Diameter	Mini Slasha may not be appropriate for size of material
	Cutting Blades Blunt	Check, sharpen or replace as required
	Cutting Blades Bent / Damaged	Check and Replace
Hydraulic Motor Stalling	Continually Stalling of Mini Slasha	Check Cutting Operations
	Oil too hot	Allow to cool
Loss of Gearbox oil	Debris have damaged the gearbox output shaft seal. It can also be as a result of a faulty hydraulic motor output shaft seal as mentioned below.	Inspect for any signs of gearbox oil leaks, repair as necessary, replenish lost oil.
Loss of Hydraulic oil	A faulty or worn hydraulic motor output shaft seal can cause hydraulic oil to contaminate, flood the gearbox oil and in some instances may cause the gearbox output shaft seal to dislodge.	Replace hydraulic motor output shaft seal. Drain contaminated gearbox oil. Replace new gearbox oil into gearbox.

## 11 TECHNICAL SPECIFICATIONS

	STANDARD MODEL	EXCAVATOR MODEL
Overall Length (mm)	1370	1370
Overall Width (mm)	1200	1200
Overall Height (mm)	580	580
Mass (kgs)	215	250
Width of cut (mm)	1000	1000
Hydraulic Motor (Light)	49cm <sup>3</sup> (3.0 in <sup>3</sup> ) - 10-30 lpm	49cm <sup>3</sup> (3.0 in <sup>3</sup> ) - 10-30 lpm
Hydraulic Motor (Intermediate)	80cm <sup>3</sup> (4.9 in <sup>3</sup> ) - 25-50 lpm	80cm <sup>3</sup> (4.9 in <sup>3</sup> ) - 25-50 lpm
Hydraulic Motor (Heavy)	98cm <sup>3</sup> (6.0 in <sup>3</sup> ) - 30-60 lpm	98cm <sup>3</sup> (6.0 in <sup>3</sup> ) - 30-60 lpm
Gearbox Oil Qty	650ml	650ml
Type of Gearbox Oil	CASTROLALPHASYN EP 320 (SYNTHETIC)	
Operating Pressure (MAX)	240 BAR / 3500 PSI	240 BAR / 3500 PSI

**For additional safety information please see Risk Management booklet. To obtain a copy contact Digga Head Office on 07 3807 3330**

## WARRANTY

All new Digga products are warranted to be free from defects in materials or workmanship, for a period of twelve (12) months from date of original purchase, which may cause failure under normal usage and service when used for the purpose intended.

In the event of failure within twelve (12) months from initial retail sale, lease or rental date (excluding cable, ground engaging parts such as sprockets, digging chain, bearings, teeth, tamping and demolition heads, blade cutting edges, pilot bits, auger teeth, auger heads & broom bristles), if after examination, Digga determines failure was due to defective material and/or workmanship, parts only will be repaired or replaced.

Digga may request defective product or products be returned prepaid to them for inspection at their place of business at 4 Octal Street Yatala, Queensland, or to a location specified by Digga. The warranty will be considered void if the product or any part of the product is modified or repaired in any way not expressly authorized by Digga, or if closed components are disassembled prior to return. Closed components include, but are not limited to: gearboxes, hydraulic pumps, motors, cylinders and actuators. Any goods returned to Digga by the customer under warranty or repair must have all freight charges prepaid for on the customers account.

Any claims under this warranty must be made within fifteen (15) days after the Buyer learns of the facts upon which such claim is based. All claims not made in writing and received by Digga outside the time period specified above shall be deemed waived.

THIS WARRANTY IS IN LIEU OF ALL OTHER WARRANTIES EXPRESSED OR IMPLIED AND THERE ARE NO WARRANTIES OF MERCHANTABILITY OR OF FITNESS FOR A PARTICULAR PURPOSE. IN NO EVENT SHALL DIGGA BE LIABLE FOR CONSEQUENTIAL OR SPECIAL DAMAGE. DIGGA'S LIABILITY FOR ANY AND ALL LOSSES AND DAMAGES TO BUYER, RESULTING FROM ANY CAUSE WHATSOEVER, INCLUDING DIGGA'S NEGLIGENCE, IRRESPECTIVE OF WHETHER SUCH DEFECTS ARE DISCOVERABLE OR LATENT, SHALL IN NO EVENT EXCEED THE PURCHASE PRICE OF THE PARTICULAR PRODUCTS WITH RESPECT TO WHICH LOSSES OR DAMAGES ARE CLAIMED, OR, AT THE ELECTION OF DIGGA, THE REPAIR OR REPLACEMENT OF DEFECTIVE OR DAMAGED PRODUCTS.



Available through

**EARTHMOVING  
WAREHOUSE**

[earthmovingwarehouse.com.au](http://earthmovingwarehouse.com.au)

0459927346 (0459 WAREHOUSE)  
Shed C1/C2 194 Zillmere Road,  
Boondall Brisbane 4034  
QLD