

DIGGA®



MINI SKID HOE

OPERATORS MANUAL

PM-000037-A

1 TO THE PURCHASER

Congratulations on the purchase of your new DIGGA Mini Skid Hoe! This product was carefully designed and manufactured to give you years of dependable service. To keep it running efficiently please read the instructions in the manual to keep it in top working condition.

Be sure to observe all safety precautions and maintenance procedures as described in this manual.

No responsibility will be taken by Digga for any omissions or errors in this manual as all data is correct at time of print, however Digga reserve the right to revise this manual without further notice.

The Mini Skid Hoe has multifit mounting. Please contact your DIGGA dealer for any further information pertaining to this product or for further information on other Digga products.

ABOUT THIS MANUAL

This manual has been designed to help you do a better, safer job. **Read this manual carefully and become familiar with its contents.** Remember; never let anyone operate this unit without reading the "Safety Precautions" and "Operating Instructions" sections of this manual. Unless noted otherwise, right and left sides are determined from the position of the operator when behind the product facing forward.

DIGGA www.digga.com	○	CE	DE-000063 MADE IN AUSTRALIA
Model			
Serial No.			
Flow (max)			
Pressure (max)			
Power			
Approx. Oil Capacity	○	Weight	

Your Digga Mini Skid Hoe is a user non serviceable part. Unauthorised disassembly will void warranty. All service and warranty must be performed by an authorised DIGGA service agent. Contact your local Digga dealer for details. To facilitate warranty or service, record the model and serial number of your unit in the space provided on this page.

This information may be obtained from the identification plate located on the product.

IMPORTANT: WHEN SERVICING OR ASSEMBLING YOUR PRODUCT, REMEMBER TO USE ONLY GENUINE DIGGA REPLACEMENT PARTS. SUBSTITUTE PARTS MAY NOT MEET THE STANDARDS REQUIRED FOR SAFE, DEPENDABLE OPERATION. USE OF NON GENUINE DIGGA PARTS WILL VOID WARRANTY AND DIGGA WILL ACCEPT NO LIABILITY WHAT SO EVER FOR CONSEQUENTIAL OR SPECIAL DAMAGES.

MODEL _____

SERIAL NUMBER _____

DATE PURCHASED _____

The parts department needs this information to insure accurate parts can be sent to the authorised service agent.

2 TABLE OF CONTENTS

	PAGE
1 TO THE PURCHASER	2
2 TABLE OF CONTENTS	3
3 PREPARATION FOR USE	4
4 SAFETY PRECAUTIONS - GENERAL INFORMATION	5
5 SAFETY WORKING WITH THE ATTACHMENT	10
6 INSTALLATION AND OPERATING INSTRUCTIONS	11
7 SPARE PARTS	14
8 MAINTENANCE	15
9 SAFETY STICKER LOCATION	17
10 TROUBLESHOOTING	18
11 WARRANTY	19

MODELS COVERED IN THIS MANUAL

MINI SKID HOE

MB-000001	MB-000033	MB-000047 (SLIDE FRAME)	MB-000050 (SLIDE FRAME)
------------------	------------------	------------------------------------	------------------------------------

3 PREPARATION FOR USE

To avoid any inconvenience before operation, please check that you have received the following items which you may have ordered. Items may differ depending on the type of machine your Mini Skid Hoe is to be fitted to:

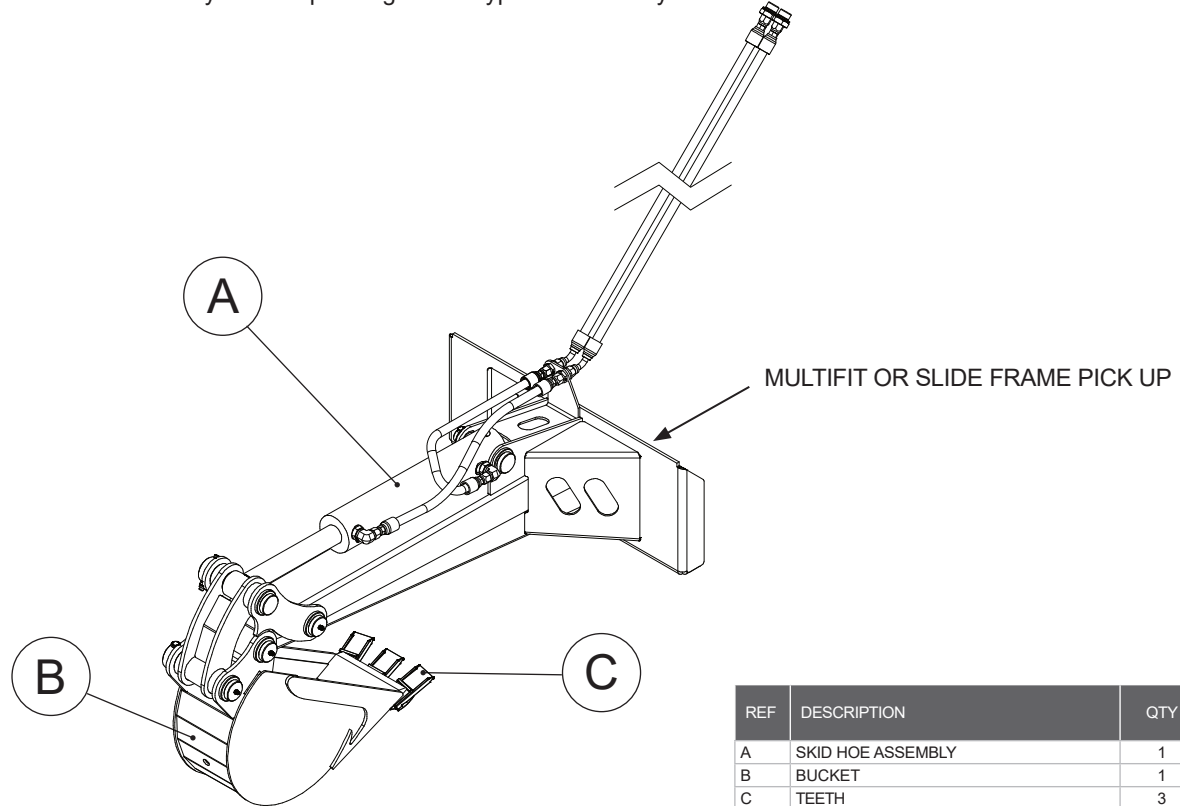

4 SAFETY PRECAUTIONS - GENERAL INFORMATION

TAKE NOTE! THIS SAFETY ALERT SYMBOL FOUND THROUGHOUT THIS MANUAL IS USED TO CALL YOUR ATTENTION TO INSTRUCTIONS INVOLVING YOUR PERSONAL SAFETY OR OTHERS. FAILURE TO FOLLOW THESE INSTRUCTIONS CAN RESULT IN INJURY OR DEATH.

THIS SYMBOL MEANS:



**ATTENTION!
BECOME ALERT!
YOUR SAFETY IS INVOLVED!**

SIGNAL WORDS: Note the use of signal words DANGER, WARNING, and CAUTION with the safety messages. The appropriate signal word for each has been selected using the following guidelines:

DANGER: Indicates an imminently hazardous situation, which if not avoided, will result in death or serious injury. This signal word is to be limited to the most extreme situations, typically for machine components which, for functional purposes, cannot be guarded.

WARNING: Indicates a potentially hazardous situation, which if not avoided, could result in death or serious injury, and includes hazards that are exposed when guards are removed. It may also be used to alert against unsafe practices and indicate potential failure or damage to equipment.

CAUTION: Indicates a potentially hazardous situation, which if not avoided, may result in minor or moderate injury. It may also be used to alert against unsafe practices.

This section is composed of various warnings and safety tips. **Read and learn all the information in this section before you attempt to use your attachment.** Also read your machines owner's manual before using your equipment. This knowledge will help you operate your unit safely. **Do not take this information lightly, it is presented for your benefit and for the benefit of others working around you.**

The "Safety Alert Symbol"  will be used throughout this manual. It will appear with the word **DANGER, WARNING, or CAUTION**, and a safety message pertaining to the specific topic being covered. Take the time to read these messages as you come across them.

4 SAFETY PRECAUTIONS - GENERAL INFORMATION

WARNING KNOW WHERE UTILITIES ARE



Observe overhead electrical and other utility lines. Be sure equipment will clear them. When digging, call DIAL BEFORE YOU DIG ON 1100 (in Australia), or your local UTILITIES location service provider for location of buried utility lines, gas, water, and sewer, as well as any other hazard you may encounter.

EXPOSURE TO RESPIRABLE CRYSTALLINE SILICA DUST ALONG WITH OTHER HAZARDOUS DUSTS MAY CAUSE SERIOUS OR FATAL RESPIRATORY DISEASE.

It is recommended to use dust suppression, dust collection and if necessary personal protective equipment during the operation of any attachment that may cause high levels of dust.

WARNING



REMOVE PAINT BEFORE WELDING OR HEATING

Hazardous fumes/dust can be generated when paint is heated by welding, soldering or using a torch. Do all work outside or in a well ventilated area and dispose of paint and solvent properly. Remove paint before welding or heating. When sanding or grinding paint, avoid breathing the dust. Wear an approved respirator. If you use solvent or paint stripper, remove stripper with soap and water before welding. Remove solvent or paint stripper containers and other flammable material from area. Allow fumes to disperse at least 15 minutes before welding or heating.

WARNING



END OF LIFE DISPOSAL

At the completion of the useful life of the unit, drain all fluids and dismantle by separating the different materials (rubber, steel, plastic, etc.). Follow all federal, state and local regulations for recycling and disposal of the fluid and components.

OPERATING THE MINI SKID HOE

WARNING



- An operator must not use drugs or alcohol, which can change his or her alertness or coordination. An operator taking prescription or over-the-counter drugs should seek medical advice on whether or not he or she can safely operate equipment.
- All bystanders should be kept a minimum of 6 meters (20 feet) away from the working area of the Mini Skid Hoe.
- Do not allow Site workers to climb or ride on the Mini Skid Hoe at any time, including while stationary, in operation or being moved.
- Operate only from the operator's station.
- Avoid steep hillside operation which could cause the machine to overturn. Consult your machine operator's and safety manuals for maximum incline allowable.
- Flow and pressure gauges, fittings, and hoses must have a continuous operating pressure rating of at least 25% higher than highest pressures of the system.

4 SAFETY PRECAUTIONS - GENERAL INFORMATION

WARNING



OPERATING THE MINI SKID HOE (CONTINUED)

- Reduce speed when driving over rough terrain, on a slope, or turning, to avoid overturning the vehicle.
- Travel only with the Mini Skid Hoe in a safe transport position to prevent uncontrolled movement. Drive slowly over rough ground and on slopes.
- Do not drive close to ditches, excavations, etc., cave in could result.
- Before exiting the machine, lower the attachment to the ground, apply the parking brakes, turn off the prime mover's engine, and remove the key.
- Do not smoke when refueling the prime mover. Allow room in the fuel tank for expansion. Wipe up any spilled fuel. Secure cap tightly when done.
- Remove the Mini Skid Hoe from the prime mover before transporting to and from the job site.

WARNING



- The Mini Skid Hoe must be stopped before making adjustments to the attachment.
- All Mini Skid Hoe operations must be stopped in the event of local thunderstorm, or lightning activity. During operation, weather conditions shall be monitored: operations shall cease during electrical storms or when electrical storms are imminent.
- Mini Skid Hoe shall be used only for their designed intent and shall not be loaded beyond their rated capacity. Overloading or exceeding the manufacturers specifications will void all warranty.

STORAGE OF THE MINI SKID HOE

WARNING



- Seal hydraulic couplers from contaminants and secure all hydraulic hoses off the ground to help prevent damage.
- Clean the unit thoroughly, removing all mud, dirt, and grease.
- Inspect for visible signs of wear, breakage, or damage. Order any parts required and make the necessary repairs to avoid delays upon removal from storage.
- Tighten loose nuts and cap screws.
- Replace decals that are damaged or in unreadable condition.
- Store unit in a dry and protected place. Leaving the unit outside will materially shorten its life.

4 SAFETY PRECAUTIONS - GENERAL INFORMATION

WARNING GROUND PERSONNEL AND BYSTANDERS



- Be alert to others in the work area. Be sure others know when and where you will be working. Make sure no one is behind equipment or within 6 meters (20 feet) of it operating.
- Loose fitting clothing, long hair, jewellery and equipment which might become entangled in moving equipment are prohibited while working near the Mini Skid Hoe.
- Operators, helpers, and other personnel working near Mini Skid Hoe must wear steel-toe safety shoes, safety glasses, and hard hats as a minimum. Hearing protection, respirators, and personnel protective clothing will be specified in the site-specific Health and Safety Plan.

WARNING



MAINTAINING THE MINI SKID HOE

- Before performing maintenance, lower the attachment to the ground, apply the parking brakes, turn off the engine, and remove the key.
- Never adjust a relief valve for pressure higher than recommended by the machine's manufacturer.

TRANSPORTING

Follow all local government regulations that may apply along with recommended tie down points and any equipment safety precautions at the front of this handbook when transporting your attachment.

TIE DOWN POINTS

WARNING



- Tie down points are identified by tie down decals where required. Securing to trailer at other points is unsafe and can damage attachment.
- Do not attach tie down accessories around cylinders or in any way that may damage hoses or hydraulic components.
- Attach tie down accessories to unit as recommended.
- Check unit stability before transporting.

Verify that all tie down accessories (chains, slings, ropes, shackles and etc.) are capable of maintaining attachment stability during transporting and are attached in such a way to prevent unintended disengagement or shifting of the unit. Failure to do so could result in serious personal injury or death.

4 SAFETY PRECAUTIONS - GENERAL INFORMATION

TO THE OPERATOR

The primary responsibility for safety with this equipment falls to the operator. Make sure that the equipment is operated only by trained individuals that have read and understand this manual. Don't hurry the learning process or take the unit for granted.

It is the skill, care, common sense, and good judgement of the operator that will determine how efficiently and safely the job is performed. Know your equipment before you start. Know its capabilities and how to operate all the controls.

Visually inspect your equipment before you start, ensure correct assembly and installation of the attachment and never operate equipment that is not in proper working order.

Practice the operation of your new attachment and become familiar with the controls and the way it handles on your machine. If there is any portion of this manual or function you do not understand, contact your local authorized dealer or the manufacturer.

1. Never operate the Attachment without first reading and understanding the entire operator's manual.
2. Do not paint over, remove or deface any safety signs or warning decals on your equipment.
3. Follow all safety decals. Keep them clean and replace them if they become worn, damaged or illegible.
4. Know your equipment inside and out. Know how to operate all controls and know emergency shut down procedures.
5. Keep all stepping surfaces, pedals, and controls free from dirt, grease and oil. Keep equipment clean to help avoid injury from slipping or a fall when getting on or off equipment.
6. Operate the attachment only in daylight or with sufficient artificial light.
7. Always carry loads close to the ground. Do not step off machine platform with load raised.
8. Turn off engine before performing maintenance. All maintenance can be performed with the machine arms lowered. If lift arms must be left raised for any reason, use a positive lift arm lock to secure the arms in place. Serious damage or personal injury could result from lift arms accidentally lowering.
9. Do not exceed rated operating capacity of the host machine, as machine may become unstable resulting in loss of control.
10. Always lower the loader arms or machine boom to the ground, shut off the engine and remove the key before getting off the unit.
11. Never use the Mini Skid Hoe on a machine that is not equipped with a cab or ROPS, and operator restraints (seat belts or equivalent devices).

5 SAFETY - WORKING WITH THE ATTACHMENT

WHEN MOUNTING THIS PRODUCT TO YOUR MACHINE

- Refer to the operator's manuals of your machine, and your quick-attach for special or detailed mounting instructions.
- This product should fit onto the tool bar/quick-attach mechanism of your machine.
- If this product does not fit properly, contact your Digga Dealer before operating.
- Where 'Dead Man' connections are connected or installed it is illegal to disengage, tamper with or remove them.

WHEN ADJUSTING, SERVICING OR REPAIRING THIS PRODUCT

- Make no modifications to your Mini Skid Hoe.
- When making repairs use only authorised Digga service agents, and genuine Digga parts.
- Replacement parts must also have safety signs attached.

6 INSTALLATION AND OPERATING INSTRUCTIONS

The DIGGA Mini Skid Hoe receives its power from the Parent Machine through the Auxiliary Valve circuit with Quick Release Couplers normally located on the machine arms near the front. Attaching points on the Mini Skid Hoe are the same as the bucket attaching points on your machine. Hook up hoses to Auxiliary Hydraulics.

Engine must be shut off. Pressure may need to be released.

Ensure your machines flow and pressures do not exceed the maximum rated flow and pressures of the Mini Skid Hoe (Refer To Page 3). Max. Flow and Pressure ratings are stated on your Mini Skid Hoe serial tag. It is the responsibility of the operator to ensure the unit's maximum rated flow & pressure are never exceeded.

Exceeding these ratings will void Warranty.

IF YOU ARE IN ANY DOUBT CONTACT YOUR NEAREST DIGGA DEALER FOR ASSISTANCE.



SAFETY FIRST!! READ AND UNDERSTAND THE SAFETY INSTRUCTIONS BEFORE BEGINNING ANY SKID HOE MOUNTING

MINI SKID HOE INSTALLATION

1. Place this product on a firm, level surface that is large enough to safely accommodate this product, your Loader, and all workers involved in the mounting process.
2. Be sure all connection points are properly secured.
3. Refer to the operator's manual(s) for your skid steer loader, and quick-attach and follow the mounting instructions contained therein.
4. Carefully raise the loader arms and cycle the tilt cylinders to check clearances and to verify that all mounting procedures have been successfully completed.
5. All Skid steer loaders MUST have a port relief installed on its hydraulic tilt circuit.

MINI SKID HOE HYDRAULIC CONNECTION

1. Attach the quick couplers to your skid steer loader as per the instructions in your skid steer loader operator's manual.
2. Carefully raise the loader arm and cycle the tilt cylinders to check hose clearances and to check for any interference.



NOTE: IT IS IMPORTANT TO MAKE SURE THE LOCKING MECHANISM ON YOUR QUICK ATTACH IS ENGAGED, THEREFORE LOCKING THE ATTACHMENT ONTO THE MACHINE.



DO NOT LOCK THE AUXILIARY HYDRAULICS OF YOUR SKID STEER LOADER IN THE "ON" POSITION. FAILURE TO OBEY THIS WARNING COULD RESULT IN DEATH OR SERIOUS INJURY.

6 INSTALLATION AND OPERATING INSTRUCTIONS



SAFETY FIRST!! READ AND UNDERSTAND THE SAFETY INSTRUCTIONS BEFORE BEGINNING ANY SKID HOE OPERATING



FAILURE TO OBEY THE FOLLOWING PROCEDURES COULD RESULT IN DEATH OR SERIOUS INJURY

Never lift this product:

- Above the operator's eye level OR to a height where visibility is obstructed, which ever is lower.
- Use caution when raising loaded bucket. Objects could fall from bucket toward bystanders or operator.

MINI SKID HOE OPERATION

NOTICE: USE OF REAR COUNTERWEIGHTS IS REQUIRED!

Refer to your Skid steer loader operator's manual for safe operating limit and use of counterweights.

TO DIG:

1. Be sure the loader is on solid ground before digging or lifting any load.
2. With the loader arms partially raised and the bucket cylinder partially extended, slowly curl the dipperstick toward the loader (using the loader's tilt control). The loader arms may need to be lowered or raised and/or the bucket cylinder extended to allow the bucket to penetrate the soil.
3. As the bucket fills, extend the bucket cylinder and extend the dipper or raise the loader arms to lift the bucket clear of the hole.
4. The depth of the hole will be controlled by the amount the dipper is extended and the height of the loader arms.
 - Use extreme care when working on hillsides. Always dump loaded bucket on uphill side of Mini Skid Hoe to minimize possibility of upset.
 - Exercise caution when working close to fences, ditches, or on uneven ground.

DO NOT:

- Dig close to the loader's wheels or under the loader; this could cause a cave-in and vehicle overturn.

TO DUMP ON GROUND:

1. With the bucket raised clear of the hole, slowly back up and pivot the loader rearward about the front wheels. This will swing the loader away from the trench, and the bucket to the side to dump.
 - Keep loads close to the ground while transporting.

TO CUT A SHALLOW TRENCH:

1. With the loader arms partially raised and the bucket cylinder partially extended, slowly curl the dipperstick toward the loader (using the loader's tilt control). The loader arms may need to be lowered or raised to allow the bucket to penetrate the soil.
2. When the bucket is positioned at the desired depth, slowly back up the loader, keeping the bucket height constant to cut a shallow amount of soil.

IMPORTANT: The tilt circuit of your power unit must be protected with a port relief; ignoring this precaution CAN result in damage to your power unit and/or this product and WILL void your Digga warranty

TO FILL A TRENCH:

1. With the loader arms partially raised, curl the dipperstick (attachment mainframe) forward with the bucket cylinder extended and the bottom of the bucket flat on the ground. The entire height of the bucket should be visible.
2. Use the loader's tilt cylinder only to raise the bucket above the material pile.
3. Pivot the loader to reach over the pile and tilt the Skid Hoe downward so the bottom of the bucket is approximately 12" below the top of the pile.
4. Pivot the loader toward the trench, using the side of the bucket to move the material into the trench. Repeat this process, lowering the bucket 6" at a time.
5. Move your power unit forward and repeat the above steps to continue filling the trench.

IMPORTANT: Make sure the portion of the trench to be driven on is full before moving forward. Moving on an unstable surface CAN result in damage to your Loader and/or this product and **WILL** void your Digga warranty.

- Always lower the bucket to the ground, set the parking brake, stop engine, remove ignition key and wait for all moving parts to stop before leaving the operator's seat.

For further information on spare parts please contact one of the Digga sales office below your closest authorised Digga Dealer.

DIGGA INTERNATIONAL SALES OFFICES

ASIA PACIFIC

DIGGA HEAD OFFICE - BRISBANE
4 Octal St, Yatala QLD 4207

PH: (07) 3807 3330

EMAIL: Info@digga.com

DIGGA NEW SOUTH WALES
19 McKay Close,
Wetherill Park, NSW 2164

PH: 1300 2 DIGGA

EMAIL: nsw@digga.com

DIGGA VICTORIA
17-21 Babbage Dr,
Dandenong, VIC 3175

PH: 1300 2 DIGGA

EMAIL: vic@digga.com

WEB: www.digga.com

NORTH AMERICA

DIGGA NORTH AMERICA
2325 Industrial Parkway SW
Dyersville IA 52040

PH: + 1 563 875 7915

WEB: www.diggausa.com

EMAIL: Info@diggausa.com

EUROPE

DIGGA EUROPE
Unit 6, Smitham Bridge Road
Hungerford Trading Estate,
Hungerford, Berkshire RG17 0QU
England, United Kingdom

PH: +44 (0) 1488 688 550

WEB: www.diggaeurope.com

EMAIL: Info@diggaeurope.com



SAFETY FIRST!! READ AND UNDERSTAND THE SAFETY INSTRUCTIONS BEFORE BEGINNING ANY MINI SLASHA MAINTENANCE

BEFORE FIRST USE

- Inspect the attachment for shipping damage. If damage does exist, do not operate until the damaged parts have been replaced or repaired.

BEFORE EACH USE

- Make sure that all nuts and bolts are in place and properly tightened.
- Make sure that all other fasteners are in place and are performing their specified function.
- Make sure that all hydraulic fittings are tightened and that there are no leaks in any fittings or hoses.
- Make sure that all safety signs are in place, are clean, and are legible. (SEE THE SAFETY SIGN SECTION)
- Replace any damaged parts and excessively worn parts.
- Grease all (5) lubrication points.

BEFORE EACH USE

- Grease all (5) lubrication points as shown on the following page.



WARNING!

If injured by injected fluid, see a doctor at once. If your doctor is not familiar with this type of injury, ask him to research it immediately to determine proper treatment.

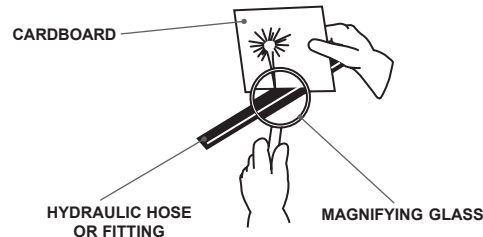

Escaping fluid under pressure can have sufficient force to penetrate the skin causing serious personal injury. Fluid escaping from a very small hole can be almost invisible. Use a piece of cardboard or wood, rather than hands to search for suspected leaks.

Keep unprotected body parts, such as face, eyes, and arms as far away as possible from a suspected leak. Flesh injected with hydraulic fluid may develop gangrene or other permanent disabilities.

8 MAINTENANCE

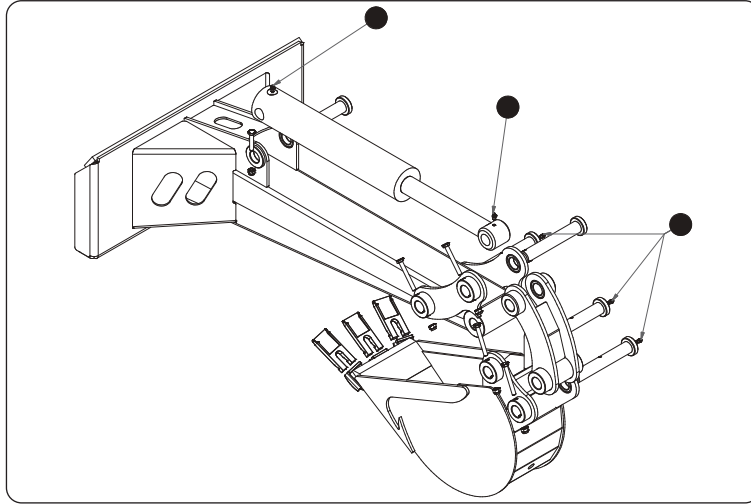

BEFORE SERVICING THE LOADER, REMOVE THE ATTACHMENT AND MAKE CERTAIN THE LIFT ARMS ARE LOWERED TO THEIR LOWEST POSITION OR THAT THE ARMS ARE SUPPORTED BY THE MECHANICAL LOCK UP DEVICES (IF THE MACHINE IS SO EQUIPPED).

- Shut off engine, set parking brake, and relieve hydraulic pressure before connecting or disconnecting hydraulic lines. Refer to your power unit's manual for instructions on how to relieve hydraulic pressure in lines.
- Before applying pressure to the system, be sure that all connections are tight and be sure there are no damaged hoses, lines, or fittings.
- Wear safety glasses and use metal or wood or cardboard when searching for leaks. Do not use your hands.
- Steam clean the power unit before any installation is made to the hydraulic system. Remove any attachment from the power unit and position on a level surface.

9 SAFETY - STICKER LOCATION

PLACEMENT OR REPLACEMENT OF SAFETY SIGNS

1. Clean the area of application with non-flammable solvent, then wash the same area with soap & water.
2. Allow the surface to fully dry.
3. Remove the backing from the safety sign, exposing the backing surface.
4. Apply the safety sign to the position shown in the diagram above and smooth out any bubbles.

INSTRUCTIONS

- Keep all safety signs clean and legible.
- Replace all missing, illegible, or damaged safety signs.
- Replacement parts for parts with safety signs attached must also have safety signs attached.
- Safety signs are available from your dealer or from Digga Australia.

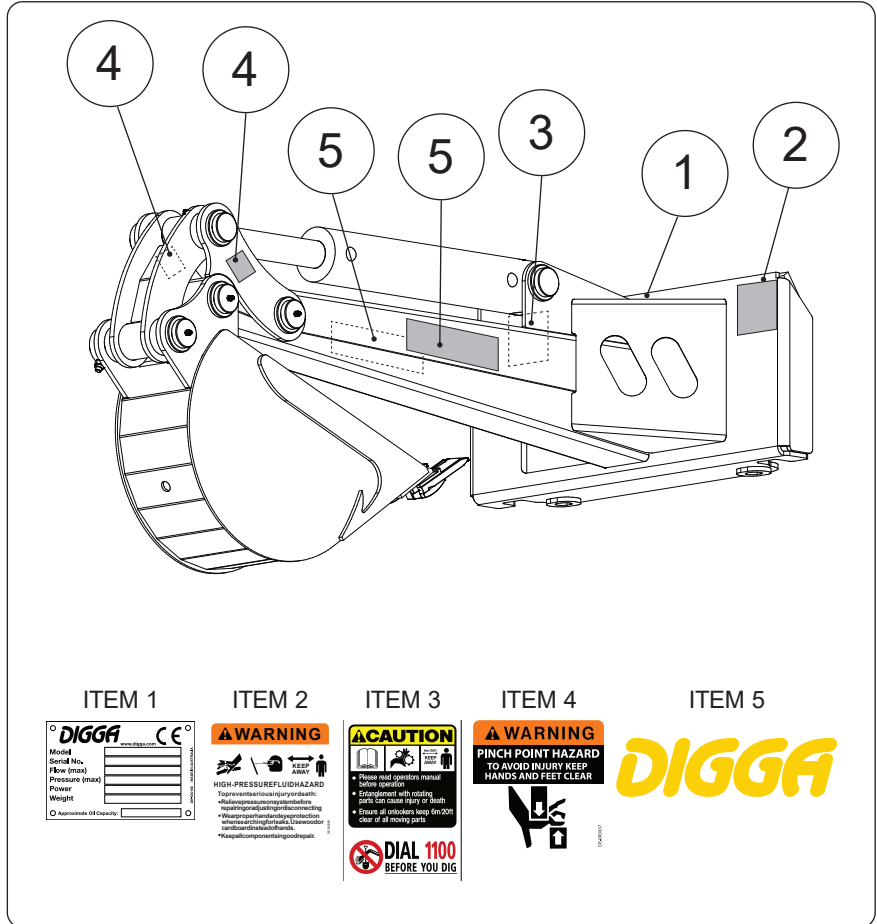

ITEM NO	ORDER CODE	DESCRIPTION	QTY
1	DE-000063	Serial Tag	1
2	DE-000089	Warning	1
3	DE-000088	Caution: Dial Before You Dig	1
4	DE-000437	Pinch Point	2
5	DE-000049	Digga Logo	2

10 TROUBLESHOOTING

MINI SKID HOE		
TROUBLE	POSSIBLE CAUSE	REMEDY
Insufficient digging depth	Worn teeth on bucket	Replace teeth
		Contact Digga for more information about replacing wearparts.
Oil Leaking from cylinder hydraulic fittings	Hydraulic fittings not tight	Tighten hydraulic fittings
Attachment bucket not moving	Couplers not connected to loader	Inspect and connect accordingly

WARRANTY

All new Digga products are warranted to be free from defects in materials or workmanship, for a period of twelve (12) months from date of original purchase, which may cause failure under normal usage and service when used for the purpose intended.

In the event of failure within twelve (12) months from initial retail sale, lease or rental date (excluding cable, ground engaging parts such as sprockets, digging chain, bearings, teeth, tamping and demolition heads, blade cutting edges, pilot bits, auger teeth, auger heads & broom bristles), if after examination, Digga determines failure was due to defective material and/or workmanship, parts only will be repaired or replaced.

Digga may request defective product or products be returned prepaid to them for inspection at their place of business at 4 Octal Street Yatala, Queensland, or to a location specified by Digga. The warranty will be considered void if the product or any part of the product is modified or repaired in any way not expressly authorized by Digga, or if closed components are disassembled prior to return. Closed components include, but are not limited to: gearboxes, hydraulic pumps, motors, cylinders and actuators. Any goods returned to Digga by the customer under warranty or repair must have all freight charges prepaid for on the customers account.

Any claims under this warranty must be made within fifteen (15) days after the Buyer learns of the facts upon which such claim is based. All claims not made in writing and received by Digga outside the time period specified above shall be deemed waived.

THIS WARRANTY IS IN LIEU OF ALL OTHER WARRANTIES EXPRESSED OR IMPLIED AND THERE ARE NO WARRANTIES OF MERCHANTABILITY OR OF FITNESS FOR A PARTICULAR PURPOSE. IN NO EVENT SHALL DIGGA BE LIABLE FOR CONSEQUENTIAL OR SPECIAL DAMAGE. DIGGA'S LIABILITY FOR ANY AND ALL LOSSES AND DAMAGES TO BUYER, RESULTING FROM ANY CAUSE WHATSOEVER, INCLUDING DIGGA'S NEGLIGENCE, IRRESPECTIVE OF WHETHER SUCH DEFECTS ARE DISCOVERABLE OR LATENT, SHALL IN NO EVENT EXCEED THE PURCHASE PRICE OF THE PARTICULAR PRODUCTS WITH RESPECT TO WHICH LOSSES OR DAMAGES ARE CLAIMED, OR, AT THE ELECTION OF DIGGA, THE REPAIR OR REPLACEMENT OF DEFECTIVE OR DAMAGED PRODUCTS.



Australian Designed and Manufactured

Available through

**EARTHMOVING
WAREHOUSE**

earthmovingwarehouse.com.au

0459927346 (0459 WAREHOUSE)
Shed C1/C2 194 Zillmere Road,
Boondall Brisbane 4034
QLD