

全金属起落架 减震刹车脚架

Full metal landing gear
struts with wheel and brake

使用说明书 Manual

感谢您对本产品的支持

- 请在使用前仔细阅读本说明书
- 在使用前务必阅读 (安全注意事项)
- 阅读后请妥善保管此说明书

Thanks for your supporting of us.

- Please reading the manual carefully before using .
- Be sure you have read attentions when using.
- Keep it for next reading.

三. 产品组装 III. Assembling

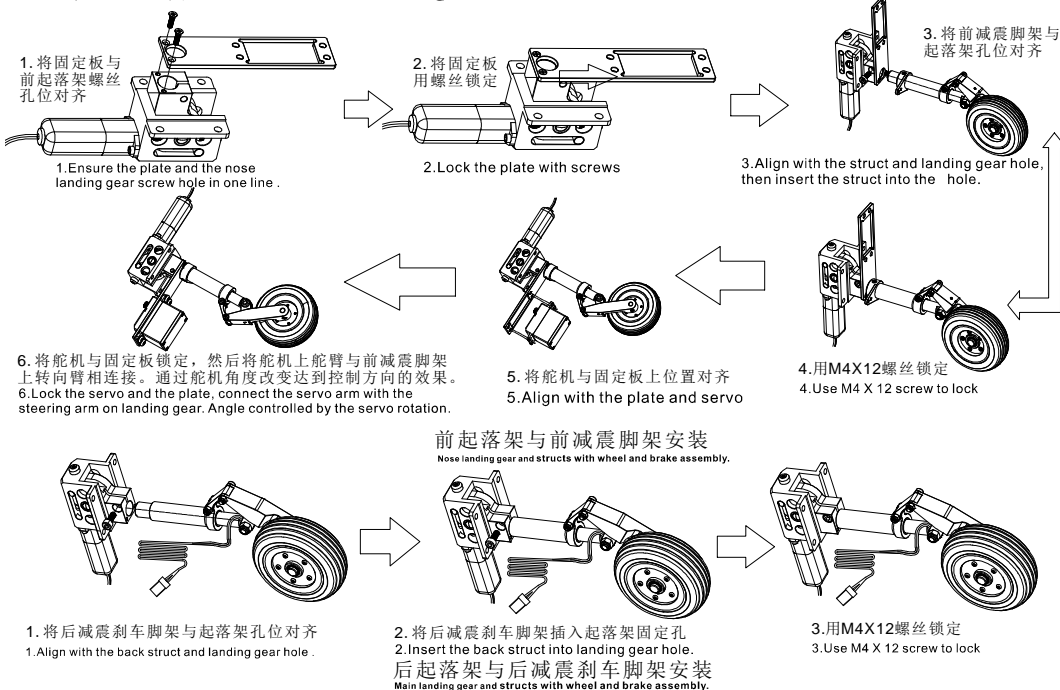

一. 产品概况

1. 本配套产品机身由全金属CNC加工而成;
2. 全金属起落架与减震刹车脚架配合使用;
3. 全金属起落架: 前1PCS, 后2PCS为一套; 刹车减震脚架: 前1PCS, 后2PCS为一套;
4. 起落架一套重量: 390克; 减震刹车脚架一套重量: 746克;
5. 本配套产品由独立控制盒提供控制程序;
6. 本配套产品适用于起飞重量13-15KG固定翼飞机。

I. Overview

1. The body made by CNC processing.
2. Landing gear & struts with wheel and brake is a group
3. A set landing gear includes 1 PC nose gear and 2 PCS main gear; same as the struts with wheel and brakes
4. Total weight of a set landing gear is 390g ; Total weight of a set struts with wheel and brakes is 746g
5. Owned the control program itself.
6. Suitable for fixed-wing airplane (takeoff weight is 13-15KG)

二. 产品包装清单 II. Packing list

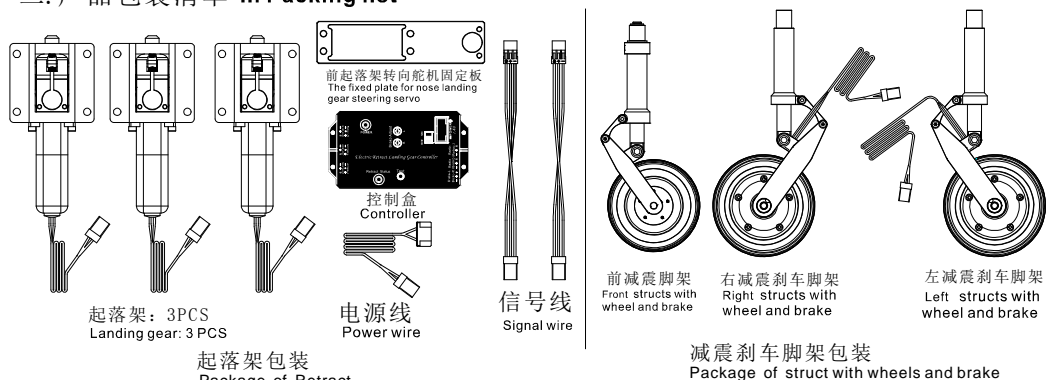

四. 操作步骤及特点

1. 按照接线原理图分别将电源 (DC6.0-7.4V), 舵机, 起落架, 遥控器; 刹车与控制板连接。
2. 点按测试按钮起落架开始动作. 指示灯亮表示起落架放下, 灯灭表示起落架收起.
3. 拨动遥控器对应的通道摇杆, 起落架开始动作, 同时指示灯亮表示起落架放下. 灯灭表示起落架收起. (起落架打开动作时, 前轮盖板和后轮盖板先打开, 动作完成后, 后轮盖板闭合; 起落架收起动作时, 后轮盖板先打开, 动作完成后, 后轮盖板闭合。)
4. 只有在起落架打开的状态下, 拨动遥控器所对应的通道摇杆, 才有启动刹车.
5. 调节电位器更改对应刹车的最大强度(逆时针增大刹车强度, 顺时针减弱刹车强度.)
6. 供电电压低于5V, 8S后起落架自动打开.
7. 掉电记忆功能.
8. 拨动电源供电开关切换控制板供电.

IV: Operating steps and Features:

1. Connect the power (DC6.0-7.4V). servo. landing gear. Remote, brake with controller. see the step-7 drawing.
2. Press the test button then landing gear begin to work, light turn on-landing gear down, light turn off- landing gear up.
3. Toggle channel joystick, the landing gear start, the light turn on means it down, light turn off means it up.
4. The brake only works when the landing gear is open .
5. Adjust potentiometer to change brake's max intensity(clockwise to increase, anticlockwise to reduce)
6. landing gear work automatically after 8s when the voltage is lower than 5V
7. Power off memory functions
8. Toggle switch to controller board as power supply.

五. 产品电气参数

1. 输入电压范围: DC6.0V-7.4V.
2. 工作电流: 800mA.
3. 起落架打开时间: 6S
4. 刹车最大堵转电流: 1.3A(单侧)
5. 起落架控制信号脉冲宽度范围: 300us---2500us. (300-1200起落架打开, 1700-2400起落架收起)
6. 刹车控制信号脉冲宽度范围: 1000us---2000us. (随着脉宽的增大, 刹车强度增大)

V: Specifications:

1. Input Voltage: DC6.0-7.4V
2. Stall Current: 800mA
3. Landing gear opening time: 6s
4. Max current of brake: 1.3A(single)
5. Landing gear input pulse range: 300-2500us (<1200us--UP, >1700us Down)
6. Brake input pulse range: 1000-2000us (pulse width increases, the braking intensity stronger)

六. 产品规格 VI. Size information.

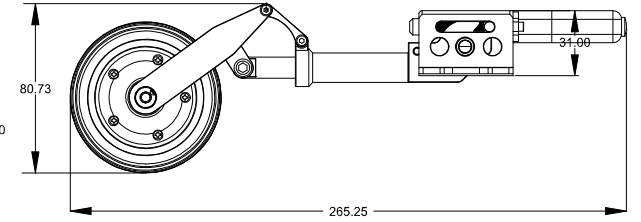
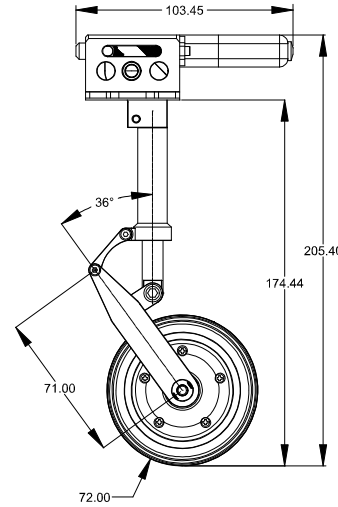
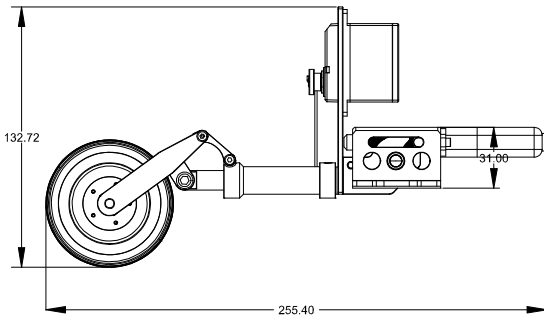
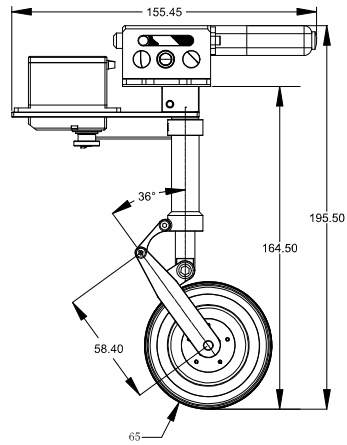
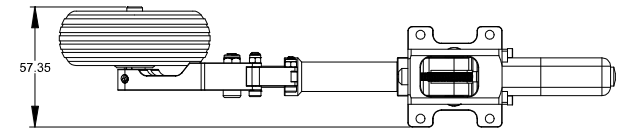
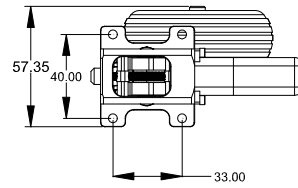
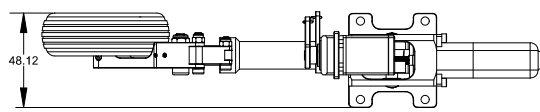
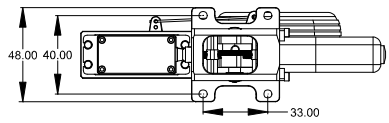

前起落架+前减震刹车脚架
Nose landing gear + struts with wheel and brake

后起落架+后减震刹车脚架
Main landing gear + struts with wheel and brake

七. 产品组装接线图 VII. Assembling Drawing

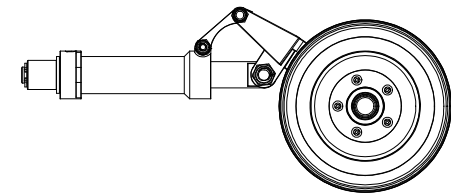
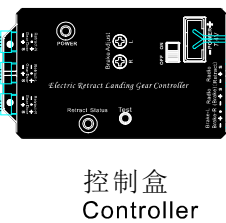
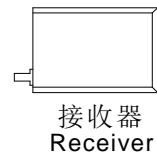
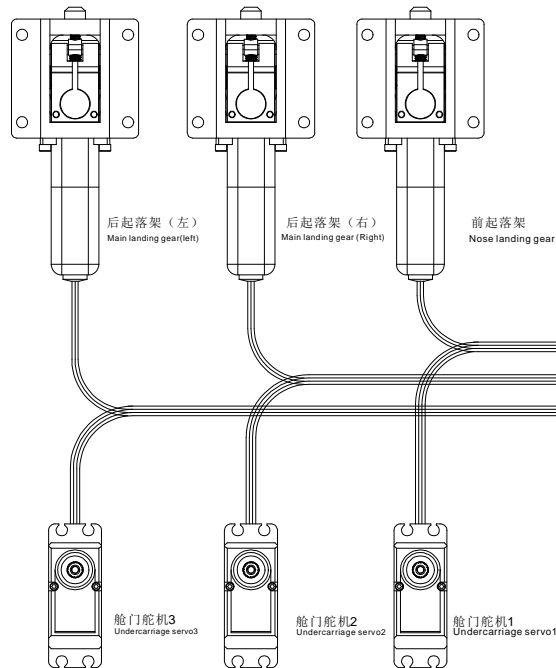

前减震脚架
Front struts with wheel and brake

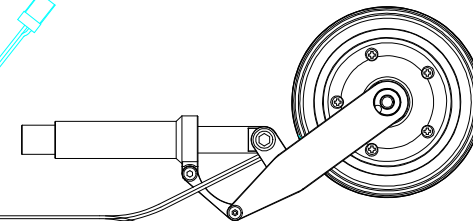

左减震刹车脚架
Left struts with wheel and brake

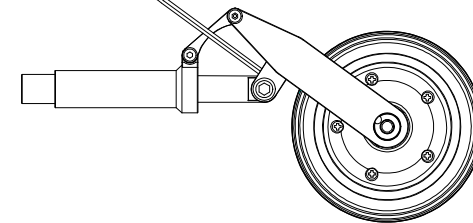

右减震刹车脚架
Right struts with wheel and brake