

Prescient^x Aranet4 Wall Mount Instruction

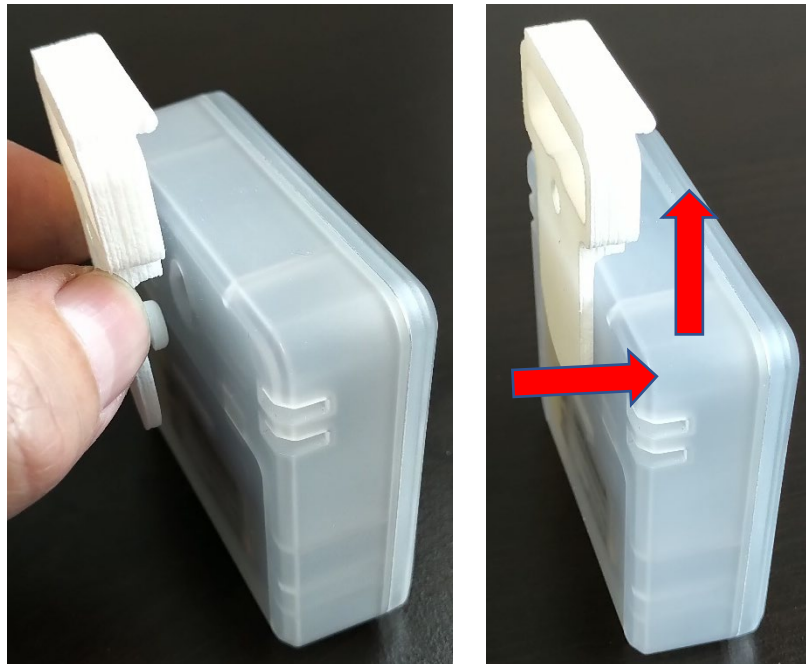

1. Insert the white mounting clip at the back of the Aranet4 unit:



2. Insert the locking plate (the plate with Prescient^x logo), make sure it is fit in between the Aranet4 unit and the mounting clip lip, then line up the screw hole:



3. Mount the unit on the wall with the Tamper Resistant Torx Screw and T25 Security Torx Screwdriver Bit (screwdriver handle not included) directly onto a stud or between studs using the drywall anchor supplied:

