



Felt Flower Succulent

step by step tutorial



To complete these flowers you will need:

- *Heartgrooves Handmade Felt Flower Succulent Kit
- *Hot glue gun (mini high heat recommended)
- *Glue sticks
- *Scissors (preferably sharp)
- *Container or project base of your choice (birch planter pictured)
- *Styrofoam for container
- *Moss

Kit Contents:

The felt used is high quality wool blend felt. A small amount of hand cutting is required for one of the flowers, the remainder have been pre cut into shapes using a die cut machine and are ready to be assembled. The kit includes:

- * 9 poppy flowers
- * 12 small flowers
- * 3 small flowers
- * 24 ovals
- * 1 mini rolled rose
- * 1 freezer paper sheet template with hand drawn petals on felt
- * 12 leaves

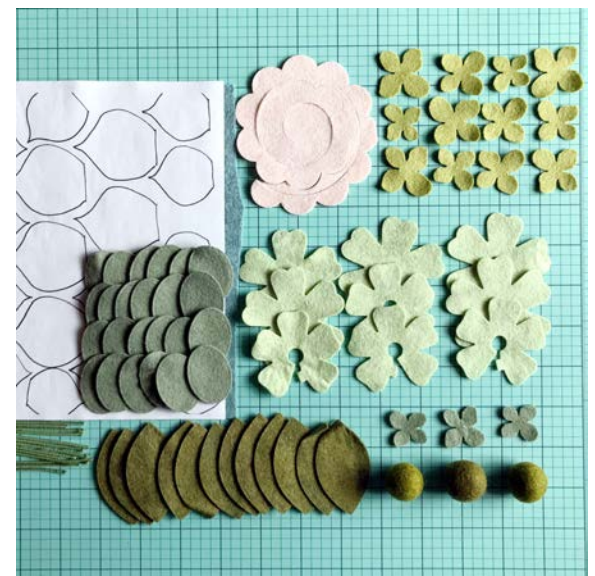



Large Succulent:

*Cut petal shapes from freezer paper template on the felt sheet. There are 6 smaller petals and 12 larger petals.

*Peel freezer paper from each cut petal.

*Start by placing a dot of glue in the corner of the flat side of a small petal. Place piece of floral wire in the glue (not pictured).

*Fold over and pinch to start rolling.

*Glue along flat edge and roll to form a "trumpet".

*Glue along the bottom of another small petal and place around the first petal by lining up the bottom center and wrapping it around, allowing the edges to move upwards to form a cup. The petals will be overlapping quite a bit.

*Repeat this step and adhere a 3rd small petal but on the opposite side of the 2nd petal, this forms the very center of the flower.

*Now start working in layers of 3 or 6 by gluing the remaining 3 small petals evenly spaced around the flower center using the same cupping technique.

*Glue 3 large petals alternating with the last layer of petals.

*Add another layer of 3 large petals, again alternating with the last layer.

*With the remaining 6 petals, place so that the points on the top of the petals are positioned in each space created by the last 2 layers to form a wide base.

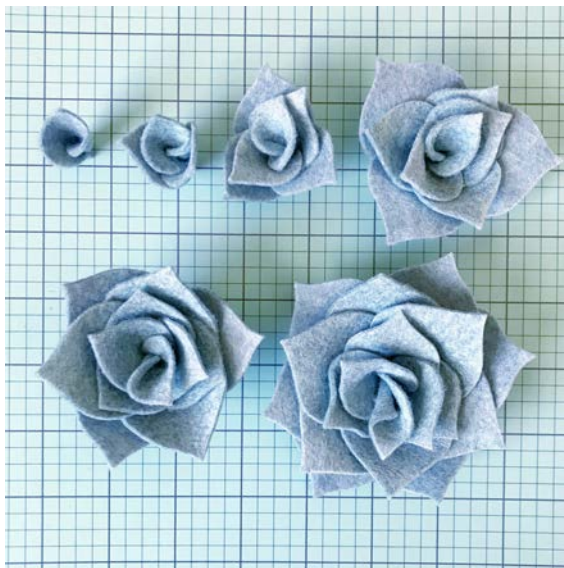

Berries:

* Using a sharp tool, form a hole in the felt ball. Place a dot of glue on a piece of floral wire and insert by twisting into the hole.

* Cut a small slit into the small sage flower and slide onto floral wire.

* Using a small dot of glue, secure flower to bottom of the felt ball to form a "leaf" base.

* Repeat to complete 3 berry stems.

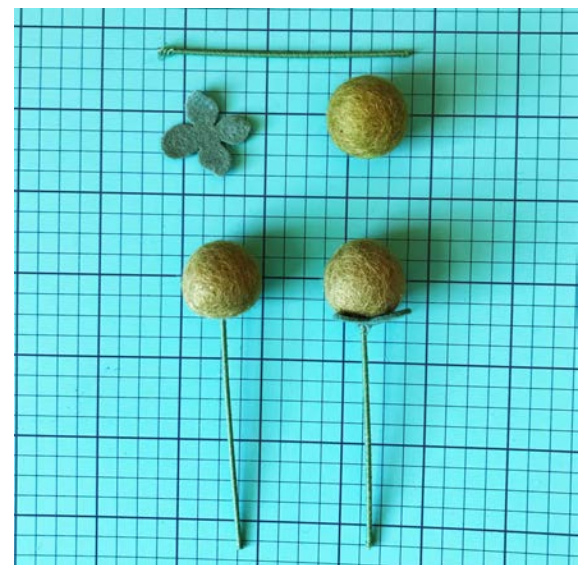

Mini Rolled Rose:

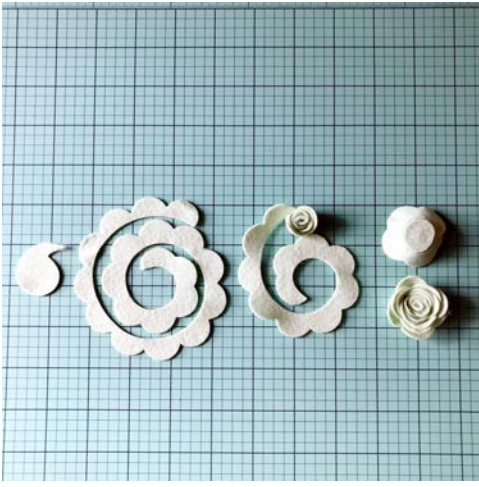

- * Discard any extra slivers of felt that are in the rose spiral. Keep the circle shape from the middle to use as the base of the flower. The scalloped side will be the top of the finished flower.
- * The outside end of the spiral is the inside of the rose, so start by placing a small dot of glue on the bottom corner. Place floral wire in glue (not pictured).
- * Fold felt over the wire and pinch to start rolling.
- * Roll gently (not pulling tight) keeping the bottom of the flower flat until the end of the spiral. Use dots of glue as needed along the way.
- * Place a dot of glue on the end to secure it.
- * Cut small slit into center of the circle shape.

- * Spread glue all over the flat bottom of the flower and slide the circle over the floral wire and secure it to the bottom of the flower. The circle will be too big, so trim it when the glue is dry.

Wavy Succulent:

- * Put a dot of glue on the bottom edge of the petal next to the tab on the open section of the flower. Place floral wire in the glue.
- * Wrap the flower around the floral wire, keeping the bottom tight around the wire, the top of the flower should flare out.
- * Add a second flower to the first by gluing it right next to where the first flower ended, continuing to wrap it around the wire.
- * Add the third flower in the same way. Repeat to create 3 of these succulents.
- * If there are slightly different size poppy cut outs, always start with smaller and end with larger.



Stacked Greenery:

- * Cut a small slit into the center of each of 4 small petal cut outs. Be careful! It's easy to cut through the whole petal on the smaller ones.
- * Slide a smaller sized petal into a piece of floral wire, add glue to the tip of the wire and fold petal over it to cover the wire.
- * Add glue right at the base of the petal and let it cool for just a second, then slide the next petal onto the wire and touch it to the glue. Letting the glue cool slightly creates a small space between the petals to add dimension to your finished flower.
- * Add the next 2 petals in the same fashion.

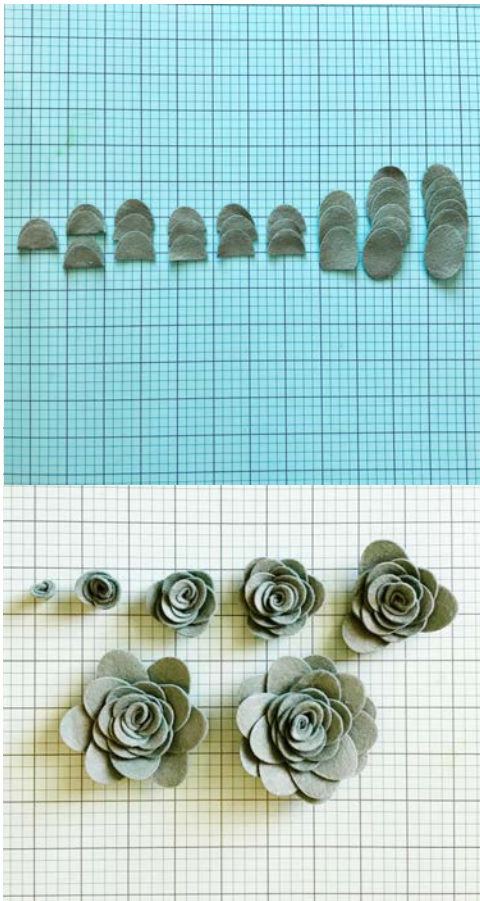

Large Oval Petal Succulent:

- * Organize ovals into groups as pictured. This will make it much easier to keep track of the progression as the flower is constructed.
- * Put a dot of glue in the middle of each of 3 ovals and fold in half, with one side slightly lower than the other. These will create the center of the flower and form the first 2 piles.
- * Cut 6 ovals in half on the short side, place in 4 piles of 3.
- * Cut a small sliver off the bottom of 3 ovals, this will be the next pile.
- * The remaining 12 ovals will be the last 2 piles of 6 each.
- * Start by rolling the first oval that is folded in half. Place glue across the flat side of the fold, add floral wire (not pictured) and roll.
- * From the 2nd pile, put glue across the flat side and wrap around the rolled oval. This will overlap quite a bit.
- * Do the same with the 3rd folded oval, placing this directly across from the 2nd oval.
- * Add the next 3 ovals that have been cut in half evenly around the center piece.
- * Add the next 4 piles of 3 ovals in the same fashion, but alternating each layer of petals.
- * For the next pile of 6 ovals, add these evenly between the last layers, there will be 2 ovals between each of the petals on the last layer.
- * Add the final pile of 6 ovals alternating with the last layer.

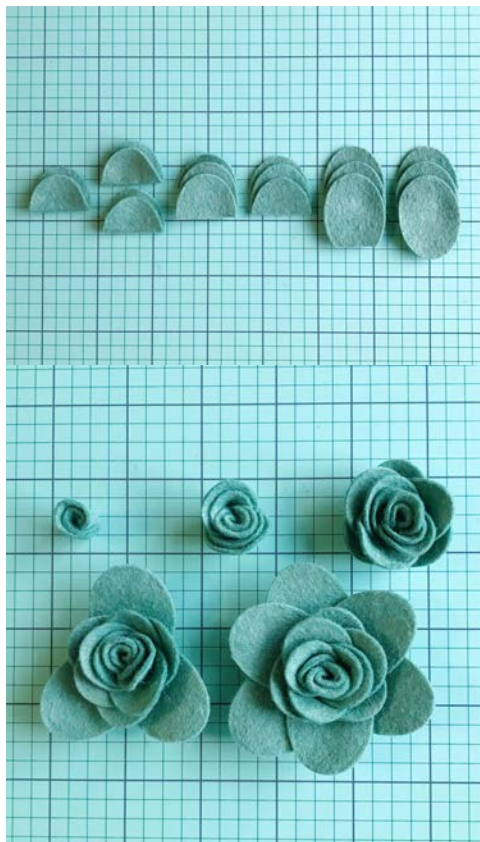

Alternative to make 2 small Oval Petal Succulents:

- * Organize ovals into groups as pictured. This will make it much easier to keep track of the progression as the flower is constructed.
- * Put a dot of glue in the middle of each of 3 ovals and fold in half, with one side slightly lower than the other. These will create the center of the flower and form the first 2 piles.
- * Cut 3 ovals in half on the short side, place in 2 piles of 3.
- * Cut a small sliver off the bottom of 3 ovals, this will be the next pile.
- * The remaining 3 ovals will be the last pile.
- * Start by rolling the first oval that is folded in half. Place glue across the flat side of the fold and roll.
- * From the 2nd pile, put glue across the flat side and wrap around the rolled oval. This will overlap quite a bit.
- * Do the same with the 3rd folded oval, placing this directly across from the 2nd oval.
- * Add the next 3 ovals that have been cut in half evenly around the center piece.
- * Add the remaining piles ovals in the same fashion, but alternating each layer of petals.

* Place the last 2 piles of larger ovals more flat against the bottom of the flower. This will create a more flat flower that forms out rather than up.

Pointed Petal Succulent:

*Start by snipping one end of each leaf shape, about 1/4 inch to create a flat side, this will create the bottom side of the flower.

*Start by placing a dot of glue in the corner of the flat side of a petal. Place floral wire on glue before rolling (not pictured).

*Fold over and pinch to start rolling.

*Glue along flat edge and roll to form a "trumpet".

*Glue along the bottom of another petal and place around the first petal by lining up the bottom center and wrapping it around, allowing the edges to move upwards to form a cup. The petals will be overlapping quite a bit.

*Repeat this step and adhere a 3rd petal but on the opposite side of the 2nd petal.

*Now glue 3 petals evenly spaced around this flower center using the same technique.

*Glue another 3 petals alternating with the last layer of petals.

*Add layers of 3 in this fashion until 12 petals have been used.



Putting it all together:

*Finished flowers can be used in any type of arrangement. If using a container with styrofoam, floral wire will need to be added to the flowers. If making a wreath or another type of flat arrangement, no floral wire will be needed.

*Use a little hot glue on the ends of the floral wire to keep in place for styrofoam arrangements, add in moss last to fill in spaces.

*Always start with larger focal flowers and add in fillers. Keep colors distributed throughout the arrangement.

*Since succulents usually grow out vs up, place the flowers lower in a container to achieve a more natural look.

*Succulents look great with any type of felt flower, so grab another kit to mix and match.

