

## ARRANGE ALIGNMENT PLATES

1. Position the Alignment Plates adjacent to each other with the shaped sides facing inward.



## POSITION PRINTER

2. Set the printer between the Alignment Plates, aligning its feet with the notches in the Plates.
3. Slide the Alignment Plates inward beneath the printer until they press against the printer feet.

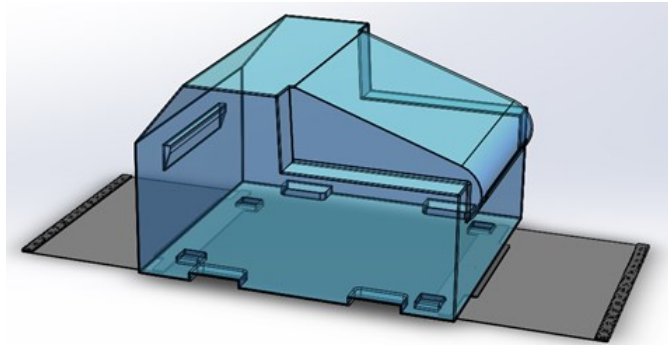

## POSITION WINDERS

4. Place Winders firmly in position next to the outer bars of the Alignment Plates.

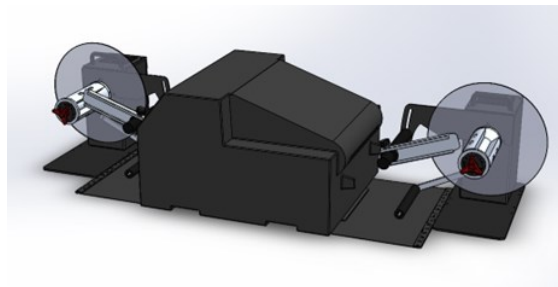

5. Align the Winders with the printer by sliding them forward/backward as necessary until the front base of the Winders is positioned at the 10.5" mark of the Alignment Plates.

