

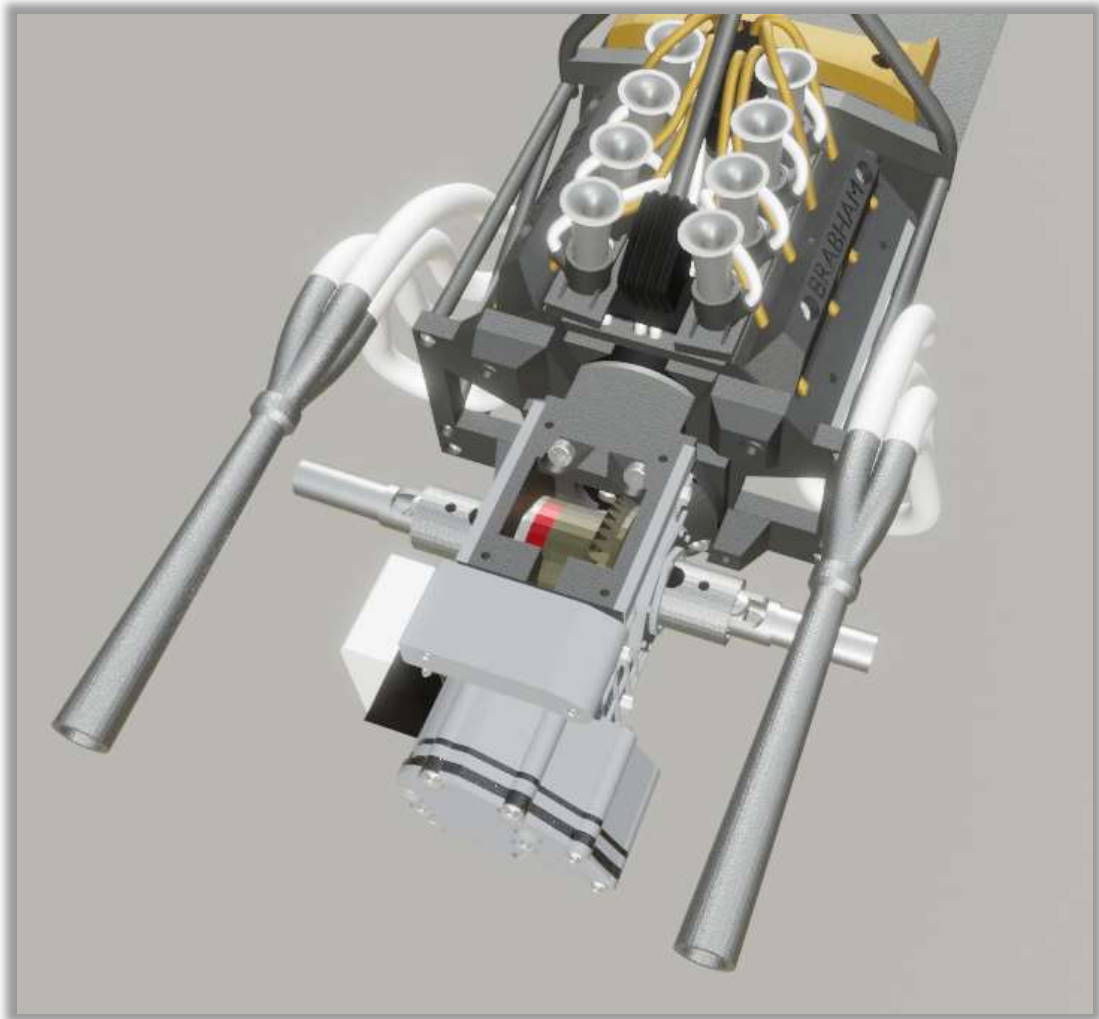

SECTION 9. Gearbox

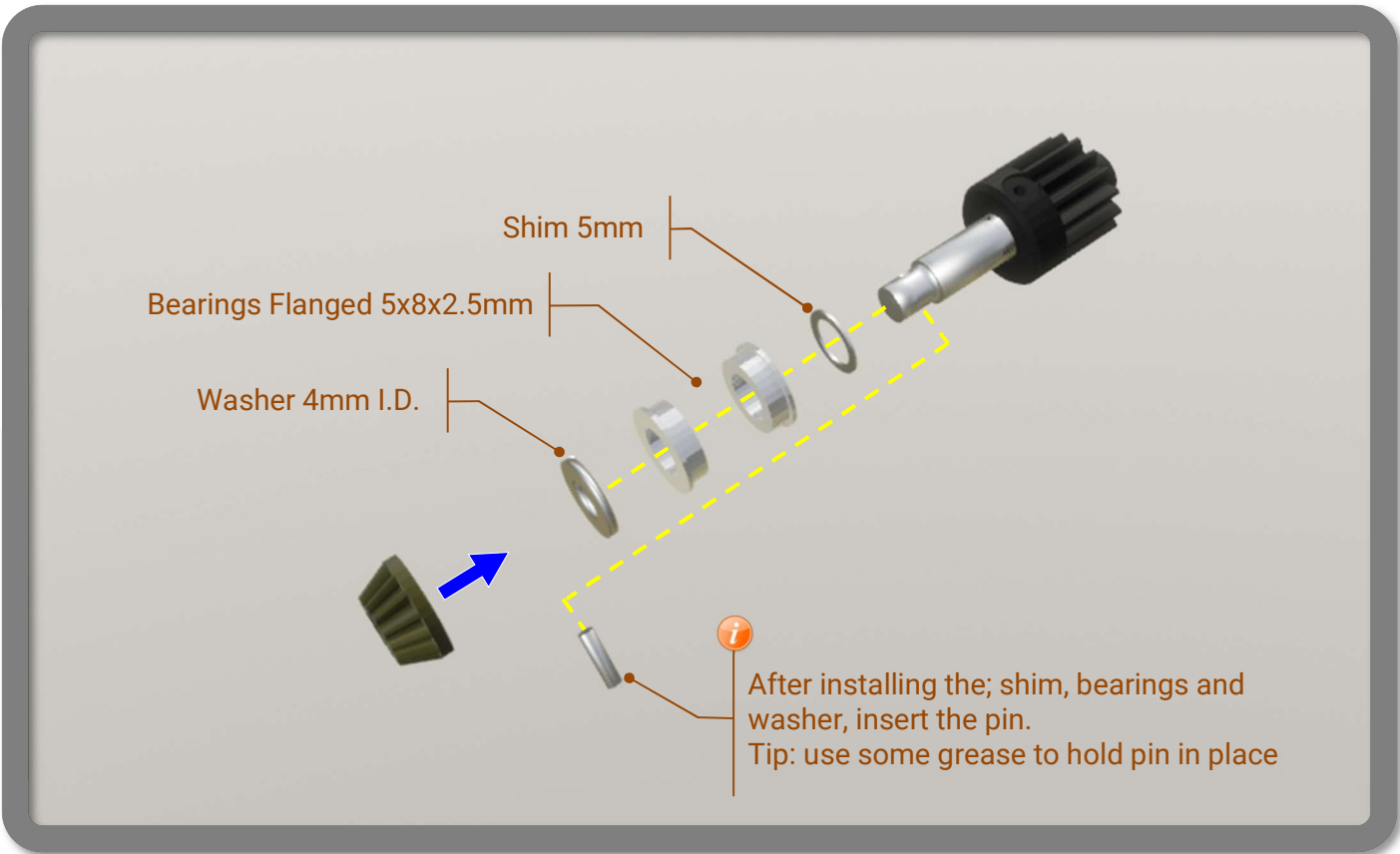

STEP 1 – UPPER LAYSHAFT

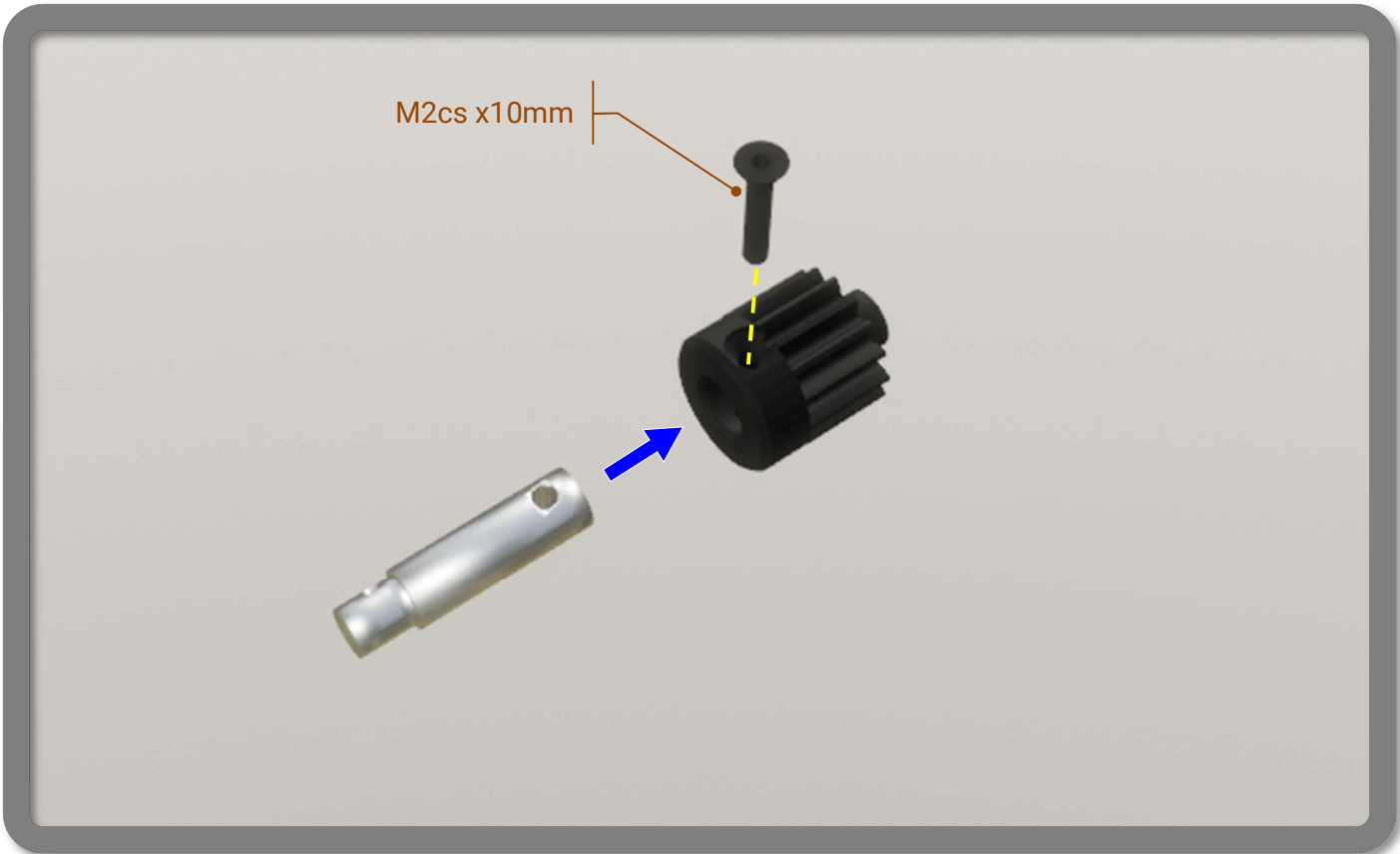

STEP 1 – UPPER LAYSHAFT

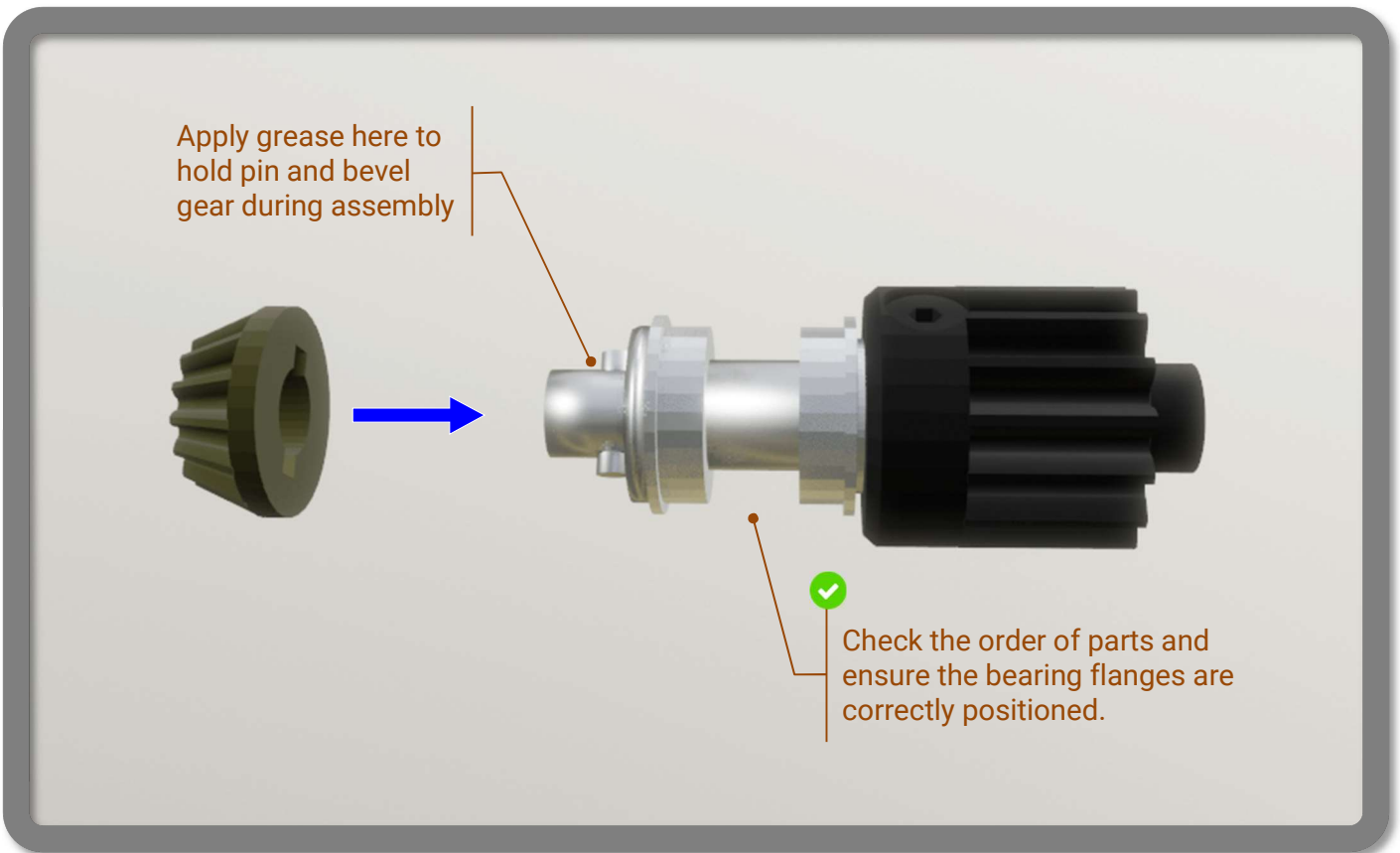

STEP 2 – LOWER LAYSHAFT

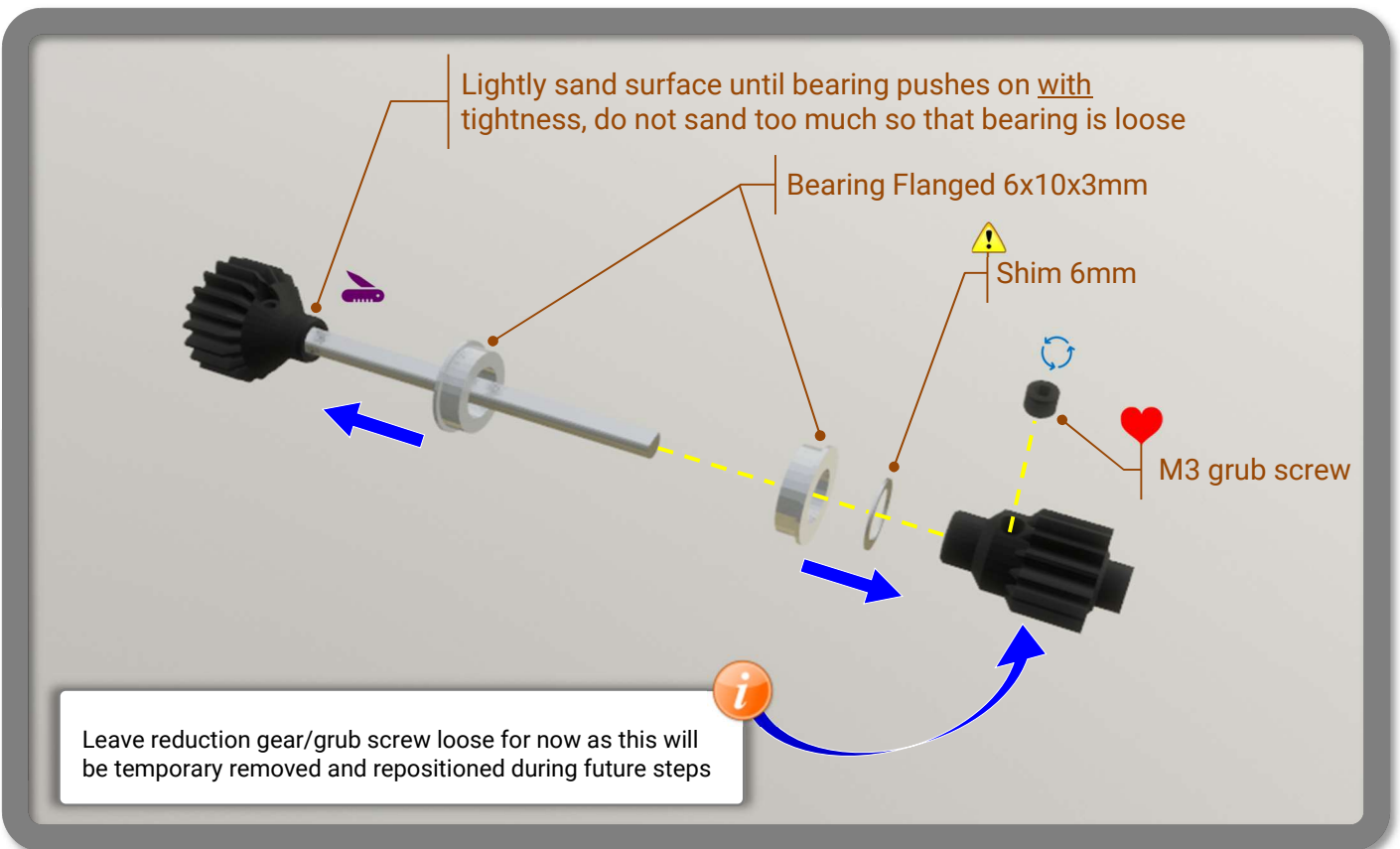
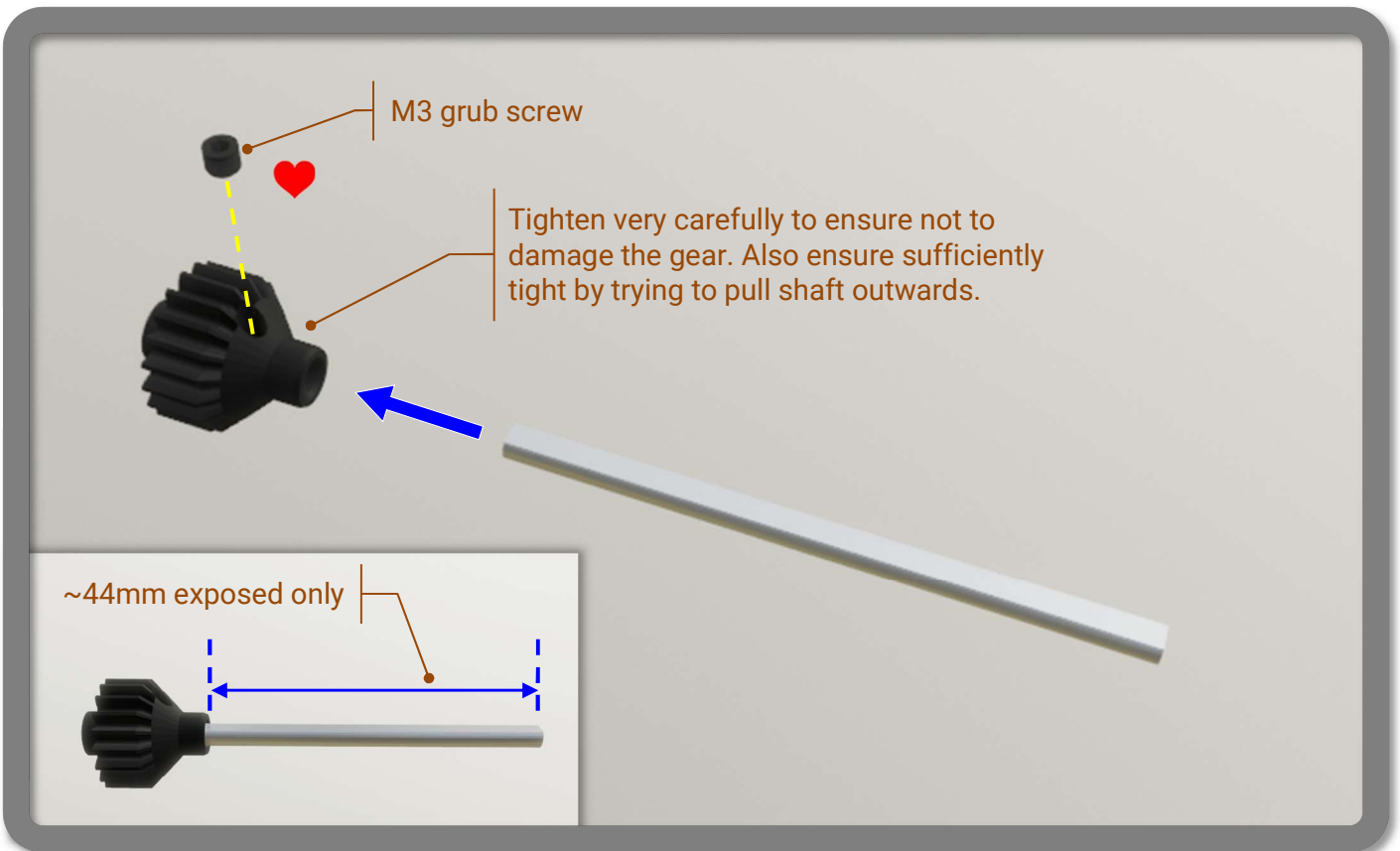

STEP 3 – GEAR MESH JIG

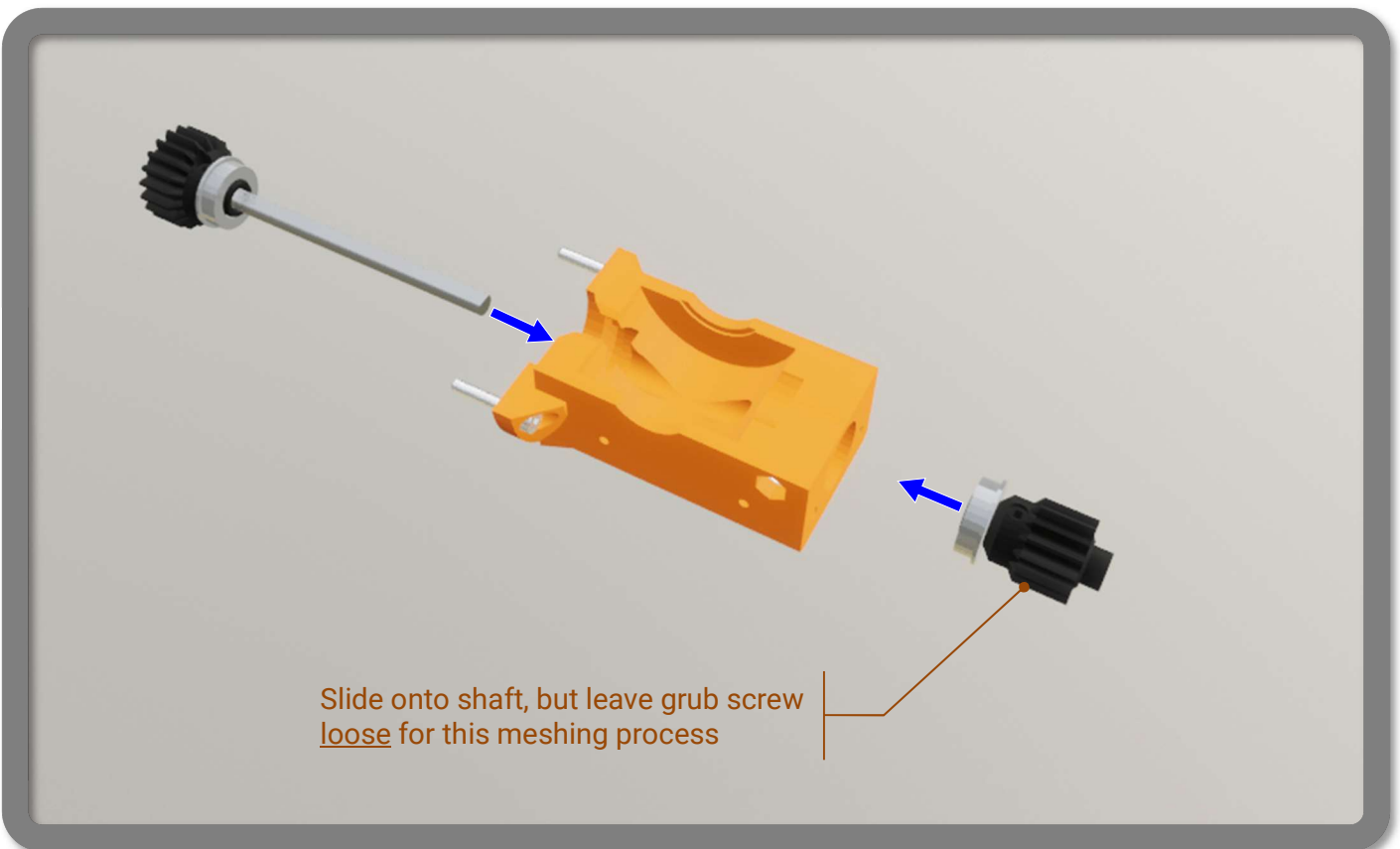
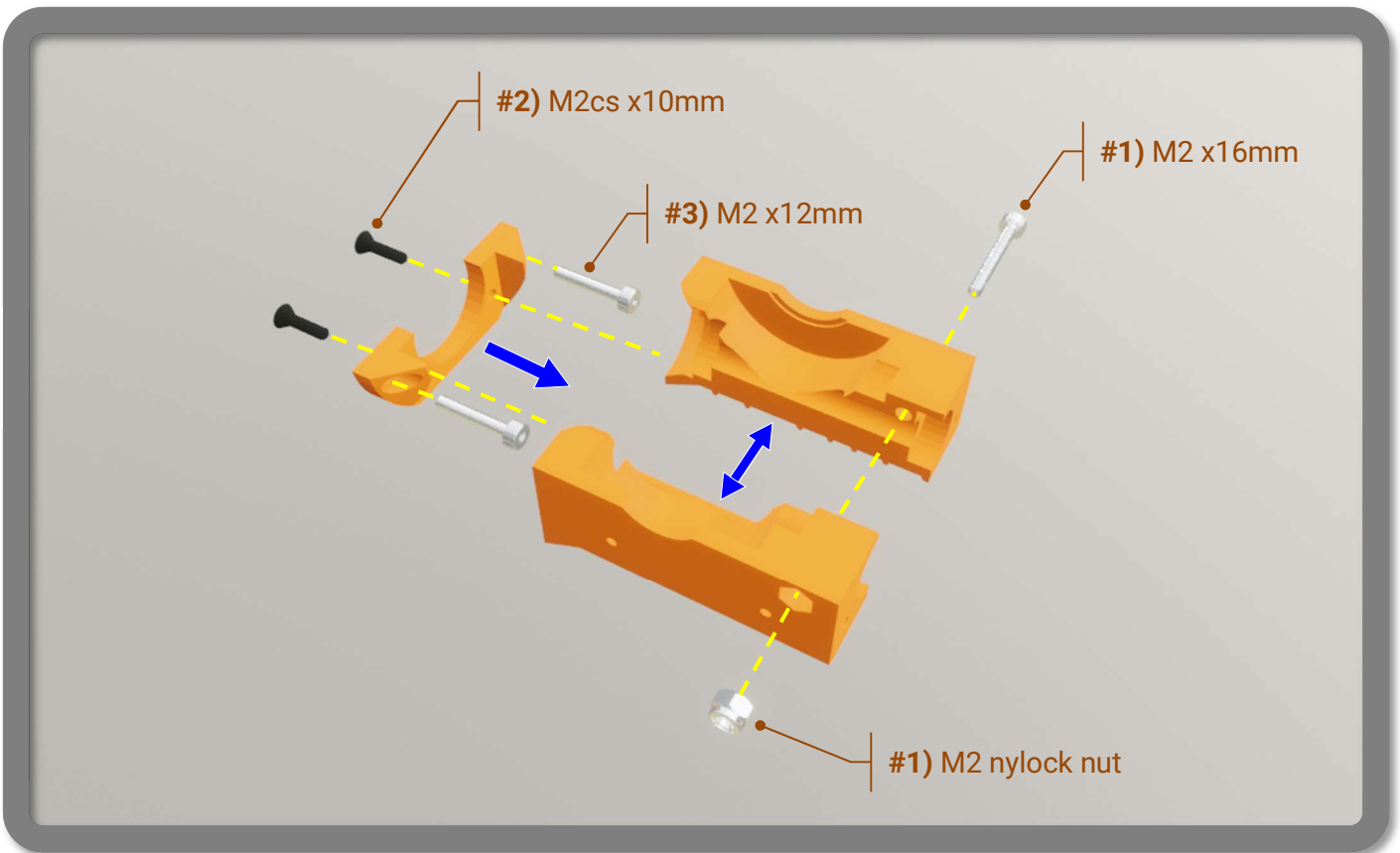

STEP 4 - GEAR MESH

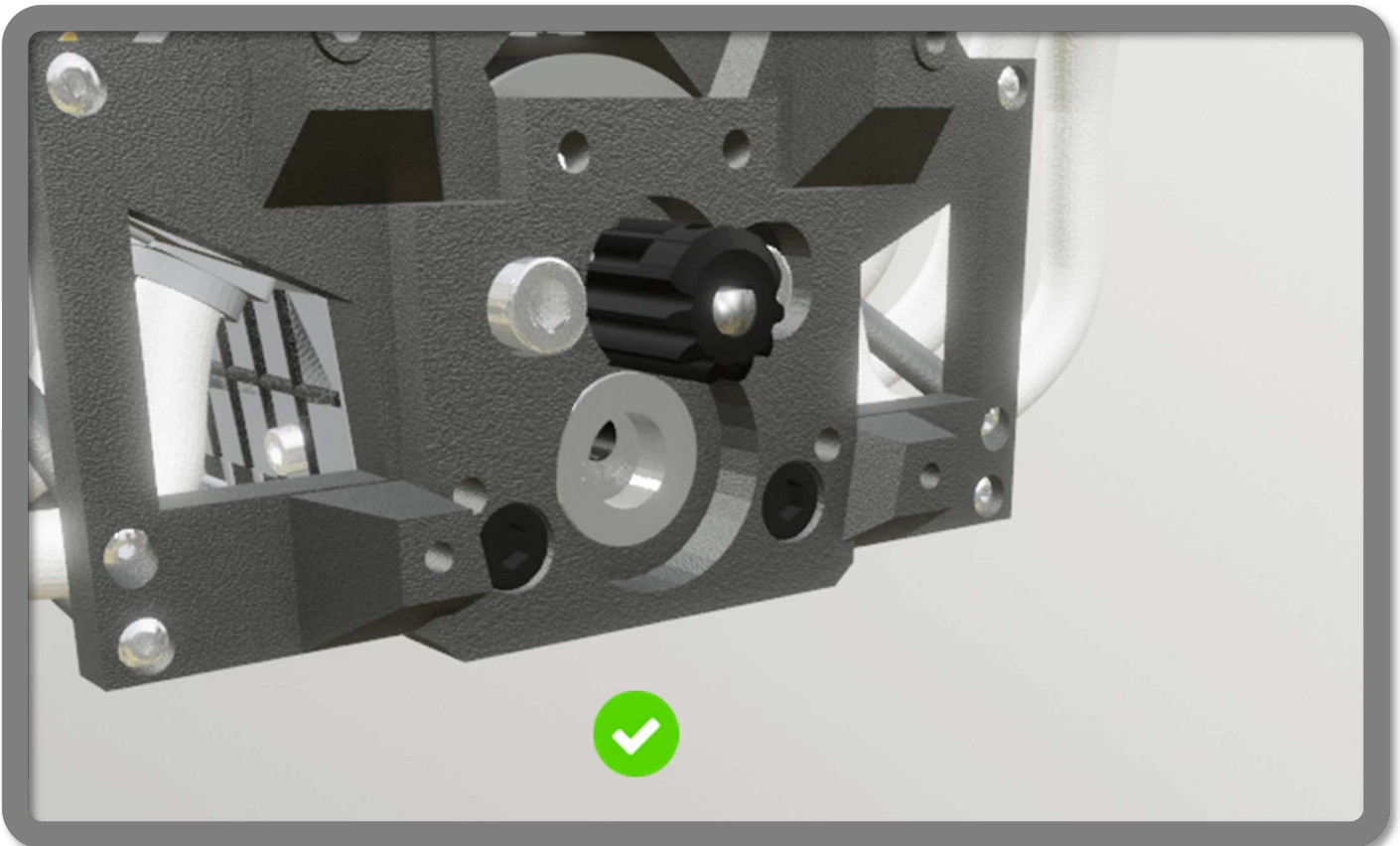
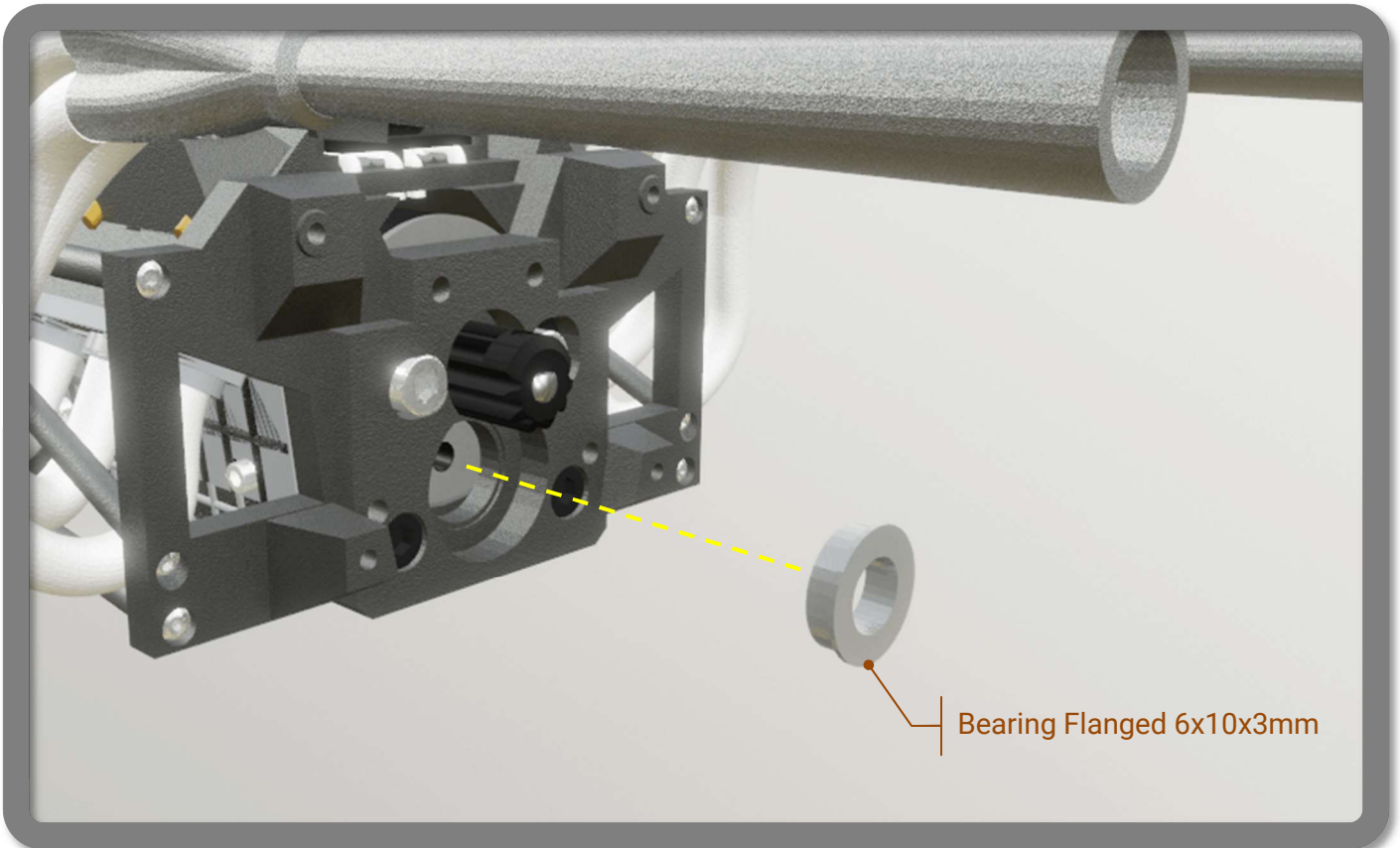

STEP 4 – GEAR MESH

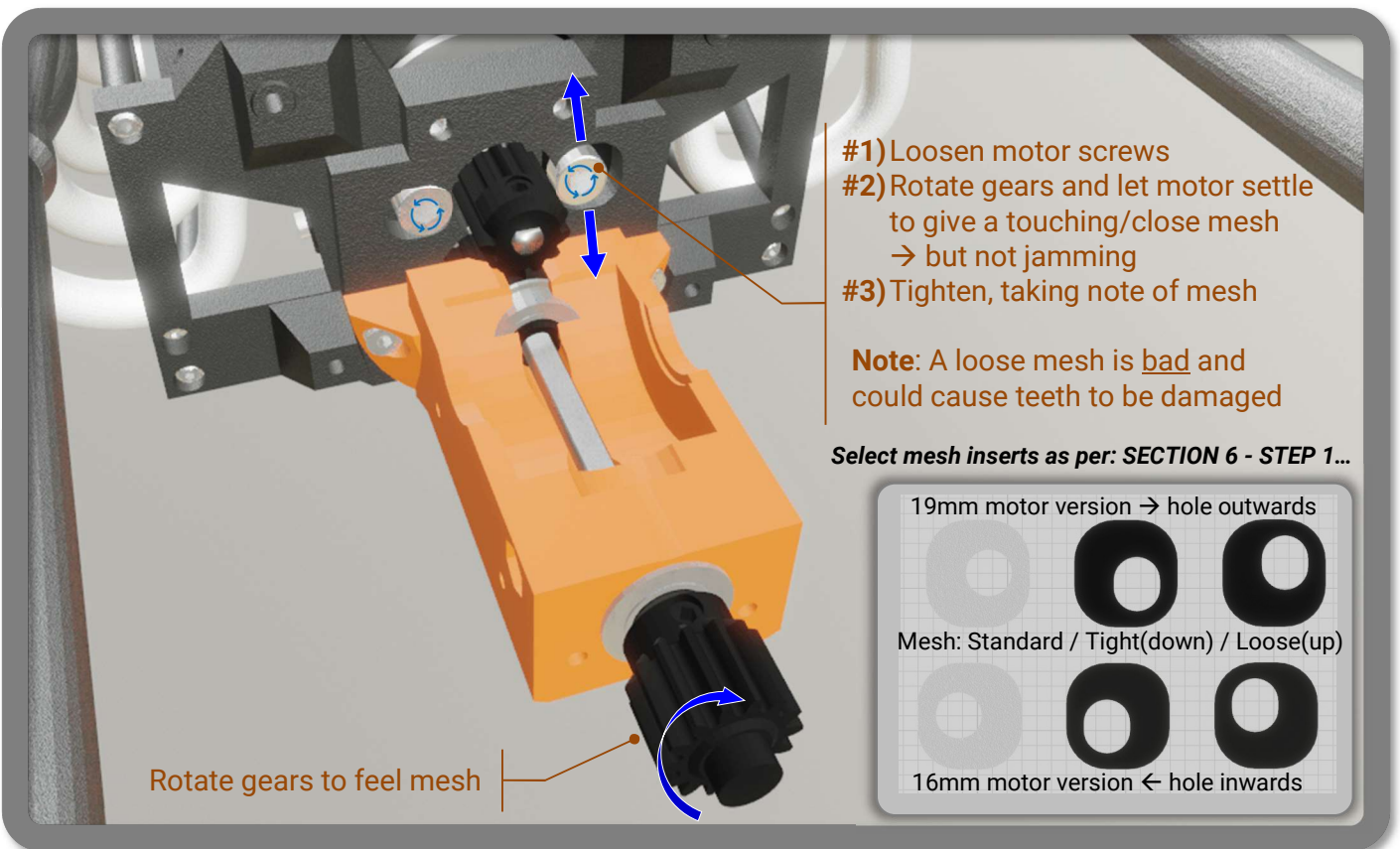
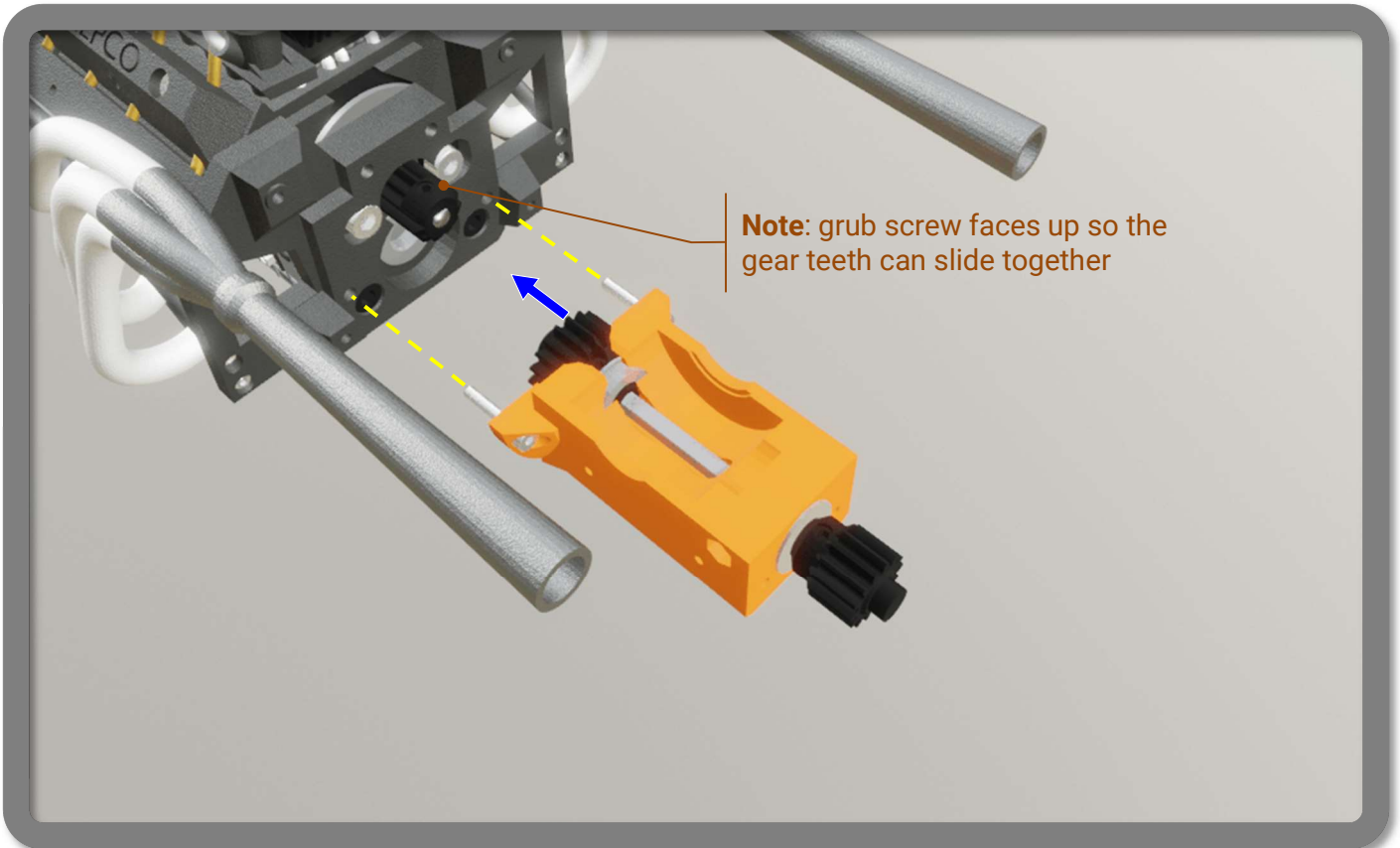

STEP 5 – DIFFERENTIAL

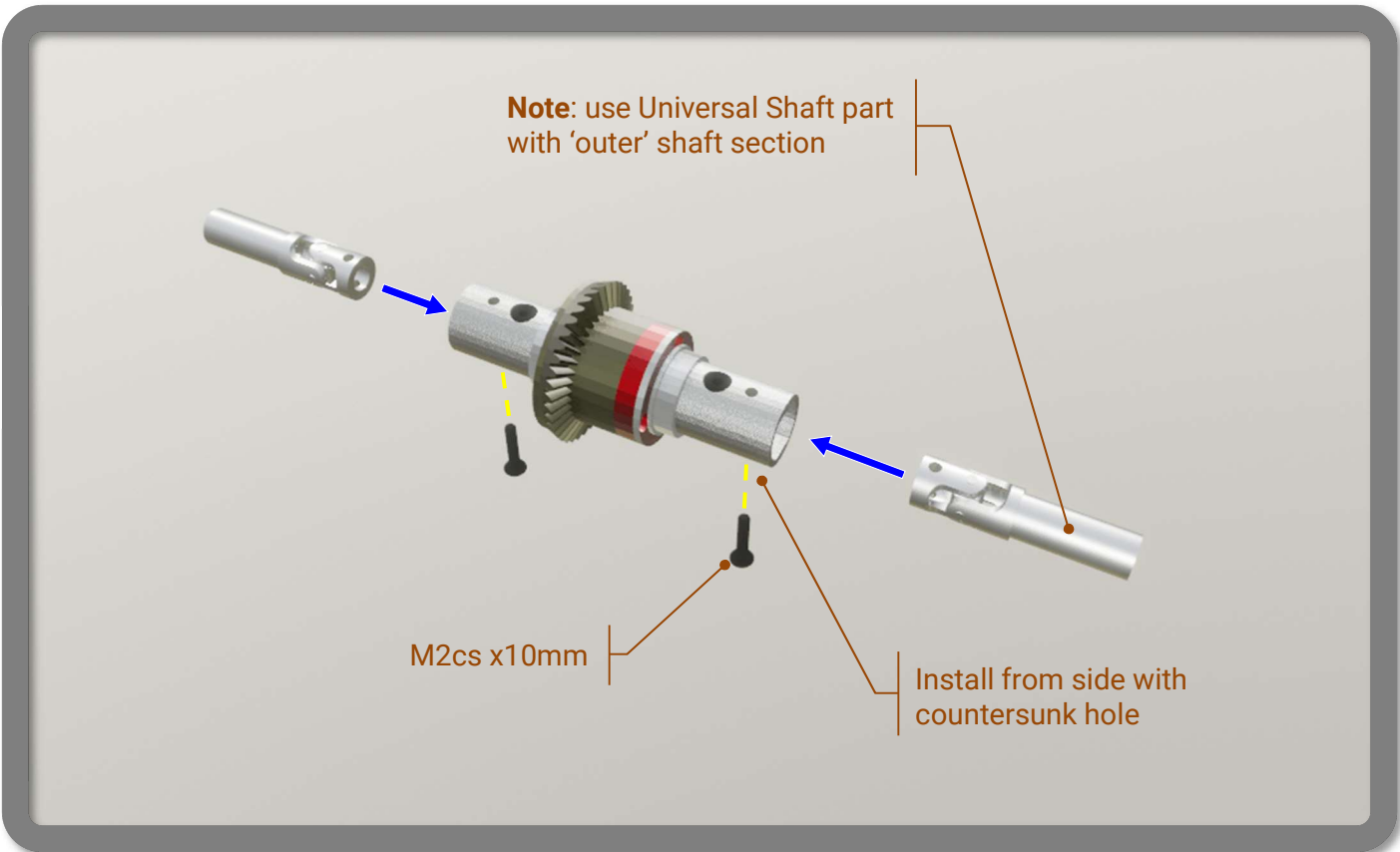
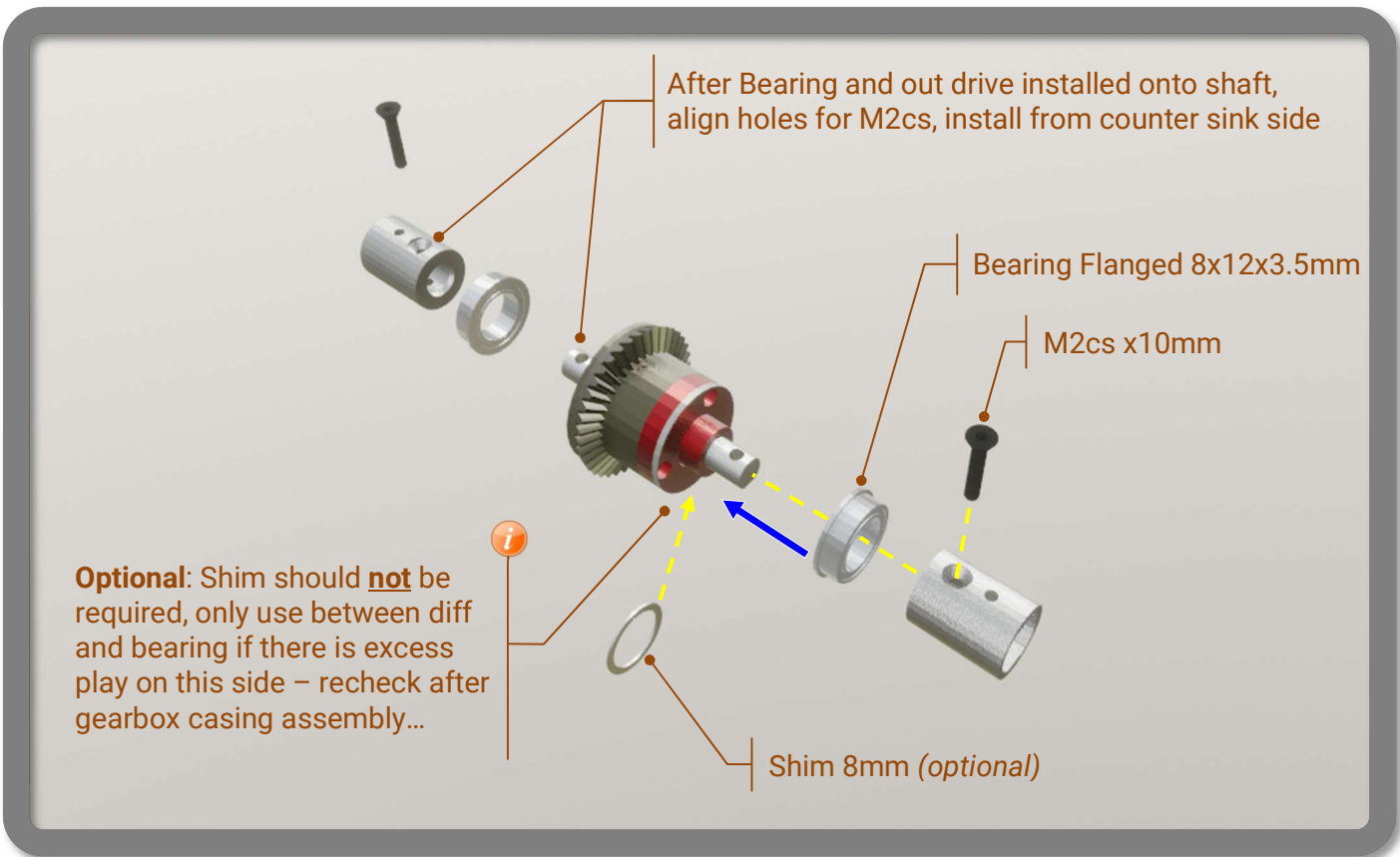

STEP 6 – GEARBOX CASING

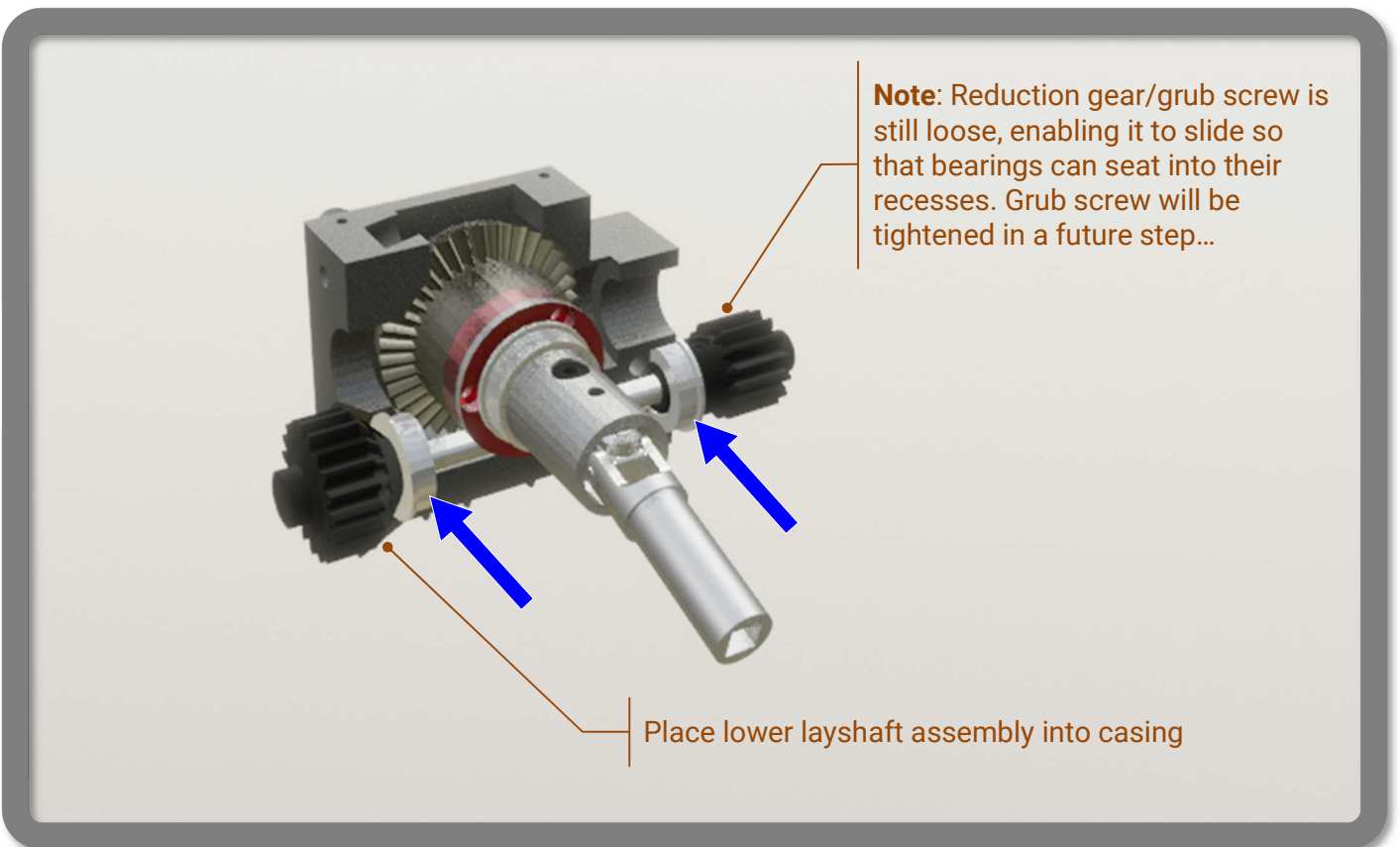
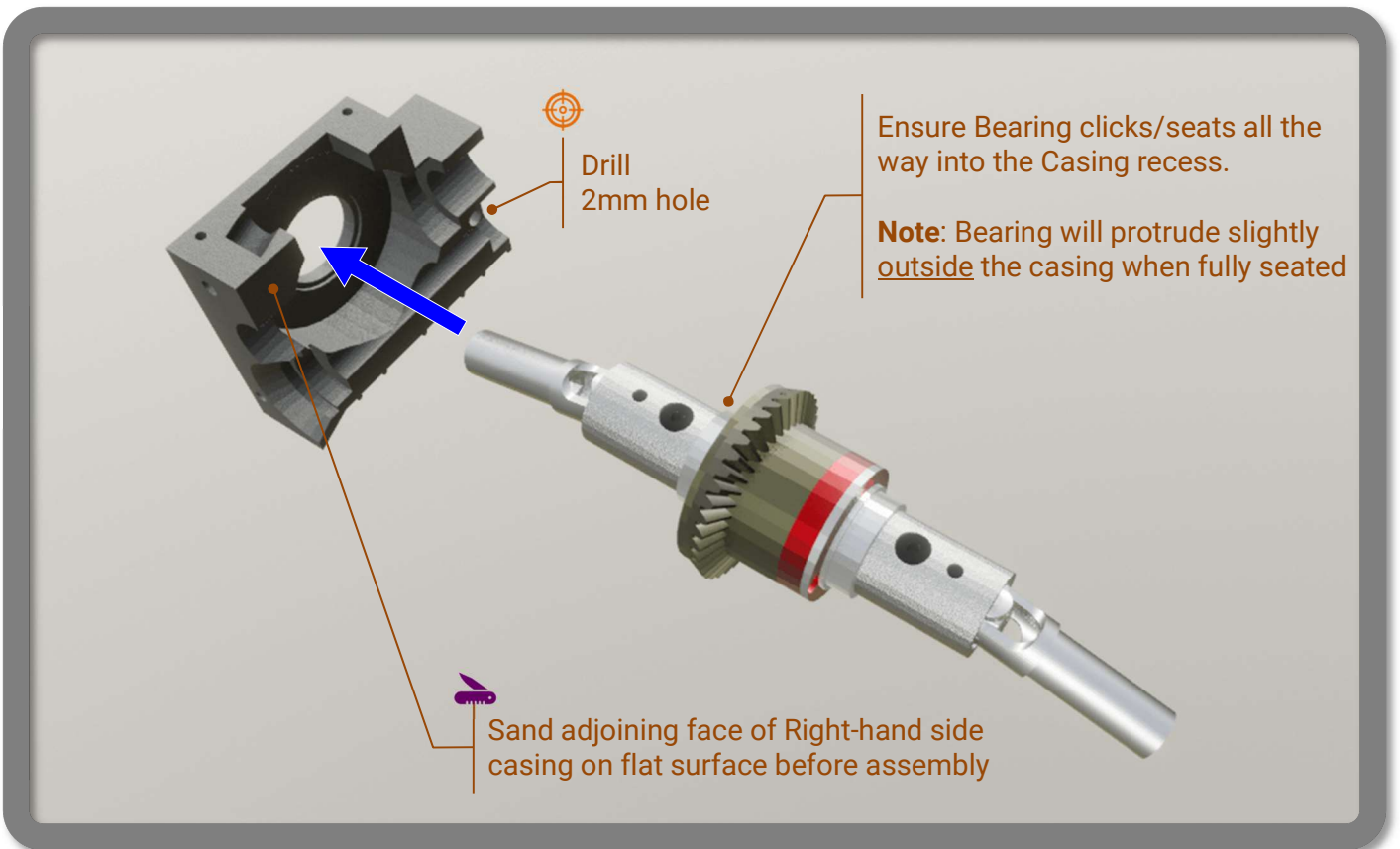

STEP 6 – GEARBOX CASING

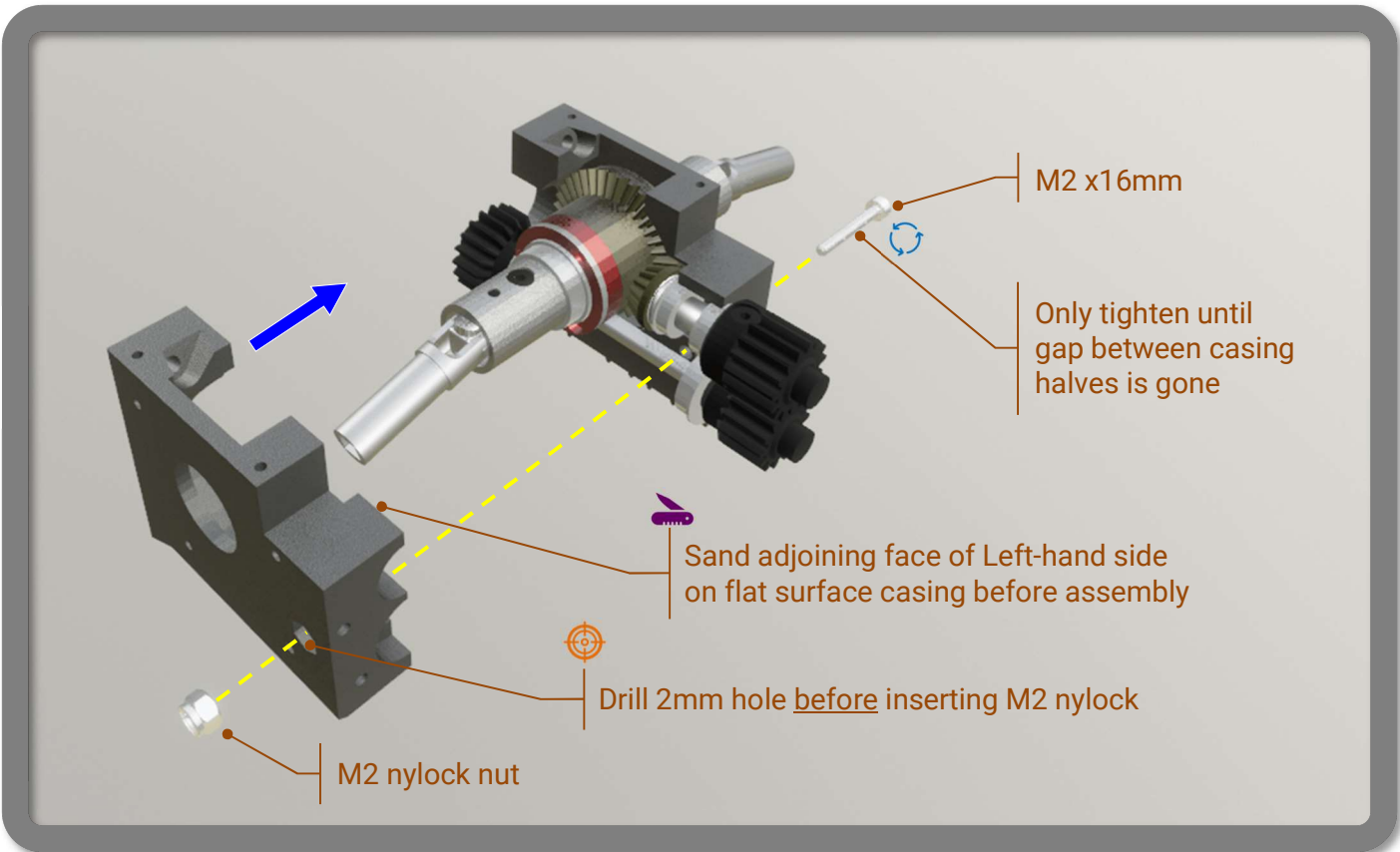
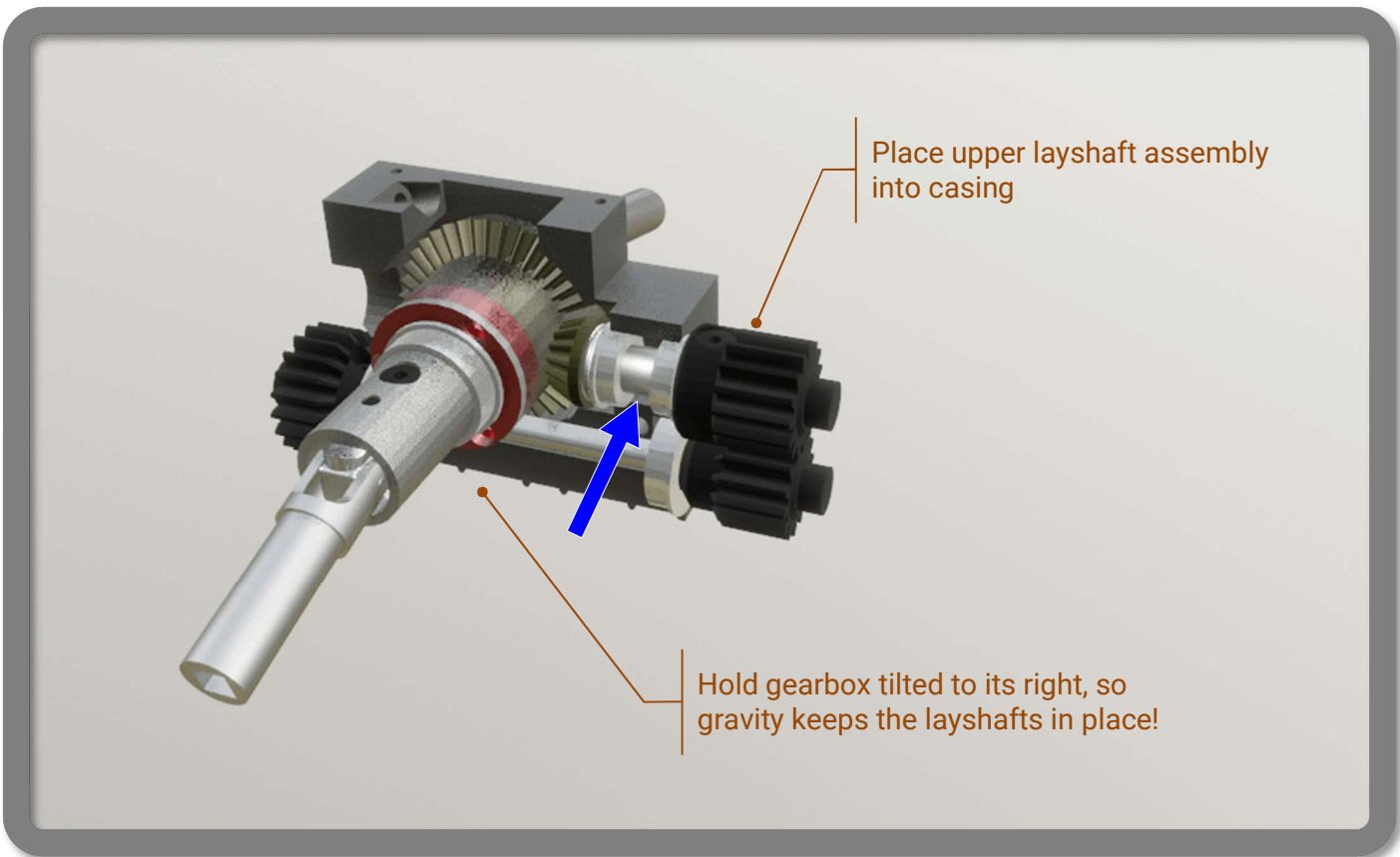

STEP 6 – GEARBOX CASING

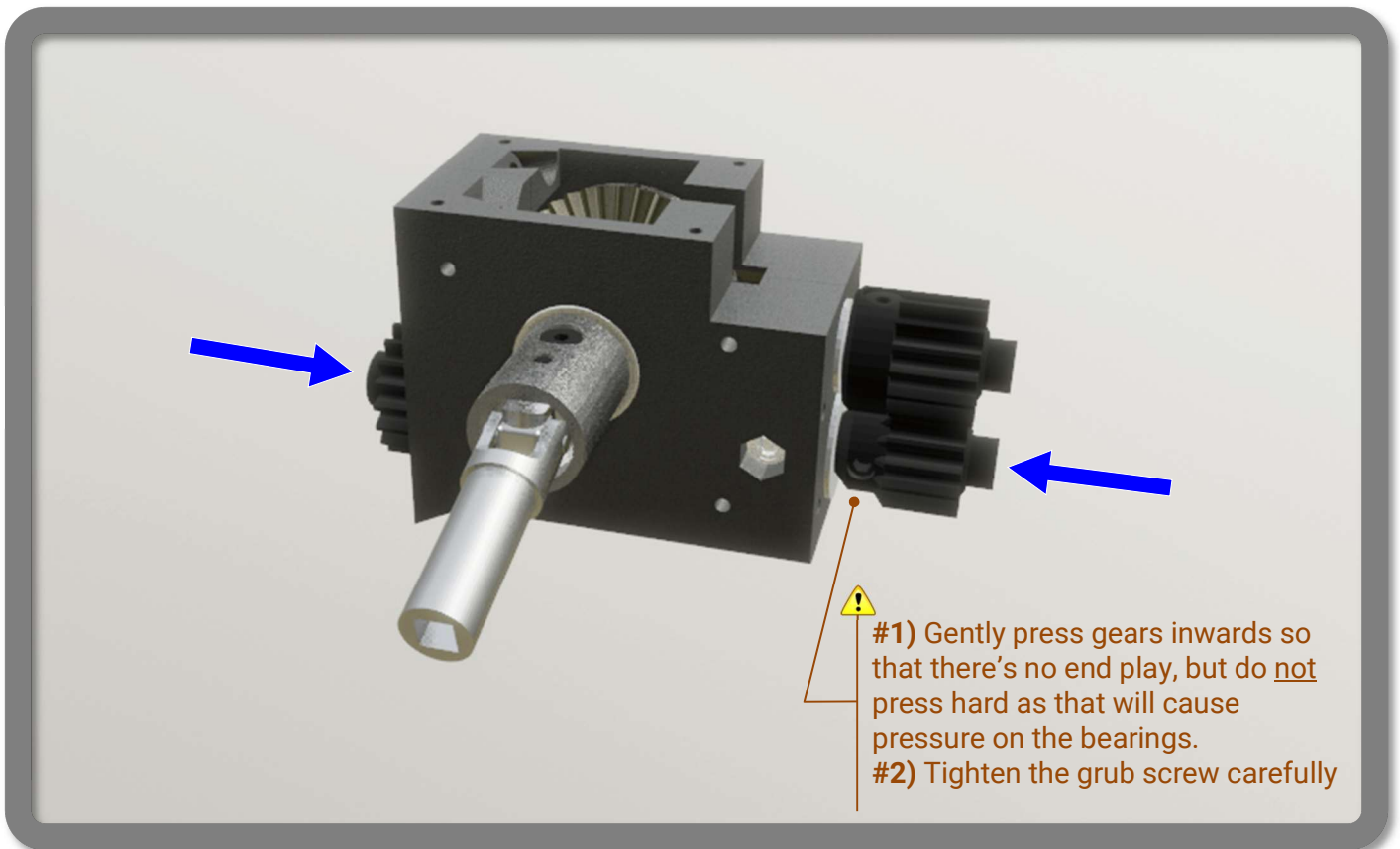

STEP 6 – GEARBOX CASING

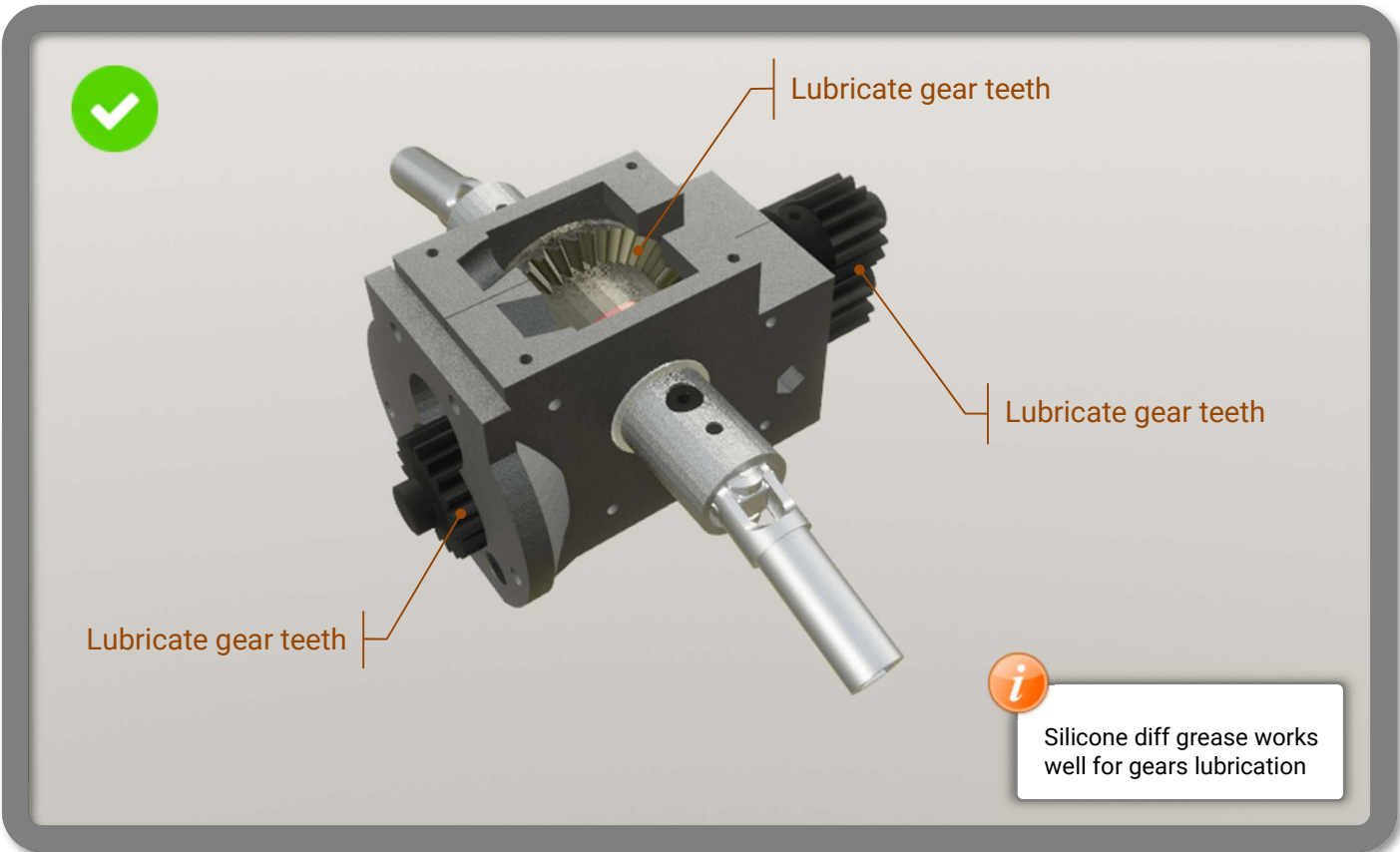
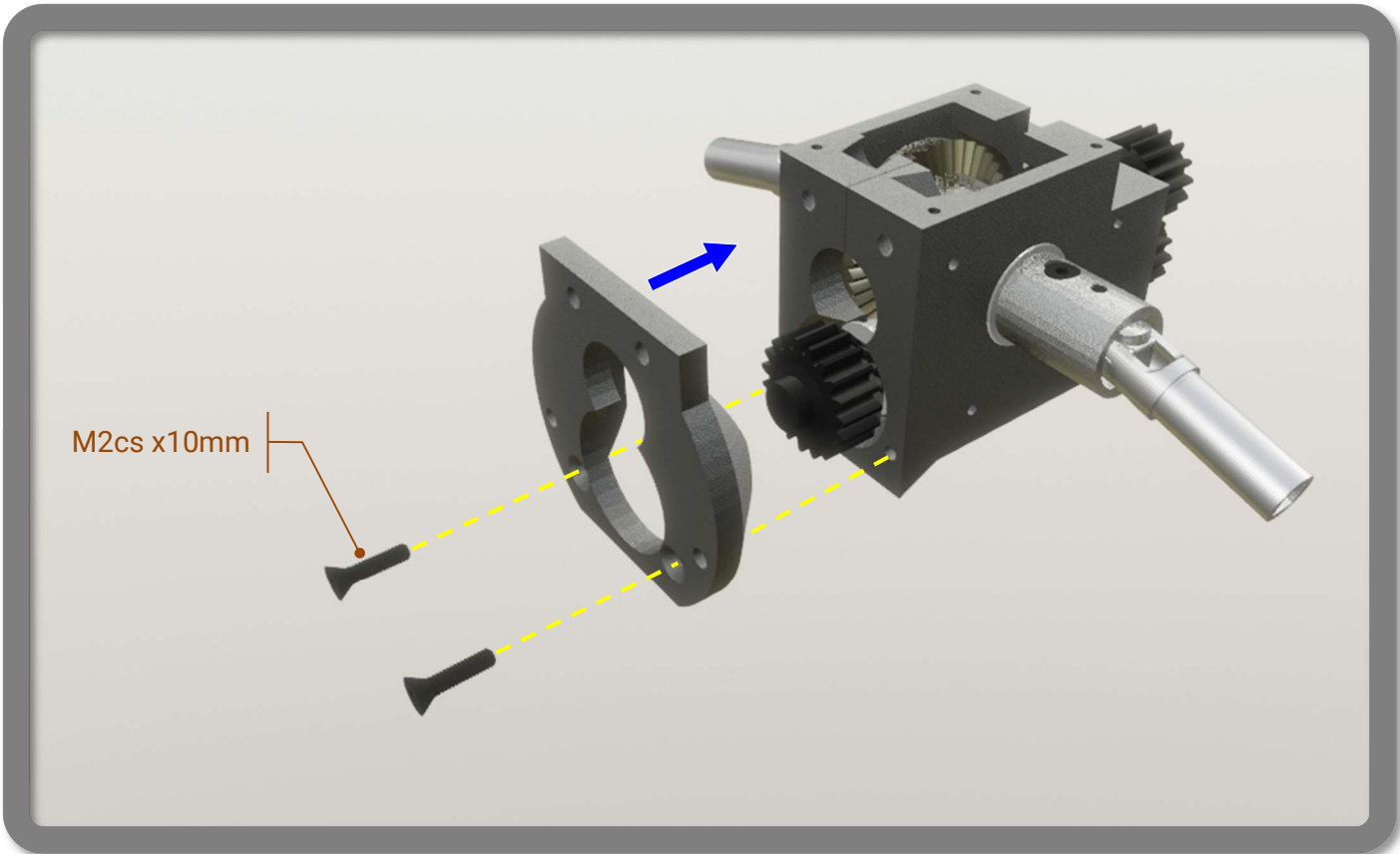

STEP 7 – GEARBOX DETAILS

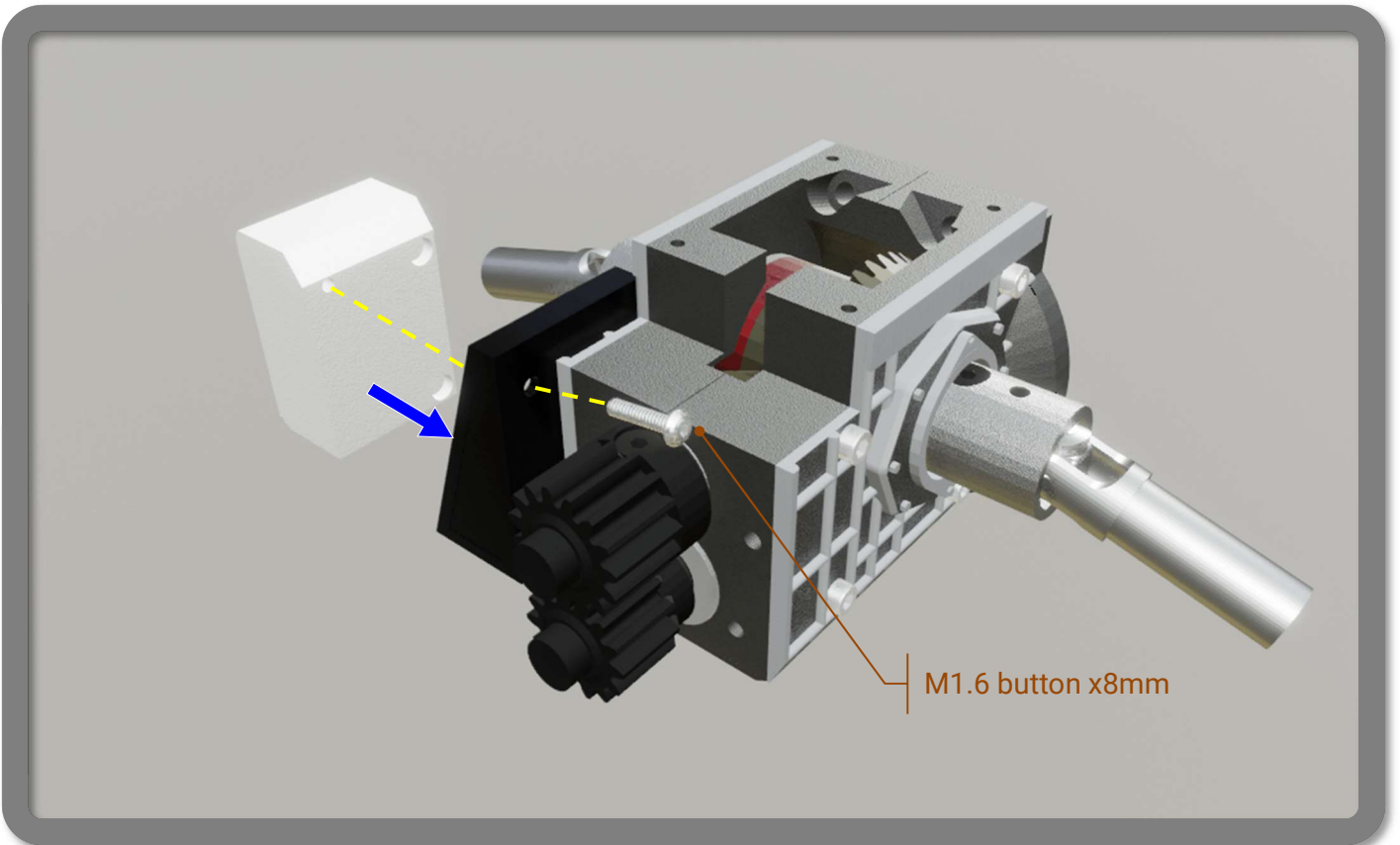
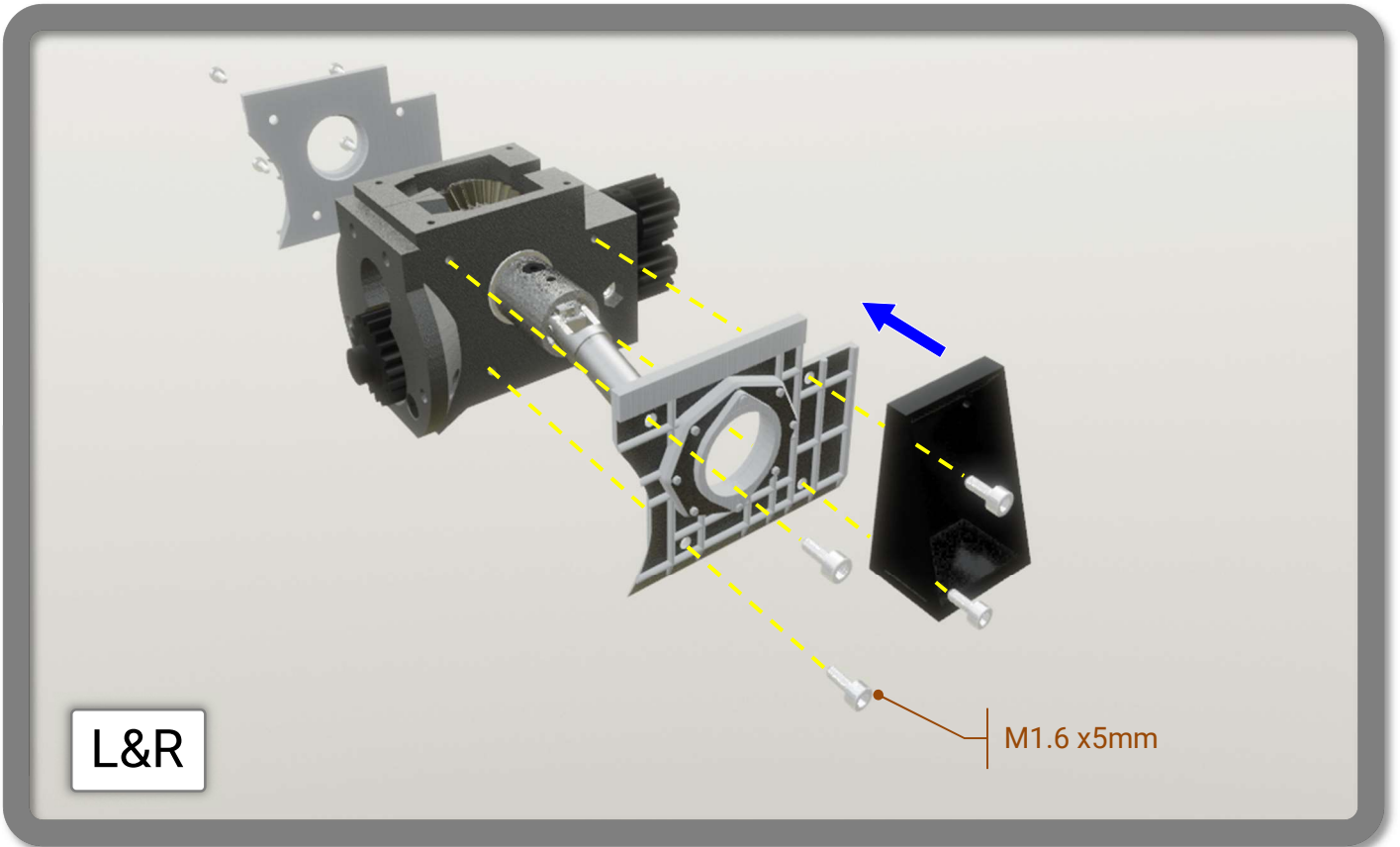

STEP 8 – GEARBOX REAR COVER

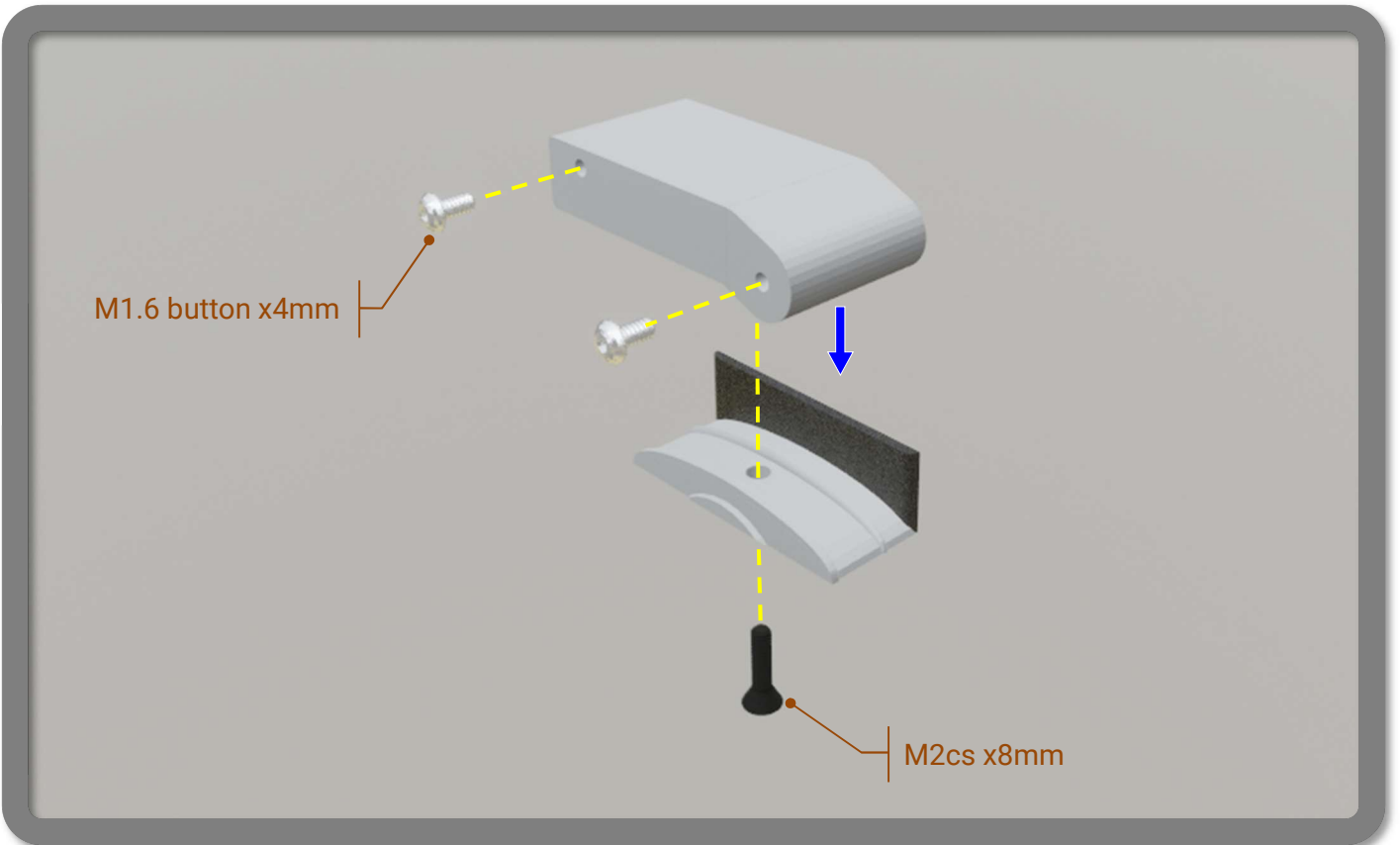
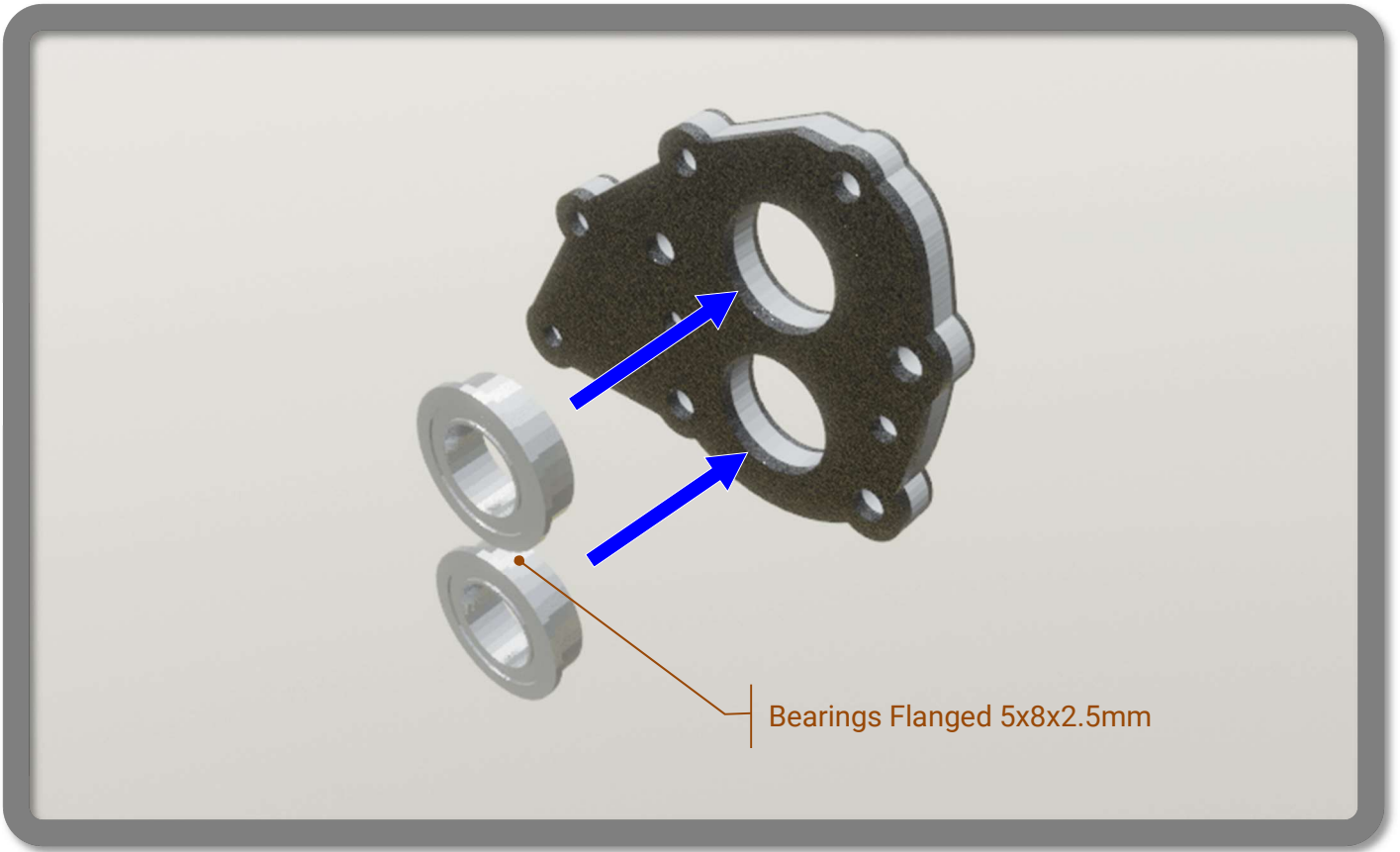

STEP 8 – GEARBOX REAR COVER

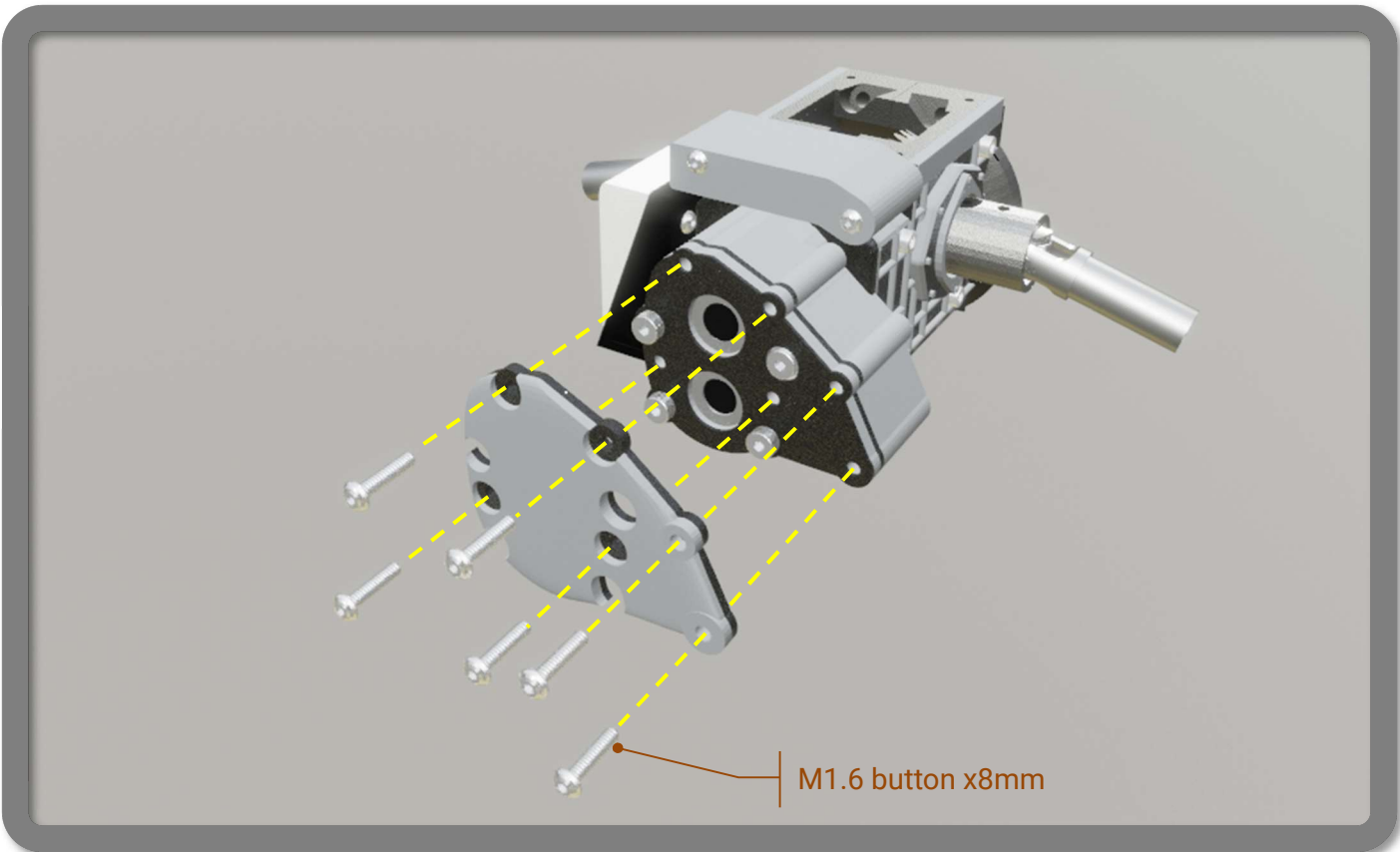
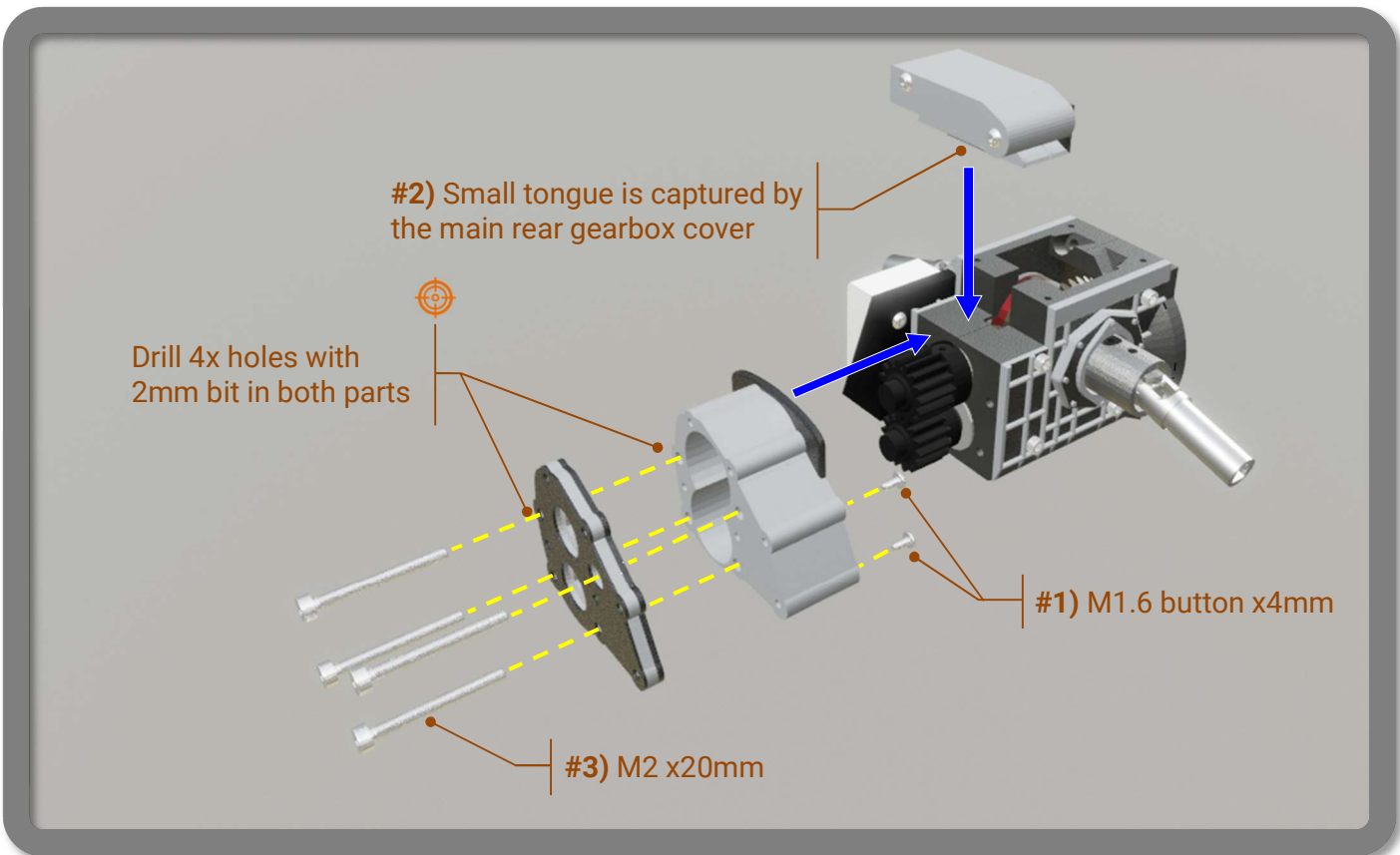

STEP 9 – GEARBOX INSTALL

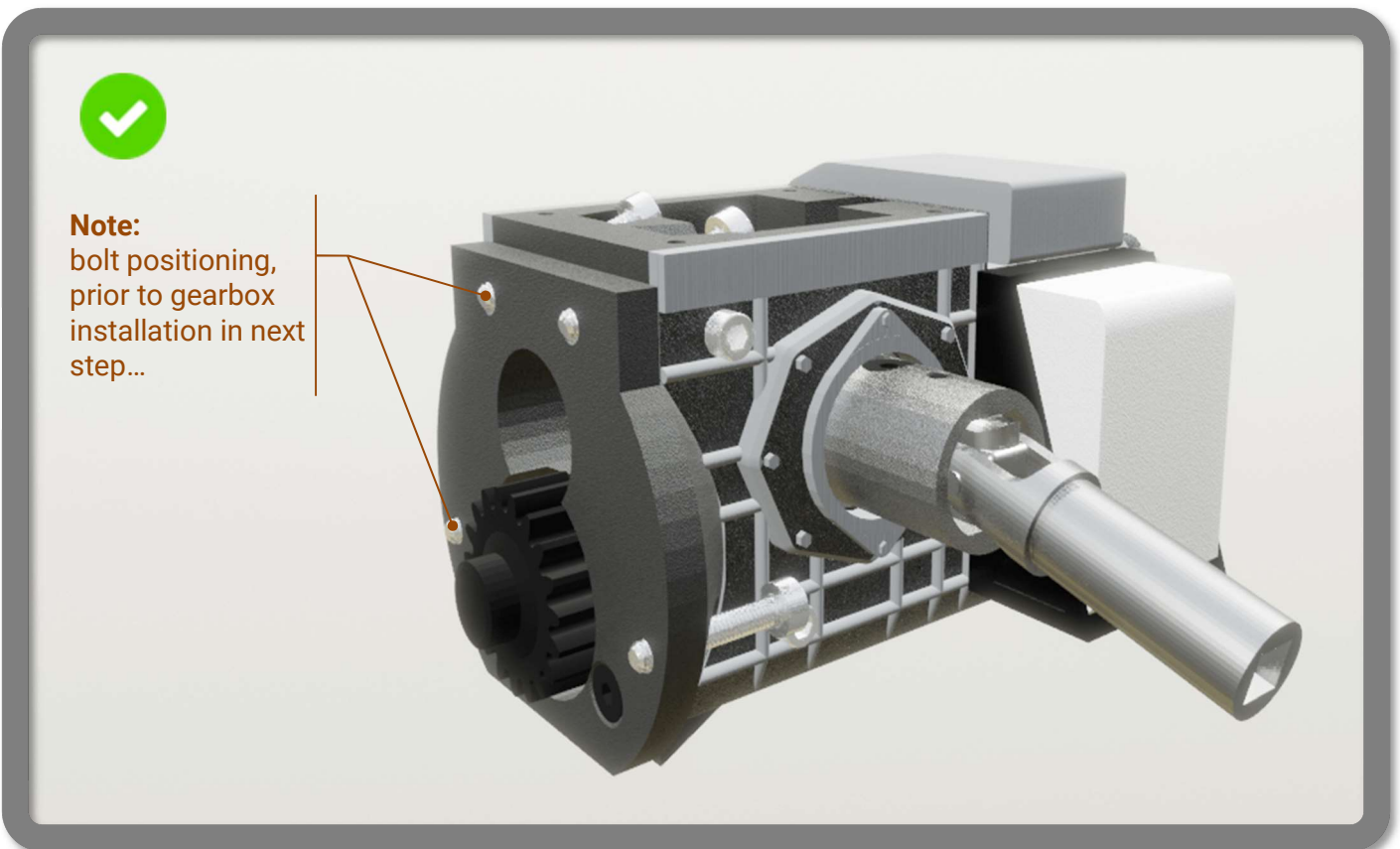
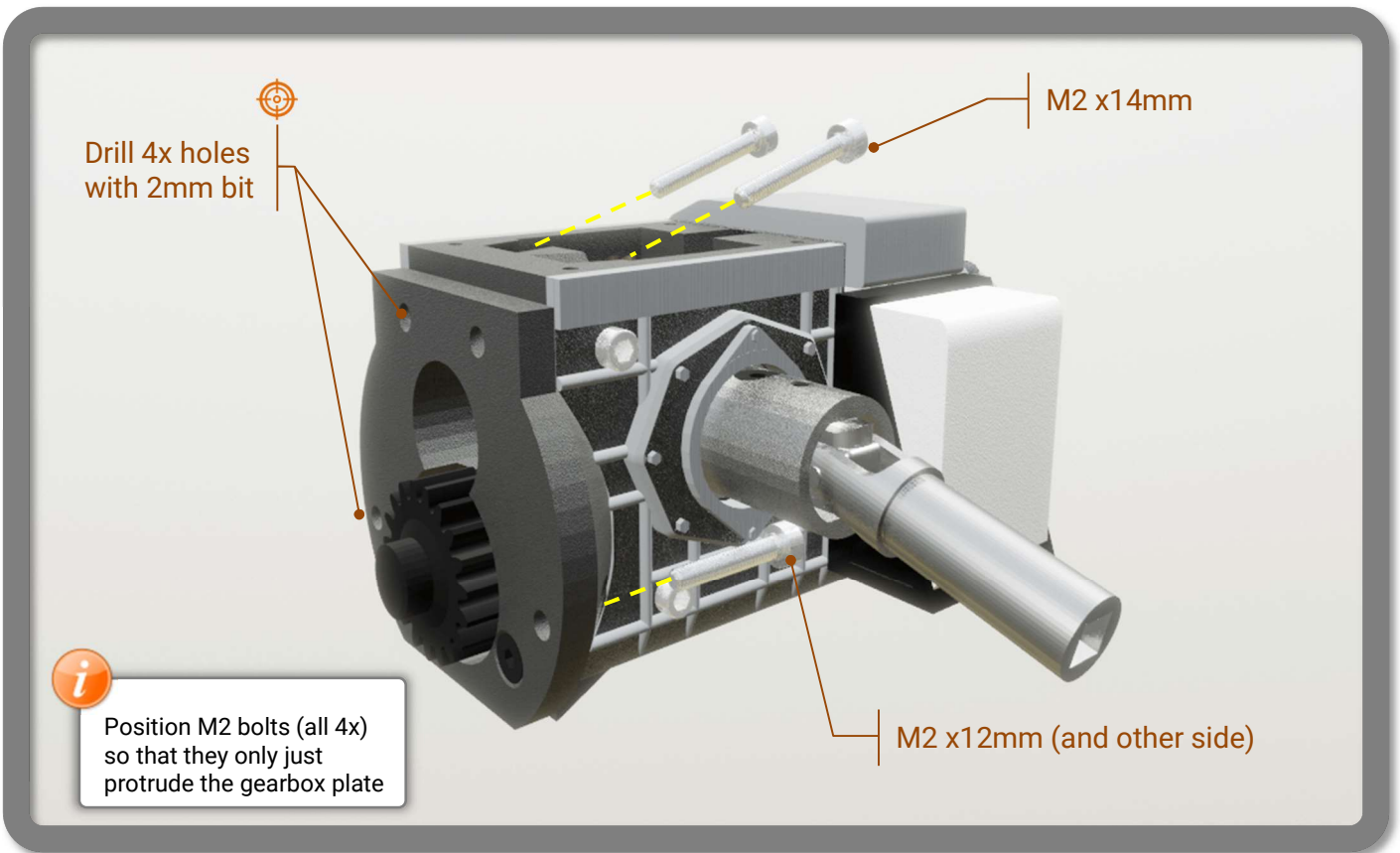

STEP 9 – GEARBOX INSTALL

