

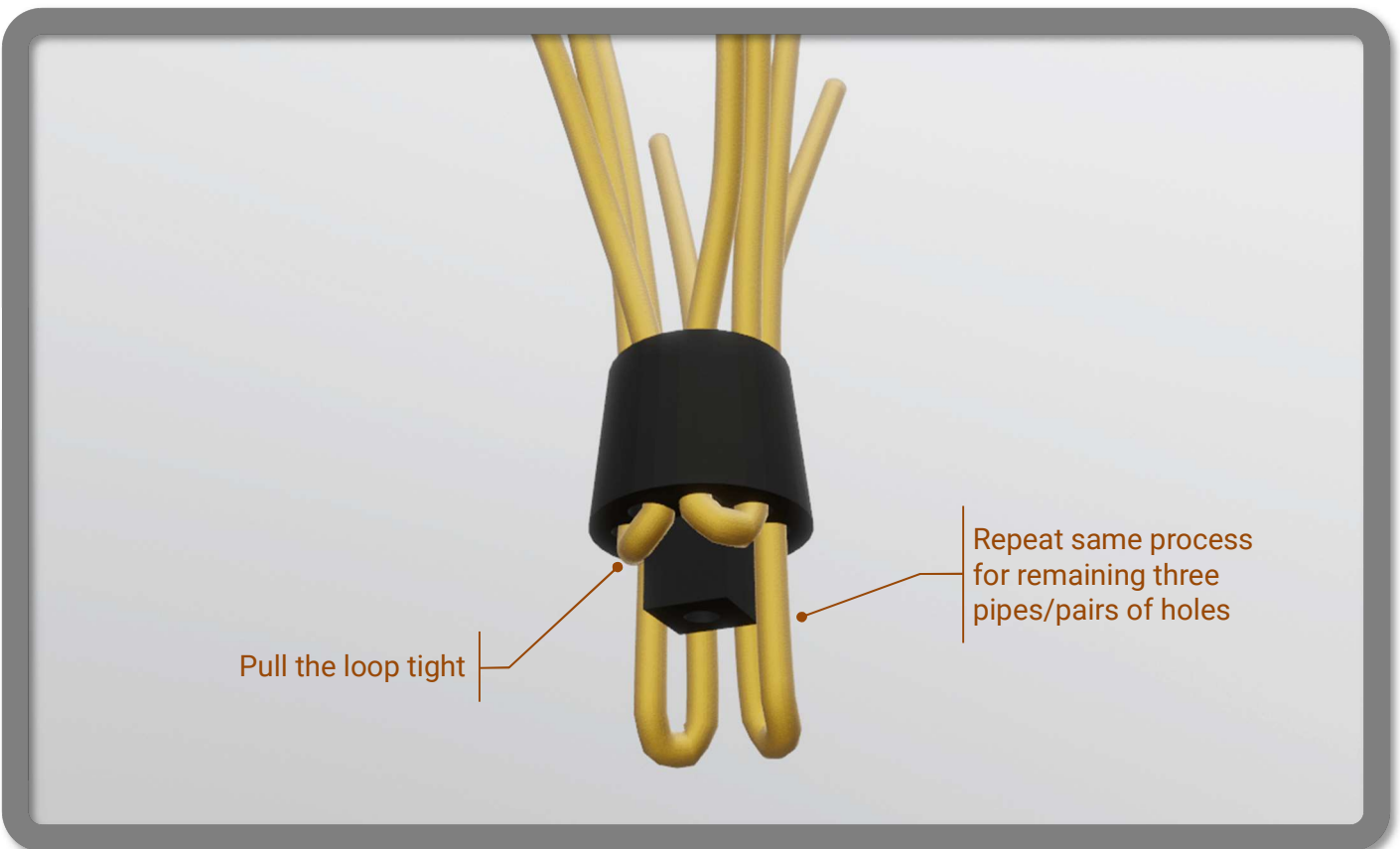

SECTION 7. Engine Details

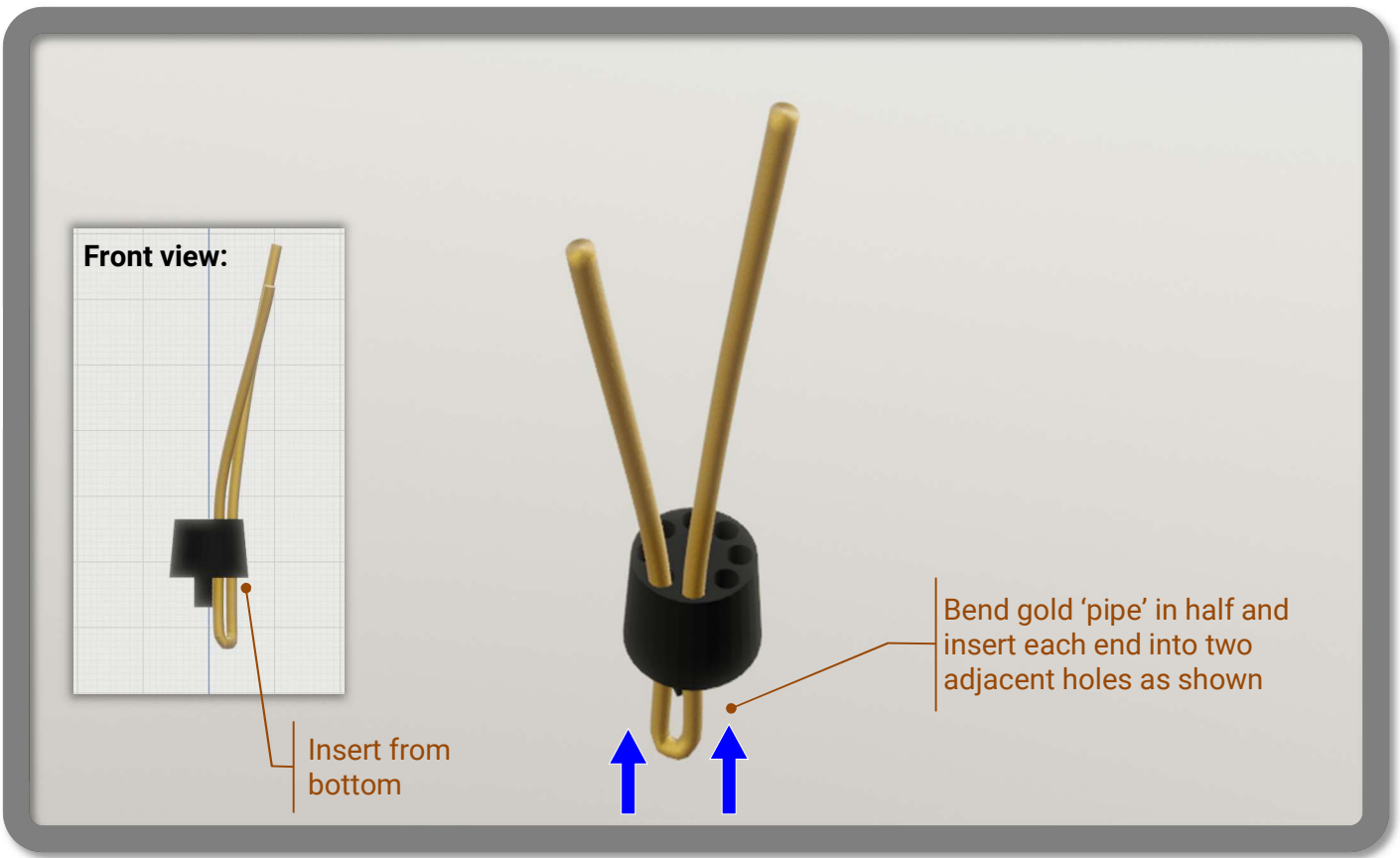

STEP 1 – INJECTOR PIPES



STEP 2 – INJECTOR BASE

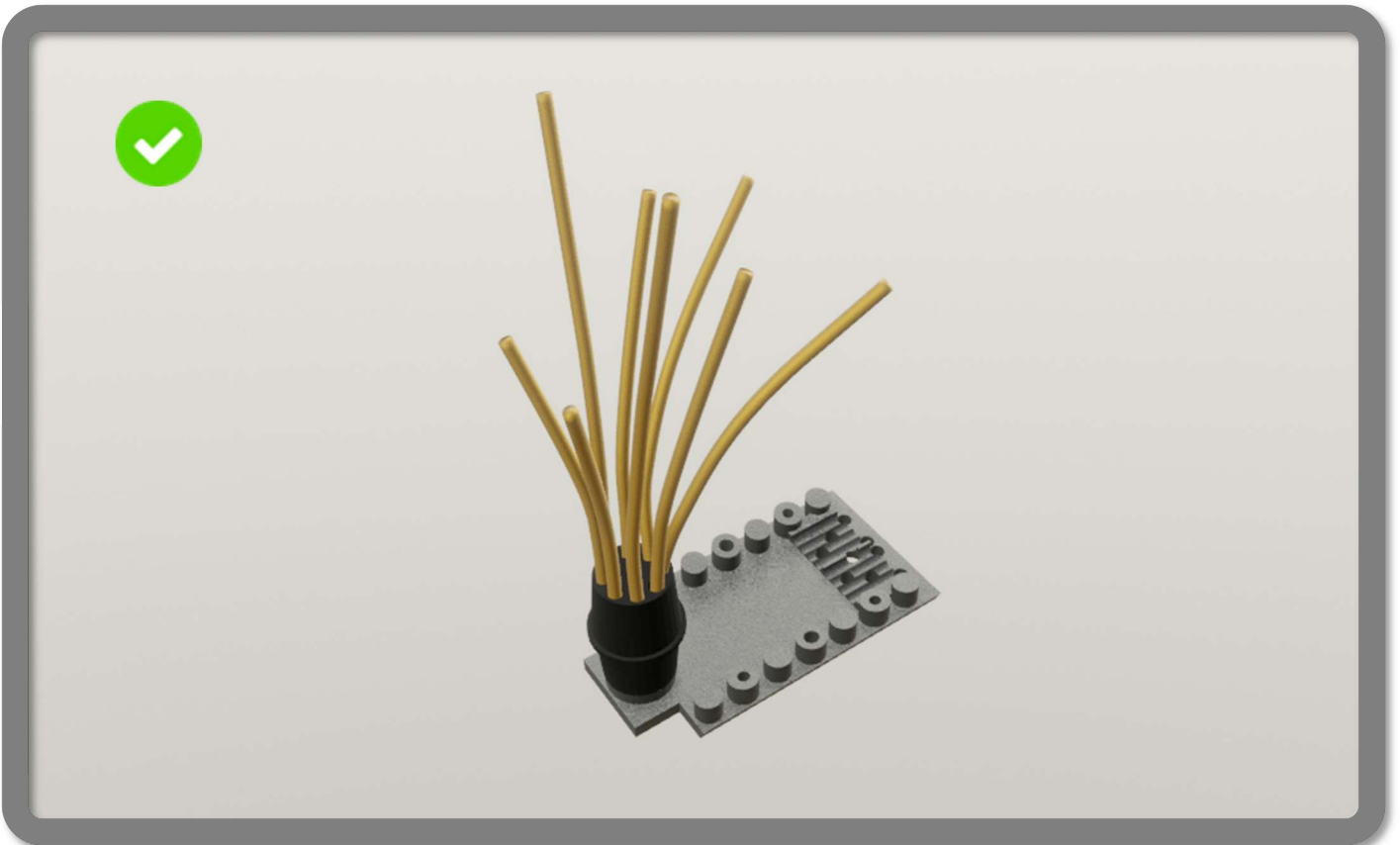
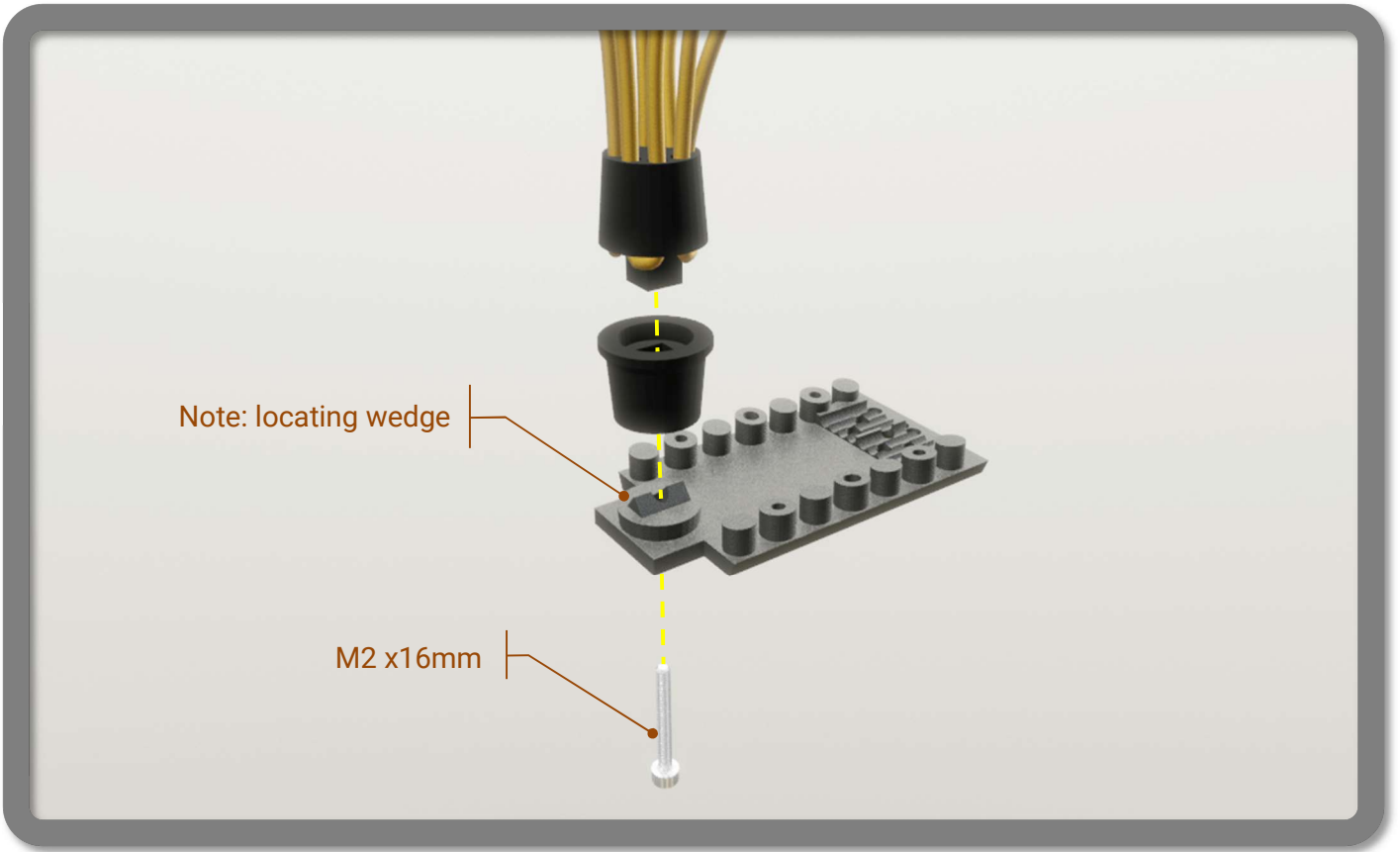

STEP 3 – TRUMPETS BASE

L&R

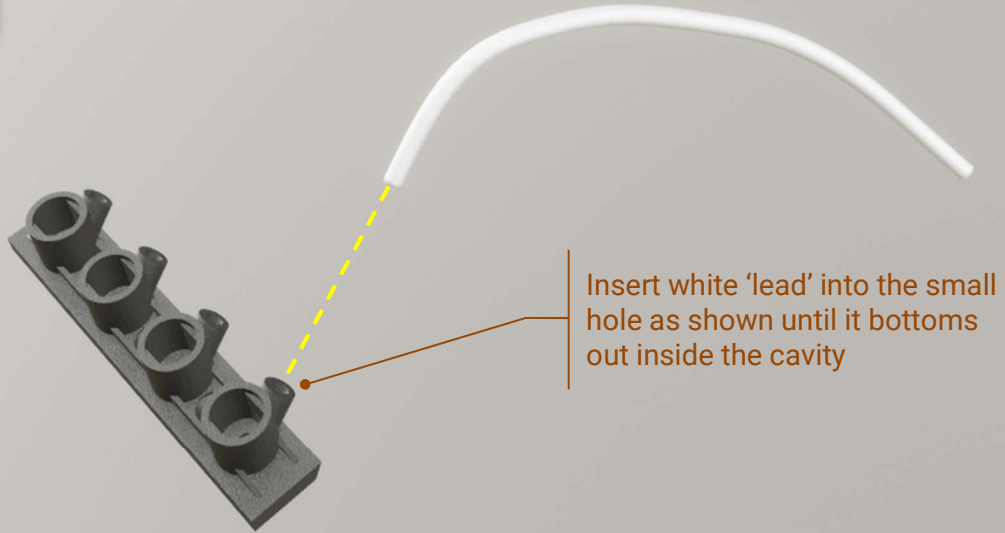

L&R

Repeat for other 3 leads

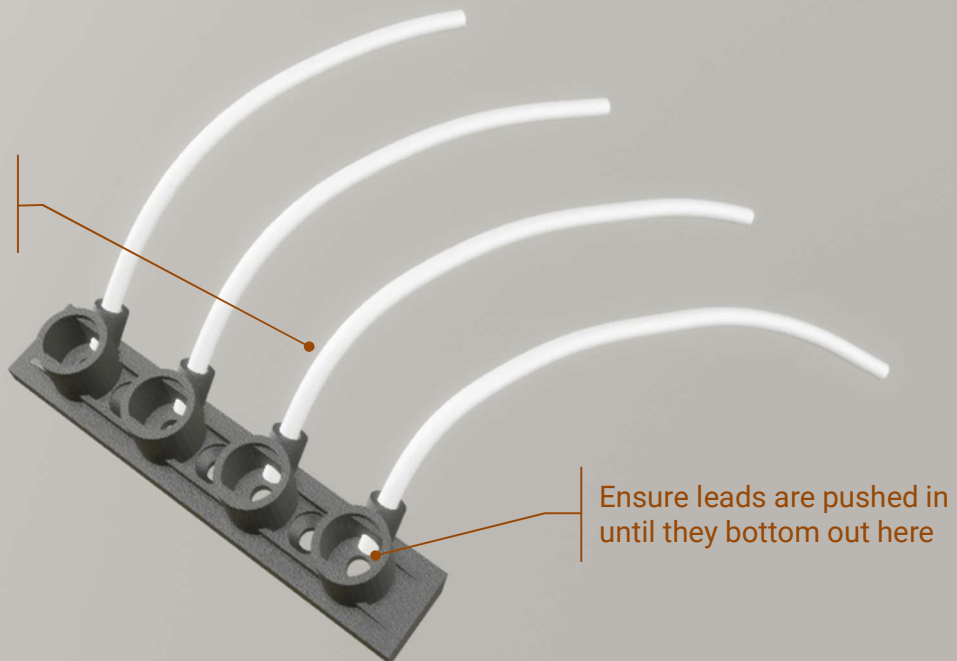

STEP 4 – TRUMPETS

L&R

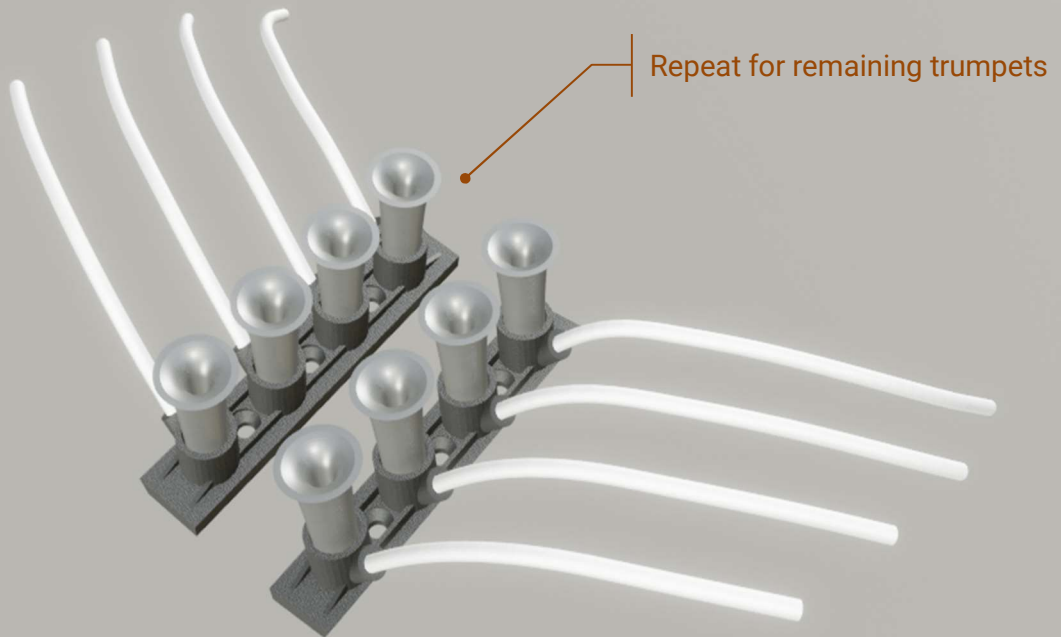

STEP 5 – ROUTE LEADS

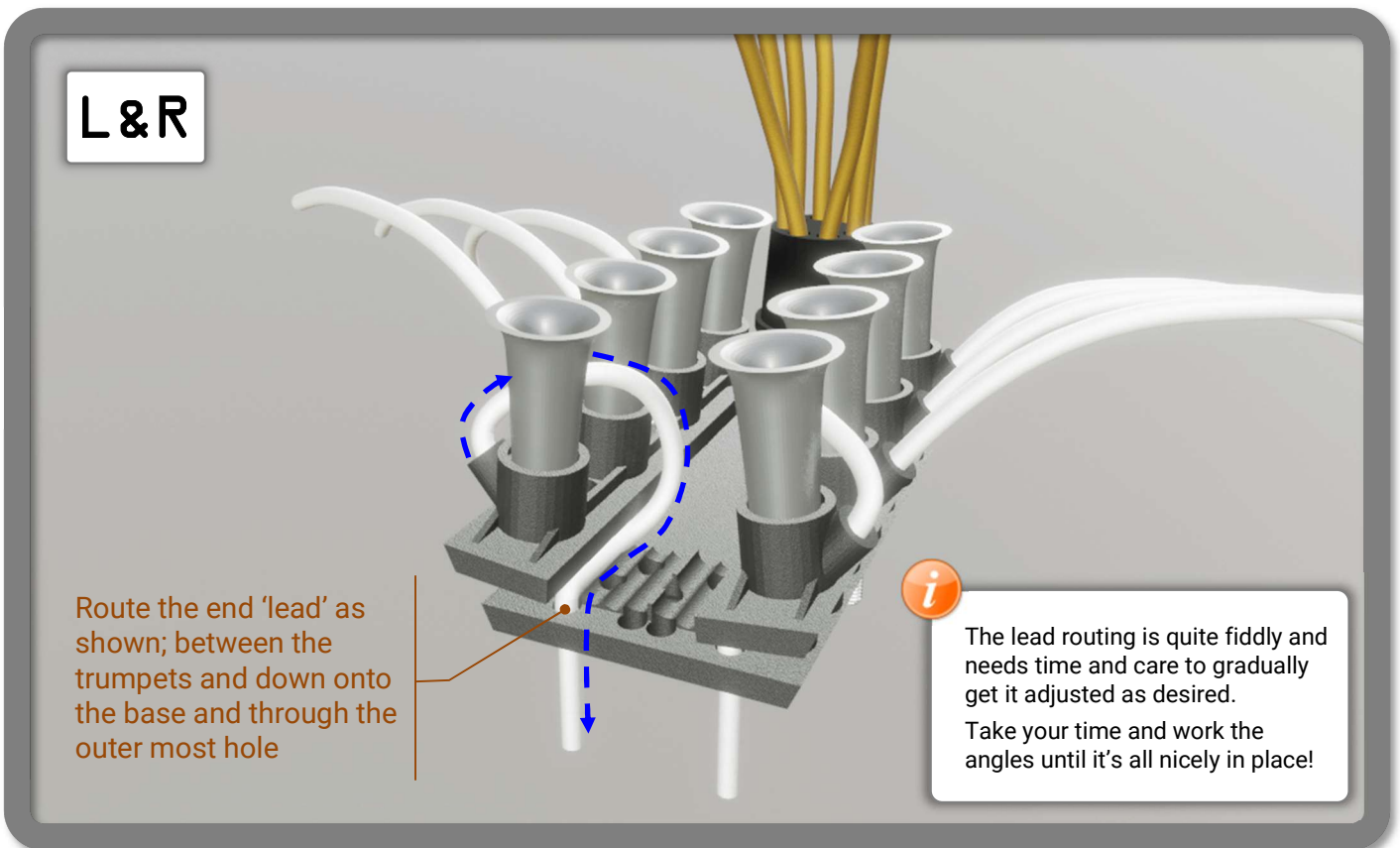
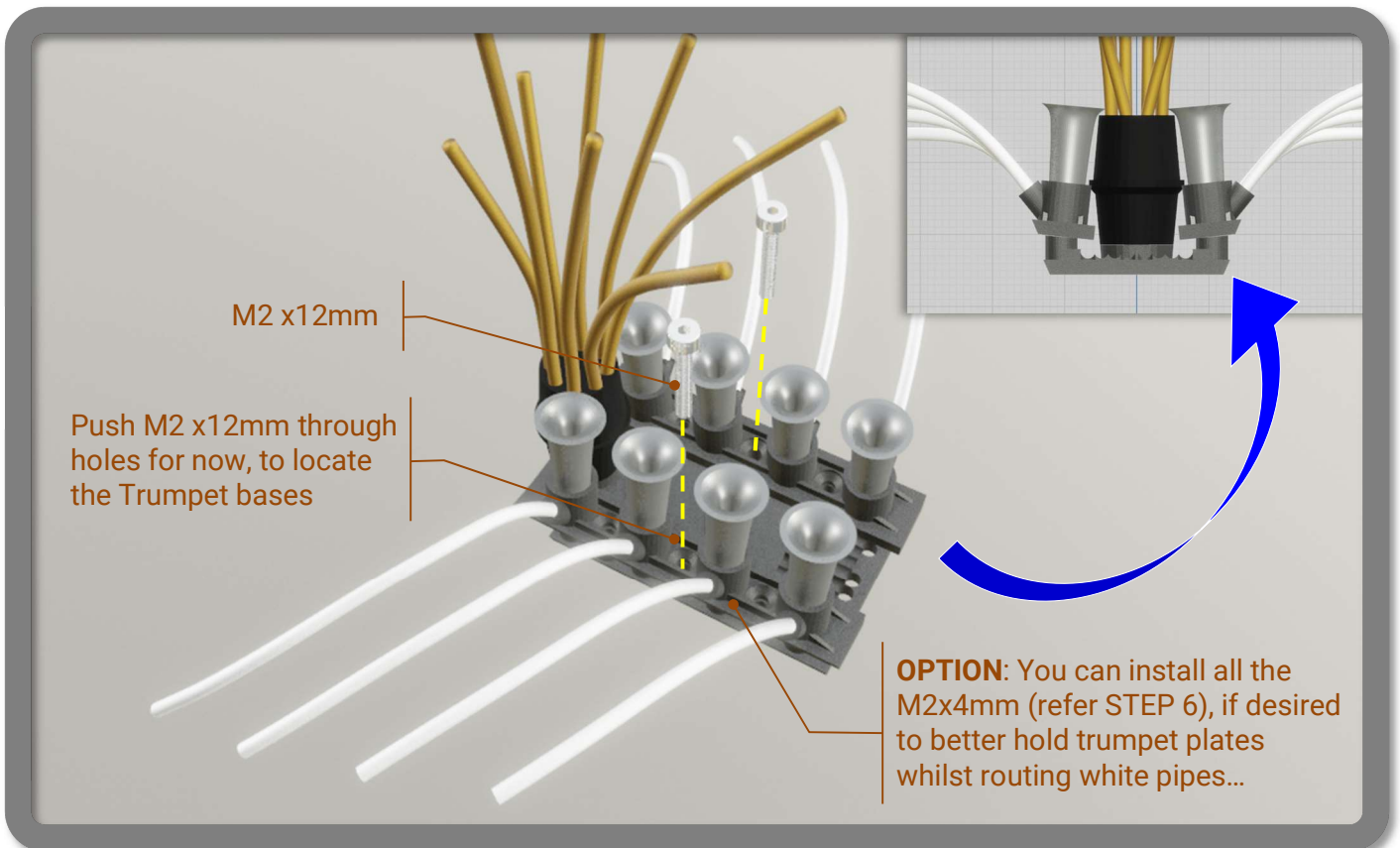

STEP 5 – ROUTE LEADS

L&R

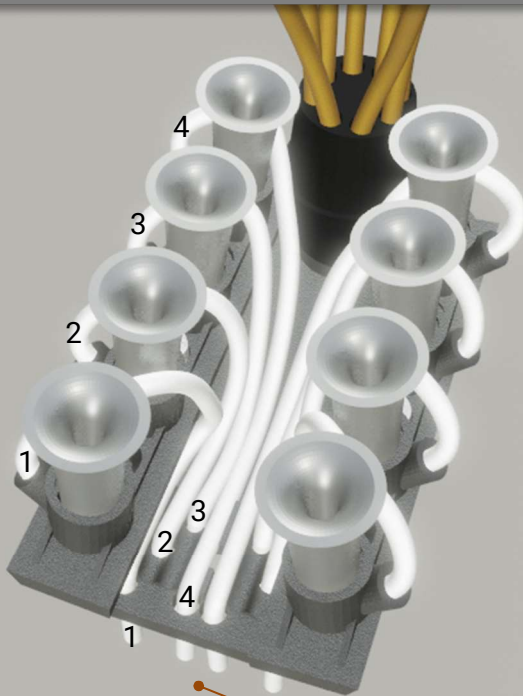

Do **NOT** cut short yet

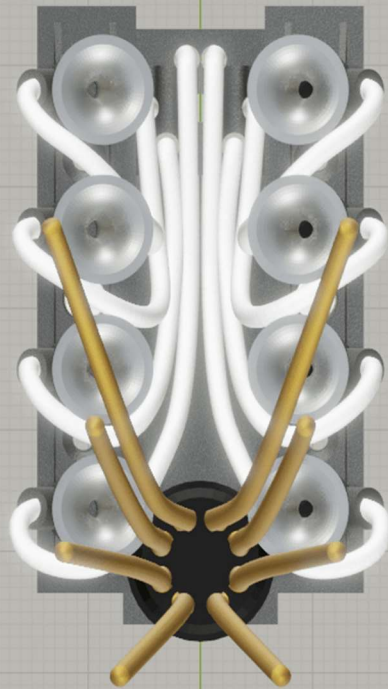

STEP 6 – ROLLOVER SUPPORT

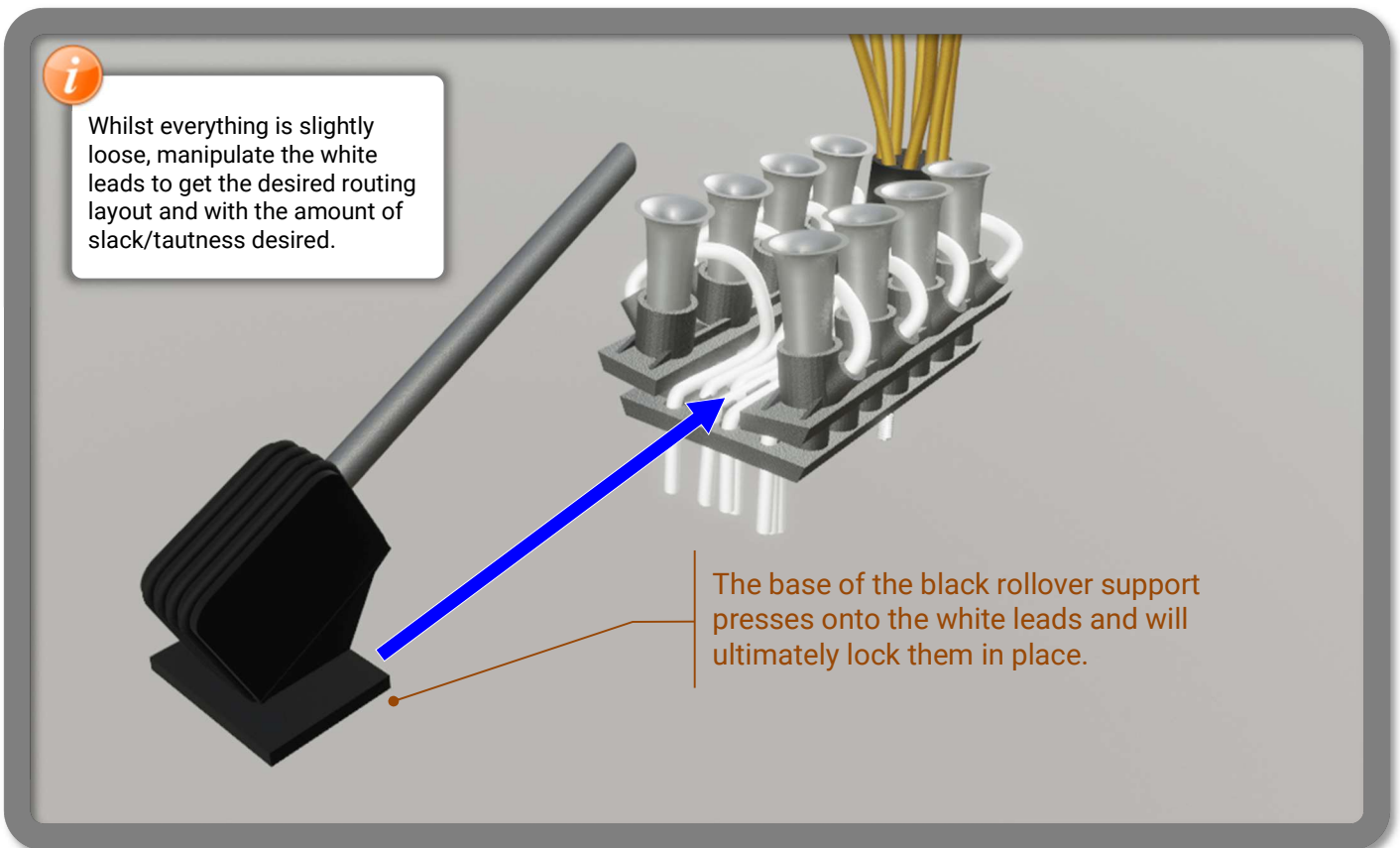
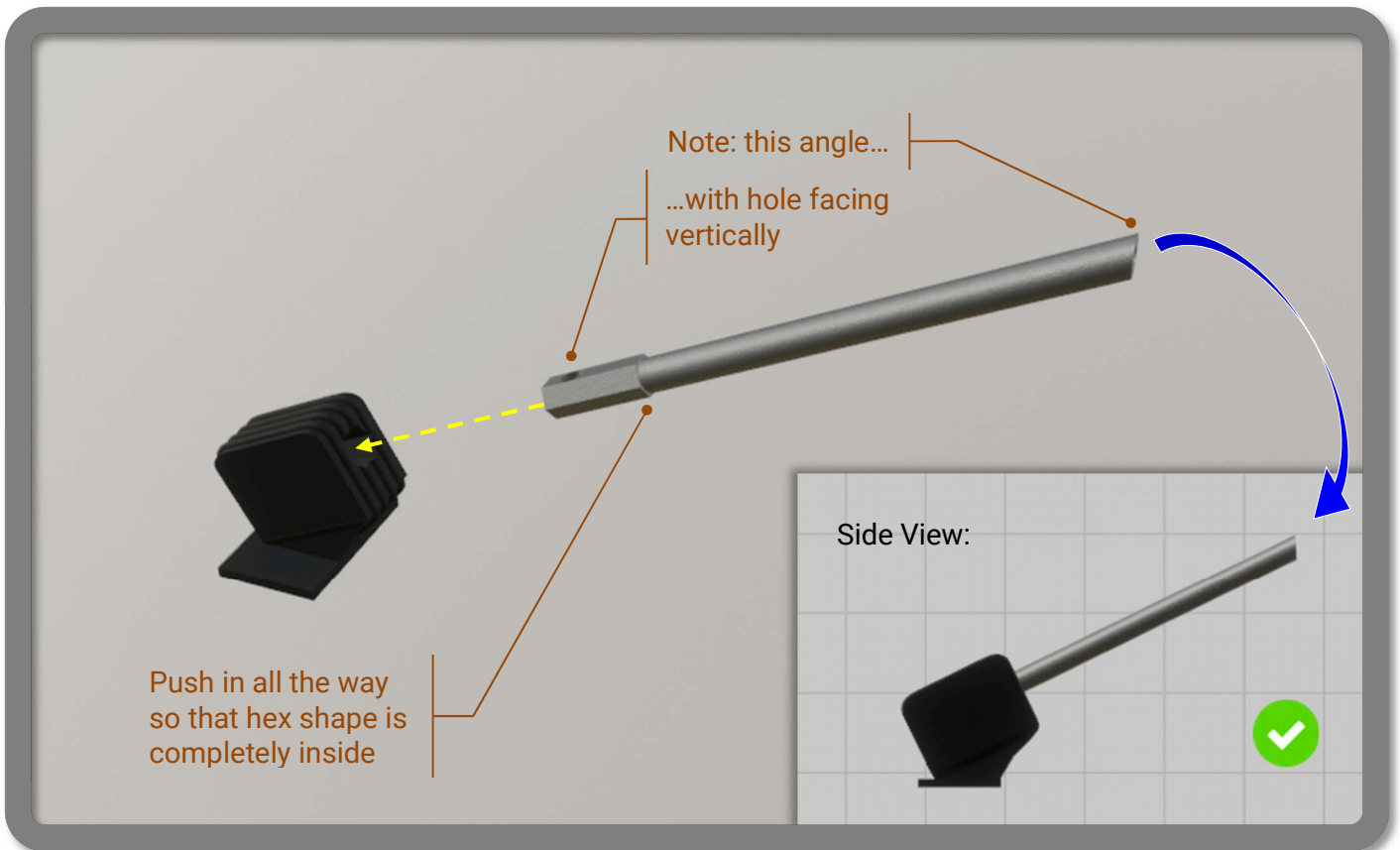

STEP 6 – ROLLOVER SUPPORT

Manipulate component into position whilst adjusting/holding the white leads as needed

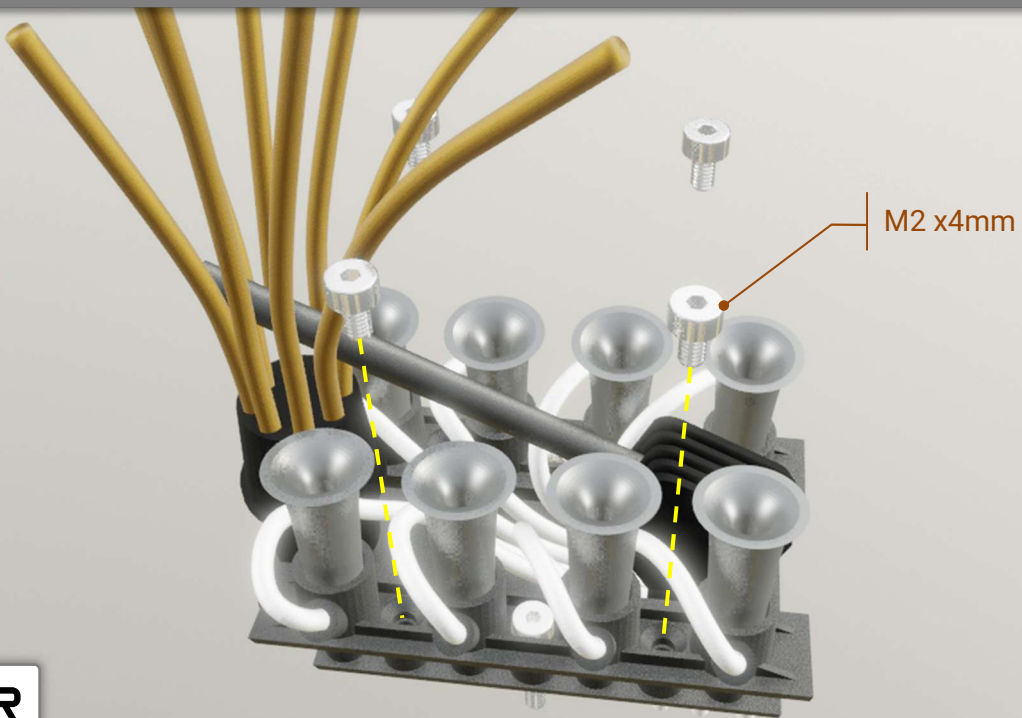
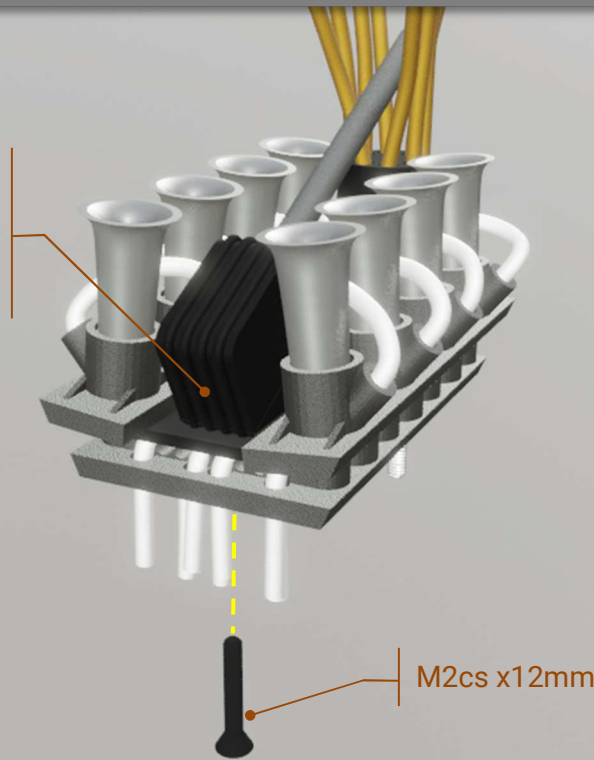

STEP 6 – ENGINE DETAILS – SUB ASSEMBLY - COMPLETED

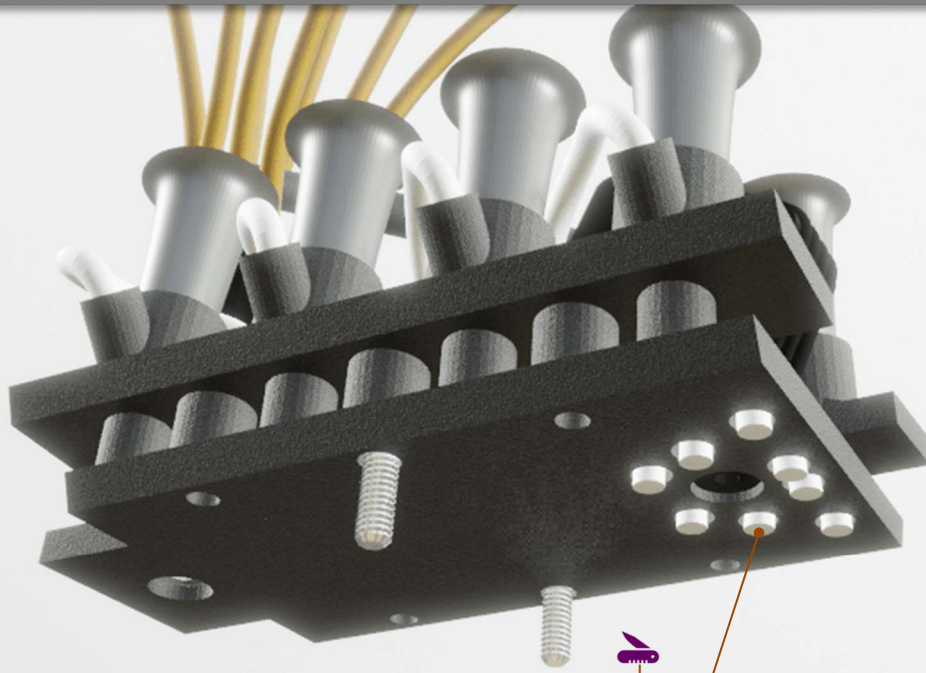

Once you are completely happy with the white leads routing and positioning and the M2cs x12mm bolt is tightened; only then cut the excess off the bottom ends



STEP 7 – SUPPORT BLOCKS

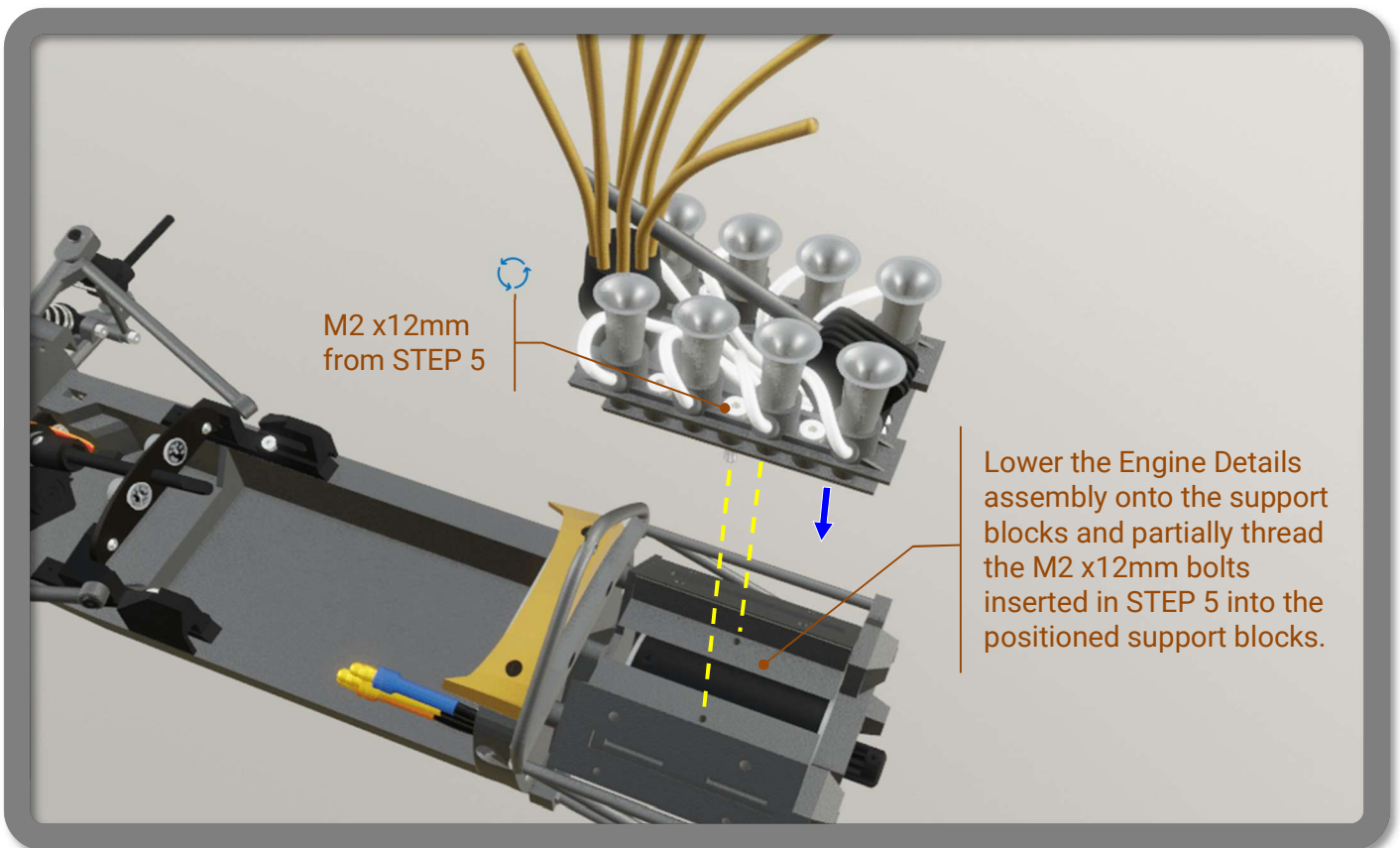
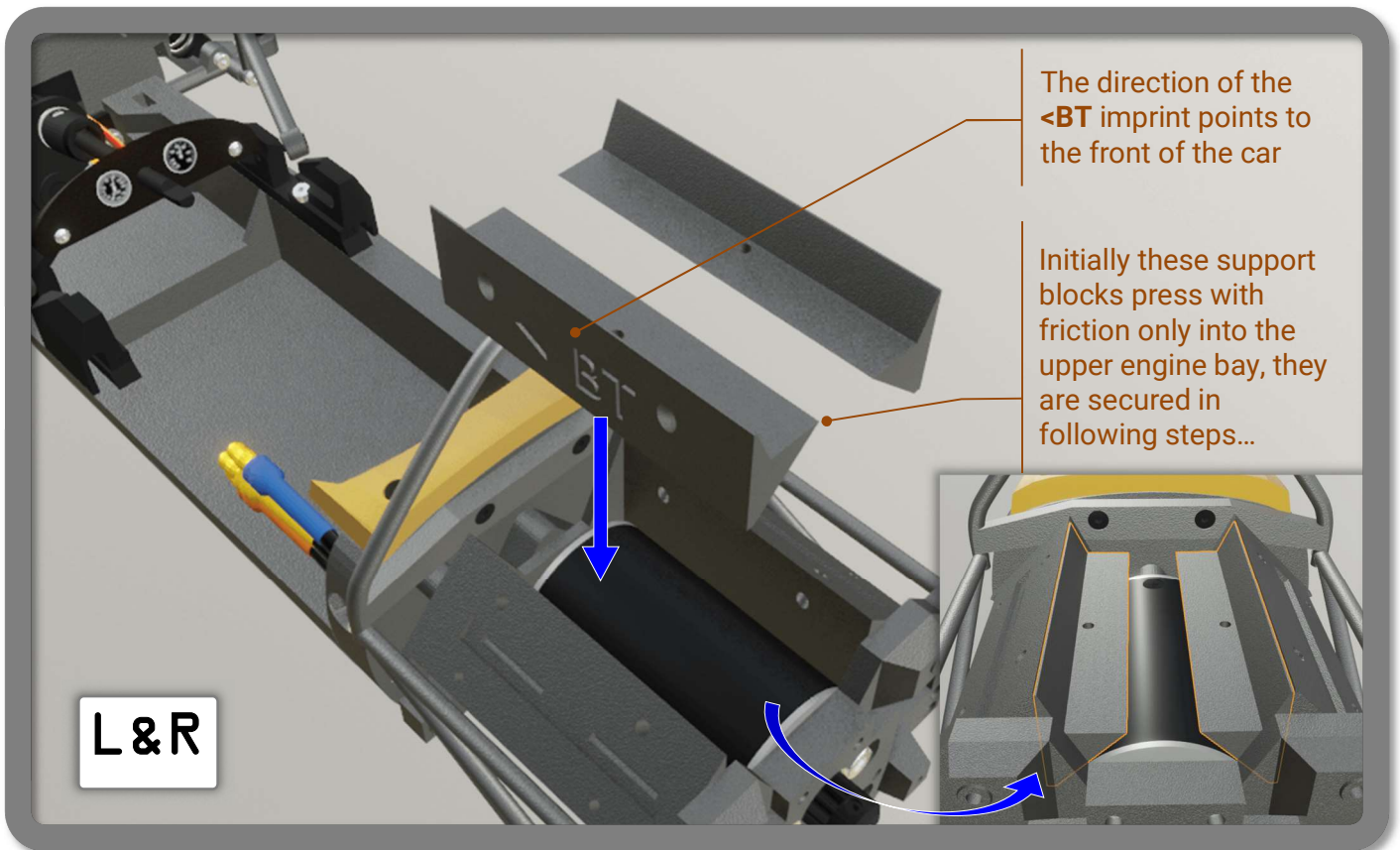

STEP 8 – ROCKER COVER & PIPES

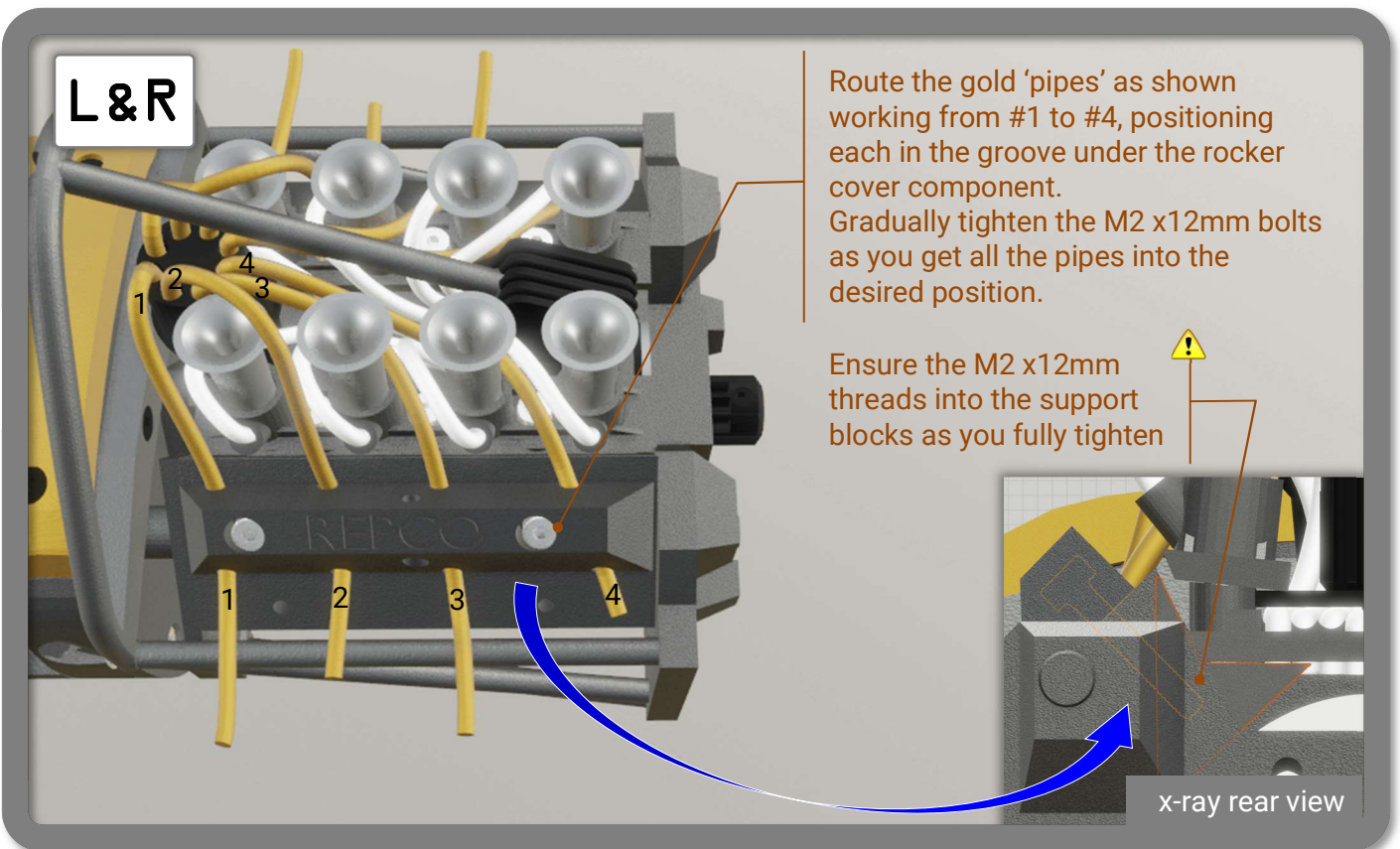
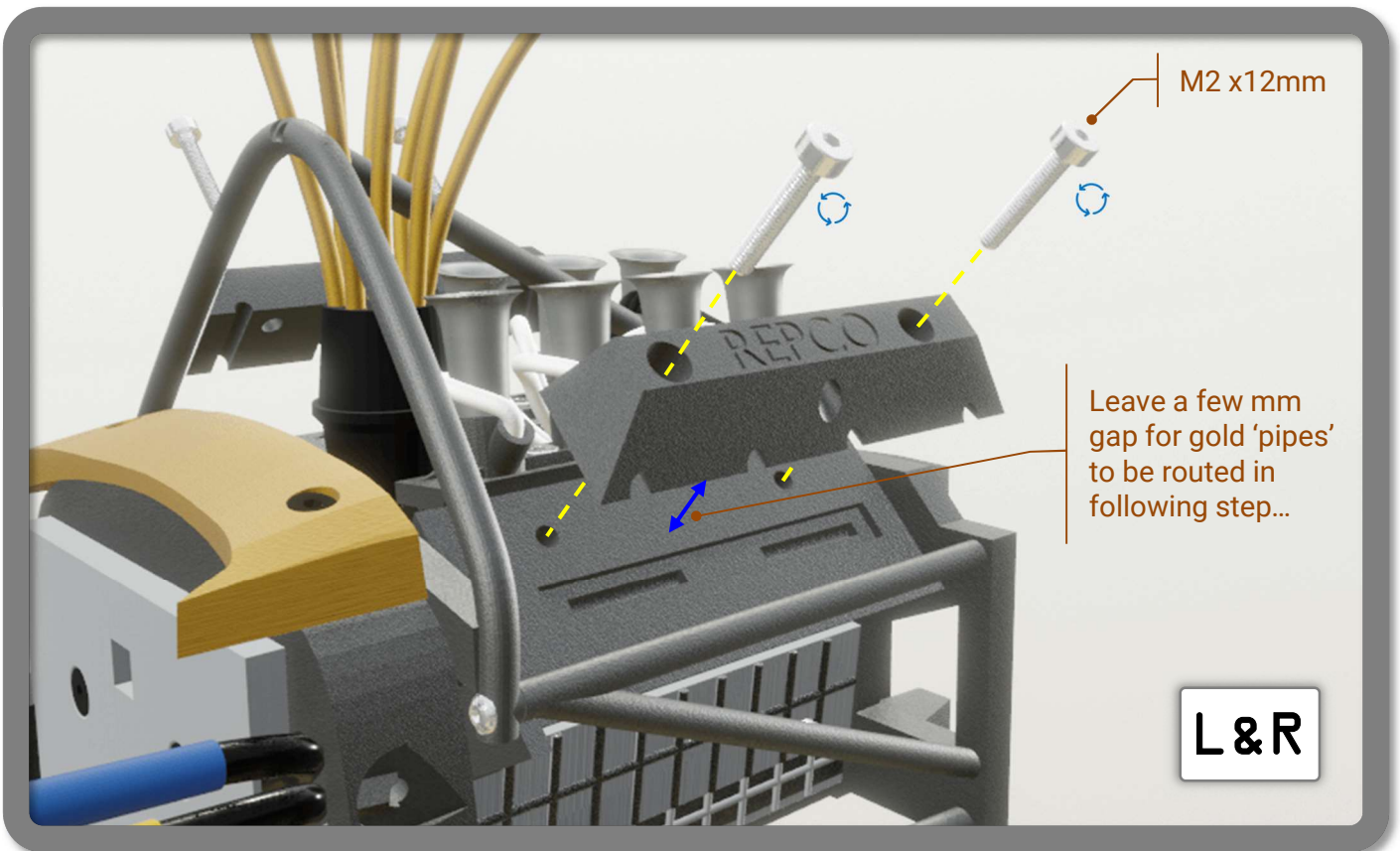

STEP 8 – ENGINE DETAILS - COMPLETED

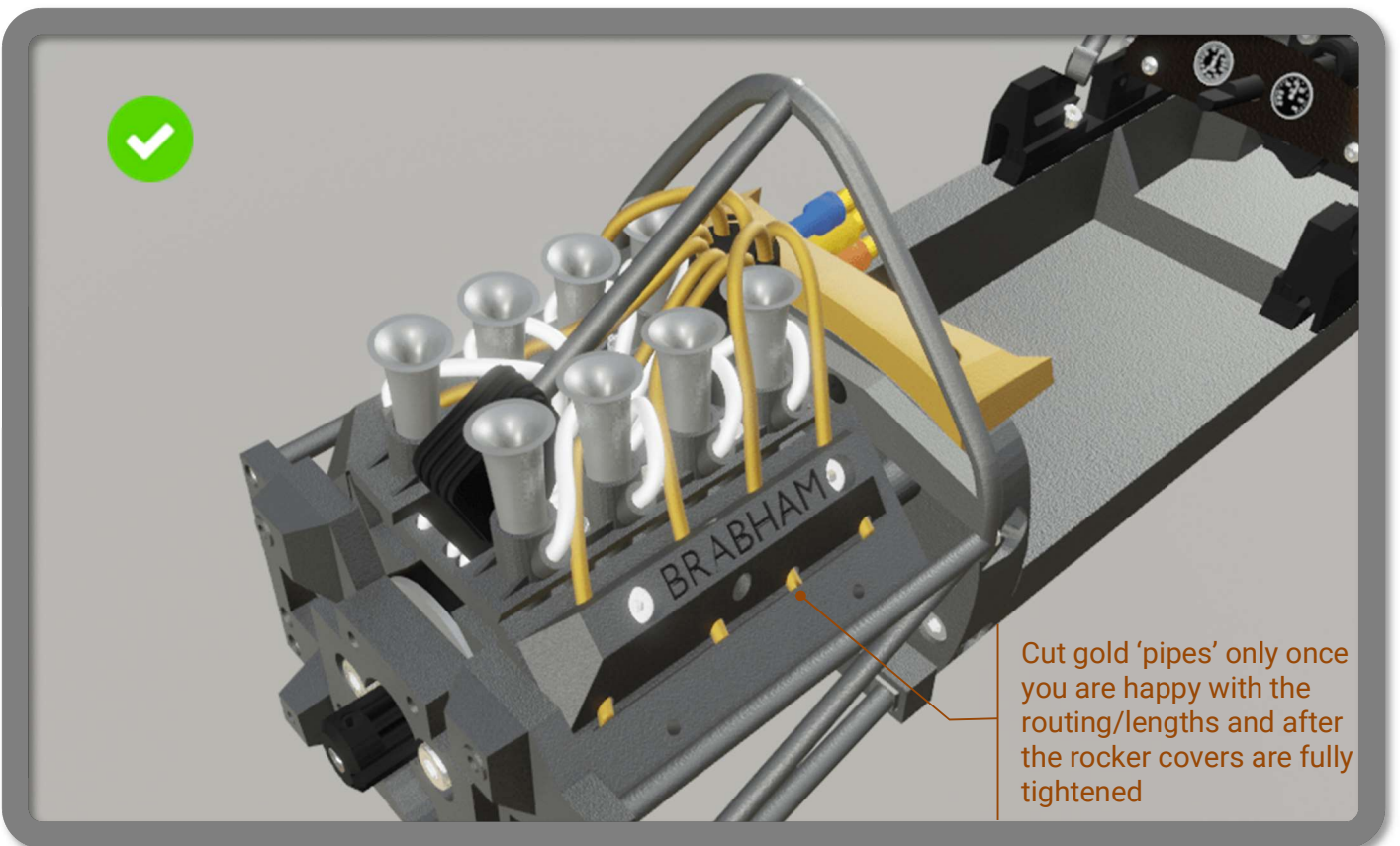
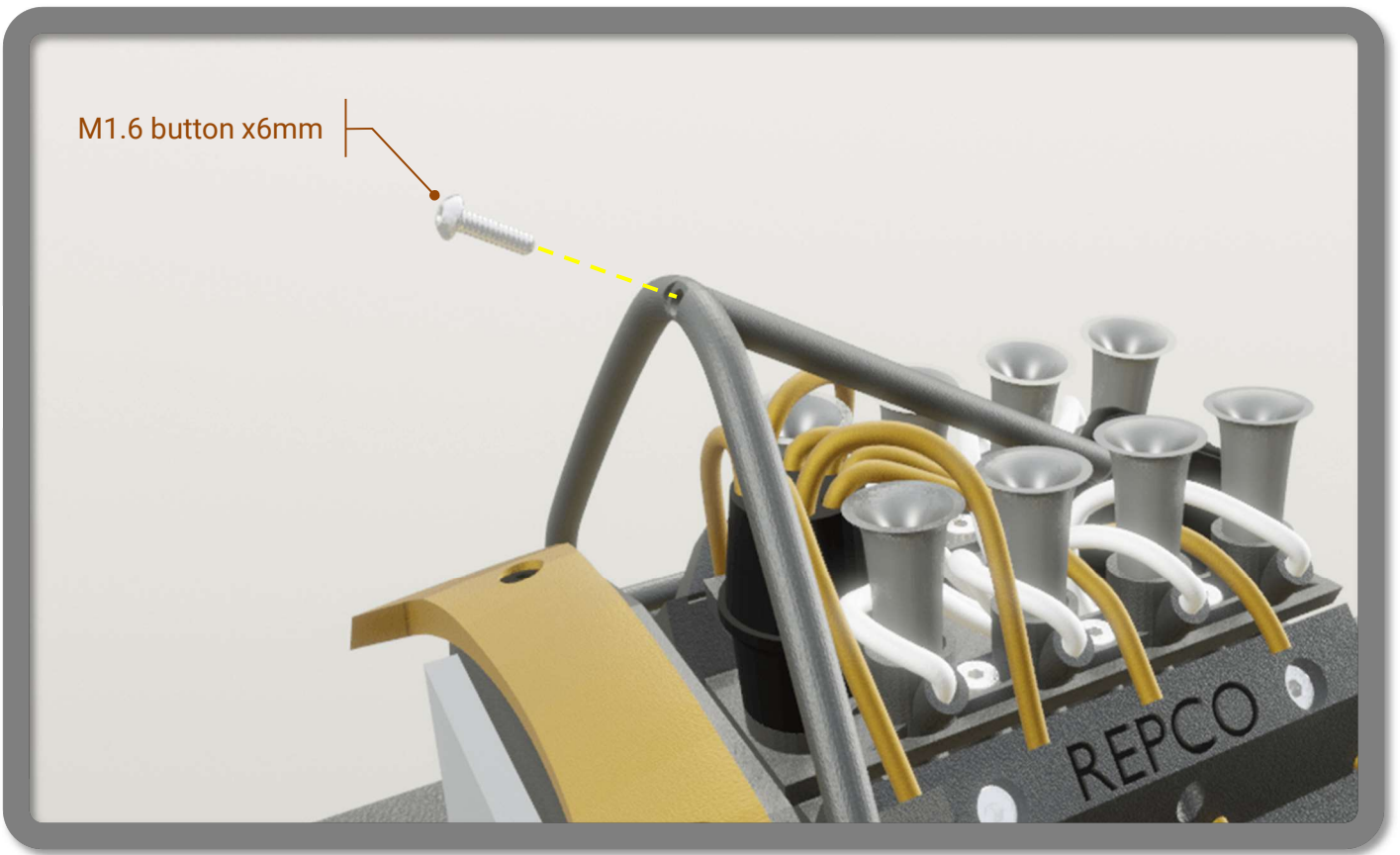

STEP 9 – EXHAUSTS

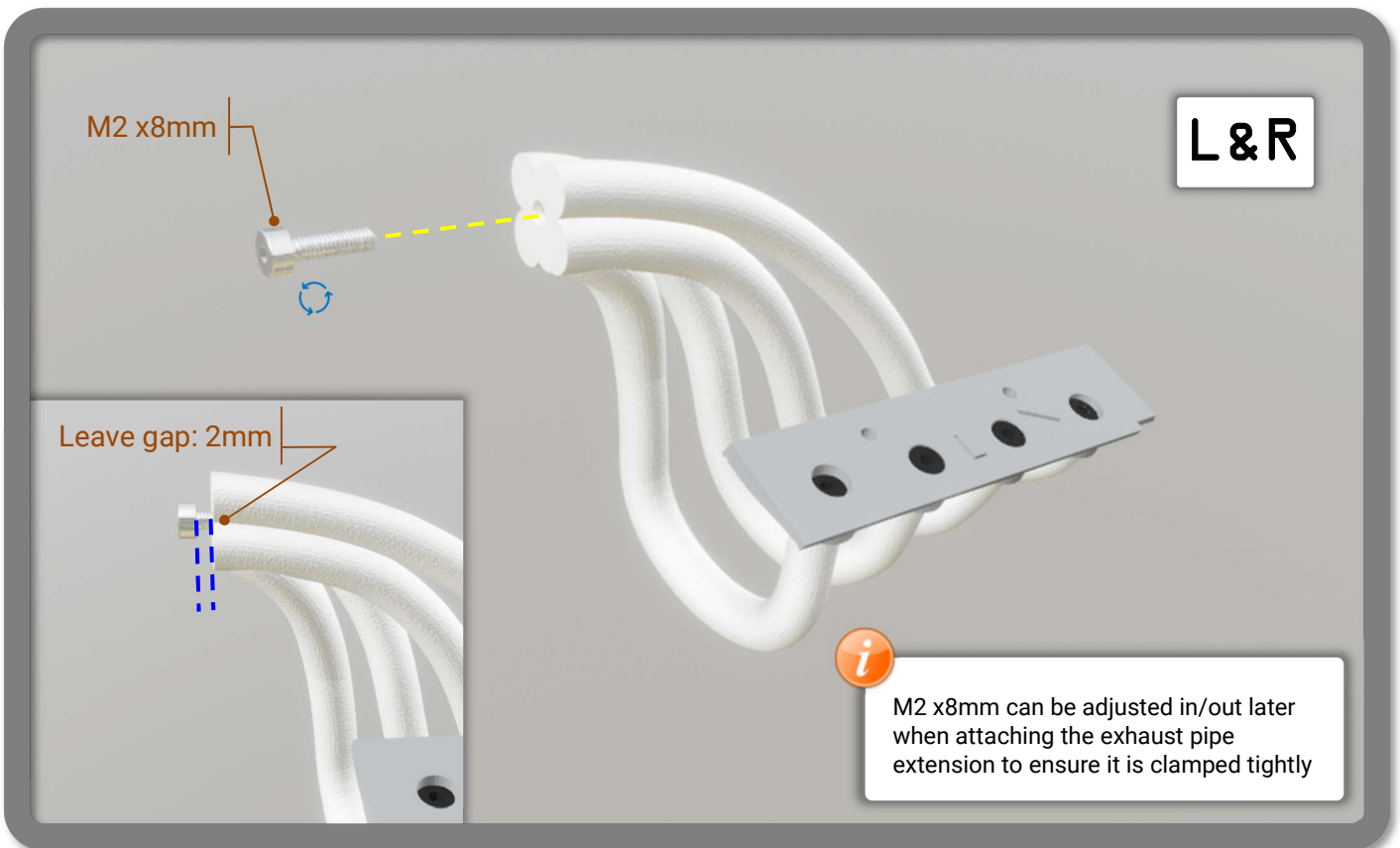
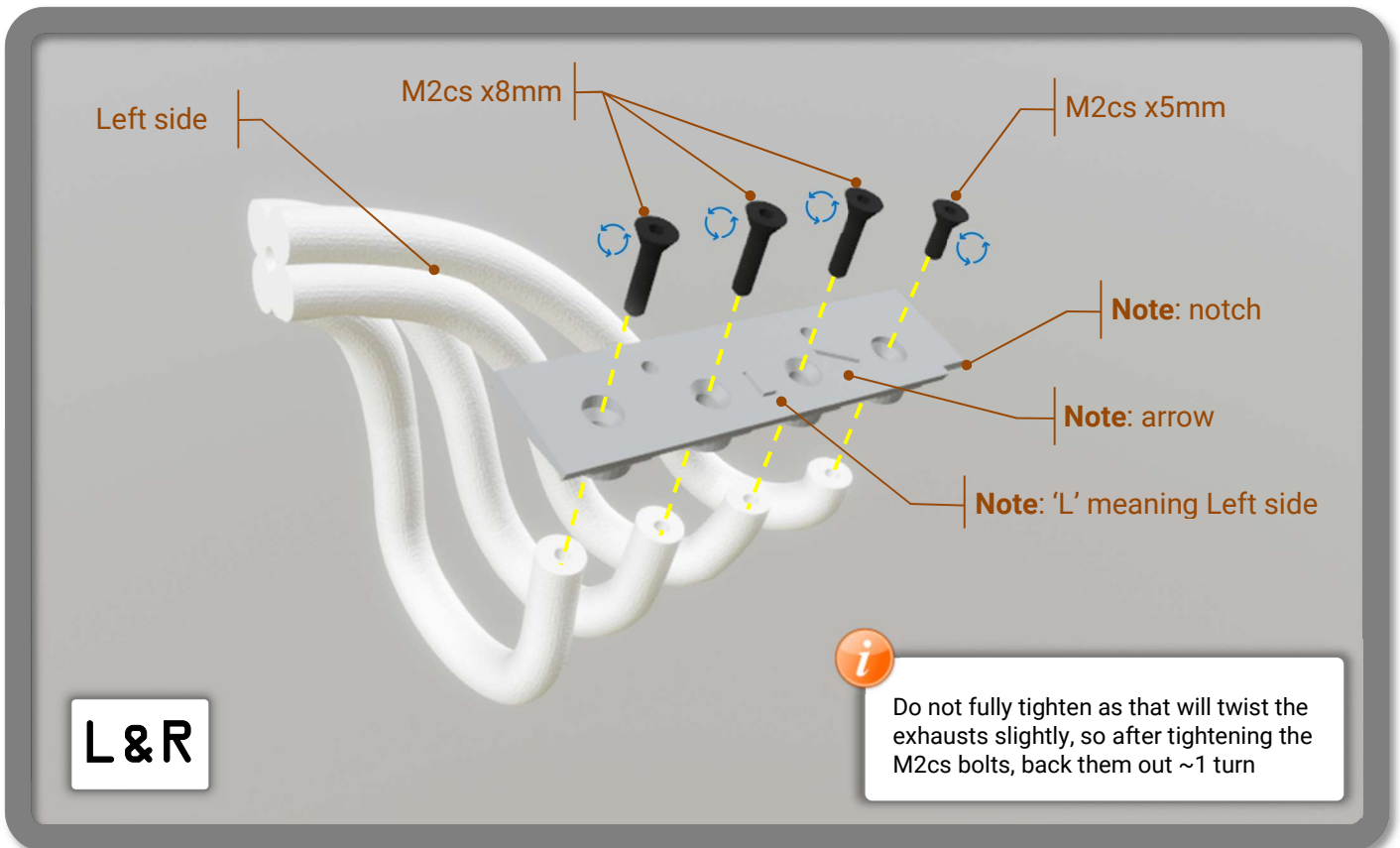

STEP 10 – EXHAUST PIPE EXTENSION

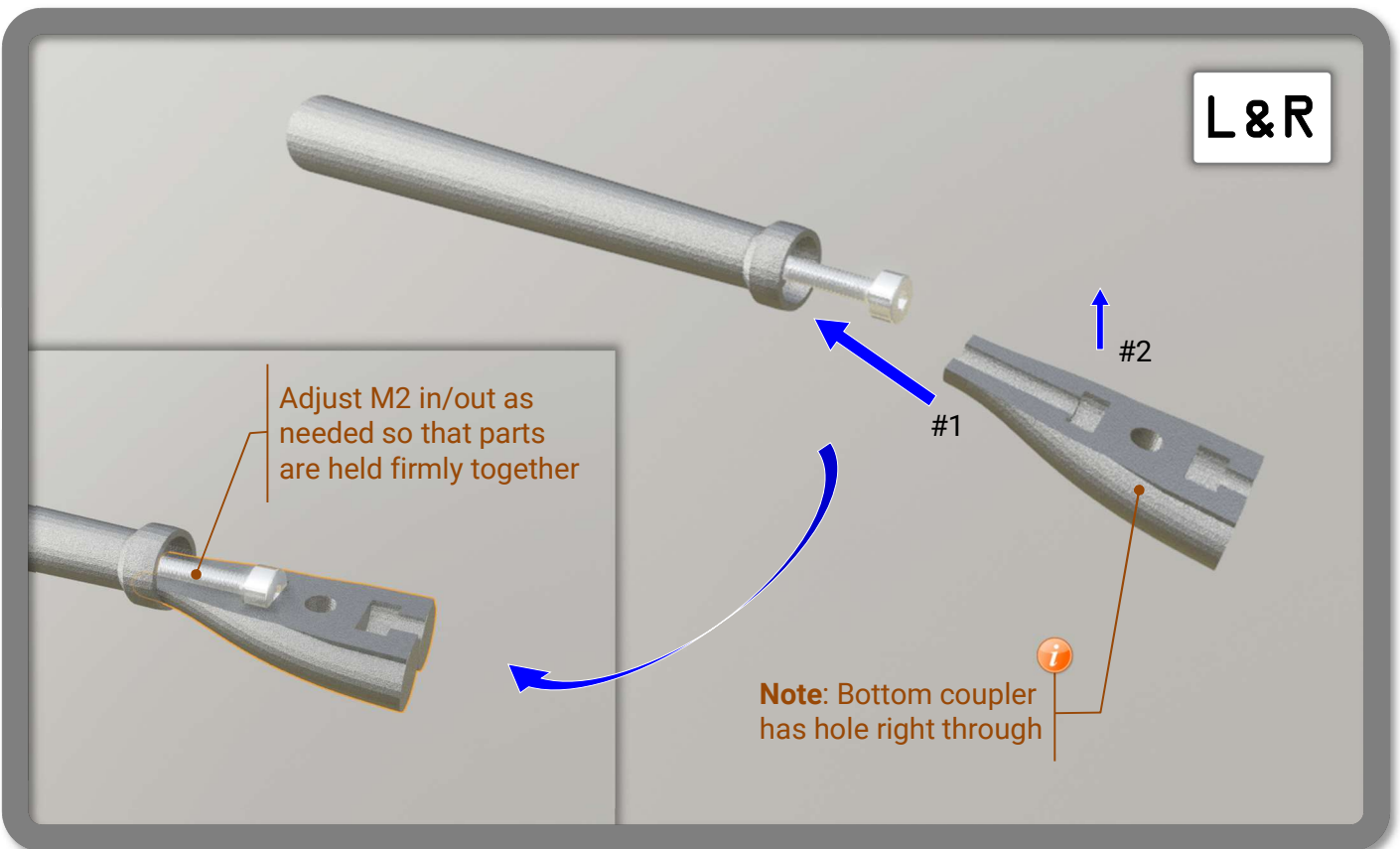
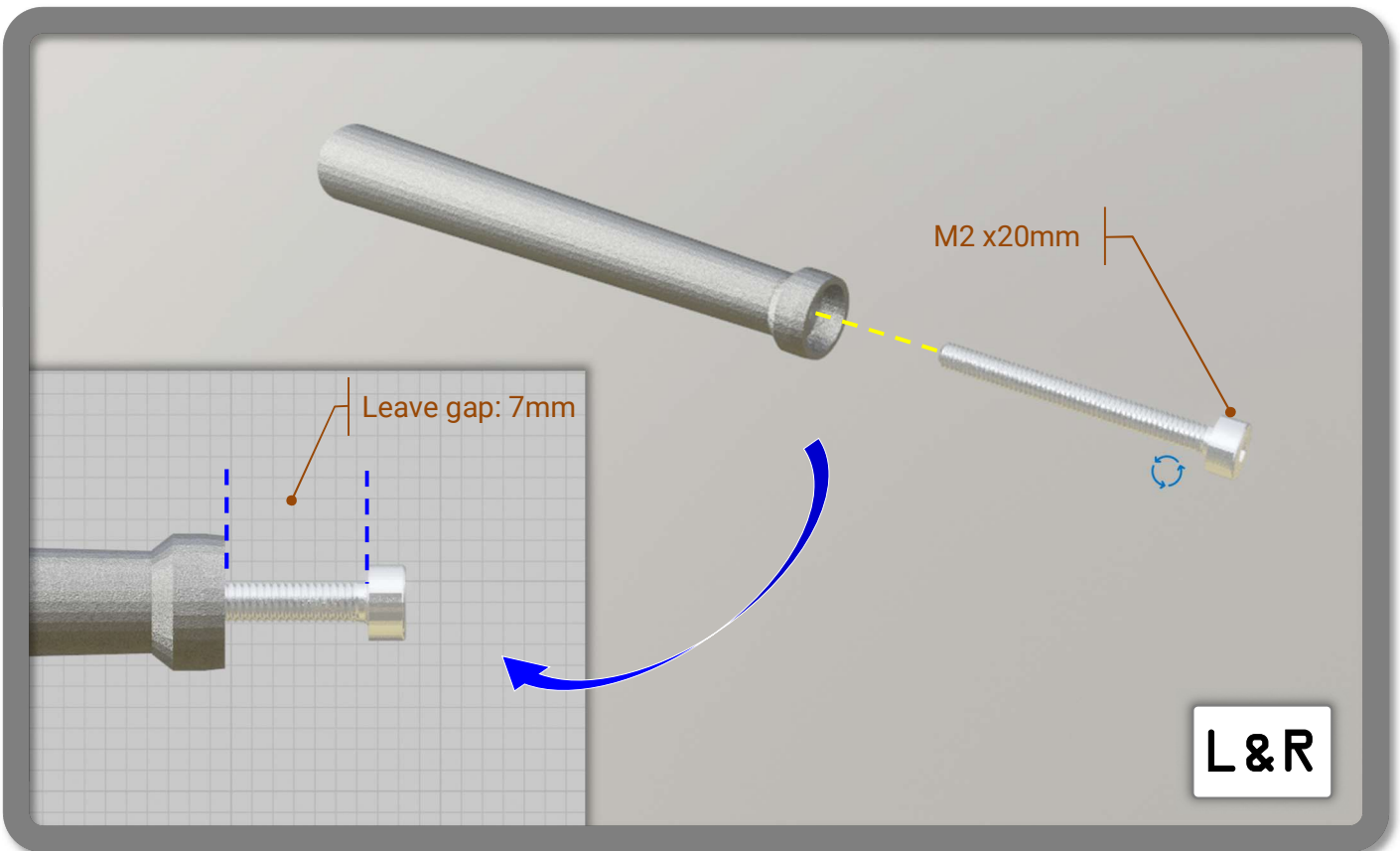

STEP 10 – EXHAUST PIPE EXTENSION

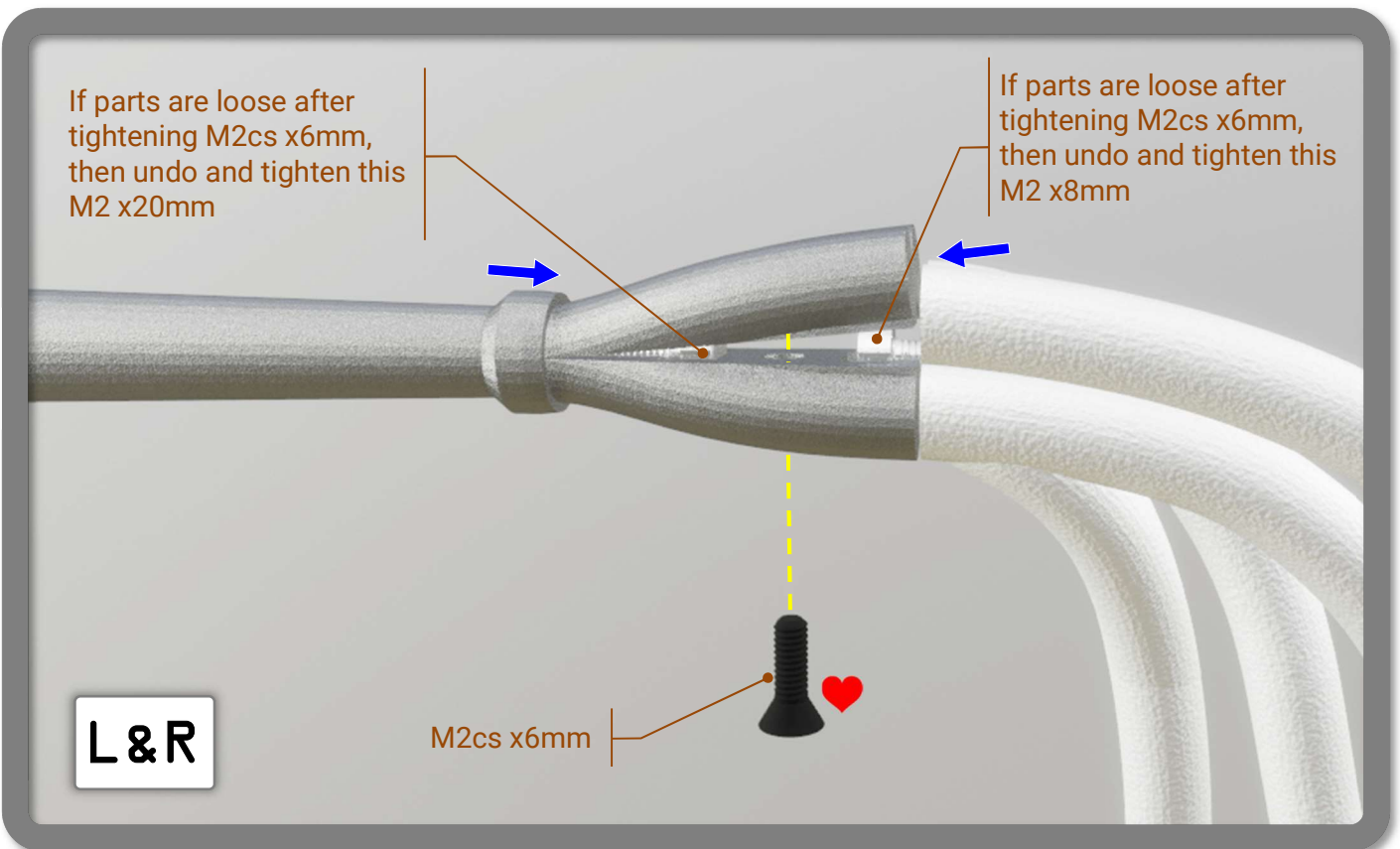
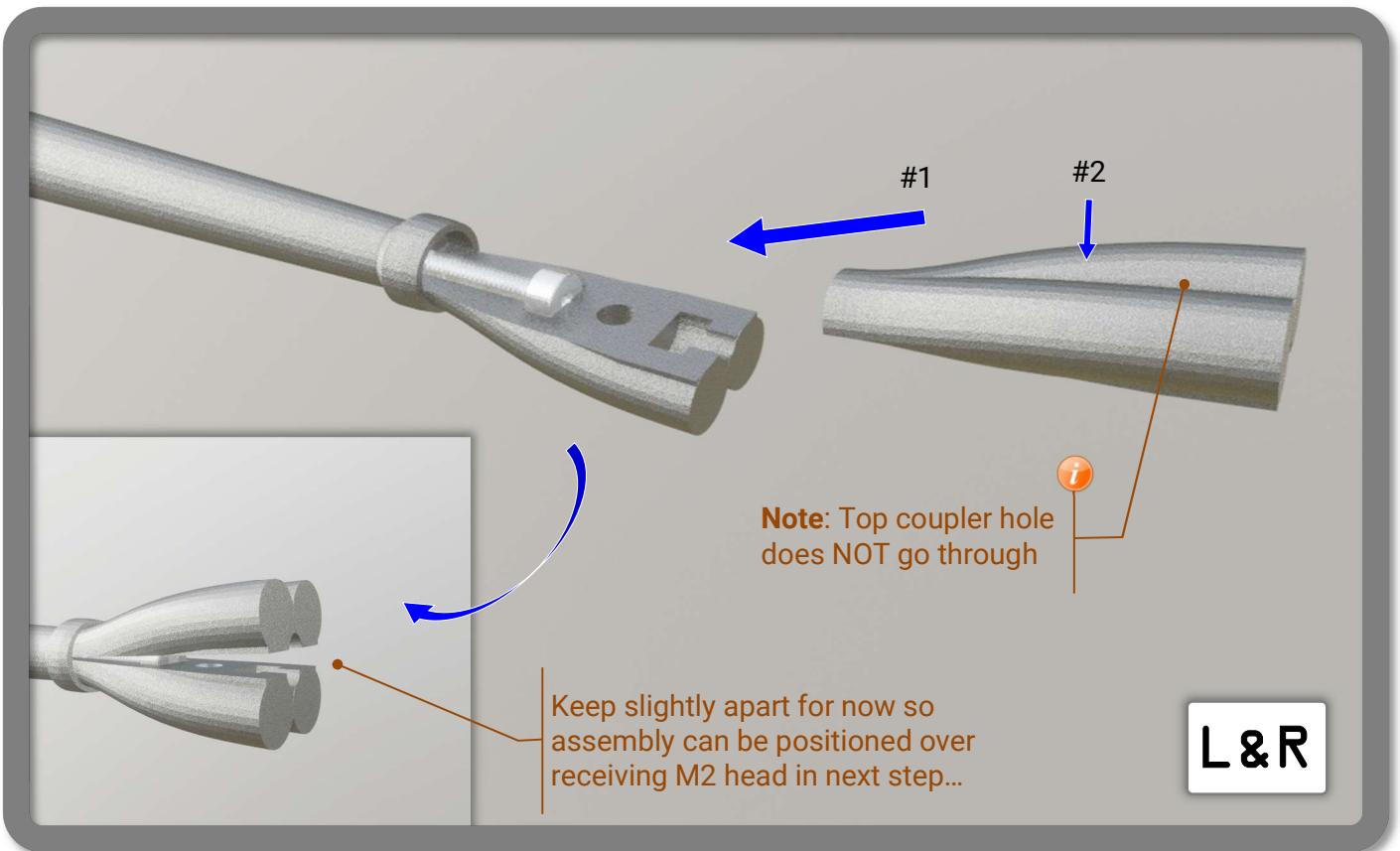

STEP 11 – EXHAUSTS ATTACHED

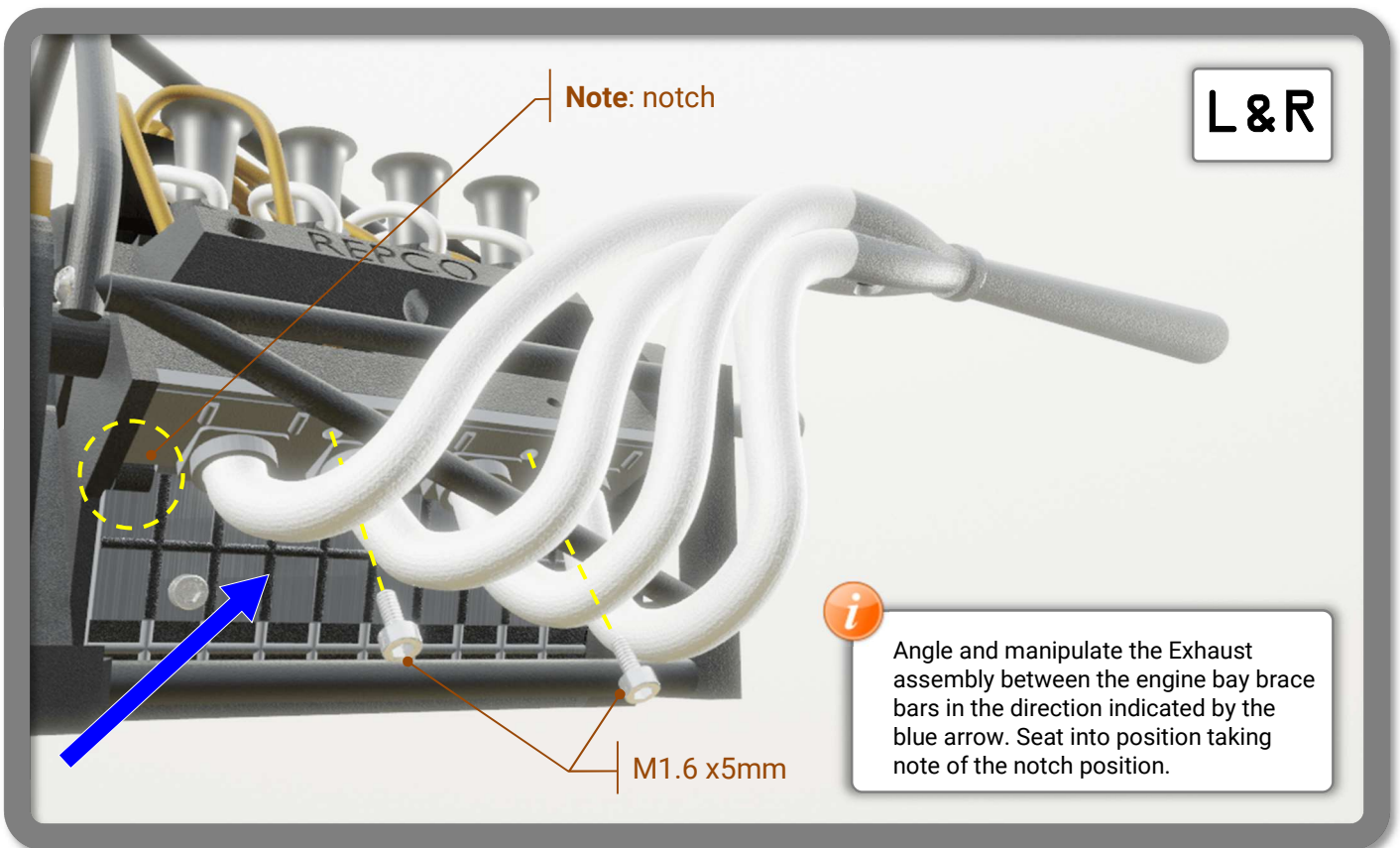
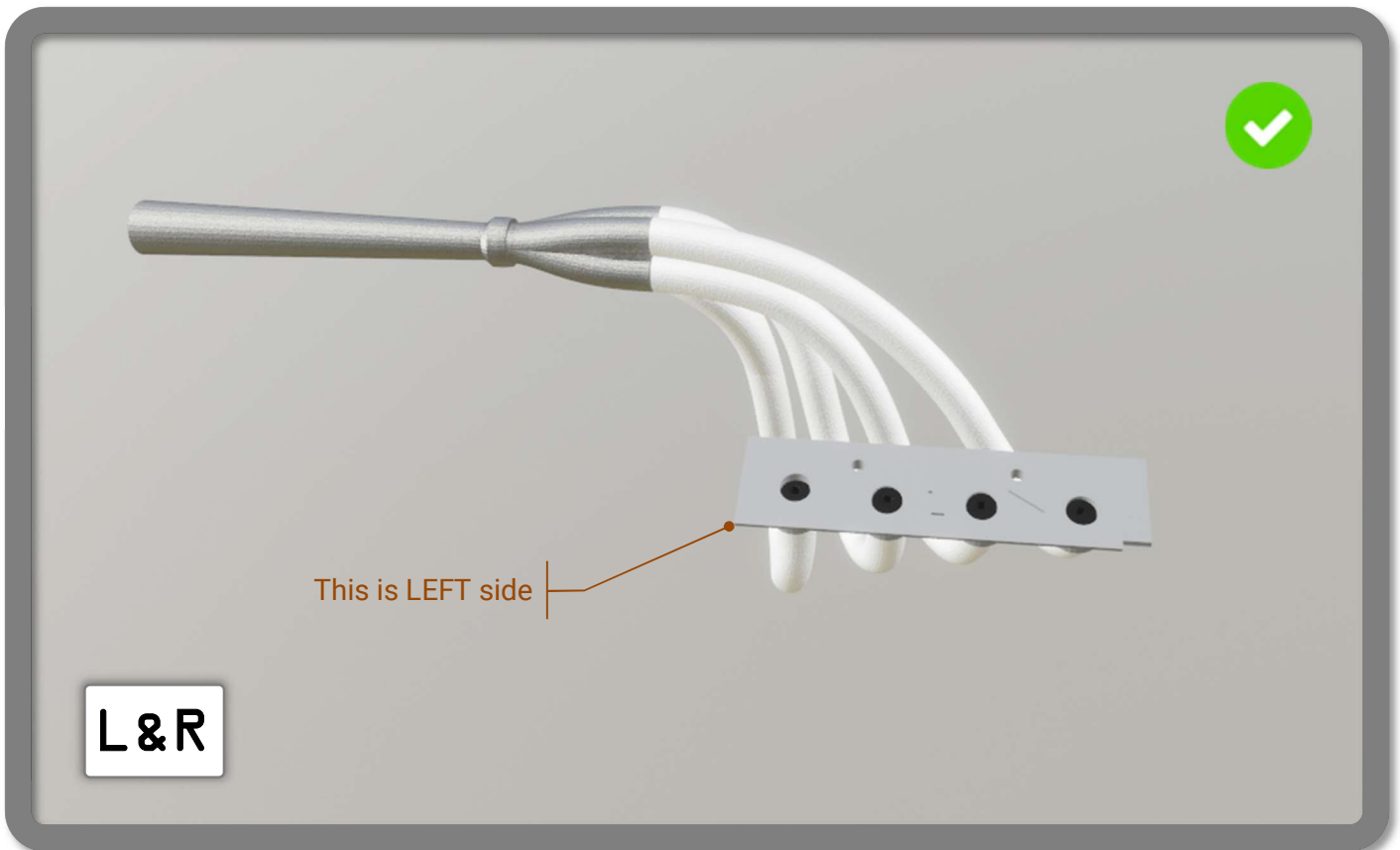

SECTION 7 – ENGINE DETAILS - COMPLETED

