

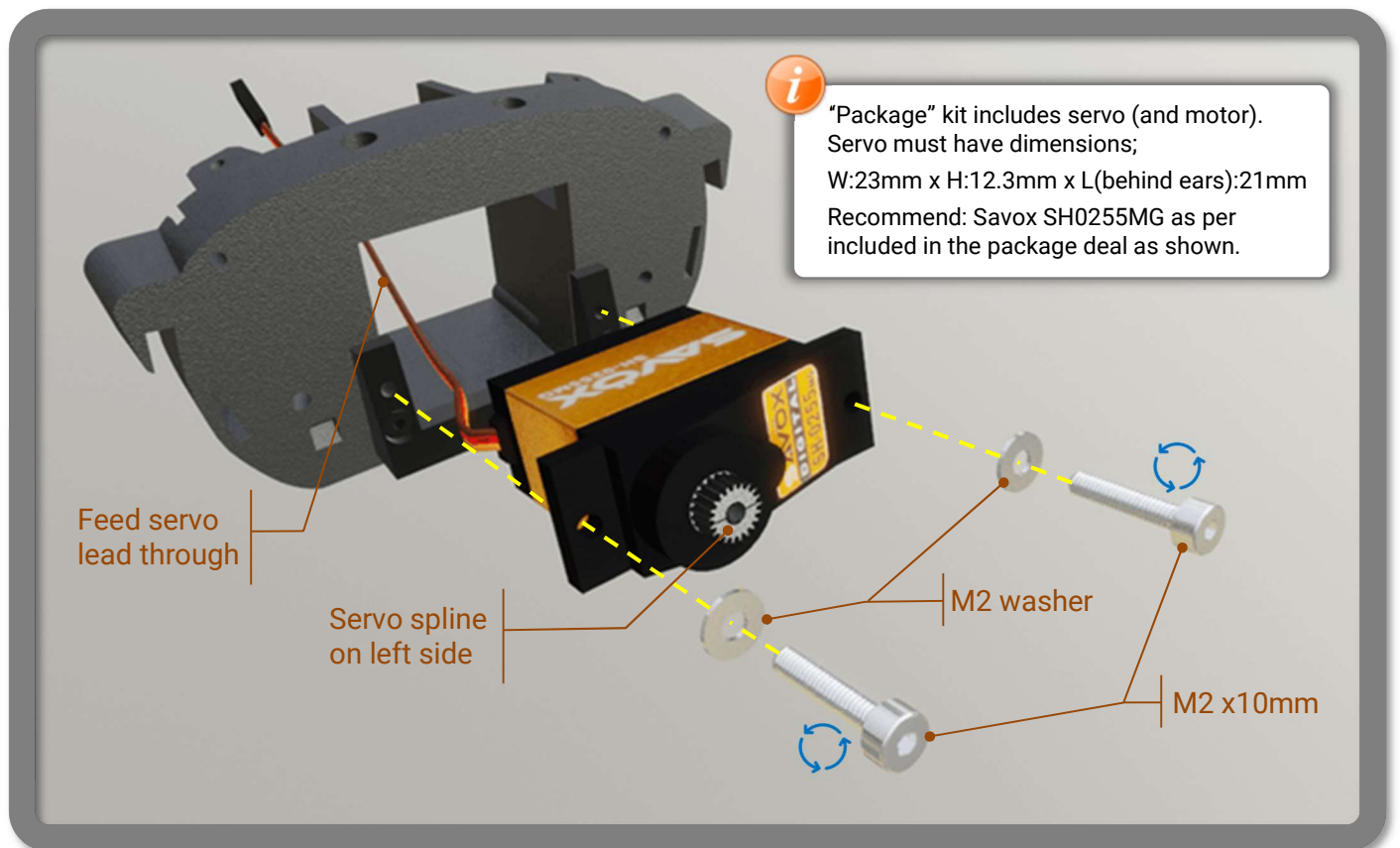

## SECTION 1. Front Bulkhead

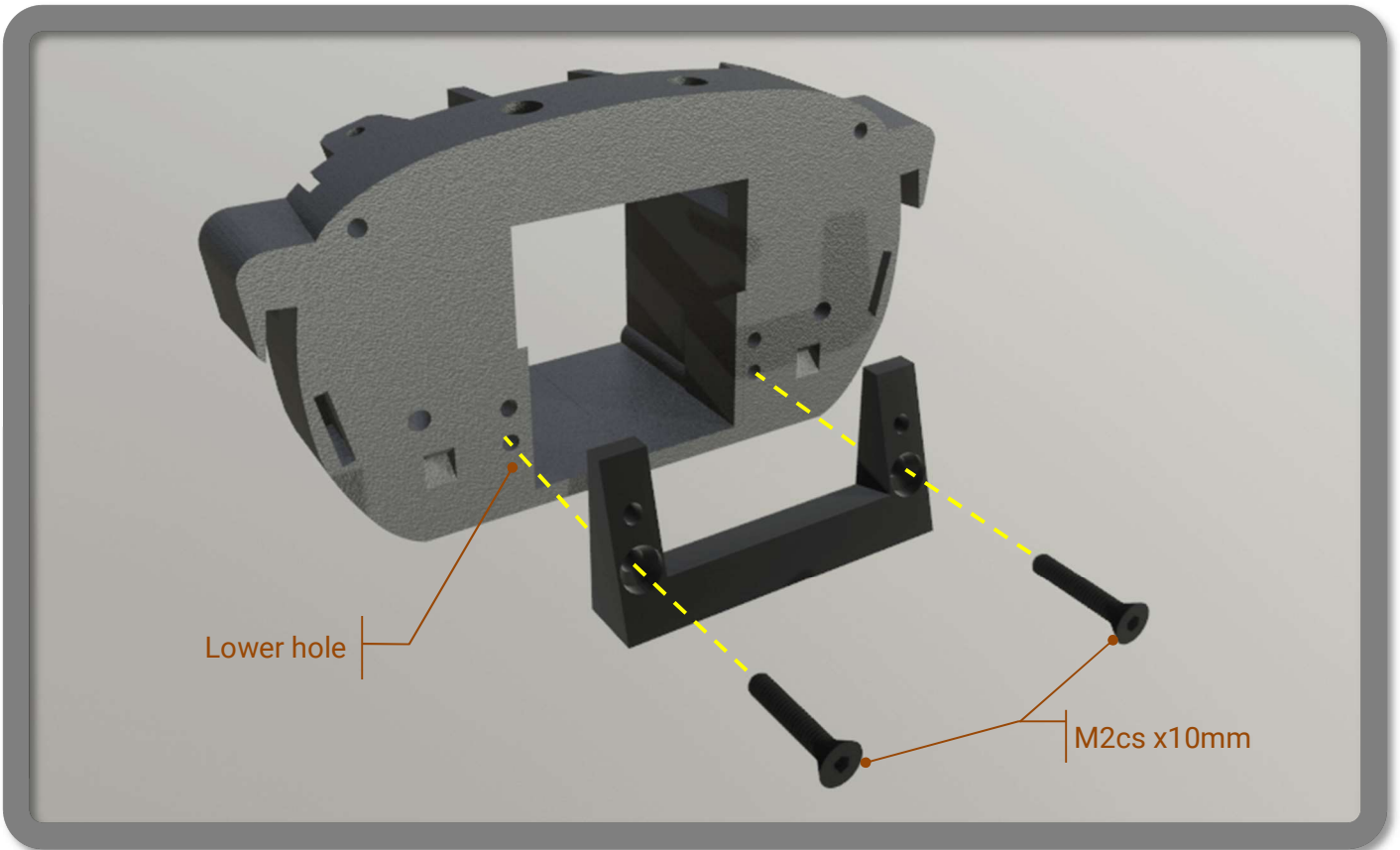

STEP 1 – SERVO INSTALLATION



STEP 2 – STEERING COLUMN SUPPORT

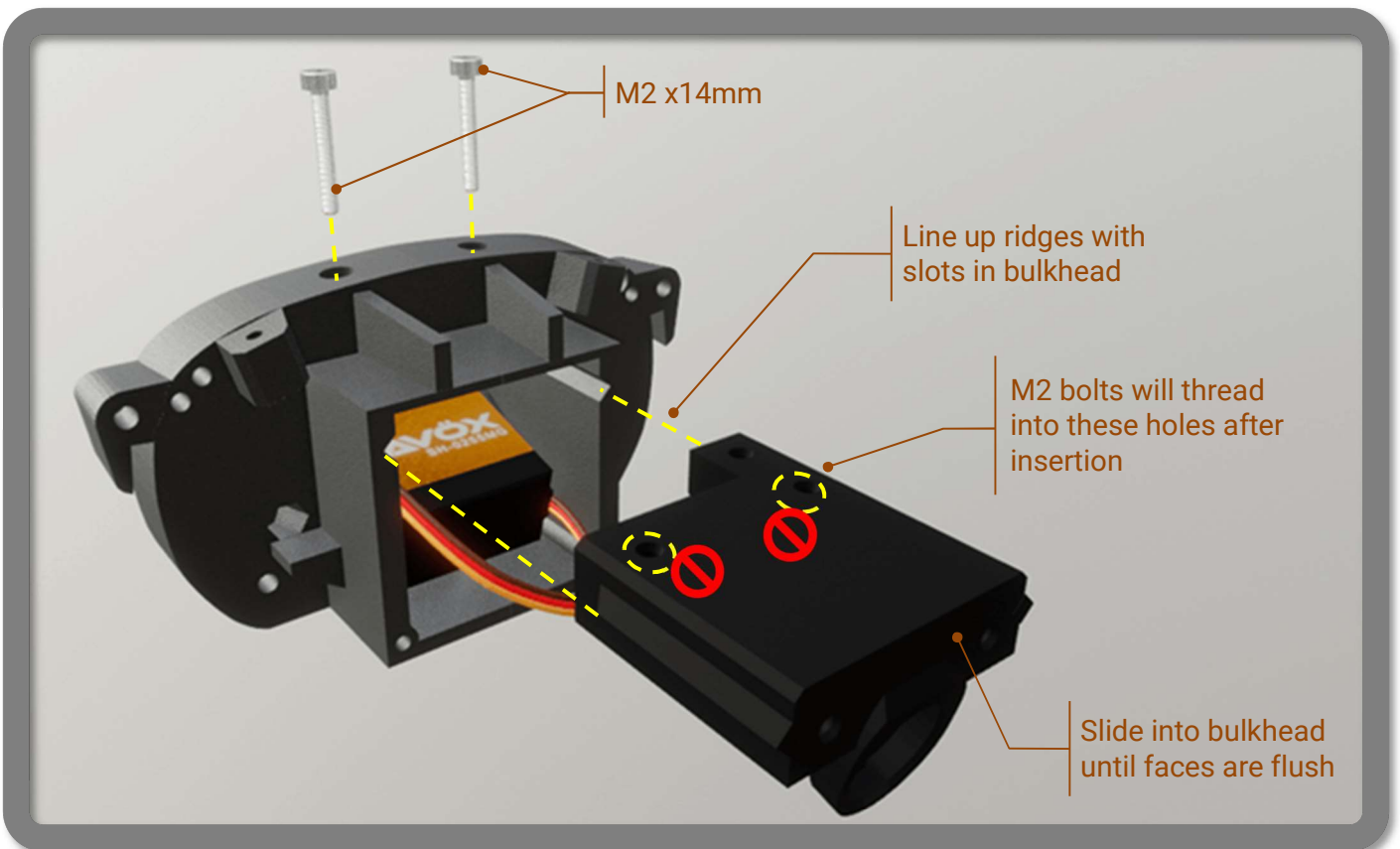
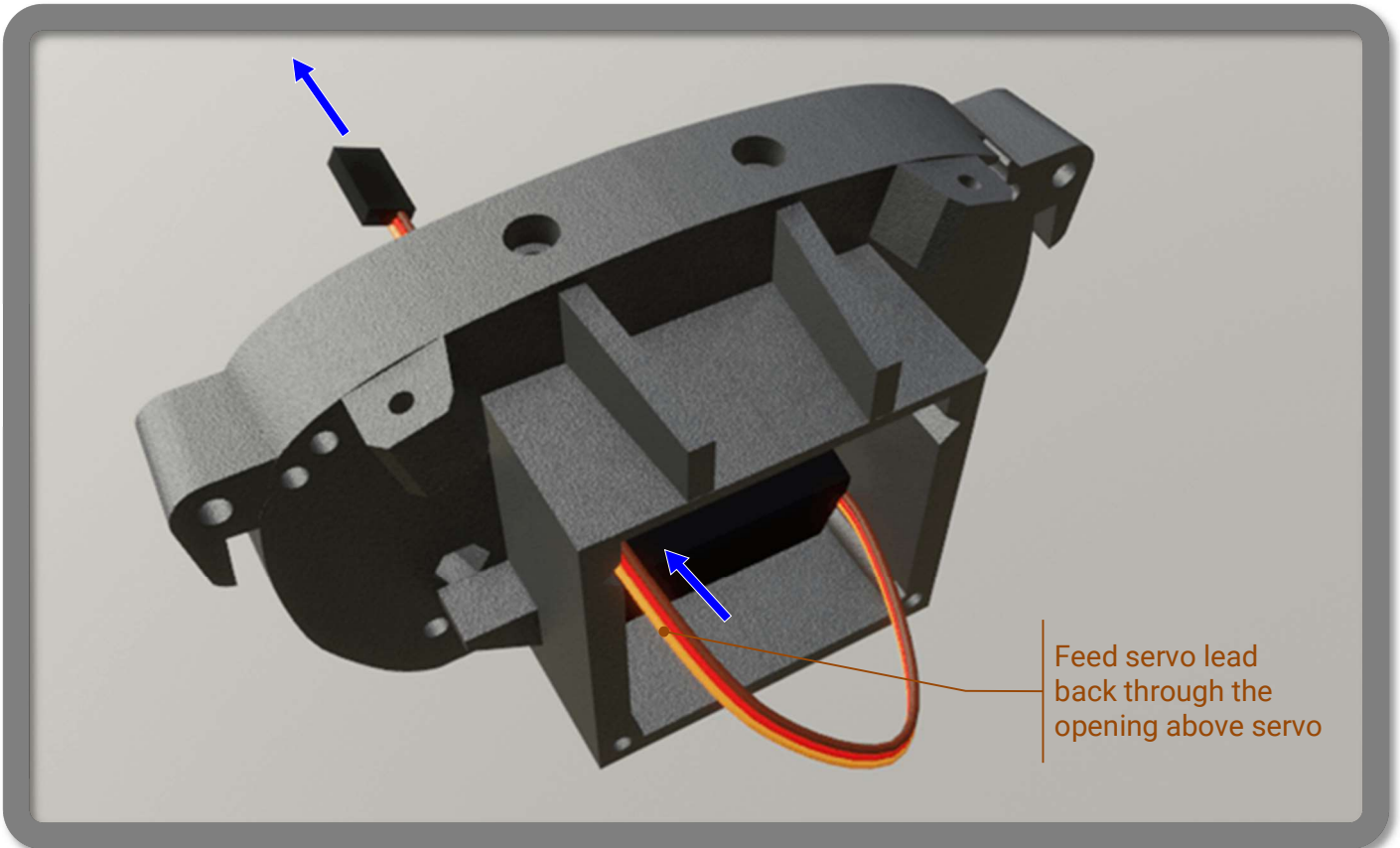

STEP 2 – STEERING COLUMN SUPPORT

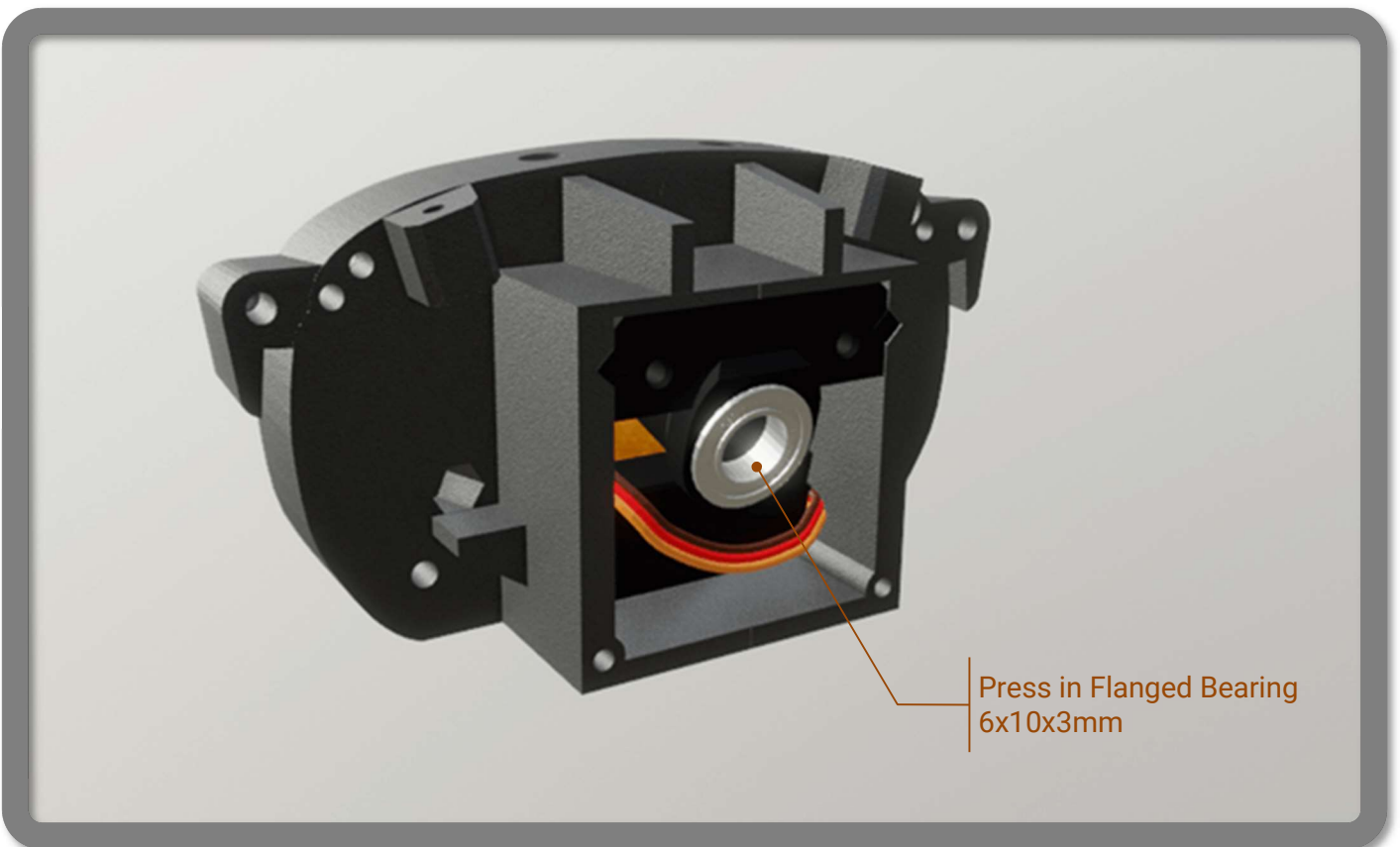
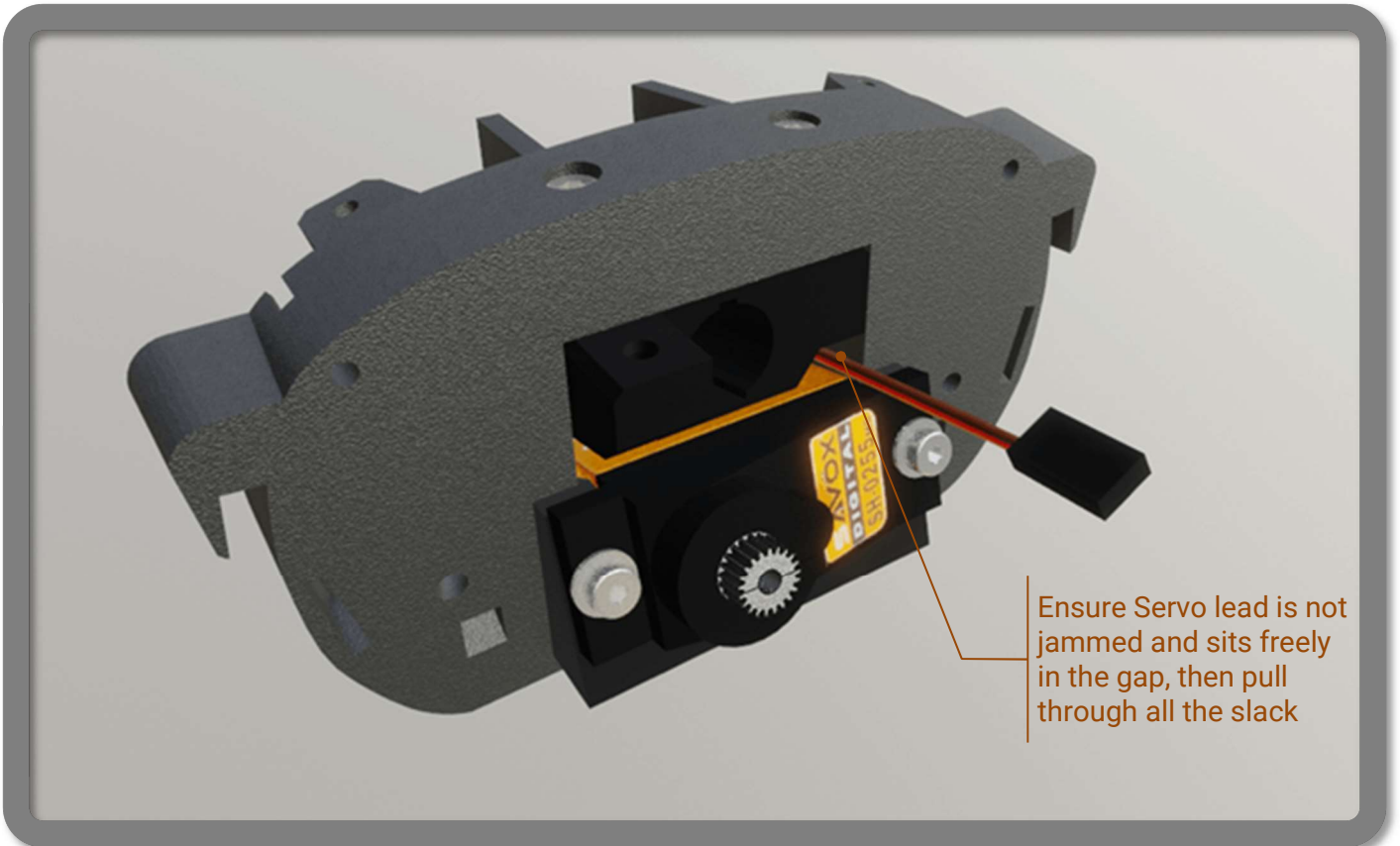

STEP 3 – STEERING COLUMN

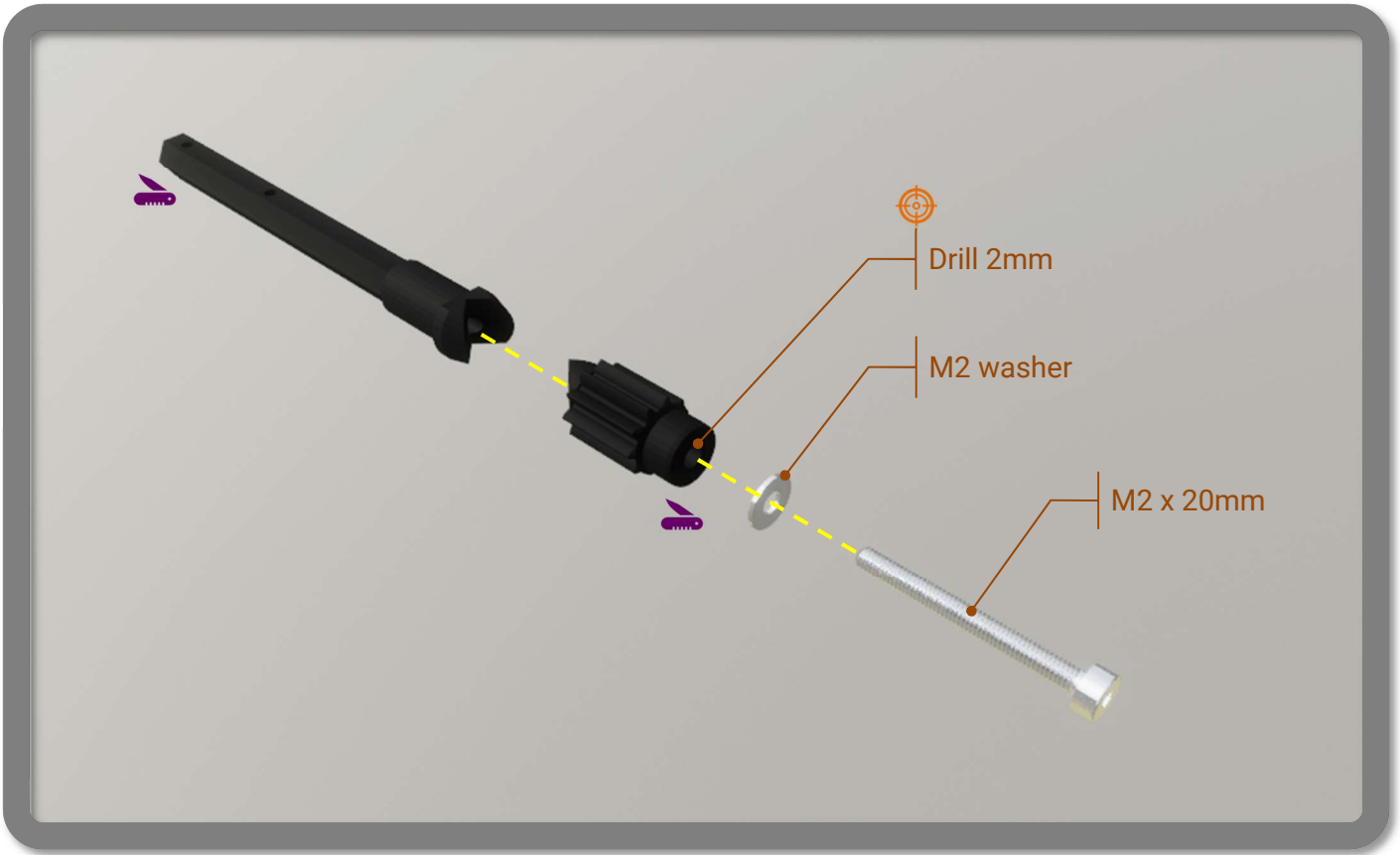

STEP 3 – STEERING COLUMN

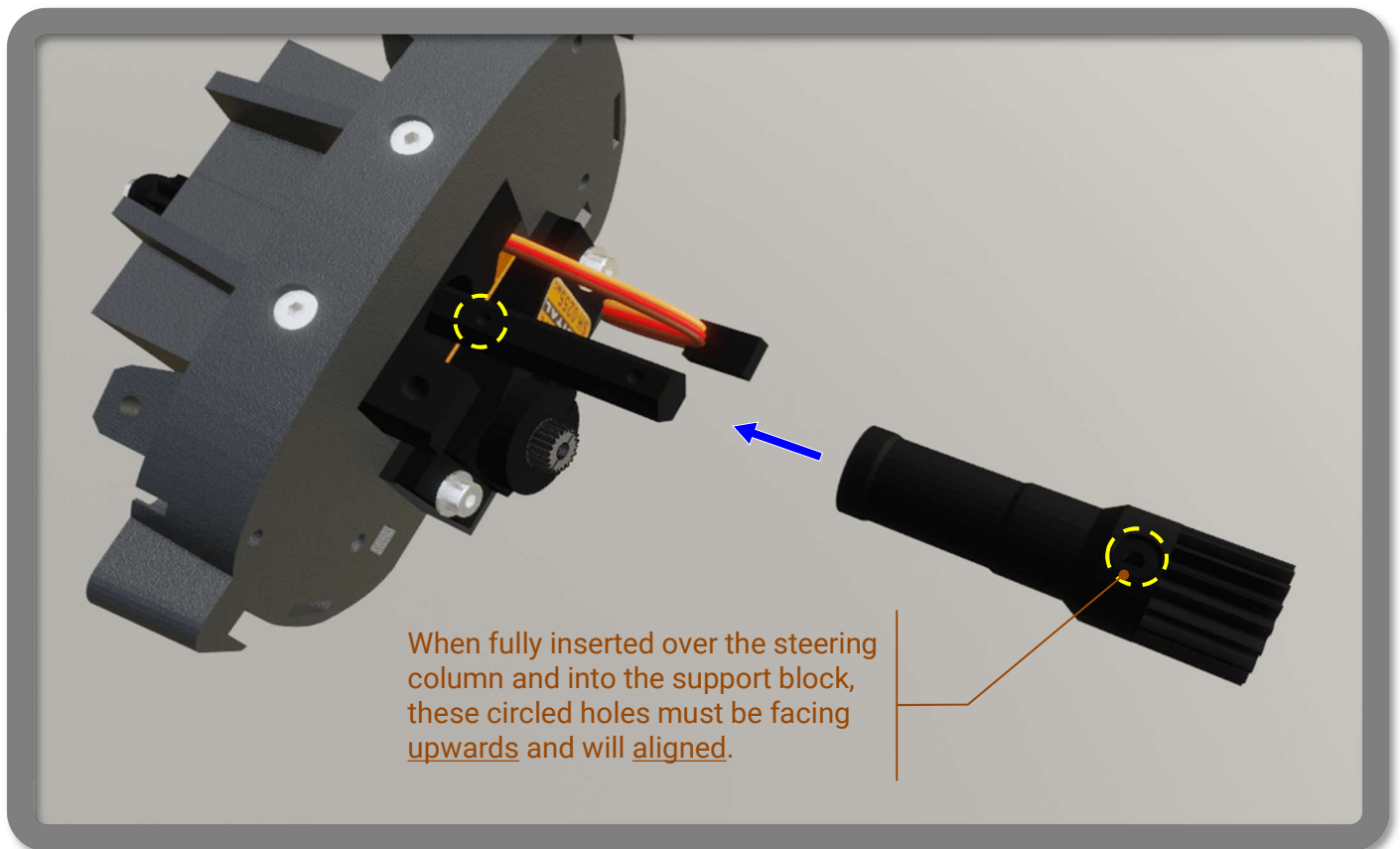
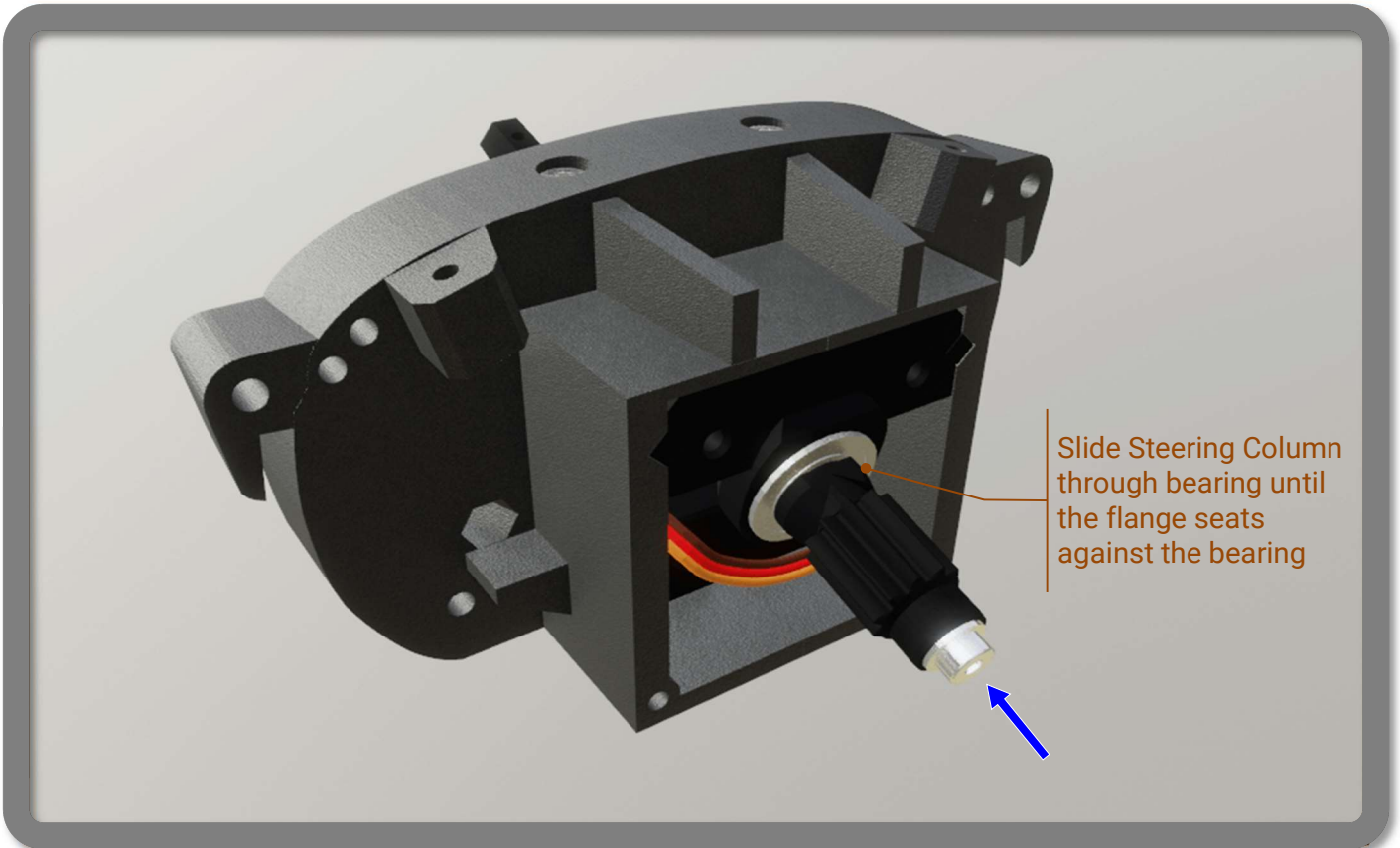

STEP 3 – STEERING COLUMN

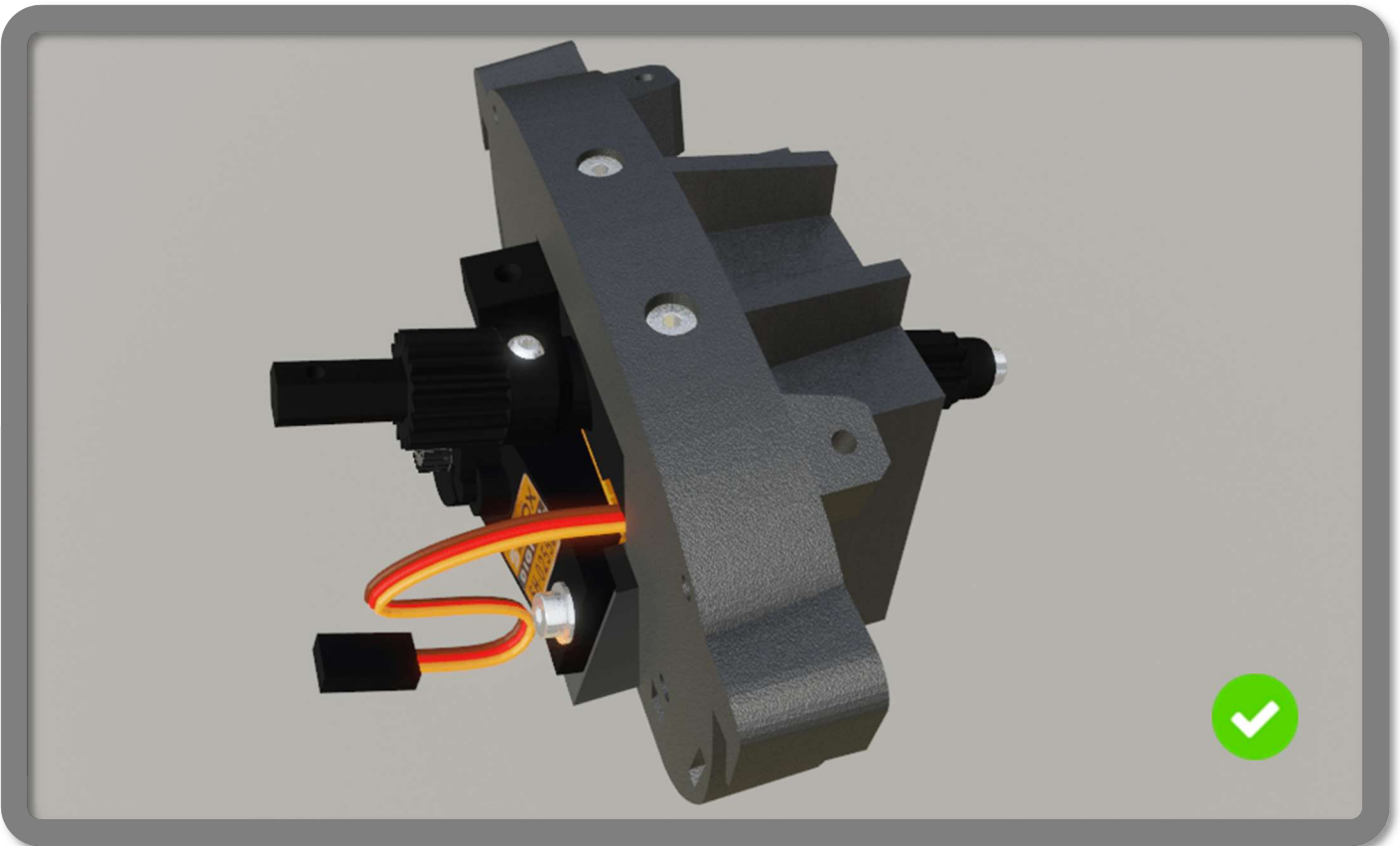
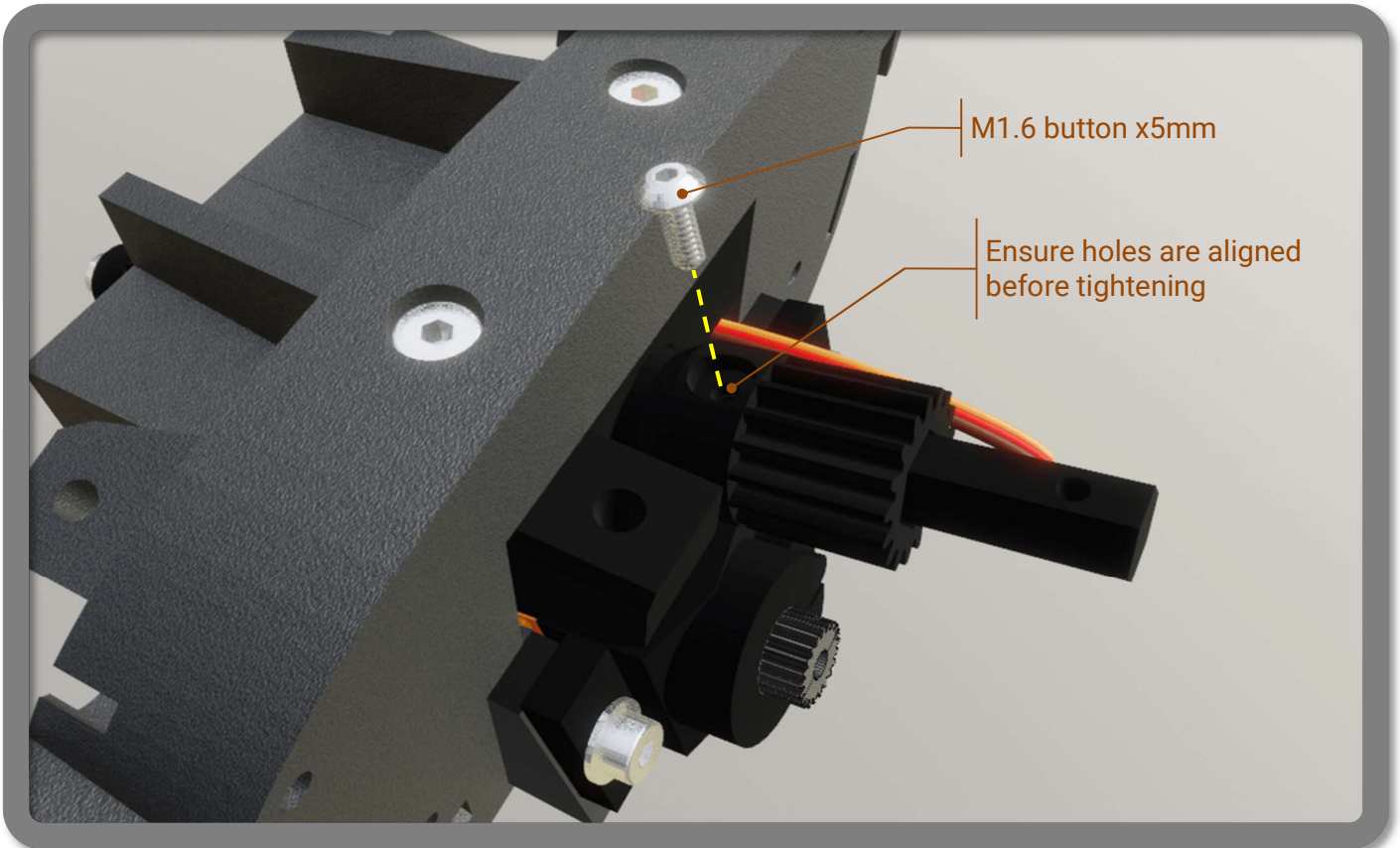

STEP 4 – STEERING GEARS

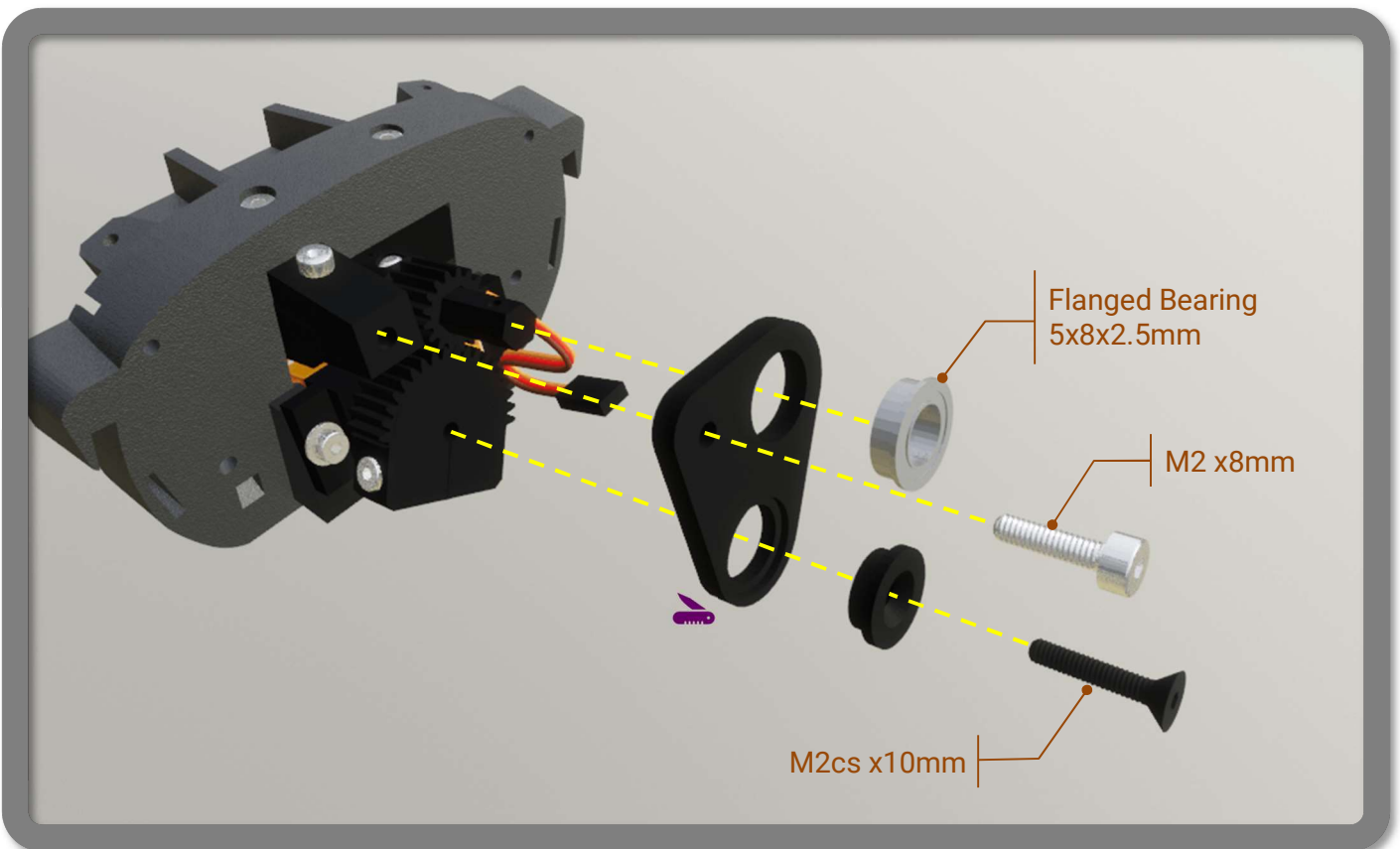
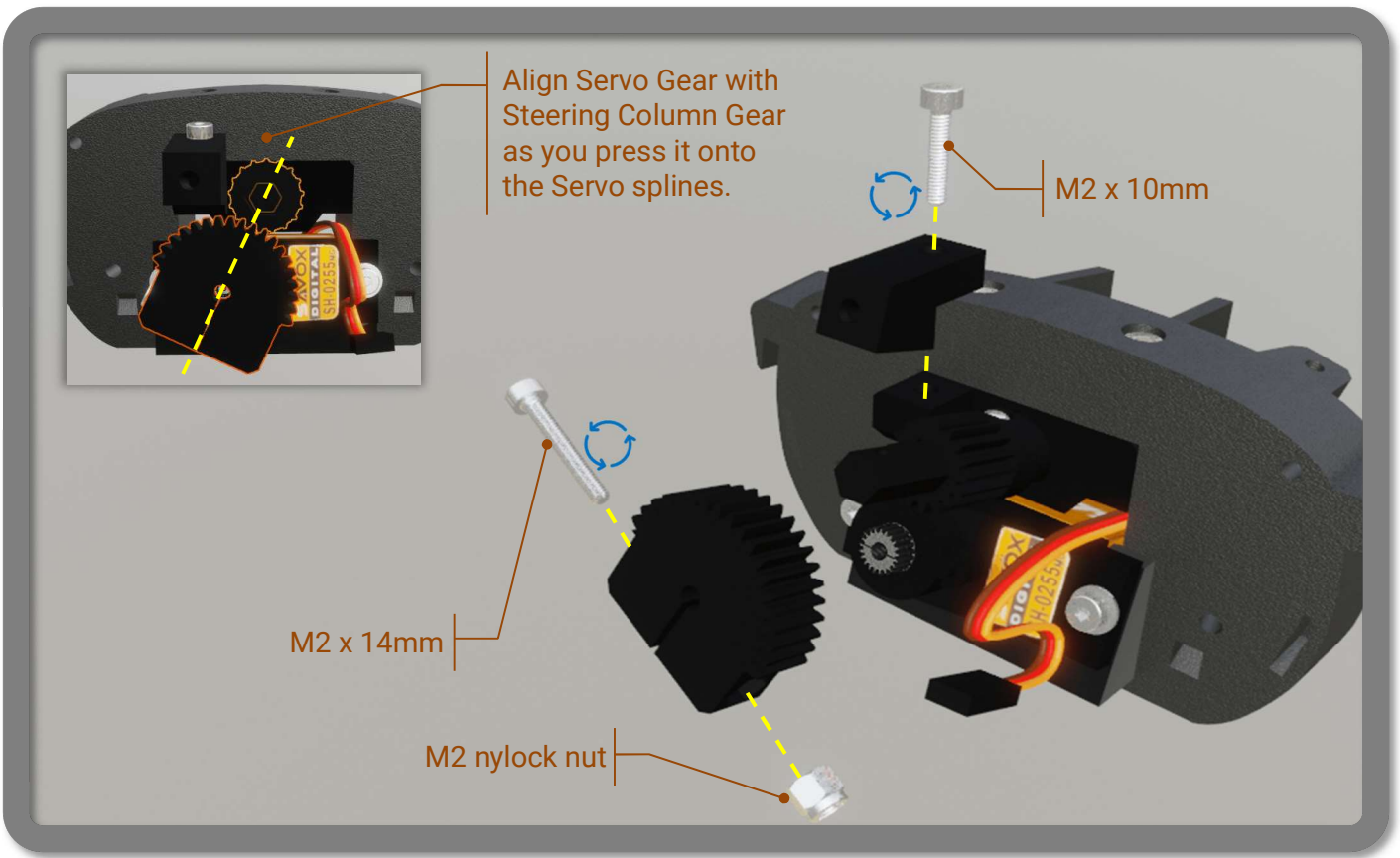



STEP 4 – ALIGNMENT TIGHTENING

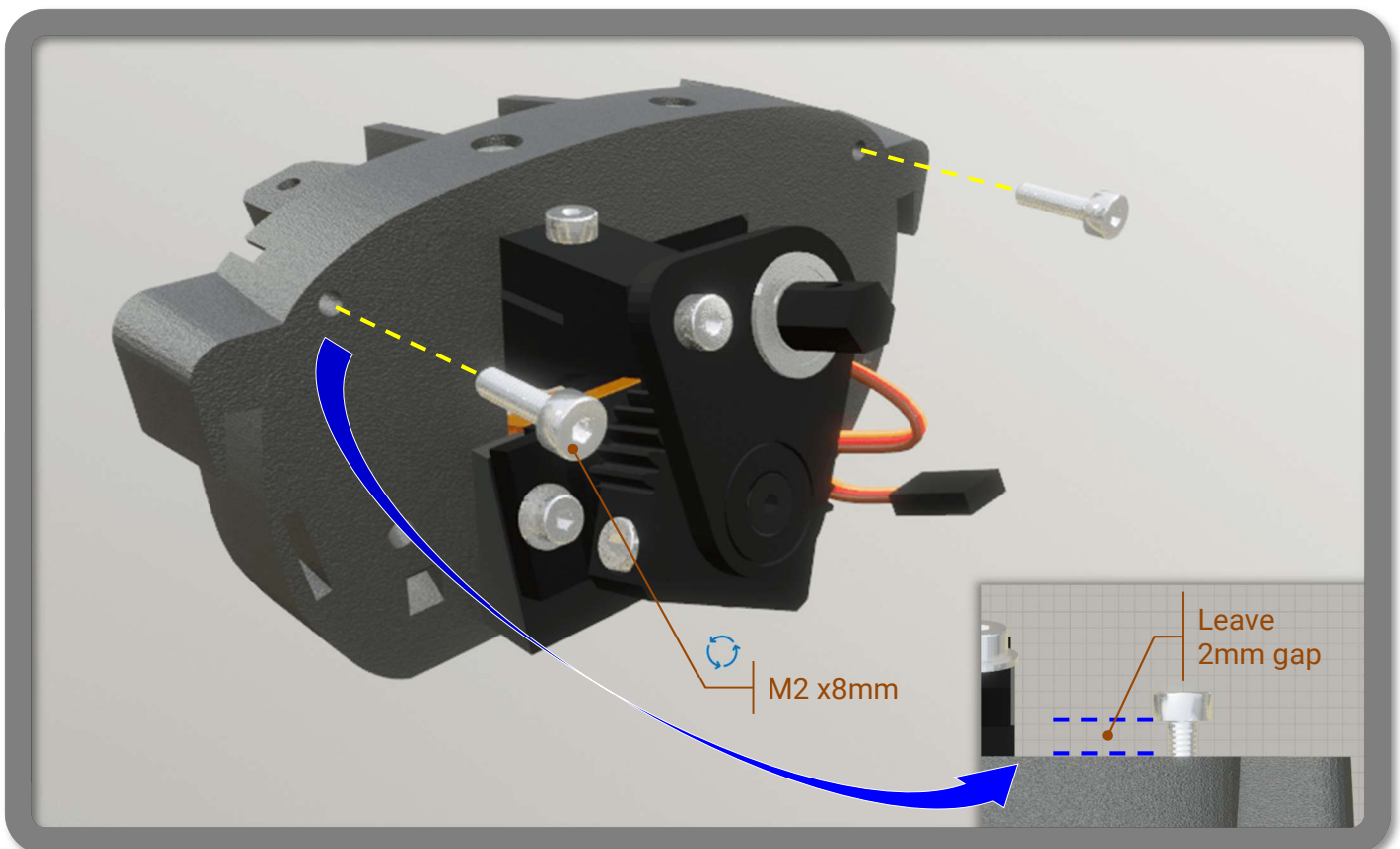
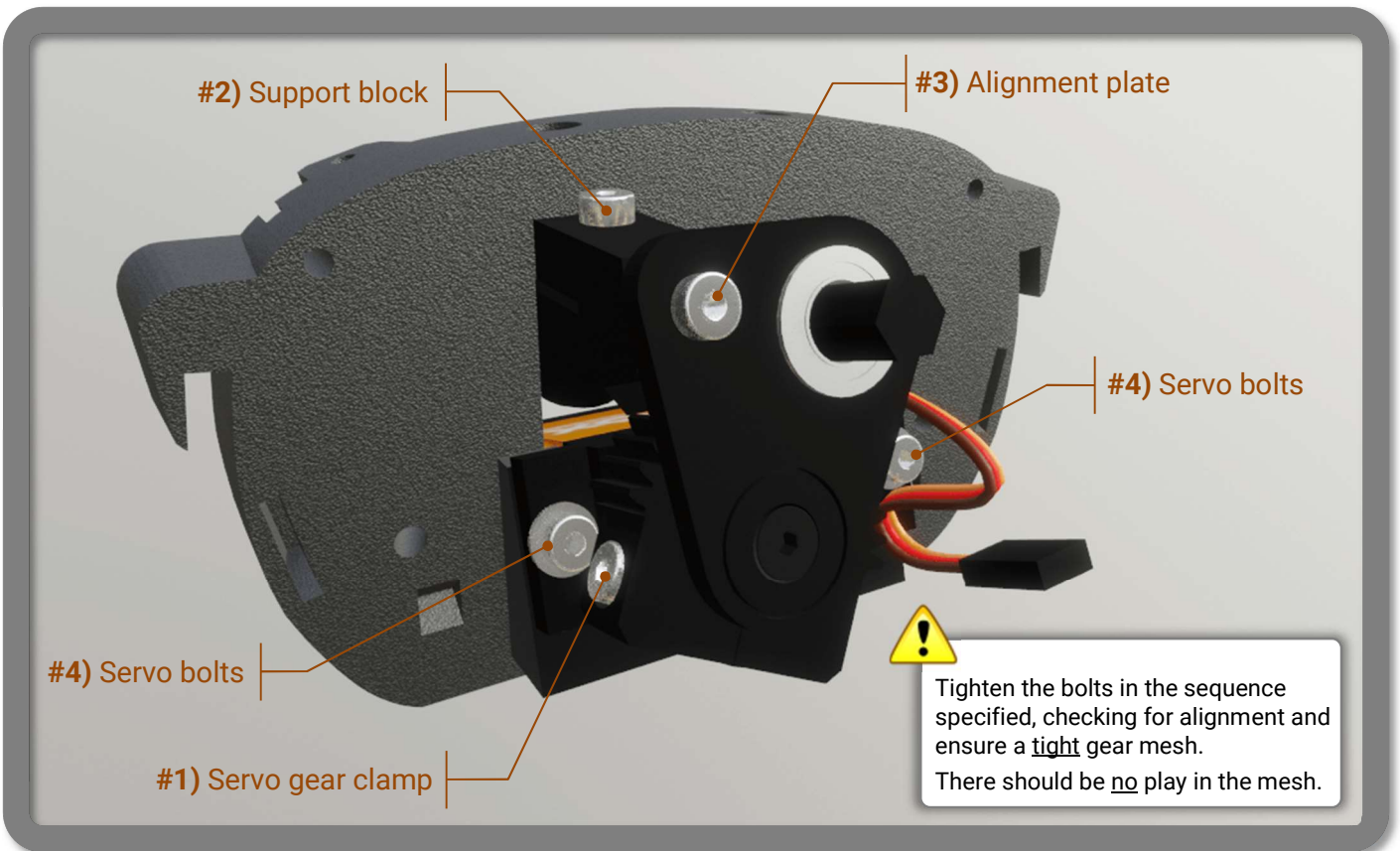

**SECTION 1 – FRONT BULKHEAD – COMPLETED**

