

SAFETY AND USE GUIDE

Please read this guide completely before using. Improper handling may result in product damage or an accident. Please keep this guide for future reference.

Please do not use with the following:



Dishwasher



Microwave



Oven

IMPORTANT SAFETY NOTES

Check your Carter to ensure that all pieces of product are accounted for and installed correctly. Do not use if parts are missing.

Do not use if you see signs of cracking, chipping, or any other abnormality.

Keep Carters holding hot beverages away from children and pets.

USE INSTRUCTIONS**Preparation Before Use**

Apply liquid dish soap to a soft sponge and wash thoroughly by hand.

Cleaning and Maintenance

Please hand wash Carter. Dishwashing the product—even on the top rack—may result in discoloration of the coating.

For hand washing, use only liquid dish soap. Do not use chlorine, bleach, or other chemicals to clean. Let air or towel dry thoroughly.

Using a coarse sponge, brush, or other rough surface will scratch the outer and interior surfaces of Carter. Use only a soft sponge.

While not in use, store Carter with the lid off to prevent unwanted smells.

Use Guide

Please pay attention when setting down. The Carter body is sturdy stainless steel but will dent if dropped on hard surfaces!

Carter is not microwave safe.

Do not use any metal stirring utensils in Carter. This will scratch the ceramic non-stick coating.

Do not let children use.

**FOR CARTER MOVE WITH:
SPLASH GUARD**

Simply snap in the splash guard for sip security on-the-go. Use the knob on the splash guard to push in or pull out of Carter.

If the splash guard gets stuck while you are attempting to remove it, rotate it back and forth clockwise and counterclockwise slightly until the splash guard releases and unsticks itself.

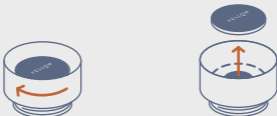
**FOR CARTER MOVE WITH:
360° SIP LID**

Simply thread on the lid for easy sipping on the move.

Please note: This is an open lid and, if tilted, can splash liquid. This is not a fullysealed, leak-proof lid.

To clean the 360° Sip Lid, pull off the circular shaped splash umbrella. The umbrella should come off easily, as it is attached by a magnet. Thoroughly wash with warm soapy water and a soft sponge.

**For more help head to:
help.fellowproducts.com**

Fellow Industries Inc.

San Francisco, CA 94110

U.S. and International Patents Pending

Fellowproducts.com