

Dix

INSTALLATION & CONFIGURATION

Questions?

support@archercomponents.com +1 831 313 7400

Hardware Included

- 4 x Battery door screws (1 extra)
- 2 x Jagwire ferrule
- 1 x Jagwire LEX-SL bowden housing
- 1 x 60cm Jagwire slick shift cable
- 3 x Jagwire cable end caps
- 2 x P-strap clamps
- 2 x P-straps
- 5 x P-strap clamp screws (1 extra)
- 1 x SRAM MatchMaker clamp and included hardware
- 2 x 14500 lithium-ion rechargeable shifter batteries
- 1 x 10440 lithium-ion rechargeable remote battery
- 1 x USB li-ion battery charger
- 4 x Griptape stars (optional extra grip for remote buttons)
- 2 x 12oz aluminum can coozies (optional but highly recommended)

Required Tools

- ✓ 1.5mm hex driver
- ✓ 2.5mm hex driver
- ✓ 5mm hex driver
- ✓ cable/housing cutters

Step 1: Install App

Download and install the Archer Components app from the Google Play Store or Apple App Store.



Step 2: Charge Batteries

Charge the shifter and remote batteries completely before installation using the provided charger.

Step 3: Shifter Preparation

1. Install Batteries

- Remove the small screw holding the battery door cover closed with a 1.5mm hex driver.
- Insert the two 14500 li-ion rechargeable batteries into the battery channel, **POSITIVE END FIRST**.
- Close the battery door and tighten the screw.

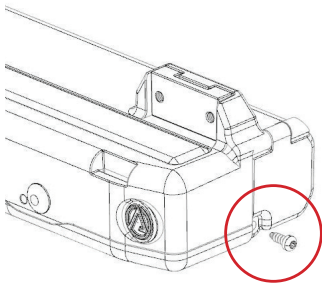

Note: **Do not use alkaline AA batteries.** Although they are the same size, they run a much lower voltage and the shifter will not perform well.

2. Install Shift Cable

- Place the shifter along your chainstay and measure the cable and bowden housing lengths you will need for your bike. Keep the housing as smooth as possible. You may need to pre-bend it to get the right shape for your bike.
- Peel back the bumper to expose the cable opening.

- The black drive nut that moves along the screw inside the shifter should be at the front of the shifter.

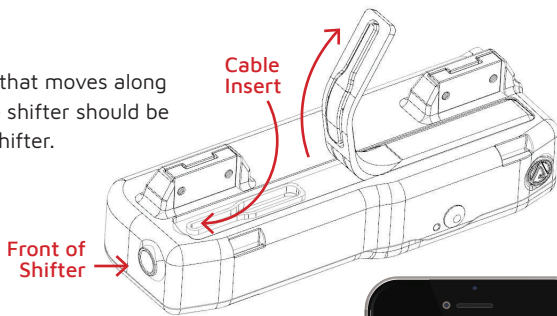

If not, power on the shifter, pair with the app, and go to "Settings > Change Shifter Cable"

- Pass the Archer Components shift cable through the hole at the top of the drive nut and thread it out the hole on the front of the shifter.
- Affix ferrules to the bowden housing and slide the shift cable through. Fit the shifter end ferrule into the hole on the shifter.
- Pull the shift cable snug against the drive nut and take care that the barrel of the shift cable is not caught on the small metal tab on the drive nut.
- Replace the cover over the maintenance door.

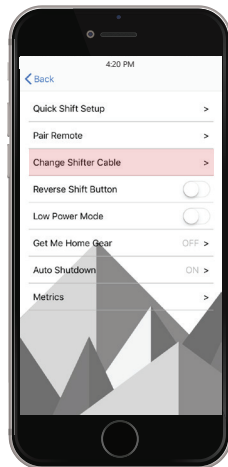

3. P-Straps

- Insert the flat end of each P-strap into the front slot-holes and pull snug.
- Place the provided aluminum clamps in the mounting bosses on the top of the shifter.
- Loosely thread screws through the mounting bosses and into the aluminum clamps.

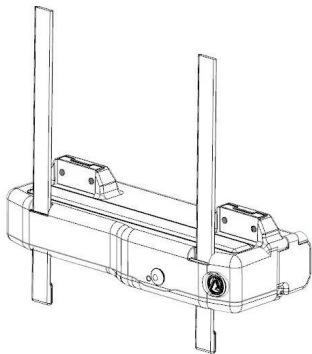

Step 4: Mount the Shifter

1. Bike Preparation

- If removing the rear wheel will make installation easier, do so.
- Disconnect the old shift cable, housing and ferrule from the rear derailleur.
- Remove the cable, housing, and old shifter pod from your handlebar.

2. Install

- Thread the provided shift cable through the derailleur path but DO NOT TIGHTEN the shift cable on the derailleur at this point. Take care to seat the end of the ferrule/bowden housing into the derailleur.
- Place the shifter on the bottom of the chainstay.

- Pull the p-straps over the chainstay and through the slot on the mounting boss.
- Push the shifter up against the chainstay while pulling the p-straps tight and tightening the clamp screws from behind.

It can help to put a temporary zip tie in place to hold the shifter against the chainstay while you tighten the p-straps.

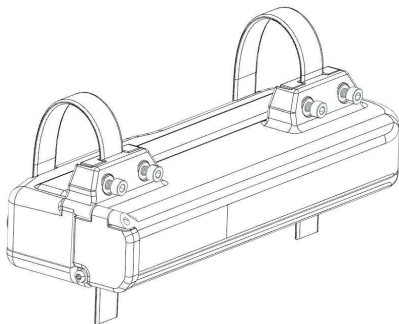

3. Configure

- Turn on the shifter by pressing the power button for 1 second. You should feel the power button click when pressed AND released. If you don't feel the click, give the button a little tug.
- Red light on the shifter will flash indicating that the shifter is available to pair.
- Open the Archer app and find the device labeled either Archer_D1x or D1x_#####. Pair with the device if prompted.
- Press *New Configuration* and proceed through the prompts on the app.

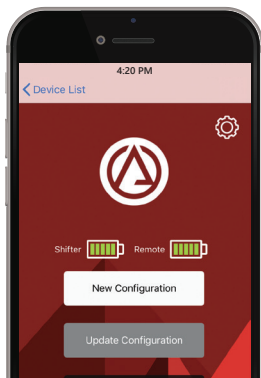

Step 5: Remote Installation

1. Battery

- Remove the two screws from the battery door cover using a 1.5mm hex driver.
- Insert the 10440 li-ion battery.
- Check that the 37x1.5mm o-ring is properly seated around the battery door.
- Close the door and tighten the screws.

2. Remote Installation

- Mount the remote to your own MatchMaker compatible parts or using the clamp provided, ensuring it is in the optimal position and is tightened securely.

Step 6: Remote/Shifter Programming

This process is only required once. The shifter will learn the unique ID of the remote and only respond to that remote during normal operation. Once the shifter is programmed, the following steps will not need to be performed again unless you get a new remote.

- Make sure the shifter and remote are powered off.
- Power on the shifter and pair with the mobile app.
- Go to "Settings > Pair Remote", tap Proceed. Shifter will turn off automatically.
- Close the app.
- Turn shifter back on. An orange LED will flash indicating Remote Learn Mode.
- Turn on the remote. LED will flash green 2 times, then orange. Once the orange light has stopped flashing the remote has been uniquely paired to the shifter.

Shifter Modes of Operation

Battery Check

When the shifter powers on the battery level is displayed by the LED.

When the shifter is in Run Mode, a quick press of the power button will display battery level.

Solid Green = 50%—100%
Flashing Green = 30%—50%
Solid Red = 15%—30%
Flashing Red = <15%

Run Mode Features

Normal:

- A **green** flashing LED.
- Auto-shutdown timer enabled.
- Get me home gear enabled.

Low Power Mode:

- LED connection and battery indicators shown for 10 seconds after powering on, power button press, or shift command received. Otherwise, LEDs are shut off.
- Auto-shutdown timer deactivated.
- Get me home gear deactivated.

Micro-Adjust Mode:

- While in Run Mode press and hold the shifter power button for 3 seconds.
- The **orange** LED will flash.
- Shift up and shift down buttons on the remote will micro adjust the current gear set point.
- Press the power button quickly to exit Micro-Adjust mode and return to Run Mode indicated by the green LED flash.

Search Mode

- When the shifter is not connected to a device (app or remote) the LED will flash **red**. The shifter is waiting for a device to connect to.

Learn Mode

- LED flashes **orange**.
- Shifter is in Learn Mode when "Pair Remote" is pressed in the app.
While in Learn Mode, the shifter is searching for an available device to connect with. Once connected the shifter will record the UUID in memory and only pair with this device.