

USER MANUAL

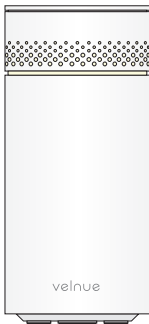

WELLSPRING DIFFUSER

Cordless Essential Oil Diffuser

IMPORTANT NOTE

The lid must be aligned properly for the diffuser to turn on. You'll feel it click in when it is twisted on correctly.

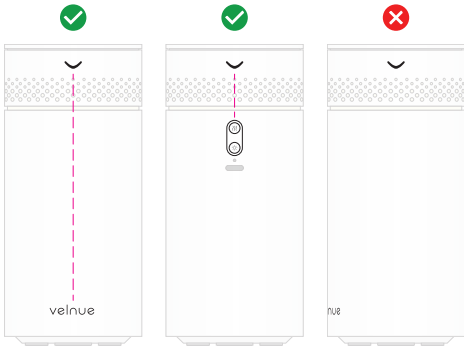
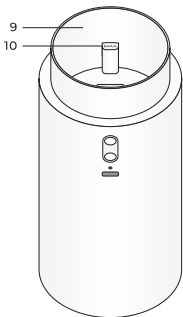
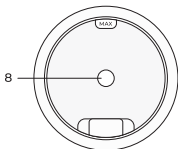
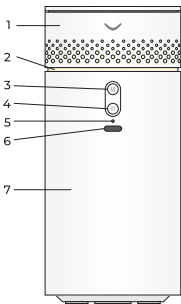

DIAGRAM of PARTS

1. Lid
2. LED light
3. Mist button
4. LED light button
5. Indicator light
6. USB-C charging port
7. Base
8. Ultrasonic disc
9. Water tank
10. Max fill mark



SPECIFICATIONS

Product Name	Wellspring Diffuser v1.0
Dimensions	7.1 x 7.1 x 15.6cm (2.8 x 2.8 x 6.1")
Weight	370g (0.8lbs)
Voltage	DC 5V/2A
Power	10 W
Ultrasonic Rate	3.0 MHz
Rechargeable Battery	4,000 mAh (lithium-ion)
Charging Time	3-4 hrs via USB-C cable
Battery Runtime	3-4 hrs on Continuous Mode 7-8 hrs on Intermittent Mode
Misting Modes	Continuous Intermittent (30s on / 30s off)
Misting Rate	12ml/hr on Continuous 6ml/hr on Intermittent
Tank Size	50ml
LED Light	Turn on /off at any time

CHARGING THE DIFFUSER

Please charge the diffuser before its first use.

Use the USB-C cord along with a USB-A wall adapter (not provided, but you probably have one around your home or office).

The indicator light will turn red when the diffuser is charging, then transition to green when fully charged.

**If the indicator light doesn't turn on at all when plugged in, then something is wrong. Visit the troubleshooting section to learn more.*



CHARGING

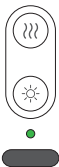

CHARGING
COMPLETE



USB-A WALL ADAPTER EXAMPLE
(not included)

OPERATING THE DIFFUSER

Twist off the lid.

Add 50ml of room temperature water to the tank, making sure the water level is below the "MAX" mark.

Add 10-20 drops of essential oil, or desired amount.

Twist the lid back on, ensuring the Velvue smile logo is either centered over the "velvue" word mark or centered over the buttons (see "IMPORTANT NOTE" at start of manual for more information).

Long press the Mist Button for 2 seconds to turn on the diffuser. The LED light will turn on and the diffuser will begin running on its default Continuous Mode.

To switch to Intermittent Mode (30s on / 30s off), short press the Mist Button when the diffuser is running.

To turn the diffuser off, short press the Mist Button one more time.

To turn on/off the LED Light, press the Light Button at any time.

The diffuser will automatically turn off when:

1. It runs out of battery
2. It runs out of water
3. The lid is removed

Carefully pour out leftover liquid after each use.

*Note: the diffuser can operate while being plugged in.

CLEANING THE WATER TANK

You should clean the diffuser's water tank weekly, or after 4 uses.

To clean the tank:

1. Carefully pour out any leftover liquid.
2. Wet a soft cloth using luke warm water, then wipe the inside of the tank without touching the ultrasonic disc.
3. Dip a cotton swab into rubbing alcohol, then gently clean the corners of the tank and the ultrasonic disc. Repeat as necessary.
4. Dry the tank with a soft dry cloth. Do not touch the ultrasonic disc.
5. Dry the ultrasonic disc gently using an unused cotton swab.

CAUTIONS

1. Keep the diffuser upright when liquid inside. Do not tilt or invert.
2. Do not operate the diffuser:
 - a. if it is filled above the MAX fill mark.
 - b. if it is damaged, broken, or making irregular noises.
 - c. if the cord is damaged or broken.
 - d. within 10cm of walls, furniture and clothes.
 - e. on any surface that impedes air from reaching the bottom.
 - f. on an uneven surface.
 - g. without water.
3. Keep out of reach of children and pets.
4. If the diffuser accidentally gets knocked over while liquid is inside the tank, immediately turn off the diffuser, remove the lid, carefully pour out any liquid, and let the diffuser dry out for at least 3 days before turning on again.
5. Do not disassemble the diffuser. If the product needs repair, please reach out to Velvue customer support at velvue.com.
6. Do not fill the water tank directly from the tap. Always fill the diffuser with an easy-to-pour cup.
7. Avoid viscous essential oils, as they can damage the diffuser.
8. We suggest using only Velvue essential oils with this diffuser, as other "essential oils" often contain fragrance oils, fillers, synthetics, and other foreign ingredients that may damage the diffuser.
9. Do not leave the diffuser plugged in for over 24 hours.

TROUBLESHOOTING (page 1)

The diffuser won't charge

1. Make sure the USB cord is plugged all the way in.
2. Try a different adapter (the part that plugs into the wall) as the one you're using may not be compatible with the diffuser.
3. Try plugging into a different outlet.

The diffuser won't turn on

1. The battery may be dead. If the battery is dead, the tiny indicator light will flash red 3 times when you try to turn the diffuser on.
2. There may not be enough water in the tank. The main LED light should flash twice to indicate a low water level.
3. The lid may not be twisted on properly. Make sure the Velvue smile logo is either centered directly over the "velvue" word mark or centered directly over the operating buttons. You'll feel and hear the lid click in when screwed on properly.

TROUBLESHOOTING (page 2)

The mist is weak

1. There may be too little or too much liquid in the tank.
2. The diffuser may need cleaning, in particular the ultrasonic disc. Visit the "Cleaning The Water Tank" section to learn how to clean the diffuser.
3. It might be the weather or climate. Low humidity conditions evaporate the mist much quicker, making it appear as though not much diffusing is happening.

The aroma is weak

1. Some essential oils have a weaker aroma. Try adding more drops.
2. Too large of a space can cause the aroma to spread out too much. Add more drops of oil when trying to fill a larger area.

If these tips don't resolve your problem, or if you have any other issues with your diffuser, please contact us through our website at venue.com and we'll find a solution for you.

LIMITED 1 YEAR WARRANTY

If your diffuser stops working within one year of purchase, you'll be able to send it back to Velvue for repair, replacement or a velvue.com gift card of equal value.

Rules and Limitations:

1. The diffuser must have been purchased within the last 12 months and before Dec 31, 2024. Proof of purchase must be provided.
2. Postage for sending the product back to Velvue must be paid by the customer. Postage for sending a replacement product back to the customer will be paid for by Velvue. Some limitations may apply.
3. The customer must have cleaned the diffuser's water tank on a regular basis according to the instructions in this manual.
4. There must not be any water damage within the unit, as this can occur when the unit is tipped over, or with incorrect use.
5. The customer must have only used Velvue essential oils with the diffuser.
6. There must not be any extensive physical damage to the diffuser.
7. Any decision on a warranty claim is at the sole discretion of Velvue Design Corp.
8. To begin a claim, contact us through our website at velvue.com.



We also make
100% Certified Organic Essential Oil blends.

Check them out at velnue.com

Distributed and imported by /
Distribué et importé par:

Velnue Design Corp.
Abbotsford, BC Canada V3G 2L6
velnue.com