

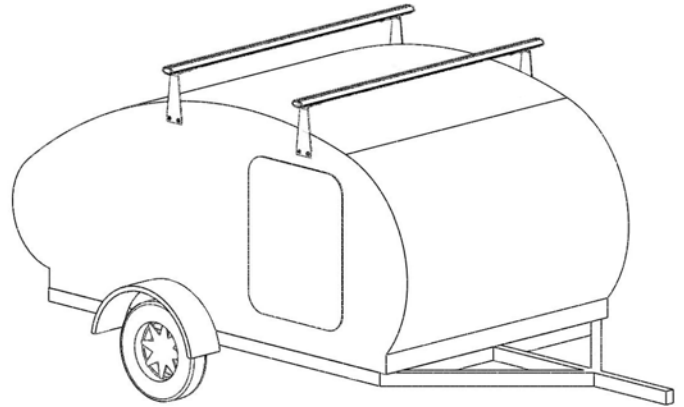

TEAR DROP TRAILER RACK INSTALLATION

Package Contents:

- (2) Load Bars
- (4) Uprights
- (1) Hardware kit containing:
 - (8) 5/16" Fender washers
 - (8) Spacers
 - (4) Backing plates
 - (8) 1/4-20 x 1-1/2" Button head screws
 - (8) 1/4-20 x 3/4" Button head screws
 - (16) 1/4" Split lock washers
 - (16) 1/4" Flat washers
 - (8) Flanged steel washers
 - (8) Plastic over caps
 - (8) 1/4-20 nut with integral washers
 - (4) Load bar end caps
 - (4) 1/4-20 x 9/16" narrow shoulder screws
 - (1) 5/32" Hex key



Before you begin:

Remove all components from the shipping carton.

Read the instructions thoroughly to familiarize yourself with the assembly sequence.

Gather the following tools used to assemble and install the rack:

- 1/4" drill bit
- 1/2" drill bit
- Drill
- Pencil or marker
- Center punch and hammer (optional)
- Level
- Tape measure
- Two boards (1" minimum thickness, 4' long)
- 7/16" socket or wrench

1. Place the trailer on a flat level surface.

Using a level, adjust the trailer so the frame is level to the ground front to back and across the width.

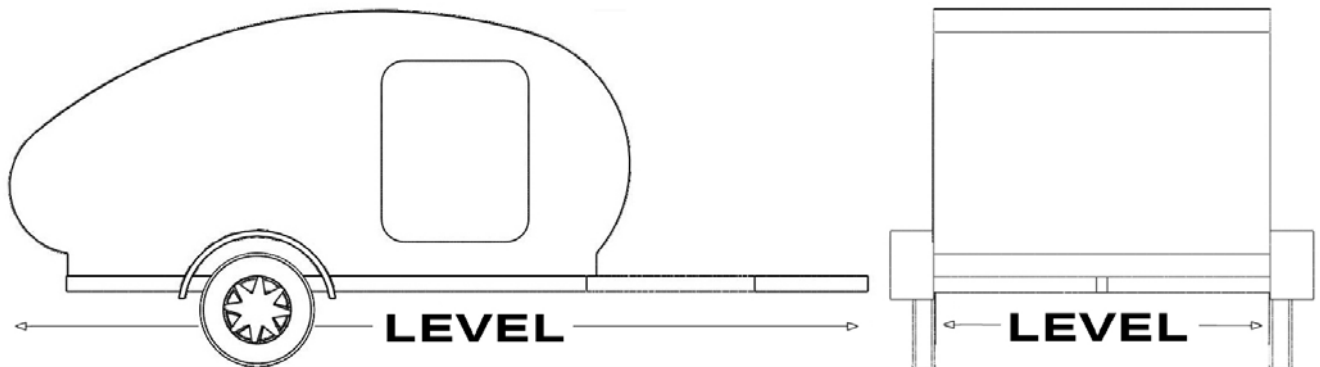

2. Assemble the uprights as shown below. Loosely tighten the 1/4"-20 x 3/4" button head screws so the backing plate is held in place, allowing for movement between the upright and backing plate.

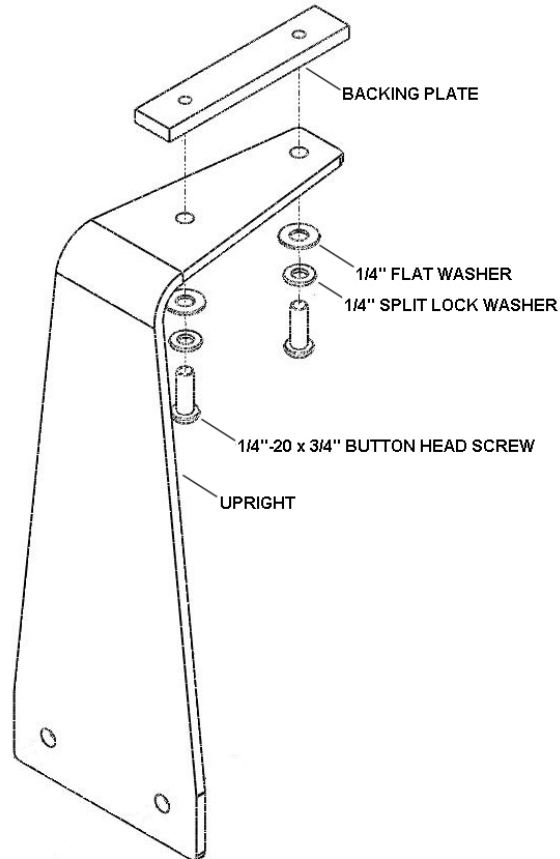

3. Assemble the uprights to the load bars by lifting up on the two 1/4"-20 x 3/4" button head screws so the backing plate is lifted from the upright. Slide the upright so the backing plate slides into the lower channel of the crossbar.

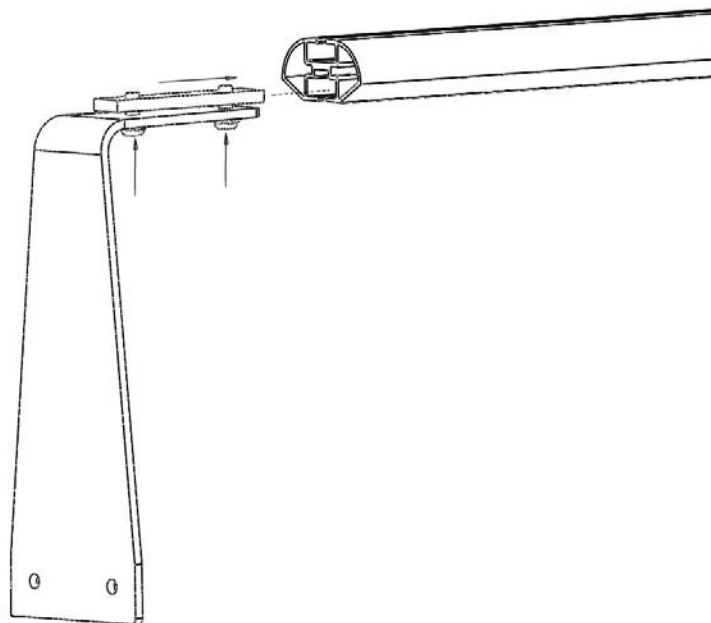

- Repeat upright to load bar assembly for other side of load bar, noting the orientation of the upright faces into the center of the load bar. Repeat for other load bar.

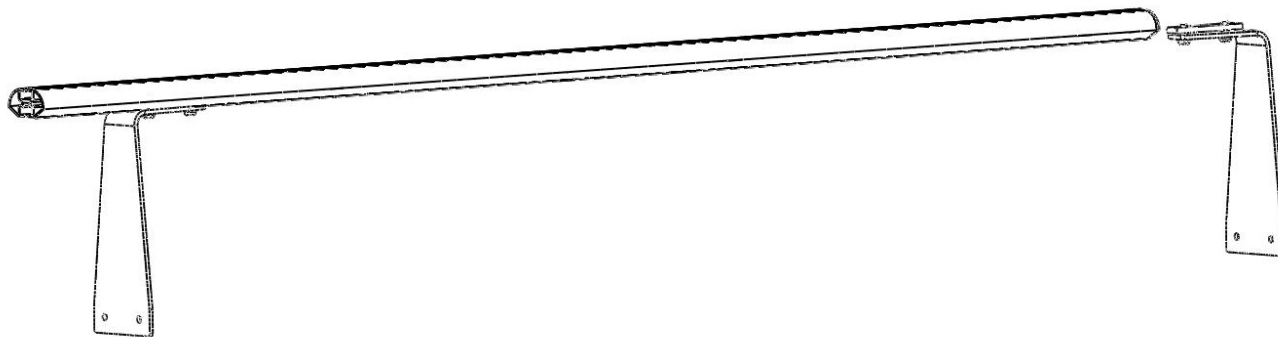

- Position the assembled load bars with uprights on top of the trailer with a minimum 1" inch gap between the crown of the roof and the bottom of the load bar (a pair 1" or thicker boards placed across the top of the trailer works best.)

Check to make sure the load bars are level front to back and side to side.

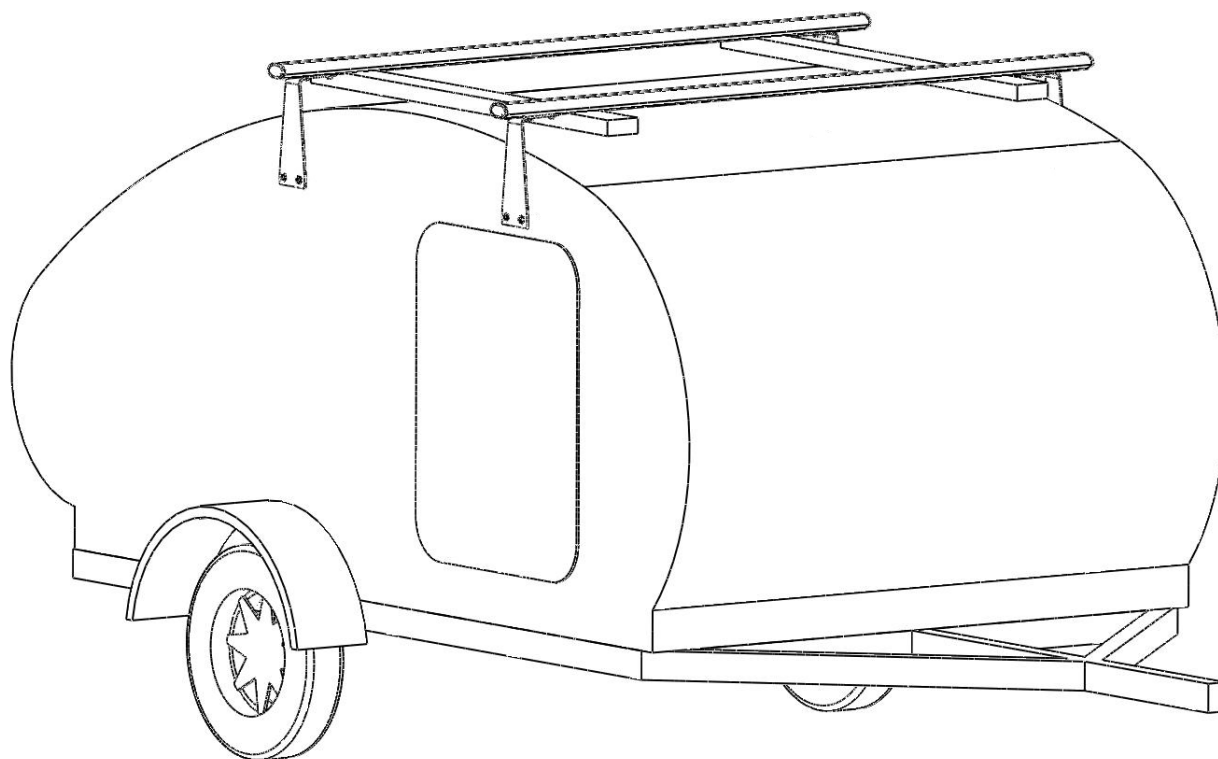

Recommended spacing between the centers of the load bars is 34.5 inches apart. If carrying larger items such as a kayak, space the load bars as far apart as possible for increased stability. However, if the load bars are spaced too far apart, bike carriers and cargo baskets might not be able to be mounted to the load bars.

- Center the load bars side to side over the trailer. Slide the uprights on the load bars so that they are against the outer shell of the trailer and lightly tighten the 3/4" button head screws.
- Examine the inside of the trailer where the uprights would mount to the side walls for obstructions on both sides. Adjust location of load bars as needed.**

8. Make sure the load bars are parallel to the front of the trailer and not skewed by measuring from a reference line on the front of the trailer. Both load bars ends should be equally spaced from the reference point.

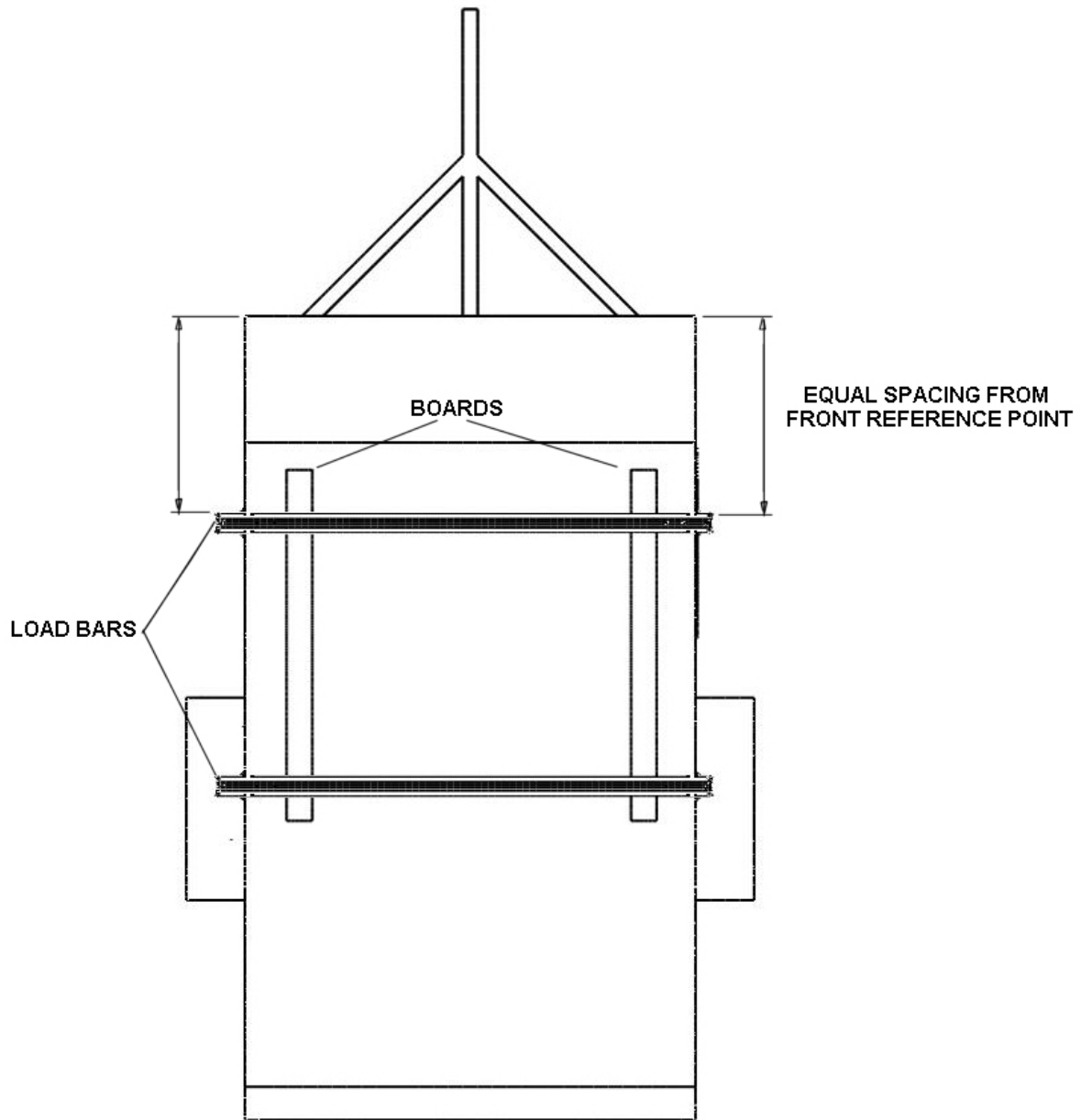

The rear load bars should be parallel to the front load bars, measure the spacing between the bars on the ends. Adjust as needed.

9. With the load bars in position and level side to side and front to back, lightly mark the bottom edges and sides of the uprights with a pencil.

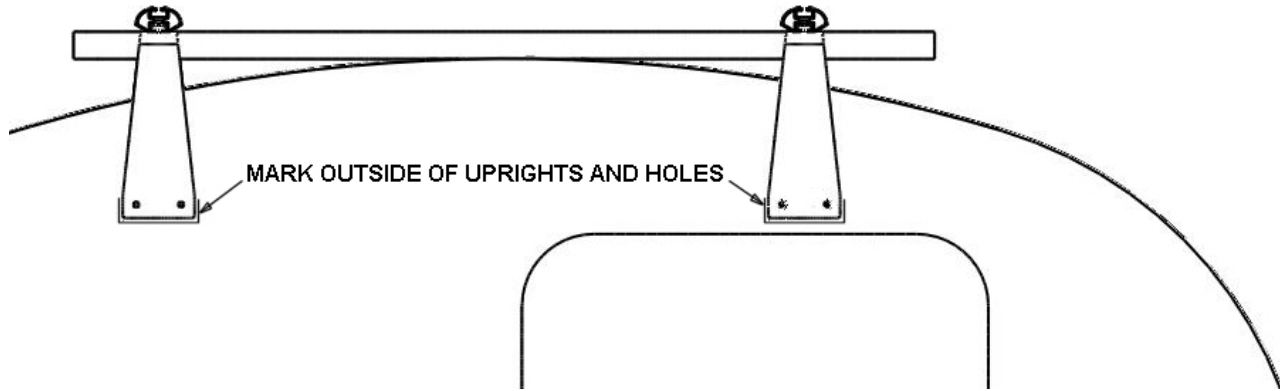

10. Examine each upright before drilling to see if it has moved from the marked pencil outline. Adjust if needed back to the markings. Use a center punch and hammer to mark the center of the holes (optional). Drill 1/4" dia holes straight through the lower holes of the uprights and straight through the trailer wall. Repeat this step for remaining uprights.

Note: As you drill through the trailer walls, carpet on the inside walls may get caught in the drill bit and start to pull. You may need to cut an "X" large enough for a 1/2" diameter drill bit to clear. Fold back the corners of the "X" to prevent the drill bit from pulling carpet into the drill bit.

11. After all holes have been drilled with 1/4" holes, move the uprights aside and drill 1/2" dia hole through the trailer wall. Erase the pencil marked lines on the outside walls of the trailer. Fold back and carpet so it lays flat against the inside trailer walls.

12. Insert the 1/2" diameter spacers into the trailer walls. They are used to spread the weight load into the trailer walls and may not necessary be the same thickness as the trailer walls.

Note: For added weather resistance, seal the outside edge of the spacers / trailer wall with silicone sealant (not included).

13. Move the uprights with load bars back in place. Assemble the upright to the trailer as shown below (trailer wall not shown for clarity):

Note: After all uprights have been loosely placed on the trailer, tighten the 1/4"-20 x 1-1/2" button head bolt using the hex key wrench. A 7/16" socket or wrench may be needed if the integral washer does not prevent the 1/4"-20 nut from rotating.

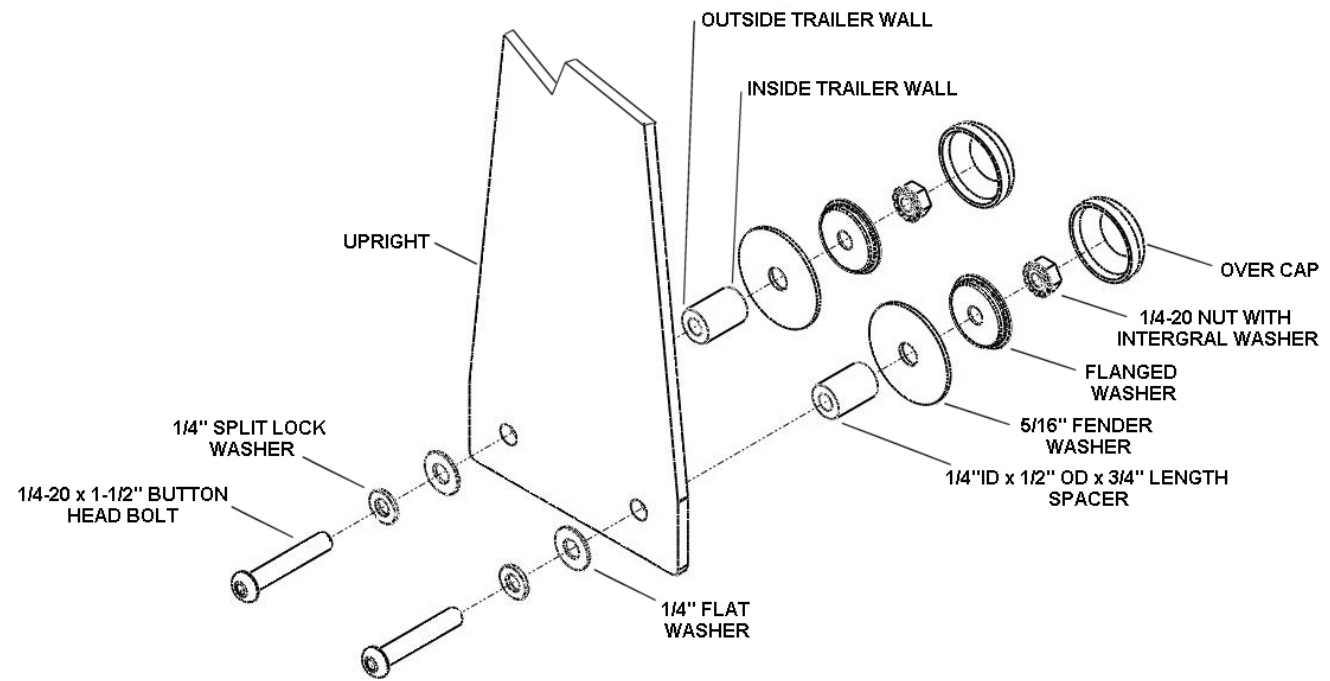

14. Assemble the end caps by screwing the ¼"-20 x 9/16" narrow shoulder screw into the end cap as shown. Repeat for remaining end caps.

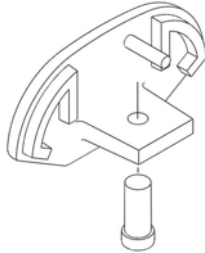

15. Slide an end cap into the end of the load bar.

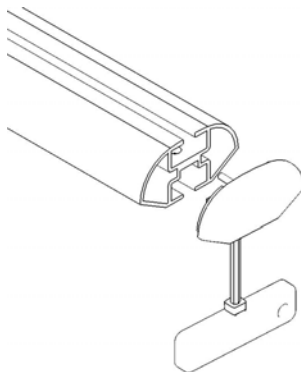

16. Tighten the ¼-20 x 9/16" narrow shoulder screw in the end cap using the hex key so that it goes through hole located on the end of the load bar. DO NOT OVER TIGHTEN SCREW.

17. Repeat steps 15 to 16 for other end of load bar.

18. Center the load bar over the trailer.

19. Using the hex key wrench, tighten the upper screws of the upright to secure the crossbar. Keep the hex key in a convenient location (such as glove box) for making future adjustments

PRO RAC GUIDELINES

Please review the instructions and warranty carefully. Assembly and installation are the purchaser's responsibility and beyond ProRac's control. Therefore, ProRac exclusively limits its warranty to the repair or replacement of a defective ProRac product for up to three years from retail purchase. Warranty excludes damage to your vehicle, cargo, or any person or property during assembly, installation, and use.

- ◆ Do not carry more than **300 pounds (68KG) of combined cargo and accessories** on ProRac load bars. ProRac load bars and rails do not increase the bed rail strength. ProRac cannot warranty loads that exceed this limit.
- ◆ Do not use ProRac load bars and accessories for purposes other than those for which they were designed. Do not exceed their carrying capacity. Failure to follow these guidelines or the product instructions will void the warranty.
- ◆ Make sure all knobs, bolts, screws, straps, and locks are firmly attached, tightened, and locked before every trip. All fasteners must be periodically inspected for signs of wear, corrosion, and fatigue. Check your load at stops during long trips to ensure continued fastening security.
- ◆ Check all local and state laws governing projection of objects beyond the width and length of vehicle. Be aware of the width and height of your cargo since low-clearance branches, bridges, and parking garages can affect the load. Never drive with any lock, knob, or rack in an open or unlocked position. All long loads such as, but not limited to, sailboards, surfboards, kayaks, canoes, and lumber must be tied down front and rear to the bumpers or tow hooks of the vehicle.
- ◆ Remove your rack and accessories when they are not in use and before entering automatic car washes.
- ◆ All locks must be turned and moved periodically to ensure smooth operation. Use graphite or similar dry lubricant. Locks are designed to deter vandalism and theft. Remove valuable gear if your vehicle is unattended. Replacement keys are available only through your ProRac dealer.
- ◆ All cargo will affect the vehicle's driving behavior. For your safety, adapt your speed to the conditions of the road and load being carried. Obey all posted speed limits and traffic cautions.
- ◆ Due to their wind resistance, do not carry disks or wheels with covers on the ProRac bike carrier.
- ◆ Consult your ProRac dealer if you have questions regarding the operation and limits of ProRac products. Review all instructions and warranty information carefully.

© 2008 ProRac Systems, Inc.

LG100-IS
Revised 07-18-08