

# PVT4 SERIES QUICK COUPLINGS

Flat Face Screw Type - Connectable Under Pressure  
 Sizes: 1/4" thru 2"

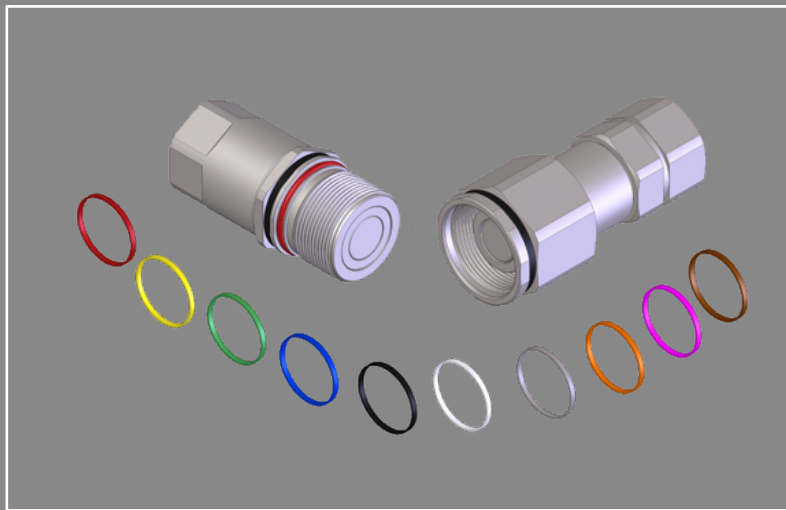
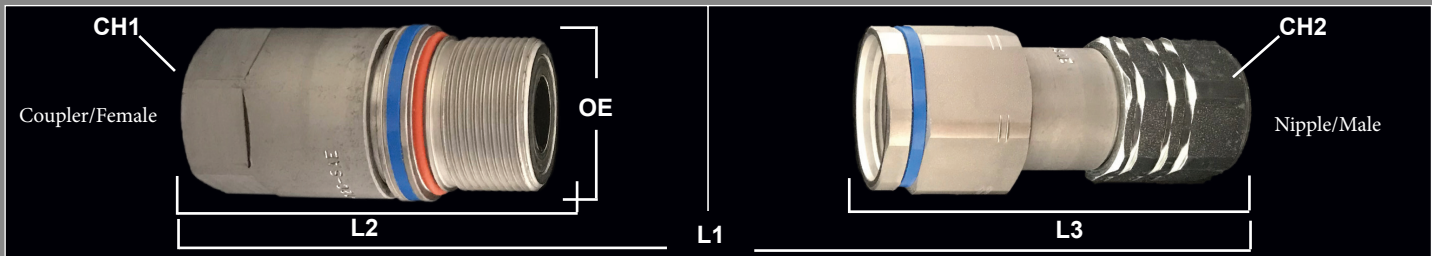

## Features and Benefits

- A non-interchangeable upgrade to the FSI Series
- High tech Z-786 anti-corrosion plating salt spray tested for 700 hours before any appearance of surface red rust
- Slimmer design than FSI
- High working pressures
- Seal is blowout resistant to 5,000 PSI when connecting or disconnecting with residual pressure
- Can connect by hand up to 5,000 PSI
- Exceeds 1,000,000 impulse cycles
- Flat face design eliminates spillage upon disconnection
- Thread to connect style coupling eliminates brinelling issues
- Heavy duty hex nut
- Fine threads for smooth makeup
- Standard Threads: NPT, SAE & BSP

## DIMENSIONAL & PRESSURE RATING DATA

| Body Size | CH1  | CH2  | OE    | L1    | L2   | L3   | Optimal Flow Rate (GPM) | Max Flow Rate (GPM) | Max Working (PSI) | Fluid Spillage (cc) |
|-----------|------|------|-------|-------|------|------|-------------------------|---------------------|-------------------|---------------------|
| 04        | .86  | .86  | 1.29  | 4.53  | 2.66 | 2.30 | 3.17                    | 6.34                | 5,800             | .008                |
| 06        | 1.18 | 1.18 | 1.417 | 5.33  | 3.07 | 2.90 | 6.08                    | 12.15               | 5,075             | .010                |
| 08        | 1.42 | 1.42 | 1.65  | 6.14  | 3.39 | 3.43 | 12                      | 24                  | 5,075             | .012                |
| 12        | 1.42 | 1.42 | 1.65  | 6.19  | 3.52 | 3.39 | 20                      | 40                  | 5,075             | .015                |
| 16        | 1.62 | 1.62 | 1.89  | 7.09  | 4.13 | 3.82 | 26.5                    | 53                  | 5,075             | .020                |
| 20        | 2.16 | 2.16 | 2.36  | 8.47  | 5.03 | 4.30 | 50                      | 74                  | 5,075             | .030                |
| 22        | 2.16 | 2.75 | 2.85  | 8.44  | 4.41 | 5.36 | 70                      | 120                 | 5,075             | .040                |
| 24        | 2.75 | 2.75 | 4.13  | 9.60  | 6.05 | 4.67 | 100                     | 185                 | 4,350             | .050                |
| 32        | 3.15 | 3.15 | 4.56  | 11.44 | 6.81 | 7.75 | 200                     | 265                 | 4,350             | .100                |

## Applications

- Used in a wide range of industrial markets where connecting and disconnecting of hydraulic circuits is needed
- High pressure, low pressure drop and high impulse applications
- Drilling Rigs, Cranes, HPU'S, Heavy Equipment, Hammer attachments and much more

## Key Note:

- Color Safe System options available



units: inches

## ORDERING INFORMATION

QUICK COUPLING PART NUMBERING SYSTEM:

PVT4-CC - 08 - 08 - C - NPT

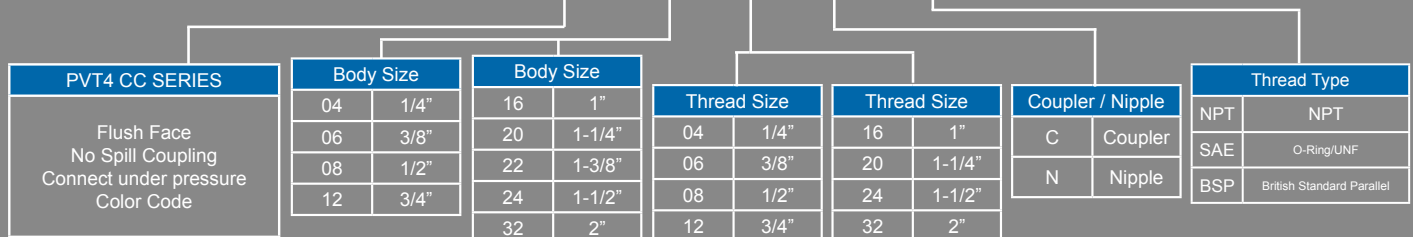



## Features and Benefits

- Easy to use and implement and easy to see at a distance
- Implements the poka-yoke by establishing a mistake-proofing system
- High Tech Z-786 Anti-Corrosion plating salt spray tested for 700 hrs before any appearance of surface red rust
- Connects and disconnects by hand up to 4,400 PSI
- Seal blowout resistant to 4,400 PSI when connecting or disconnecting with residual pressure
- Exceeds 1,000,000 impulse cycles
- Flat face design eliminates spillage upon disconnection
- Thread to connect style coupling eliminates brinelling issues
- Standard Threads: NPT, SAE, BSPP, DIN, Code 62

## Applications

- FSI series couplings are used in a wide range of industrial markets when connecting and disconnecting is needed
- High pressure, low pressure drop and high impulse applications
- Drilling rigs, oilfield services, drilling equipment, cranes, heavy equipment, hammer attachments and much more

Notes: Aluminum caps and plugs play a crucial role in extending the life of the coupling set.

**Key Note: Color Bands offered in 10 different colors**

### QUICK COUPLING PART NUMBERING SYSTEM:

**FSI-CC - 08 - 08 - C - NPT**

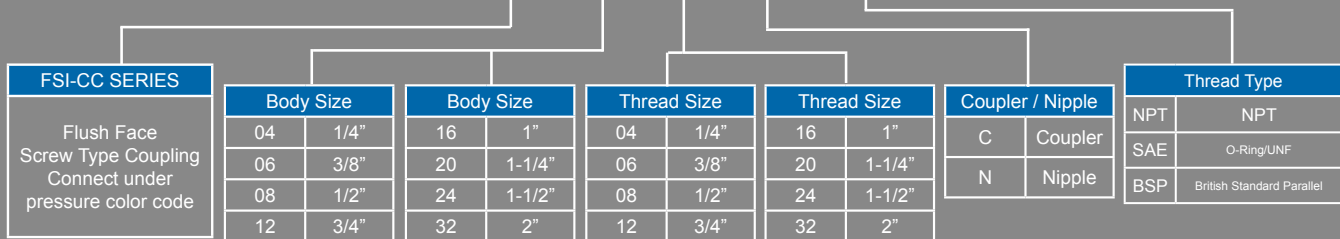

**FSI - CB - 04 - Blk**

