

THERMOSTATIC SHOWER MANUAL

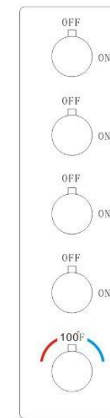
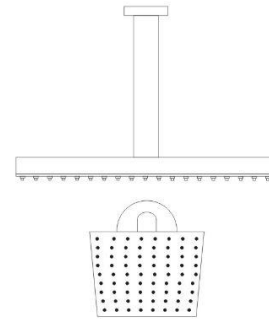

Installation Step

Multi-function Thermostatic Concealed Shower

INSTALLATION Tools You Will Need :

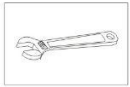

Adjustable wrench



Hexagon wrench

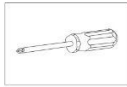

Phillips Screwdriver



Pipe Tape



Glue

Notes before installation :

1. Please check that all components are available.
2. Before installation ensure that all feed lines are clear of debris and on/off valve is available.
3. Ensure water pressure is between 20-125 PSI (includes combination of hot and cold feed lines).
4. Pictures in the manual are general in content and may not represent exactly your purchased faucet. If you are having difficulties please contact a professional plumber.
5. If you will be away from home for an extended period you should shut off the main water supply.

Daily maintenance

1. Use a soft cloth and vinegar to remove hard-water spots.
2. Check aerator (if present) regularly for calcium build up are when water stream is not optimum.
3. DO NOT use caustic cleaning products as the use will break down finish and will void the product warranty.
4. Acceptable cleaners include vinegar or mild non-abrasive liquid detergents.
5. If the water pressure appears to be less than optimum remove, inspect, clean or replace aerator

You need to purchase this accessory to install

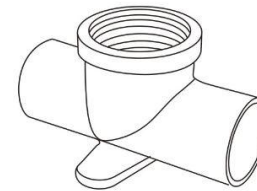
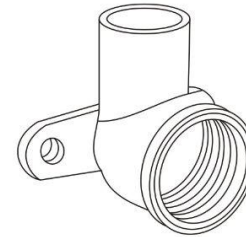

1/2 inch inlets 3-way thermostatic shower faucet

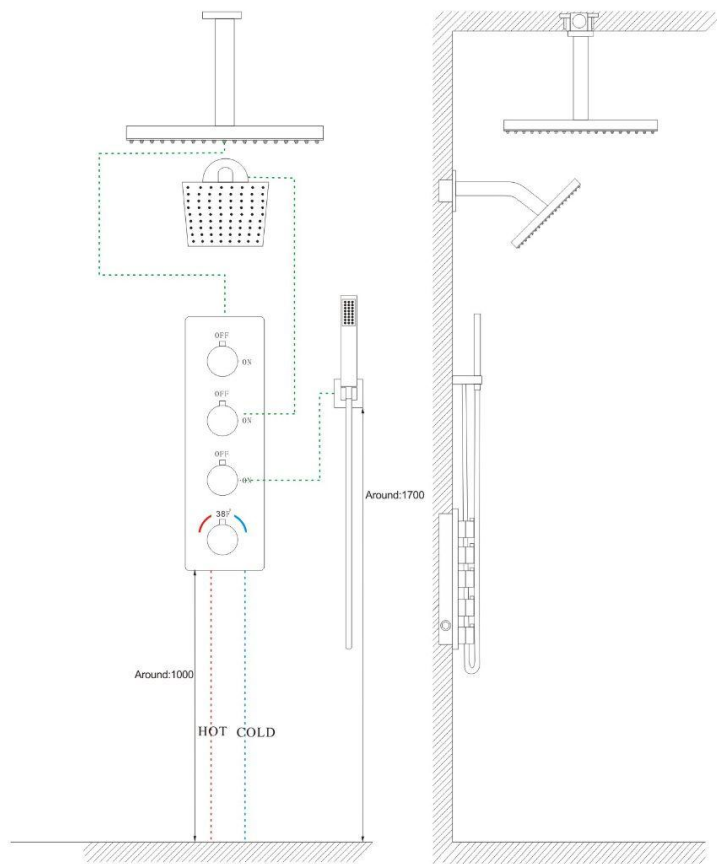

3

3/4 inch inlets 4-way thermostatic shower faucet

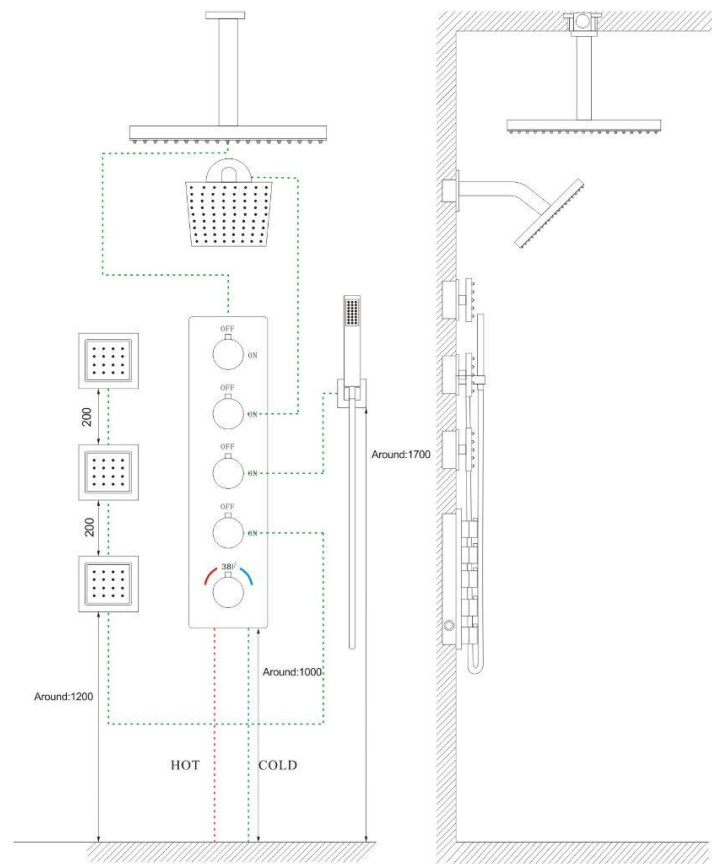

4

Product List

Please check the accessories with following table, if there is anything missing, please contact customer service immediately.

1/2 inch inlets 3-way thermostatic shower faucet

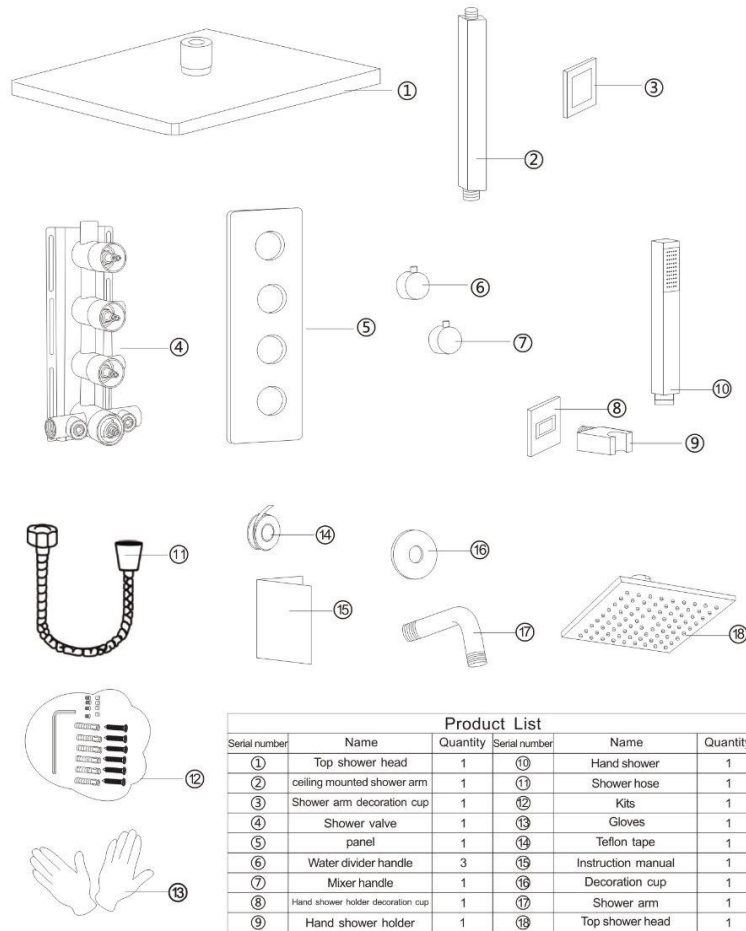

Product List					
Serial number	Name	Quantity	Serial number	Name	Quantity
①	Top shower head	1	⑩	Hand shower	1
②	ceiling mounted shower arm	1	⑪	Shower hose	1
③	Shower arm decoration cup	1	⑫	Kits	1
④	Shower valve	1	⑬	Gloves	1
⑤	panel	1	⑭	Teflon tape	1
⑥	Water divider handle	3	⑮	Instruction manual	1
⑦	Mixer handle	1	⑯	Decoration cup	1
⑧	Hand shower holder decoration cup	1	⑰	Shower arm	1
⑨	Hand shower holder	1	⑱	Top shower head	1

Product List

Please check the accessories with following table, if there is anything missing, please contact customer service immediately.

3/4 inch inlets 4-way thermostatic shower faucet

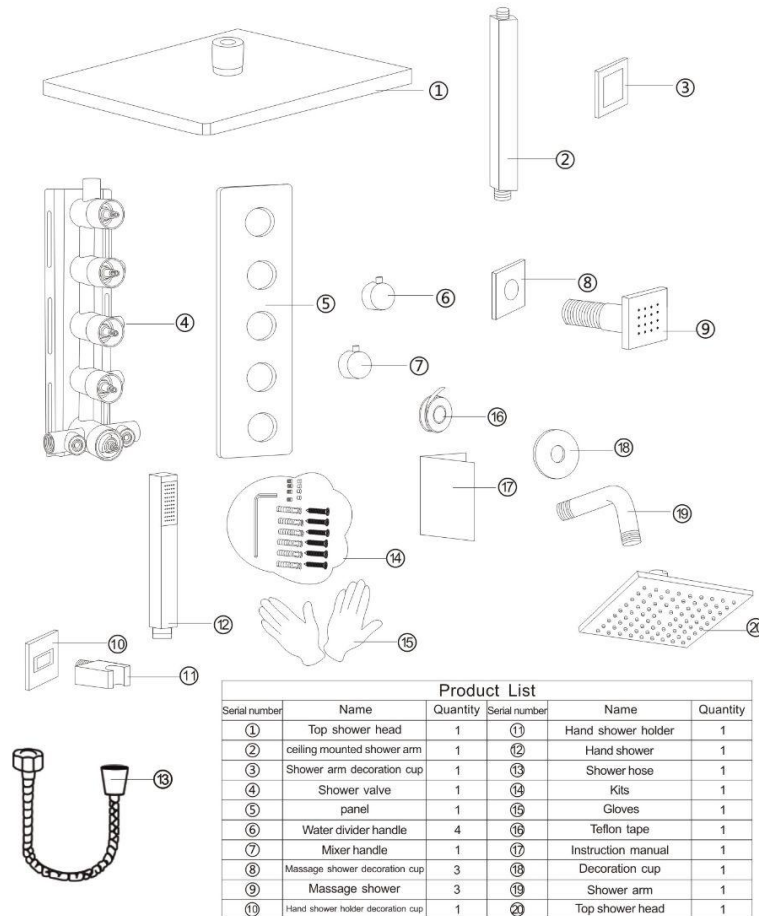

Product List					
Serial number	Name	Quantity	Serial number	Name	Quantity
①	Top shower head	1	⑪	Hand shower holder	1
②	ceiling mounted shower arm	1	⑫	Hand shower	1
③	Shower arm decoration cup	1	⑬	Shower hose	1
④	Shower valve	1	⑭	Kits	1
⑤	panel	1	⑮	Gloves	1
⑥	Water divider handle	4	⑯	Teflon tape	1
⑦	Mixer handle	1	⑰	Instruction manual	1
⑧	Massage shower decoration cup	3	⑱	Decoration cup	1
⑨	Massage shower	3	⑲	Shower arm	1
⑩	Hand shower holder decoration cup	1	⑳	Top shower head	1

◆ Installation step —1/2 inch inlets 3-way thermostatic shower faucet

<p>Height of valve body</p>		
<p>1. Confirm the installed place of the pressure balance valve and fixed on the wood block .</p>	<p>2. Connect the hot&cold inlet tube and outlet tube,then make sure the tube fix stable on the wooden wall.</p>	<p>3. Please cut the size of the tile hole according to the size and shape of the protected cover (about 5mm bigger than the protected cover from each side).And please put the tile outside the wooden wall (please noted that we keep the same central point for the tile hole with the protected cover).</p>
		<p>Length of thread</p>
<p>4. Install the water proof cover to the N-box with glue,fix the steel plate, then install the handle levers.</p>	<p>5. Put on the handle,then tight the screw.</p>	<p>6. Wrap the teflon tape on the thread Step .Clockwise rotation of the wall arm to the pipe, the rain shower head connects to the arm.</p>

◆ Install the massage shower

Step 1

Step 2

Step 3

NPT1/2

G1/2

Step 1. Wrap the tooth tube NPT1/2 with teflon tape and screw into the wall
Step 2. Cut off excess part with a saw
Step 3. Cover the decoration cup, then screw the massage shower in

◆ Install the rain shower head

Step 1

Step 2

Step 3

Length of thread

13mm

Step 1. Wrap the teflon tape on the thread
Step 2. Clockwise rotation of the ceiling arm to the pipe
Step 3. The rain shower head connects to the arm.

◆ Install the handheld shower head

Step 1

Step 2

Step 3

Step 4

Length of thread

12mm

Step 1. Screw the thread into the water pipe inside the wall.
Step 2. Screw the main body into the thread.
Step 3. Rotate and fix with the alien wrench
Step 4. Connect handle holder with hose and handle shower

◆ Installation step — 3/4 inch inlets 4-way thermostatic shower faucet

<p>Height of valve body</p>		
<p>1. Confirm the installed place of the pressure balance valve and fixed on the wood block .</p>	<p>2. Connect the hot&cold inlet tube and outlet tube,then make sure the tube fix stable on the wooden wall.</p>	<p>3. Please cut the size of the tile hole according to the size and shape of the protected cover (about 5mm bigger than the protected cover from each side).And please put the tile outside the wooden wall (please noted that we keep the same central point for the tile hole with the protected cover).</p>
		<p>Length of thread</p>
<p>4. Install the water proof cover to the N-box with glue,fix the steel plate, then install the handle levers.</p>	<p>5. Put on the handle,then tight the screw.</p>	<p>6. Wrap the teflon tape on the thread Step .Clockwise rotation of the wall arm to the pipe, the rain shower head connects to the arm.</p>

◆ Install the massage shower

Step 1

NPT1/2

G1/2

Step 2

Step 3

Step 1. Wrap the tooth tube NPT1/2 with teflon tape and screw into the wall
Step 2. Cut off excess part with a saw
Step 3. Cover the decoration cup, then screw the massage shower in

◆ Install the rain shower head

Step 1

Step 2

Length of thread

13mm

Step 3

Step 1. Wrap the teflon tape on the thread
Step 2. Clockwise rotation of the ceiling arm to the pipe
Step 3. The rain shower head connects to the arm.

◆ Install the handheld shower head

Step 1

Step 2

Step 3

Step 4

Length of thread

12mm

Step 1. Screw the thread into the water pipe inside the wall.
Step 2. Screw the main body into the thread.
Step 3. Rotate and fix with the alien wrench
Step 4. Connect handle holder with hose and handle shower