



Deep hydration mask with talc

The + Benefit

This peel-off mask is a care adapted for the **very sensitive and dry skins**. It contains talc and a specific alginate form.

The + Product

The composition of this mask gives a very soft paste and leave a smooth and humid film on the skin. Deep hydration mask contains arginine and amino acid naturally contained in the NMF of the skin. The mask provides **a moisturizing care**.

Properties & Ingredients

Argidone®	Argidone® is composed by L-PCA (L-Pyrrolidone Carboxylic Acid*), physiological moisturizing agent, essential component of N.M.F. (Natural Moisturizing Factor) and by arginine, semi-essential amino acid. Arginine is also present in N.M.F. Argidone® is an excellent regenerant and oxygenating for the skin. *L-PCA is obtained by the cyclization of the L-glutamic acid, amino acid from plant origin.
Talc	Well-known for its soft-touch, talc is used to its matifying and absorbent porperties for many thousands of years.

Ritual of Beauty

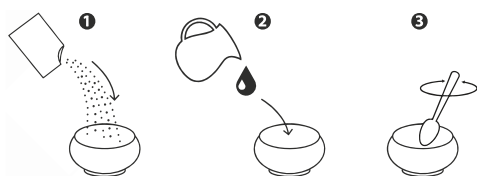

Pour 90ml of water at 20°C on the 30g of powder. Stir quickly and vigorously during one minute to get an homogeneous paste.

Apply immediatly the paste on the face avoiding the eye contour. (The mask sets between 6 and 8 minutes following the application.) Leave the mask on for 15 minutes and then remove it by peeling off in one whole piece.

Durability : 36 months