

Sophie Mirror

by Jean-Francois Merilou

Parts Included

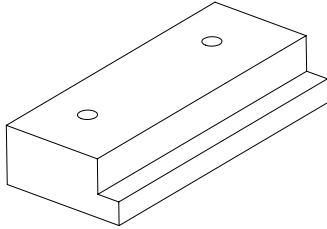

Wood Hanger

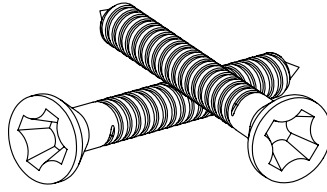

6mm-head Screws

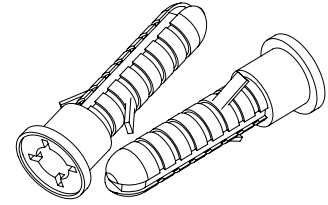

Plastic Wall Plugs / Screw Anchors

1

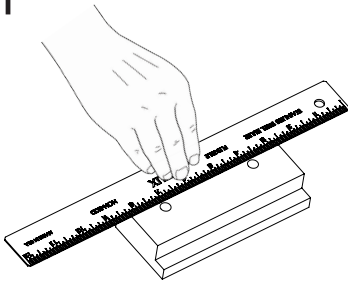

Measure the holes of the Wood Hanger with a ruler.

2

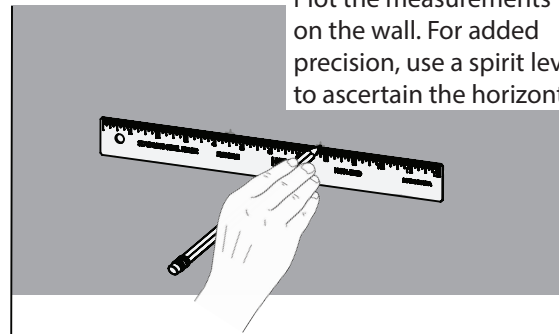

Plot the measurements on the wall. For added precision, use a spirit level to ascertain the horizontal.

3

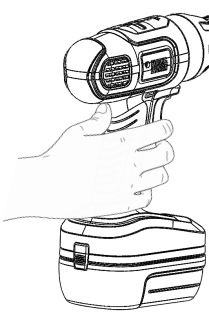

Drill the marked positions on the wall with a 6mm drill bit.

4

Insert the wall plugs into the drilled holes.

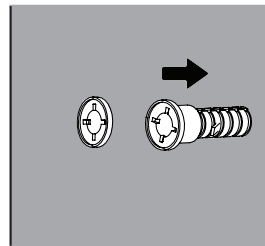

5

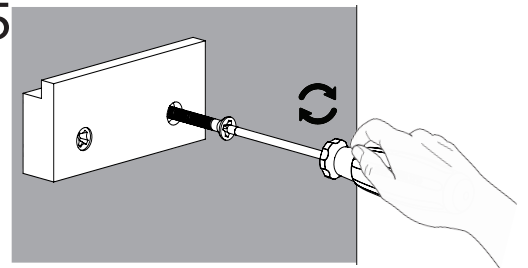

Fasten the wood hanger to the wall with the provided 6mm-head screws. Make sure that the protruding section is facing away from the wall and upwards as shown in this diagram.

6

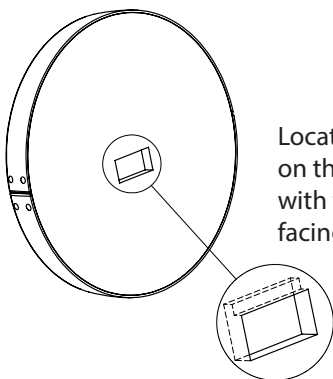

Locate the fitting gap on the back of the mirror with the inner gap facing upwards.

7

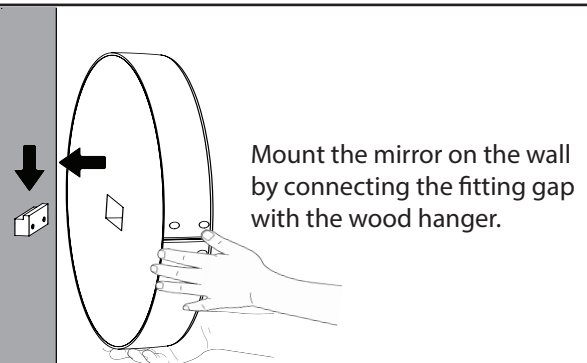

Mount the mirror on the wall by connecting the fitting gap with the wood hanger.

Safety reminder: Wear appropriate noise muffers to protect your ears when using a power drill. Loud noise may cause permanent hearing loss.

Verify that the wall or medium is able to endure the weight of the mirror. Avoid soft or flimsy walls.