

2015-2017 FORD F150 ADAPTER KIT

MODEL #48597

CAREFULLY READ THE FOLLOWING INSTALLATION INFORMATION.

Item no	Description	Included
1	Frame Bracket – Driver Front	1
2	Frame Bracket – Passenger Front	1
3	Carriage Bolt, 5/8" x 6", Grade 5	2
4	Tube Spacer, 4" Long	2
5	Bolt w/ Plate, 5/8" x 2", Grade 8	4
6	Nut, 5/8", Locking, Grade 5	4
7	Conical Washer, 5/8"	4
8	Wire Bolt Leader, 5/8"	4
9	Galvanic Isolator Material	4 Rolls

BASE RAILS AND ALL OTHER HARDWARE SHOWN INCLUDED IN PART #48630

Tools Needed

1/8" Drill Bit	11/16" Drill Bit	3/4" Socket/Wrench
9/16" Drill Bit	1-1/8" Drill Bit	15/16" Socket/Wrench



WARNING

- Do not install mounting rails over plastic bed liners. Plastic liners must be trimmed away to allow base rails to contact bed directly. Spray in bed liners are acceptable.
- These instructions are guidelines only. Actual installation is the responsibility of the installer and the owner.
- Use only supplied hardware for installation.
- Before beginning installation of mounting rails, brackets, and hitch measure to make sure adequate clearance between the truck and trailer exists to allow for turns.

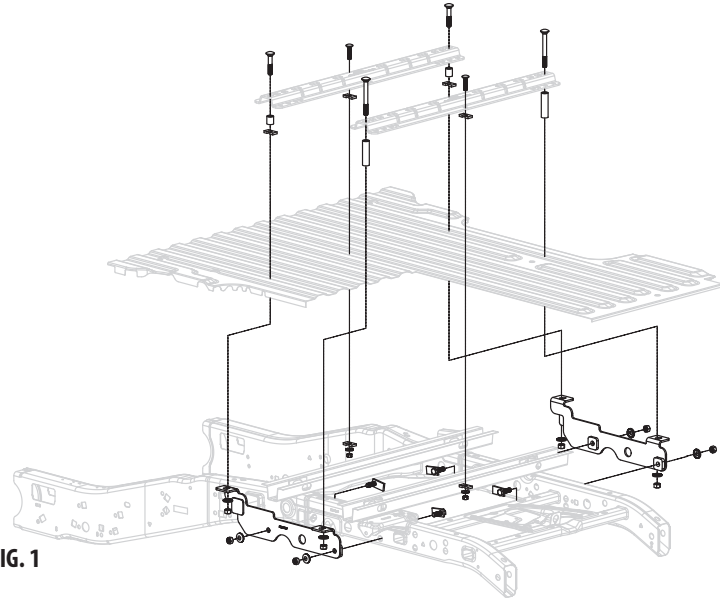

FIG. 1

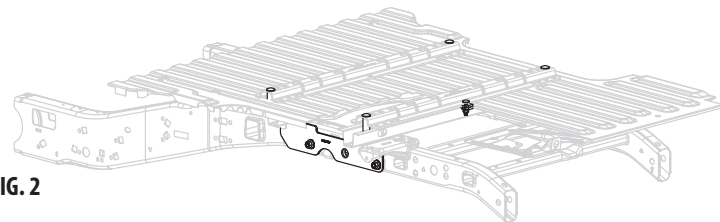

FIG. 2

Installation Instructions

- Lower and remove the spare tire if extra room is required. Remove plastic wheel well liners for access to the frame.
NOTE: This vehicle has an aluminum bed. It is required that all steel components of this install kit be isolated from the aluminum frame. Apply segments of the included isolator material [9] between all steel components and the aluminum bed.
- Temporarily install both frame brackets [1 & 2] to the outside surface of the frame using 5/8" Bolt w/ Plate [5], 5/8" Conical Washer [7], and 5/8" Nuts [6]. Thread the wire leaders [8] onto the 5/8" bolts and fish them through the access hole on the inside of the frame rail and out the existing frame holes shown. Attach the conical washers and hex nut to the bolts on the outside of the frame bracket. Push both brackets forward toward the cab of the truck as far as they will go. This will help ensure the mounting rail is installed perpendicular to the frame. Center punch the bed from underneath through the forward center bed rail mounting slot.
- Place the forward base rail (w/ isolators) in the bed of the truck and align with the center punches. Punch marks should align with the outer most 4-bolt slots. Adjust center punch marks side to side as needed to center base rail in the truck bed. Move the base rail out of the way and drill 1/8" holes through the bed at the center punch locations. From underneath check to make sure the 1/8" holes line up with the frame brackets.

CAMCO MFG., INC.

121 LANDMARK DRIVE / GREENSBORO, NC 27409 / USA

1-800-334-2004

WWW.CAMCO.NET

LIMITED WARRANTY: Camco warrants this product to be free from defects in material and workmanship under normal use and service conditions for 12 months from the date of first purchase. Camco's liability is limited solely to the replacement of any defective product returned to us. To the extent allowable by law, Camco makes no other warranty, either expressed or implied, nor assumes any liability for incidental or consequential damages resulting from the use of this product or for breach of warranty of merchantability or fitness for a particular purpose. Submit warranty claims to Camco Manufacturing, 121 Landmark Drive, Greensboro, NC 27409.

CONTINUED ON PAGE 2

CD895093 1015529R1 #617

CAMCO

2015-2017 FORD F150 ADAPTER KIT

MODEL #48597

4. Remove the frame brackets and enlarge the 1/8" holes to 11/16". Reinstall frame brackets and mount forward base rail using 5/8" carriage bolts, fill shims - small, 5/8" conical washers, and 5/8" nuts (hardware in 48630 bolt pack). Fill shims to be installed in the truck bed corrugation either between frame bracket and truck bed or between base rail and truck bed. Be sure to use galvanic isolator material at this step. Loosely tighten 1/2" bolts at this time.
5. Place the unassembled fifth wheel legs, slider, or gooseneck in the forward base rail. Position the rear base rail by aligning with the fifth wheel legs, slider, or gooseneck. Push the rear base rail toward the forward base rail to ensure a tight fit. If the fifth wheel or gooseneck to be used with the truck is not available set up the rear rail 22" on center from the forward rail. Be sure the rear rail is centered between the bed box sides. Center punch in the outer most 4-bolt mounting slots on each end of the base rail.
6. Check to make sure the center punch in the bed aligns with the rear slot in the frame brackets. Drill 1/8" holes through the bed at the center punch locations.
7. Enlarge 1/8" holes to 1-1/8". This hole is located within the bed riser approximately 3" outside the factory bed bolts. Only enlarge to 1-1/8" through the bed and not all the way through the bed riser. Mount rear base rail using 5/8" x 6" carriage bolts [3], tube spacer [4], 5/8" conical washers [7], and 5/8" nuts [6]. Be sure to use galvanic isolator material at this step on the base rail, tube spacer, and the frame brackets top surface. Loosely tighten 5/8" bolts at this time.
8. Install fifth wheel or gooseneck into base rails to ensure proper fit and spacing. Keep the fifth wheel or gooseneck installed and final torque all bolts.
 - a. 1/2" hardware to 75 ft-lbs [102 N*M]
 - b. 5/8" hardware to 150 ft-lbs [204 N*M]
9. 1/2" carriage bolts are required in the outer most square holes in center of base rails for all installations. Refer to 48630 instructions for specifics.
10. Replace plastic wheel well liners and spare tire removed at beginning.

FIG. 3 - DRIVER SIDE MOUNTING DETAIL

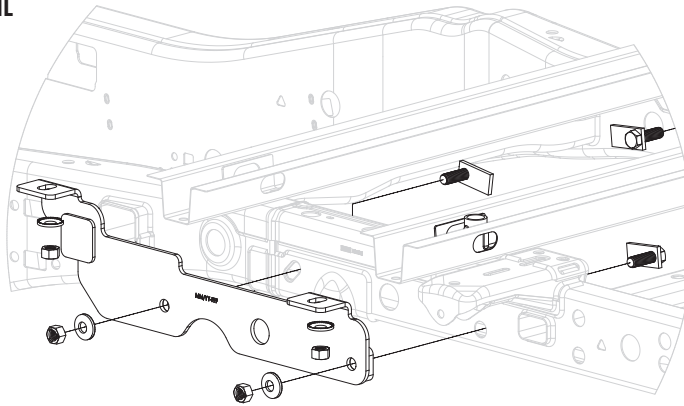

FIG. 4 - DRIVER SIDE DETAIL

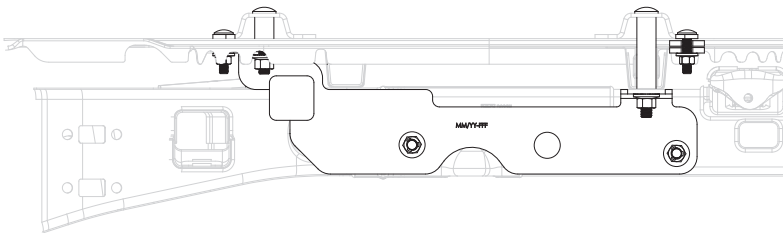
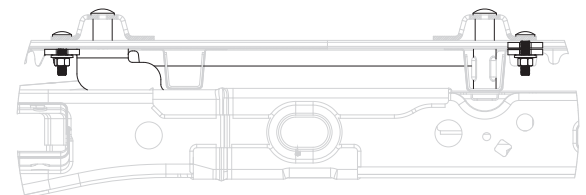

FIG. 5 - INSIDE FRAME RAIL ACCESS HOLE DETAIL



CAMCO MFG., INC.

121 LANDMARK DRIVE / GREENSBORO, NC 27409 / USA

1-800-334-2004

WWW.CAMCO.NET

LIMITED WARRANTY: Camco warrants this product to be free from defects in material and workmanship under normal use and service conditions for 12 months from the date of first purchase. Camco's liability is limited solely to the replacement of any defective product returned to us. To the extent allowable by law, Camco makes no other warranty, either expressed or implied, nor assumes any liability for incidental or consequential damages resulting from the use of this product or for breach of warranty of merchantability or fitness for a particular purpose. Submit warranty claims to Camco Manufacturing, 121 Landmark Drive, Greensboro, NC 27409.

CAMCO