



PORTABLE PROPANE WATER HEATER/SHOWER

USER GUIDE

HICPWH025



Thank you for purchasing the Hike Crew™ Portable Propane Water Heater/Shower.

This User Guide is intended to provide you with guidelines to ensure that operation of this product is safe and does not pose risk to the user. Any use that does not conform to the guidelines described in this User Guide may void the limited warranty.

Please read all directions before using the product and retain this guide for reference. This product is intended for outdoor use only.

This product is covered by a limited one-year warranty. Coverage is subject to limits and exclusions. See warranty for details.

SAFETY PRECAUTIONS



IT IS OF CRITICAL IMPORTANCE THAT YOU THOROUGHLY READ AND MAKE SURE YOU UNDERSTAND ALL SAFETY PRECAUTIONS AND SAFE USE REQUIREMENTS BEFORE ATTEMPTING TO USE THIS APPLIANCE. FAILURE TO PROPERLY FOLLOW THE GUIDELINES ESTABLISHED HEREIN COULD RESULT IN SEVERE INJURY, FIRE, OR EVEN DEATH.

⚠ This device is not intended to supply you with drinking water. It is designed to provide warm and/or hot water for washing and cleaning purposes only. Always check the water temperature and confirm its safety before using this appliance. Water dispensed by this product can be very hot.

NEVER operate this device in an enclosed area without ventilation.

⚠ Do not place or store any clothing or other miscellaneous items on top of or against this device.

⚠ Do not place or store chemicals, flammable items, or aerosol sprays of any kind on or near this device.

⚠ Do not attempt to operate this device if any panels, covers, or safeguards have not been properly installed.

⚠ Do not operate this appliance in a boat, trailer, or tent.

⚠ The water heater/shower is designed to be used with water at a base starting temperature of 68°F (20°C) and below.

⚠ This device can raise the temperature of the source water a maximum of 86°F (30°C) from the starting temperature (e.g., water starting at 20°F can only be raised to a maximum of 106°F). In the event that the heater does not increase the temperature of the water as high as you want it to go, keeping in mind that it cannot raise the temperature over 125°F (52°C), simply return the heated water to the source reservoir and run it through the heater again until the desired temperature is reached.

- ⚠ For safety reasons, this device will automatically shut off the internal burner once the water temperature from the shower head or dispenser reaches 125°F (52°C).
- ⚠ You should only use this device with the supplied regulator and only ever connect it to non-refillable 16.5oz (468g) disposable propane tanks certified to DOT-39, UN1075.
- ⚠ Always make sure to store your portable propane water heater/shower in a dry and well-ventilated location that is free from direct sunlight or extreme temperature variations.
- ⚠ **Never store this appliance while the propane tank is still connected.**
- ⚠ Always be sure to disconnect the propane tank and store it safely in an area that is well-ventilated and free from exposure to direct sunlight, heat, and any ignition sources (pilot lights, matches, lanterns, etc.). If you choose to store the propane tank indoors, make sure that the location complies with any local regulations and standards pertaining to indoor propane storage.
- ⚠ This appliance should only ever be repaired or serviced by an authorized serviceperson. Do not attempt to repair this device on your own. Always contact Hike Crew directly for repairs.
- ⚠ Make sure all packaging is completely removed and properly disposed of prior to first using this device.
- ⚠ This device is designed for outdoor use only.
- ⚠ Do not use the portable water heater/shower if it has a leak or any worn, deteriorated, or damaged seals. See Safe Use Requirements on page 3 for information on how to check the quality of the seals for gas leaks.
- ⚠ Always handle this device with extreme care and pick it up using the built-in handle. Never pick this appliance up or carry it by the propane tank.
- ⚠ Do not attempt to fit other types or sizes of gas containers or tanks to this device as this could prove hazardous.
- ⚠ Only use this appliance in well-ventilated areas. It should only be operated in an above-ground, open-air situation where there is natural ventilation, no stagnant areas, and where gas leakage and/or products of combustion will be promptly diffused by wind and natural convection.
- ⚠ Never use any type of adapter or attempt to modify this device to fit other connectors or other types of cylinders.
- ⚠ Do not attempt to use this device as a cooking appliance or modify it for any reason.
- ⚠ Children should be supervised by an adult at all times when around this appliance.
- ⚠ Never leave this device unattended during operation.

⚠️ This appliance must only be used outdoors and always should have at least 31.5" (800mm) of free space around the sides and should always be at least 31.5" (800mm) from all combustible surfaces, fabrics, and/or flammable materials.

SAFE USE REQUIREMENTS

CARBON MONOXIDE HAZARD:

USING THIS DEVICE IN AN ENCLOSED SPACE CAN CAUSE DEATH.
UNDER NO CIRCUMSTANCES SHOULD YOU USE THIS APPLIANCE IN TRAILERS,
TENTS, BOATS OR OTHER MARINE CRAFTS, MOBILE HOMES,
OR ANY OTHER SIMILARLY ENCLOSED SPACE.

This device should always be used on solid and stable horizontal surfaces made from non-combustible or non-flammable materials. It should always be protected from direct drafts and should be both stored and utilized in a well-ventilated location.

Keep this appliance away from children at all times.

Accessible parts can get extremely hot due to the internal burner of this device. Always use care when handling or moving this device.

If you smell gas at any point, immediately turn the power off and move both this device and the propane tank to a well-ventilated outdoor area, making sure to keep it far away from any sources of heat, like open flames or pilot lights.

Never attempt to pick up or move the appliance while it is in operation. Always extinguish the burner, allow the device to cool down, disengage the propane tank, and then move it.

You must use this appliance with the approved gas regulator that came with it. Do not use a different gas regulator or any kind of adapter.

Always check this device thoroughly for any signs of gas leaks before using it.

PROPERLY CHECKING FOR GAS LEAKS

- ! Check that all connections are secure and that the propane tank connection has been fully tightened before you turn on this device.
- ! Never check for gas leaks with an open flame or pilot light.
- ! Use soapy water to coat all the connections that should be sealed. If bubbles appear, you will need to tighten the connection before testing again.
- ! Inspect your water heater/shower regularly for signs of wear, leaks, or any evidence of incorrect operation. If you become aware of symptoms such as flaring of the burners, issues with lighting,

damage to connections, or leaks from the seals or gas controls, contact Hike Crew right away for information about authorized service professionals in your area. Do not under any circumstances attempt to repair these issues on your own.

! To check if there is propane remaining in your propane tank, first fully remove and disconnect it from the rear of the device. Hold it fully upright and vertical, then shake it from side to side. If you hear a sound or feel liquid moving around inside, then it still contains gas.

! Always make sure to change propane tanks outside, in a well-ventilated location, free from people, animals, and ignition sources (naked flames, pilot lights, electrical equipment with heaters or heating elements, etc.).

SAFE USE LOCATIONS

Reminder: this device should only be operated in an above-ground, open-air situation where there is natural ventilation, no stagnant areas, and where gas leakage and/or products of combustion will be promptly diffused by wind and natural convection.

Any enclosure in which you are using this device should comply with one of the following types of safe use locations. Do not use it in any area that does not comply with any of the following safe use locations.

- 1.** An enclosure with walls on all sides, but no roof/overhead covering.
- 2.** A partial enclosure that includes a roof/overhead covering, but has no more than two (2) walls.
- 3.** A partial enclosure with a roof/overhead covering, more than two (2) walls, but meets one of the following conditions:
 - a.** At least 25% of the total wall area is completely open and ventilated.
 - b.** At least 30% or more of the remaining wall side, back, and front areas are completely open and unrestricted.
 - c.** If using on a balcony or patio, at least 20% or more of the total wall area must remain open and unrestricted.

During operation, always make sure that all air inlets and exhaust vents are kept unobstructed and fully open.

SAFETY FEATURES

High Temperature Sensor: Your water heater/shower will automatically disable the burner once the water temperature from the dispenser reaches 125°F (52°C). It will automatically relight the burner once the water temperature from the dispenser falls below 113°F (45°C).

Water Flow Sensor: Water must be flowing through the system in order for the burner to ignite. If the water supply should for any reason become restricted, or cease entirely (i.e. the Flow Switch is in the "off" position), the burner will automatically be extinguished and will not relight until the water flow resumes.

Tilt Switch: If this device is moved during operation, or if it is being operated on an unstable/non-solid surface, the appliance will shut itself down and you will need to switch it off until you find a more suitable

surface on which to operate it.

Fuse Protection: The fuses in this appliance are located in the cigarette lighter and pump power inlet. In the event of an issue with the electrical supply, these will “blow” and protect the electronic system of this device.



CONNECTION POINTS AND CORRESPONDING PLUGS

This diagram will be referenced throughout the manual, as the various plugs and connection points can be confusing.



USEFUL INFORMATION

The AC/DC power adapter (**Plug #4**) and 12V cigarette lighter adapter (**Plug #5**) are interchangeable. Both will provide power to the main unit when connected to the main DC power input (**Connection Point #5**). You should use **Plug #5** in circumstances where your source of electrical power is coming from a cigarette lighter adapter, and use **Plug #4** in circumstances where your source of electrical power is coming from a traditional socket (such as on an RV or outdoor generator).

You can plug the pump power connector (**Plug #2.5**) into the pump hose power adapter (**Plug #6**) only in circumstances when you don't want to plug in the main unit. When you connect **Plug #2.5** to **Plug #6**, and then connect the cigarette lighter adapter end of **Plug #6** to a compatible power source, it allows you to run the hose and water pump without igniting the burner. This allows you to shower or run water through the faucet without using propane or powering on the whole main unit.

Please note, if you choose to use this feature, the water will not be heated.

INITIAL SETUP

NOTE: This process must be followed each time you prepare the device for use. These steps are critically important and should not be skipped – be sure to always check the device for gas leaks when setting it up.

1. Remove all the parts and accessories from the travel bag. Place the water heater itself on a solid, non-combustible surface, and straighten out all the included hoses so that any kinks or twists are removed.
2. Connect either the AC/DC power adapter or the 12V cigarette lighter adapter (**Plug #4 or Plug #5**) to the device via the main DC power input jack at the rear of the unit (**Connection Point #5**), and plug the power cable into an appropriate power source.
3. Swing the faucet away from its secure storage position so that it is turned toward the side and facing away from the heater. Turn the switch underneath the hinge all the way to the left to set the faucet flow to the MAX position.
4. Check that the power switch is set to the "OFF" position. Connect the pump hose (**Plug #2**) to the water inlet (**Connection #2**) at the rear of the appliance, and plug the pump power connector (**Plug #2.5**) into the pump DC power input (**Connection Point #4**) next to the main DC power input.
5. Attach the propane tank to the gas regulator (**Plug #1**) by screwing it in a clockwise motion to the top of the tank, and then connect the the gas regulator (**Plug #1**) with the attached propane tank to the gas inlet (**Connection Point #1**) at the rear of the appliance. Use soapy water as described in the Safe Use Requirements on page 3, to check for gas leaks. Do not use a flame. If you detect a leak, remove the propane tank, retighten all connections, and then retest.
6. Lower the filter end of the pump until it is fully submerged in a suitable water reservoir.

NOTE: Do not use water directly from rivers, lakes or the ocean. Do not use saltwater with this appliance under any circumstance.

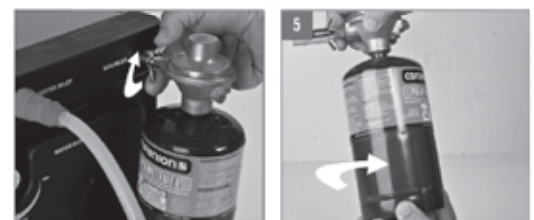
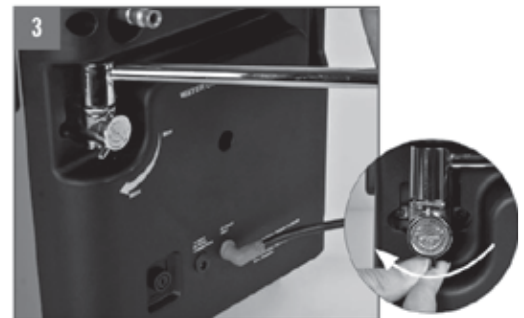

USING THE FAUCET

1. Follow the steps described in the Initial Setup section, but in Step 3, set the faucet flow switch to a central position, instead of the MAX position. Make sure the faucet is turned away from the rear of the device toward the side, and you have a basin or bucket underneath the faucet to catch the water as it is dispensed.
2. Press the power button and the heater will turn on.
3. Turn the gas control knob on top of the heater to the "HIGH" position, and then press the green "START" button next to the power button. Within a few seconds, water should start to flow from the faucet.
4. You should hear the electronic ignition lighting the internal burner; once the burner is ignited, the ignition indicator will be lit on the display, and the water temperature readout on the display will start to increase.
5. The water temperature can be adjusted by either turning the flame lower or higher via the knob on top of the heater, or by adjusting the flow valve underneath the spigot to increase or decrease the water flow. Increasing the water flow will decrease the water temperature because it will pass rapidly over the burner, while decreasing the water flow will increase its temperature due to it passing over the flame more slowly.
6. Once you have finished with the faucet, turn the flow switch underneath the spigot all the way to the MIN position, which will stop the flow of water and extinguish the burner, then press the green "START" button to stop the flow of water to the pump.



USING THE SHOWER

1. Follow the steps described in the Initial Setup section. Make sure the faucet is turned away from the rear of the device toward the side, then attach the shower head (**Plug #3**) to the faucet outlet (**Connection Point #3**) using the Quick Connect attachment. Make sure the shower flow switch under the handle is in the ON position.
2. Press the power button and the heater will turn on.
3. Turn the gas control knob on top of the heater to a central position between the LOW and HIGH positions, and then press the green "START" button next to the power button. Within a few seconds, water should start to flow from the shower head.
4. You should hear the electronic ignition lighting the internal burner; once the burner is ignited, the ignition indicator will be lit on the display, and the water temperature readout on the display will start to increase.
5. Carefully test the temperature of the water coming from the shower head, and then use the gas control knob on top of the heater to adjust the heat until the shower water has reached your desired temperature.
6. At any time, you can stop the water flow from the shower head by sliding the flow switch under the handle up until it clicks into the OFF position. This will automatically extinguish the burner, although the pump will continue to operate.
7. To reignite the burner if necessary, simply slide the flow switch back down toward the handle of the shower head until it clicks into the ON position. Water will resume flowing from the shower head and the burner will ignite within 5-10 seconds.

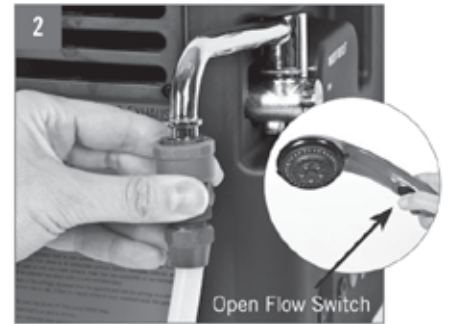

NOTE: Any water remaining in the heat exchange segment of the appliance while the flow is temporarily stopped may become hot. If and when you switch the shower head back on, you should ALWAYS carefully check the temperature output to make sure it is not excessively hot.

8. Once you have finished with the shower head, slide the flow switch up toward the shower head until it clicks into the OFF position, which will automatically extinguish the burner, and then press the green "START" button to stop the flow of water to the pump.

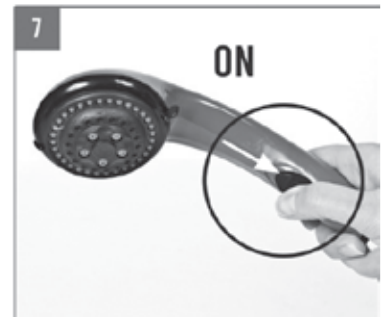

REMOVING THE PROPANE TANK

1. Check that the internal burner is fully extinguished, the heater is entirely powered down, and all surfaces are cool to the touch.
2. Unscrew the gas regulator (**Plug #1**) from the gas inlet (**Connection Point #1**) at the rear of the heater by turning it in a counter-clockwise direction.
3. Unscrew the regulator connection from the propane tank by turning it in a counterclockwise direction.

STORING YOUR WATER HEATER/SHOWER

1. Press the power button to completely power down the unit.
2. Disconnect all of the hoses and hold them vertically so that all the excess water can drain out of them. During this process, the flow switch on the shower head should be in the ON position.
3. Unscrew the regulator assembly from the heater and remove the gas cartridge as explained on page 6.
4. Turn the faucet back into the locked position at the rear of the device.
5. Tip the heater backwards and to one side so that the excess water will drain out of the heat exchanger via the nozzle marked "water inlet" above the faucet.

TROUBLESHOOTING

If you're experiencing this issue:	Try these possible solutions:
Water isn't coming out of the shower head	<ul style="list-style-type: none">• Make sure the device is switched on and the START button is pressed• Make sure there is sufficient water available• Make sure the pump is connected to the heater• Make sure you have adequate DC power• Check the DC fuse in the cigarette lighter adapter• Make sure the shower flow switch is set in the ON position
The burner won't light	<ul style="list-style-type: none">• Make sure the gas tank is turned on and that there is sufficient propane remaining• Make sure water is flowing from the shower head and that the flow switch is set to ON• Make sure the water has not exceeded the temperature limit
Water isn't hot enough	<ul style="list-style-type: none">• Check the gas control knob on top of the unit• Check the temperature of your source water• Run the water through the system so that it flows back into your source reservoir, and then run it through the system a second time

ERROR CODES

Your portable water heater/shower includes a number of operational and safety features. In the event that the device will not operate, certain issues can be identified from error codes that will appear in the display window on the front of the appliance.

Error Code	Meaning
E3	No flame/burner not lit
E6	Temperature too high, auto shut-off initiated
E7	Water temperature exceeds 125°F (52°C)
E8	Tilt switch activated



USEFUL TIPS

Recycling water for extra heat: If your water temperature has not increased to the desired level after being run through the system once, simply recycle it back into your source reservoir via the faucet or the shower head attachment, and then run it through the system a second time. This method of “pre-heating” the water is especially helpful when trying to take a warm shower. In addition, if you use the smaller inner rings on the shower head spray pattern, this will help contribute to an increase in the shower temperature.

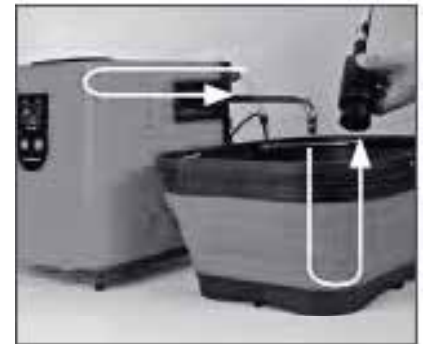

Pump water filter: The pump on your device is equipped with a mesh filter on the water inlet, which you can see by unscrewing the cap of the pump. You should periodically check this mesh filter for buildups and blockages which may restrict the water flow to the device.



Air in the hose: During operation of this device, if the water reservoir is low on water or if you remove the pump from the water, air will be pulled into the hose as a result. This will result in a blockage. To resolve this issue, just turn your water heater all the way off, disconnect the hose, remove it from the water, and hold it vertically above the reservoir so that it drains fully. Once this process is complete, you may reassemble the hose and resume operating the device as usual.

Adjusting shower head spray patterns: The shower head features three distinct spray patterns and a selector dial that allows you to choose between them. Simply turn the dial right underneath the head to experience and select your preferred spray pattern.



Ice buildup on propane tank: When using a propane tank and running the device on “HIGH” for an extended period of time, you may notice that the tank will start to freeze up—identifiable from the accumulation of ice on the outside of it. This will obviously result in a reduced burner performance and drop in the temperature of water being dispensed. To correct this issue, turn the heater to “LOW” or turn it completely off, then wait for the ice to melt as the propane tank warms back up.

Please do not attempt to warm the propane tank yourself with any type of flame or combustible material.

CARE AND MAINTENANCE

- To clean your water heater/shower, use warm soapy water, a soft towel, and a mild detergent to wipe down all external areas and surfaces. Please take care to make sure water does not enter the burner outlets.
- NEVER submerge this appliance in a sink, bowl, or any other body of water.
- NEVER use bleach or any other abrasive cleaners.

TECHNICAL SPECIFICATIONS

Water flow: 2.3qt/minute (2.2L/minute) on average

DC input voltage: 12V/5A DC lead cigarette connector

Size: 9.65" L x 12.2" W x 11.8" H (245 x 310 x 300mm)

Weight: 13.2lb (6.0kg) without propane tank

Gas type: Propane

Consumption: 5.7kWh (20.68Mj)/hr / 14.5oz (412g)/hr

CUSTOMER SERVICE INFO

info@supportcbp.com

1-833-855-1816

Hike Crew is a trademark of C&A IP Holdings, LLC, in the U.S.

All other products, brand names, company names, and logos are trademarks of their respective owners, used merely to identify their respective products, and are not meant to connote any sponsorship, endorsement or approval.

Distributed by C&A Marketing, Inc., 114 Tived Lane East, Edison, NJ 08837. Made in China.

© 2018. C&A IP Holdings, LLC. All Rights Reserved.