

# Peel & Stick

*Wallpaper Installation*

WallsNeedLove



---

# Steps

---

1. Prepare

2. Apply

3. Trim

4. Enjoy

## Essential Tools

---

Having the proper tools is essential for successful wallpaper installation. You will also need a helper to assist with the alignment of peel-and-stick wallpaper.



Felt tip  
squeegee



Cutting Knife  
Snap-off blade

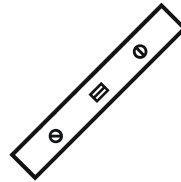

Level / straight edge  
(we recommend a Kapro 313)



Flathead  
Screwdriver



Scissors



Step ladder



Pencil



A Helper

---

**Congratulations!** We believe that wallpaper is one of the best ways to transform an interior. Nothing makes an impact quite like billboard-sized artwork resting in your space.

Our ultimate goal is for you to have an enjoyable and successful wallpapering experience. Proper tools and instruction is important. Please review these instructions prior to starting and let us know if you have any questions at all.

Alternatively, you can hire a professional wallpaper installer. You can find wallpaper installers on [Google](#), [Thumbtack](#), [AngiesList](#), [WallcoveringInstallers.org](#) and [Houzz](#).

# 1. Prepare

---

## Layout your wallpaper

---

- Unroll your wallpaper and separate the panels.
- Repeating patterns can be installed in any order. However, if you have ordered a large image mural then you will need to arrange them in order (C1, C2, C3...).
- Each panel will have a white header and footer. This will be trimmed away after the installation.

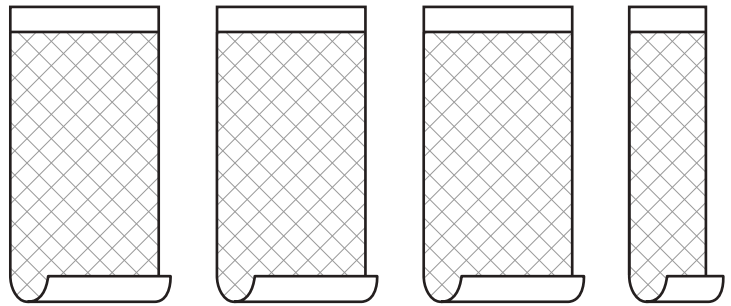

*Repeating patterns*

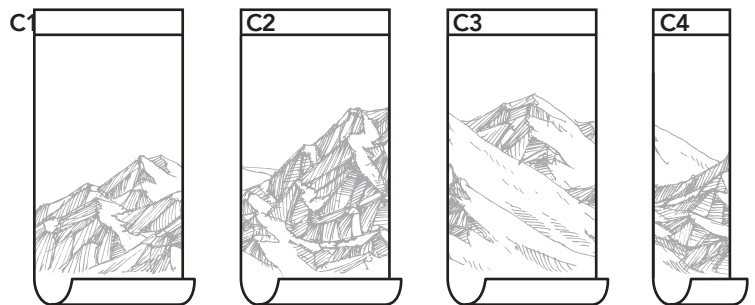

*Large image mural*

## Prepare your wall

---

- Turn off your breaker and remove all socket and switch covers.
- Ensure your wall is clean, dry and free of any noticeable bumps.
- If you have painted, wait 4 weeks before installing. Best applied on flat paint.
- A Mildly textured walls such as orange peel are fine but heavy textures need to be sanded smooth prior to installation.

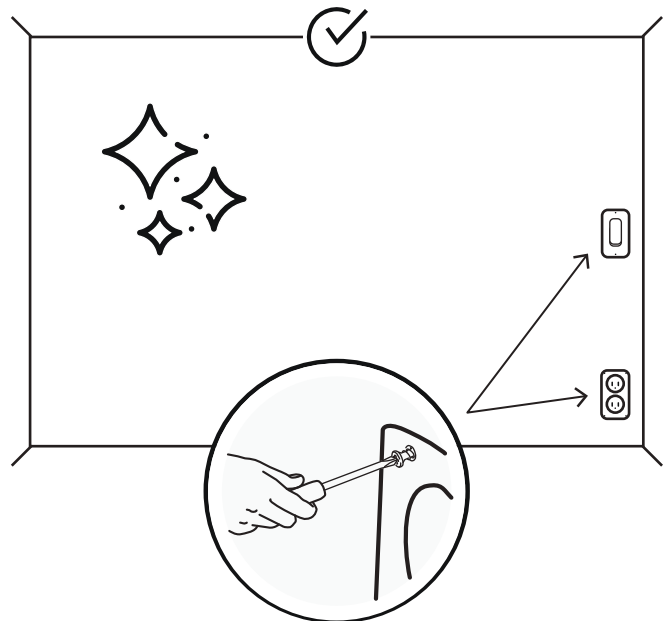

## Mark your plumb line

---

- You will start applying in the middle of the wall, not in the corner.
- Roll up and arrange your panels at the floor. Make sure to arrange them so that both the left and right sides have an overlap.
- Select one of the center seams and make a pencil mark for the location of your plumb line.
- Using the level and a pencil, mark a vertical plumb line from floor to ceiling.

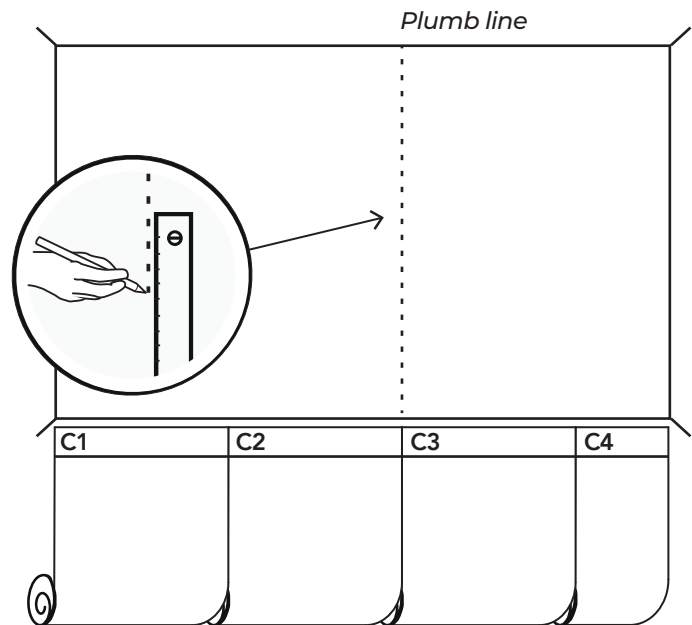

## 2. Apply

---

### Apply the first panel

---

- Identify the correct middle panel and peel away about 2 feet of backing paper from the top.
- Position the panel high enough to overlap the ceiling line by at least 2-inches. This will be trimmed later.
- You and your helper will align the panels' edge with the plumb line.
- Once aligned, stick the top of the panel and check the alignment. If any adjustments are necessary then simply peel it off and reapply.

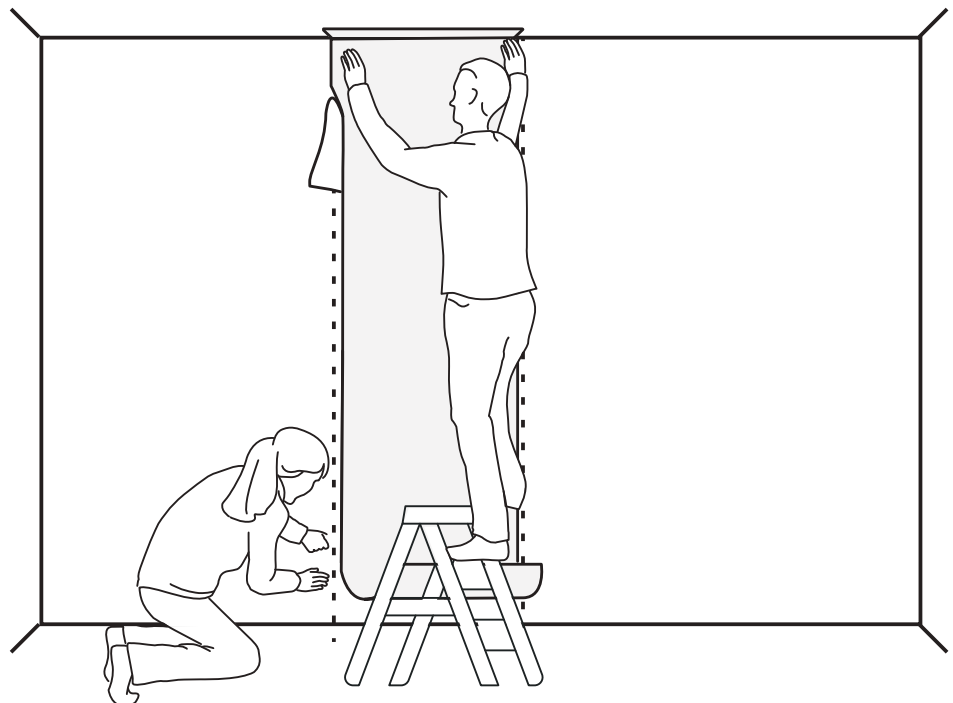

## Apply the remaining panels

---

- Once aligned, you'll apply the rest of the panel to the wall.
- Pull the backing paper down 2 feet and use the felt-tipped squeegee to smooth it onto the wall.
- Repeat the process all the way down and then smooth out any air bubbles.

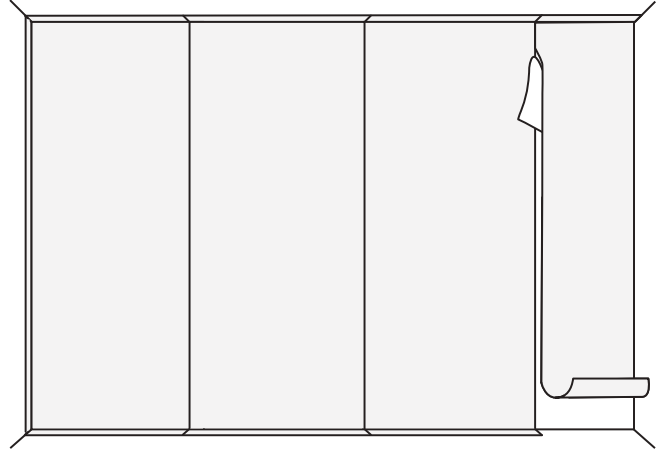

## 3. Trim

---

### Grab your straight edge

---

- Take your time with this final step and make sure you snap off a fresh blade for every cut.
- Hold the straight-edge firmly in place and trim the edges of the wallpaper.

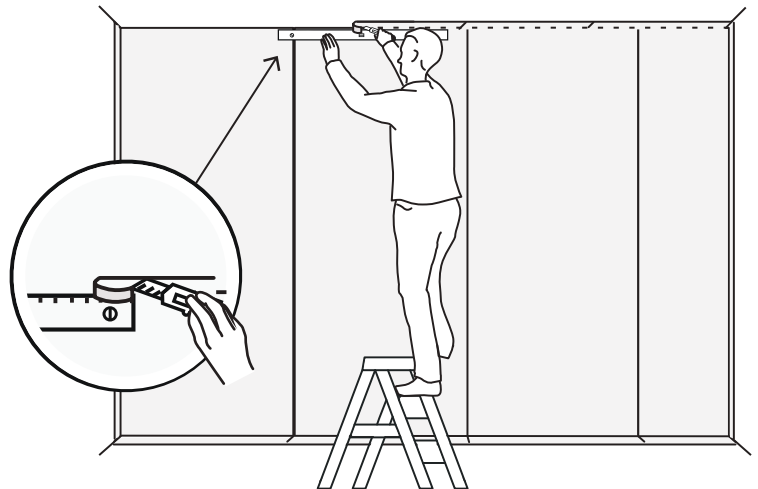

# 4. Enjoy

---

## You did it congradulations

---

Stand back and appreciate the project that you just completed

We realize that DIY projects can seem daunting at first but taken step-by-step, any journey is possible.



**Pics:** Snap a photo and share it with us by tagging @WallsNeedLove on Instagram or email it to [pics@wallsneedlove.com](mailto:pics@wallsneedlove.com)



WallsNeedLove



[hello@WallsNeedLove.com](mailto:hello@WallsNeedLove.com)



877-807-8897