



TXJTD8

Dual 8" Under Seat Subwoofer Enclosure FOR JEEP GLADIATOR JT



INSTALLATION GUIDE

NOTE! Read this installation guide thoroughly before disassembling or modifying the vehicle. Installation of this product requires technical skill, experience and specialized tools. If in doubt, it's recommended to have it professionally installed by an authorized **Stinger** or **Audio Control** Dealer.

A video installation guide is available at:

<https://stingerelectronics.com/collections/vehicle-specific-subwoofer-enclosures/products/txjtd8>



INSTALLATION NOTES

The TXJTD8 is designed to mount under the rear seat of the Jeep Gladiator. The factory under seat storage will need to be removed and two of the factory bolts will be used to mount the enclosure.

- For JT models equipped with a factory subwoofer, there is no need to remove the subwoofer, but unplugging the factory subwoofer is recommended. See Step 6.
- Some installation steps are more easily completed with a second person.
- Speaker wire is required.
- Final enclosure impedance: 2ohms.
- Recommended amplifier rating: 400-1,000 watts @ 2ohms.
- Recommended Subsonic Filter Setting: 31 Hz.

INCLUDED HARDWARE

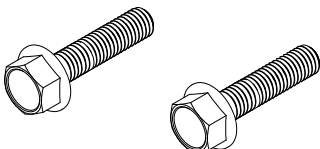
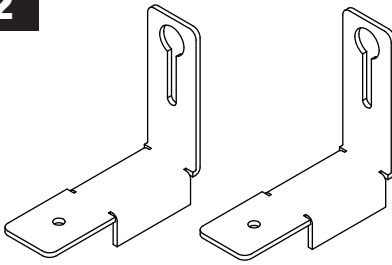
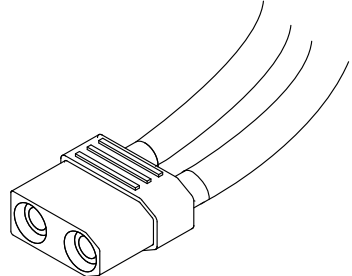
1 	2 	3 
M6 FLANGED HEX HEAD BOLT (2) 75mm / 2.95in Length	ENCLOSURE MOUNTING BRACKETS (2)	QUICK-PLUG SPEAKER CONNECTOR (1)

RECOMMENDED TOOLS

10mm Wrench

Wire Strippers

Optional:

Small Pick / Flat Screwdriver

T25 Torx

Nylon Panel Tool

Wire Crimper

Solder/Solder Gun

Step 1

On both sides of the speaker enclosure, loosen the 10mm bolts halfway and remove the mounting brackets by passing the bolt head through the “keyhole” on the brackets.

Leave the 10mm bolts partially installed in the rear of the enclosure.

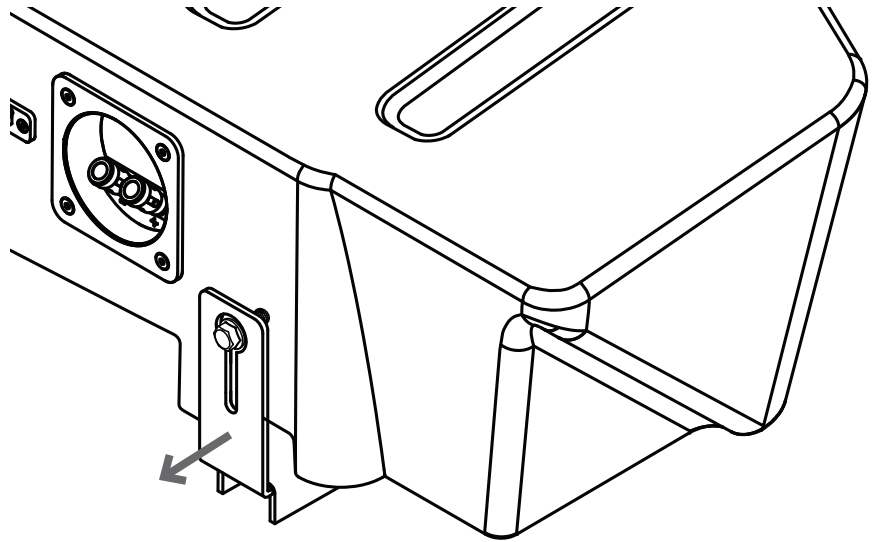

Step 2

With the rear seat bottoms folded up, remove the four 10mm (Torx #40) bolts securing the storage wall to the floor. Remove the storage wall from the vehicle.

NOTE: On models equipped with a locking storage bin, the bottom of the storage bin has rubber mats that need to be removed to access the four mounting bolts.

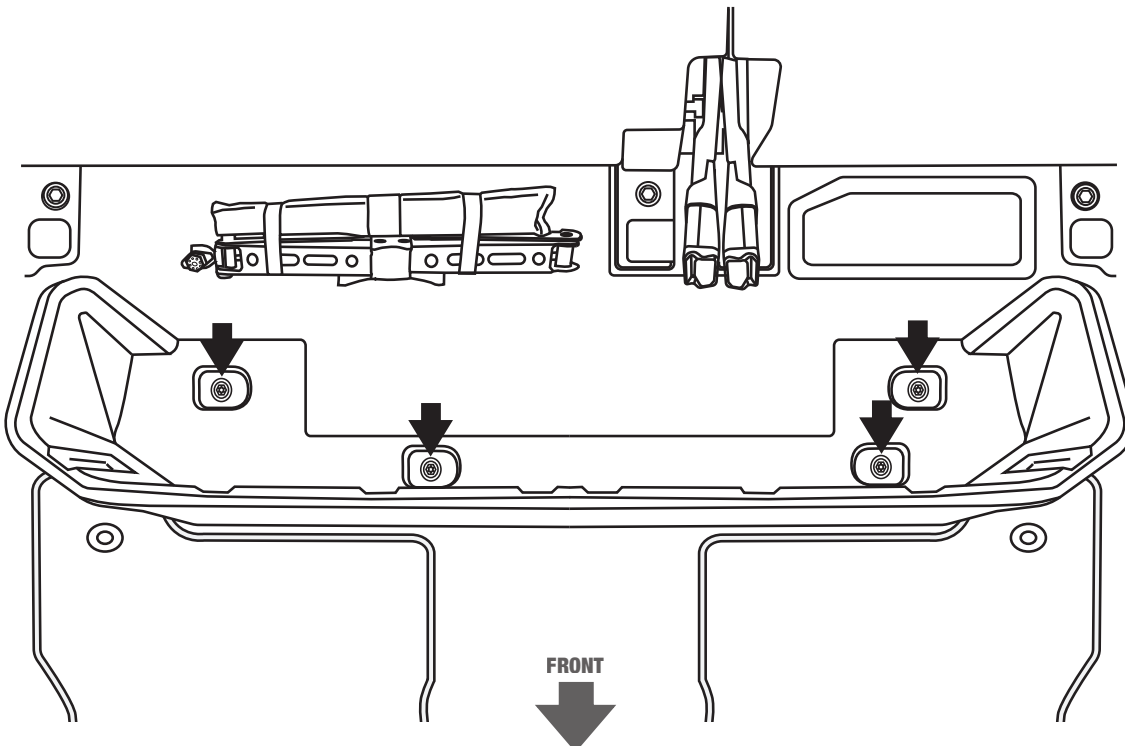

INSTALLATION

Step 3

Using two of the factory bolts removed in Step 2, attached the enclosure mounting brackets to the two outer mounting points on the vehicle floor as shown.

NOTE: The mounting brackets should be aligned straight and centered on the mounting points.

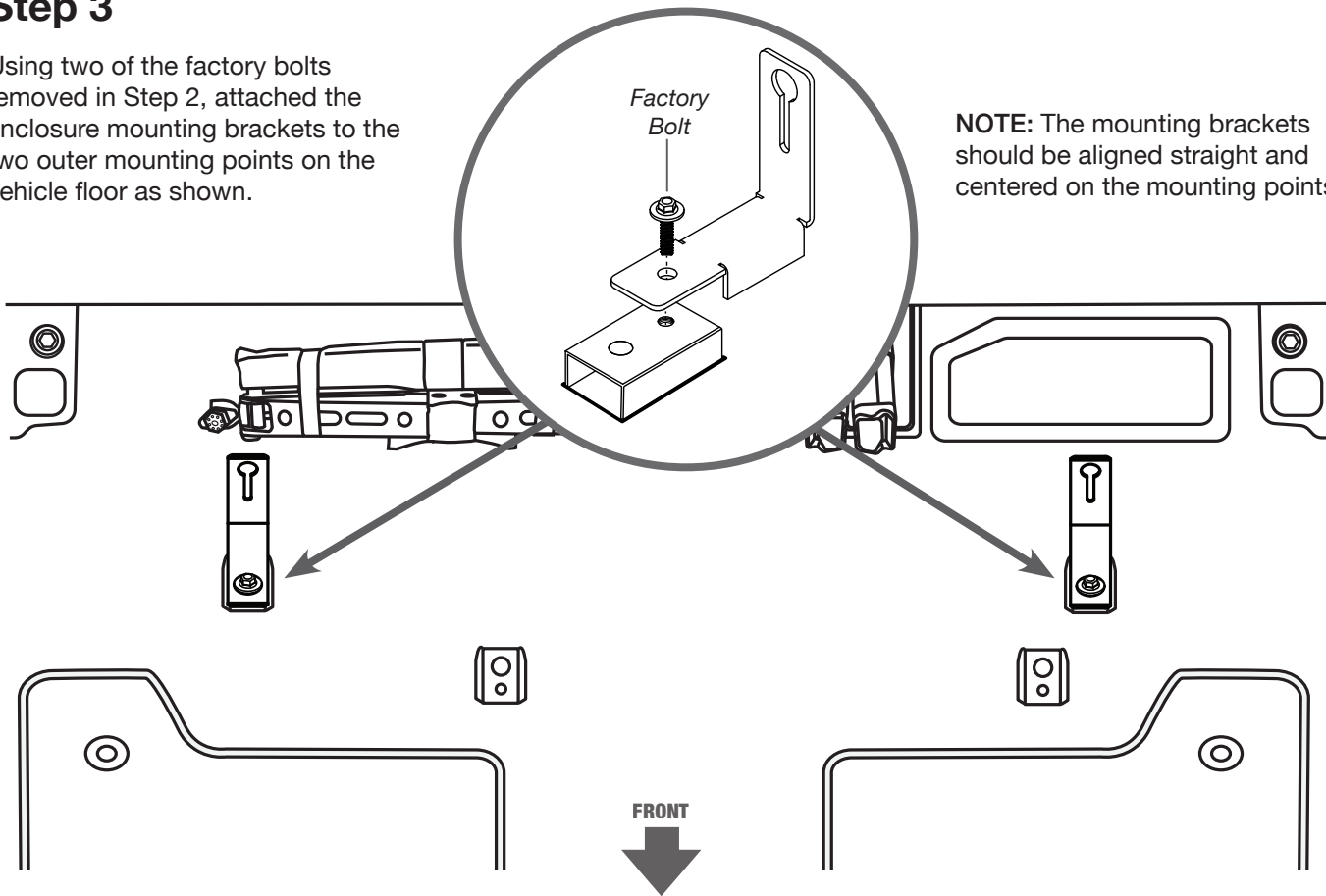

Step 4

Place the speaker enclosure in the vehicle with the rear bolts facing towards the mounting brackets.

Route speaker wire to the rear of the enclosure and connect using either the Push Terminals or the Quick-Plug connector.

Red = Positive (+)
Black = Negative (-)

NOTE: Do not connect speaker leads to both of the enclosure connections. Use one or the other.

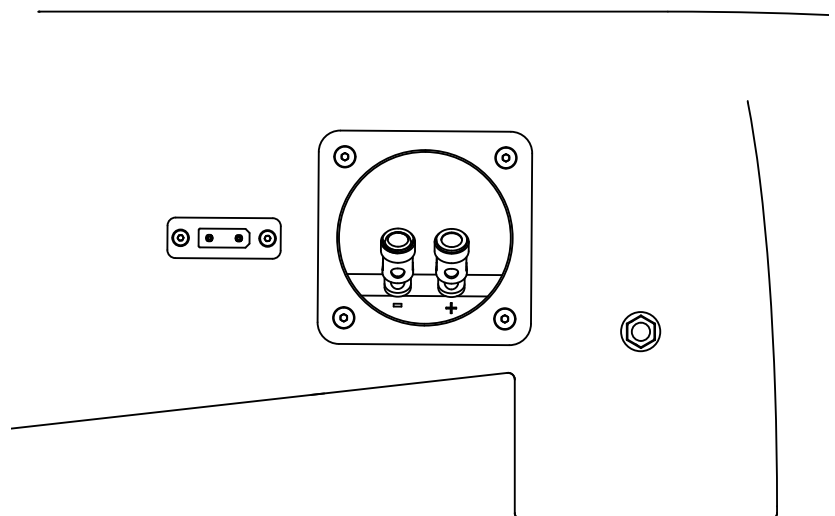

Step 5

After the speaker wire is connected, align the rear bolt on the enclosure to the keyhole on the mounting brackets. Pass the bolt head through the keyhole and lower the bolt into the bracket slot. Repeat for the other side.

Tighten both bolts securely using a 10mm wrench.

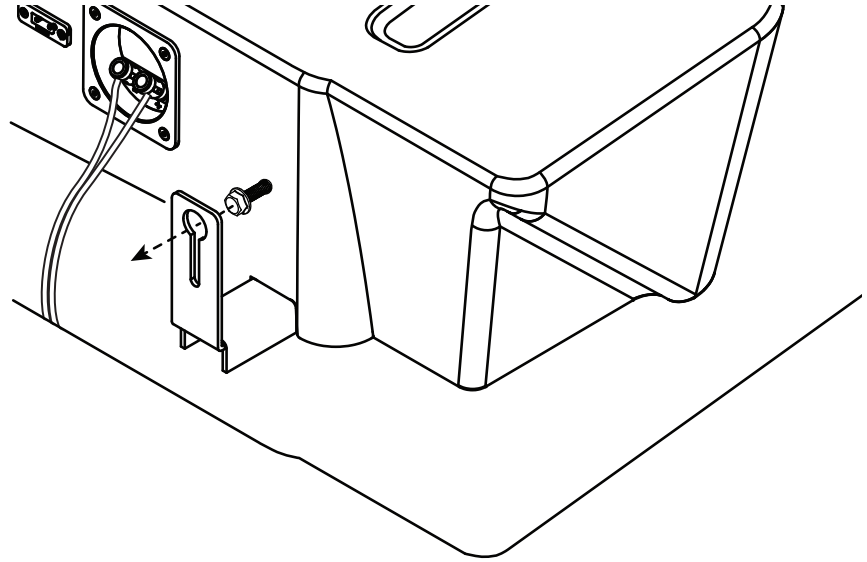

FACTORY SUBWOOFER

Step 6

For Gladiator's equipped with a factory subwoofer, it is recommended to unplug the factory subwoofer to avoid phase issues.

To access and disconnect the factory subwoofer, release and lower the rear passenger side seat back to access the storage bin on the back wall trim panel.

Using a small pick or flat blade screwdriver, remove the screw covers (1). Remove the two Torx T25 screws (2). Using a panel tool, release the retaining clips and remove the storage bin (3).

Unplug the 6-pin connector (4).

Reinstall the trim panel, screws and screw covers.

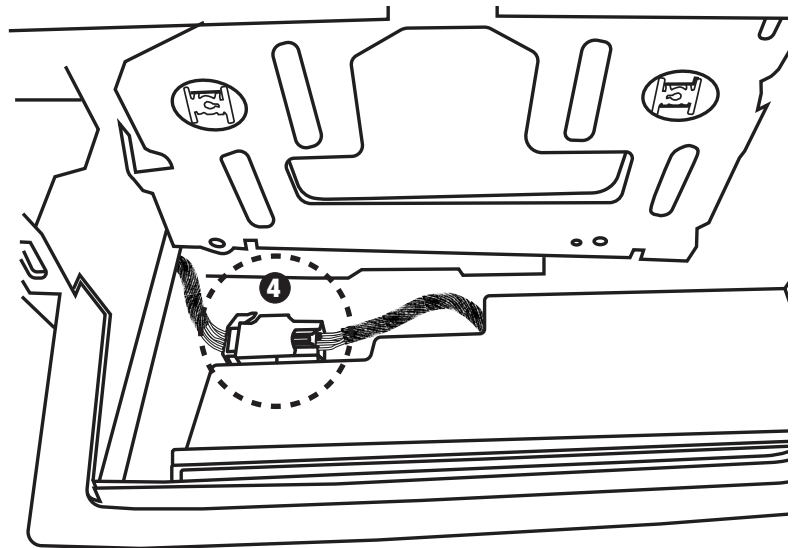
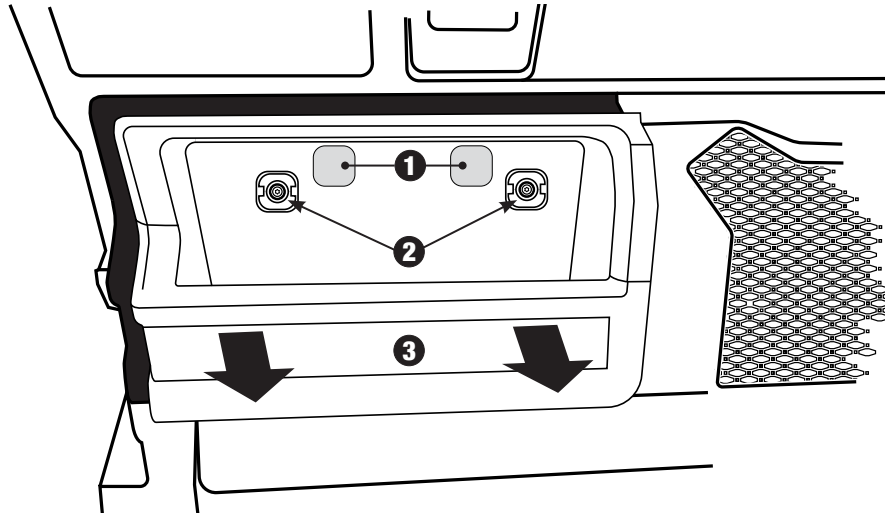

SPECIFICATIONS

Model Number	TXJTD8
Speaker Model	SPK-S4 (x2)
Subwoofer Size	Dual 8"
Voice Coil	Single 4 ohm
Enclosure DC Resistance (Re)	2 ohm
Sensitivity 1W/M (SPL)	88 dB
Frequency Response	20Hz - 250Hz
RMS Power	Min: 400 watts / Ideal: 700 watts
Peak Power	1,000 watts
Speaker Displacement	0.10 cu ft / 2.88 Ltr
Speaker Weight	11.75 lbs
Enclosure Specifications	
Internal Tuning	39 Hz
Subsonic Filter Setting	31 Hz
Enclosure Weight	20.5 lbs
Total Weight	43 lbs
Height	7.5in / 19.05cm
Width	48in / 121.92cm
Depth	10.5in / 26.67cm

WARRANTY

Limited Warranty

Stinger warrants this product to be free of defects in materials and workmanship for a period of one (1) years from the original date of purchase. This warranty is not transferable and applies only to the original purchaser from an authorized Stinger dealer in the United States of America only. Should service be necessary under this warranty for any reason due to manufacturing defect or malfunction, Stinger will (at its discretion), repair or replace the defective product with new or remanufactured product at no charge. Damage caused by the following is not covered under warranty: accident, misuse, abuse, product modification or neglect, failure to follow

installation instructions, unauthorized repair attempts, misrepresentations by the seller. This warranty does not cover incidental or consequential damages and does not cover the cost of removing or reinstalling the unit(s). Cosmetic damage due to accident or normal wear and tear is not covered under warranty.

INTERNATIONAL WARRANTIES:

Products purchased outside the United States of America are covered only by that country's Authorized Stinger reseller and not by Stinger. Consumers needing service or warranty information for these products must contact that country's reseller for information.



Stinger is a Power Brand of AAMP Global
15500 Lightwave, Clearwater, Florida 33760
Phone: 888-228-5560

Technical Support

Phone: 727-592-5991

Email: support@stingerelectronics.com

Chat: stingerelectronics.com

Stinger and the Stinger logo are trademarks or registered trademarks of AAMP Global in the United States and other countries.

AAMP Global is not affiliated with FCA US LLC. Jeep® is a registered trademark of FCA US LLC. The terms OEM, Jeep, Wrangler, and Gladiator all terms are used strictly for identification purposes only. It is not implied that any part listed is a product of, or approved by, Fiat Chrysler Automobiles.