



**ADVENTURE  
FURTHER®**

**2021+ JEEP JL /JT (392 & MOPAR)  
OVERHEAD MOUNTING BRACKETS  
(W/OPTIONAL A-PILLAR/COWL LIGHT MOUNTS)**

## INSTALLATION INSTRUCTIONS

### IMPORTANT:

Please read all instructions before beginning installation. These guidelines are provided in good faith to help prevent any issues arising from errors during installation. The manufacturer of this product shall not be held responsible for any user actions taken or not taken during installation. There are many details of the installation that are assumed to be general mechanical knowledge to experienced installers; which are not detailed in these instructions. These installation guidelines are intended to serve as professional recommendations and are not as a step-by-step, fail-safe installation checklist. Selection of an experienced installer is the sole responsibility of the project owner.



### PARTS INCLUDED:

- (1) - OVERHEAD MOUNTING BRACKET SET
- (1) - SILICONE DRIVER/PASSENGER GASKET SET
- (2) - WINDSHIELD HINGE BRACKETS
- (2) - 2-HOLE HINGE REINFORCEMENT BRACKET
- (1) - A-PILLAR/COWL LIGHT TAB SET
- (1) - HARDWARE
  - (4) - M8\*35MM BHCS
  - (4) - M8 WASHERS
  - (4) - M6\*25MM BHCS
  - (2) - M6\*16MM BHCS
  - (2) - M6 WASHERS
  - (6) - M6 NYLOCK NUTS

## STEP BY STEP INSTALLATION INSTRUCTIONS

TOOLS NEEDED: T40 & T45 TORX | 4MM & 5MM HEX KET



### PRE-INSTALLATION

Apply gaskets onto the corresponding brackets with a uniform offset from the edge of the bracket(s), evenly applying pressure to ensure adhesion.

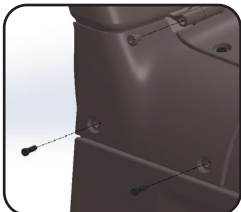

### STEP 1 - BEGIN

(With T40 TORX) Remove the 2-lower factory cowl mounting screws.  
(With T45 TORX) Loosen the factory pin-nut from the hinge approximately 1/8".

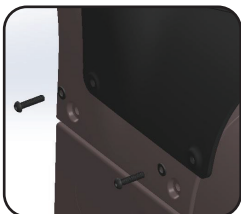

### STEP 2 - LOWER MOUNT

Position the Overhead Bracket on the vehicle. Using the supplied M8 Screw (w/ thread locker) and M8 Washer, secure the Overhead Mounting Brackets to the vehicle.



### STEP 3 - HINGE MOUNT

Slot the Windshield Hinge Bracket over the loosened factory pin-nut; positioned on the 'outside' of the Overhead Mounting Bracket "Tab".

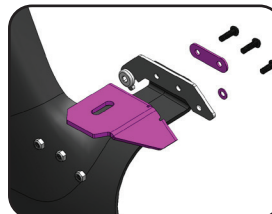

### STEP 4 - FINAL ASSEMBLY

Position the A-Pillar Light Tab on the 'outside' of the Windshield Hinge Bracket and the Hinge Reinforcement Bracket on the 'inside' of the Overhead Bracket Mounting Tab.

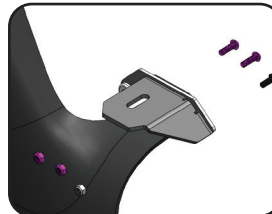

With the M6\*25mm Screws & Nylock Nuts, secure the A-Pillar Light Tab & Hinge Reinforcement Bracket to the Overhead Bracket Mount; make sure that the assembly is level before final tightening.

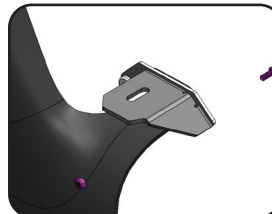

Using the M6\*16mm Screw, Washer & Nylock Nut, secure the A-Pillar Light Tab to the Windshield Hinge Bracket.

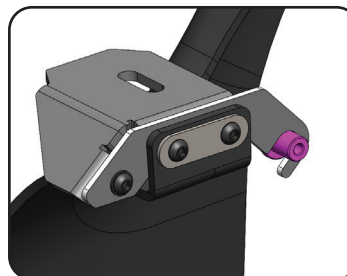

### FINAL TIGHTENING

After the Light Tab is level and securely fastened, re-tighten the factory pin-nut securing the Overhead Mounting Bracket in place.

Repeat with the other side.