



URBAN
Bonfire[®]
URBAIN

URBAN BONFIRE
Sink Guide - Custom

AUGUST 2021

Important Notice

Urban Bonfire recommends that customers building an outdoor kitchen use a **top mounted sink**. Outdoor sinks are often filled with ice and used to cool beverages. This creative use of an outdoor sink can be very heavy and put a lot of strain on undermount sink fasteners and potentially create delamination over time. Top mounted sinks are fully supported by the flange that rests on the countertop so they tend to be more resilient in outdoor applications.

Sink Clearance : Sink Cabinets (inches)

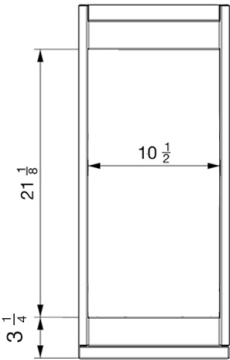

BF12-S

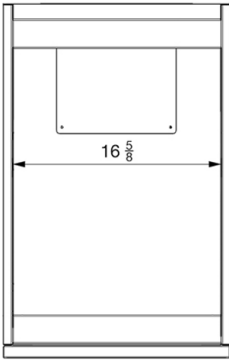

BF18-S

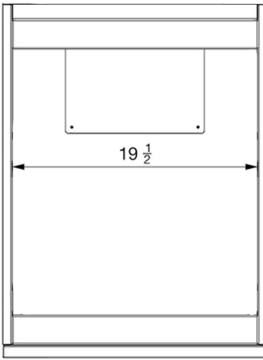

BF21-S

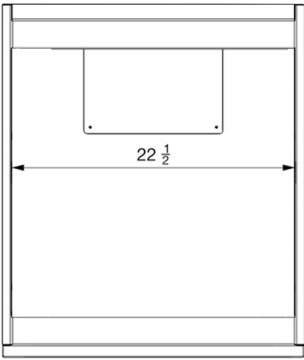

BF24-S

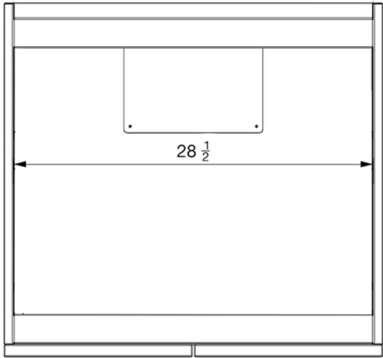

BF30-S

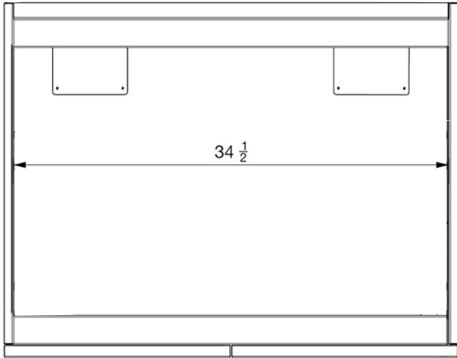

BF36-S

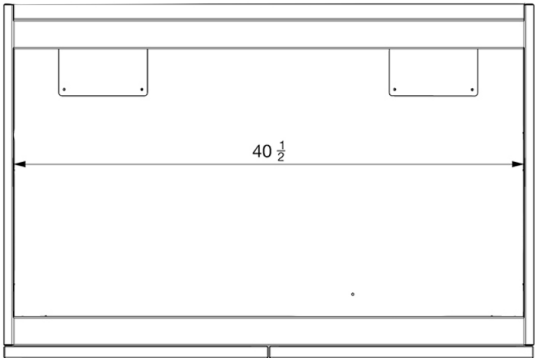

BF42-S

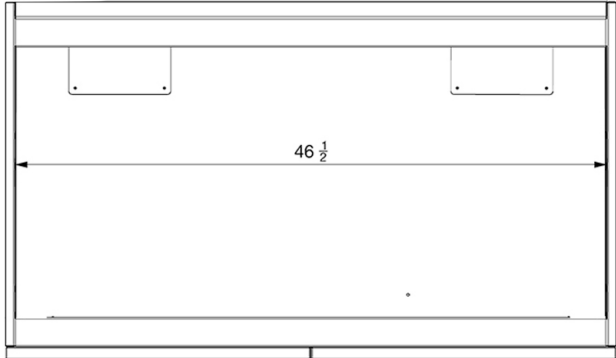

BF48-S

Top Mount Sinks

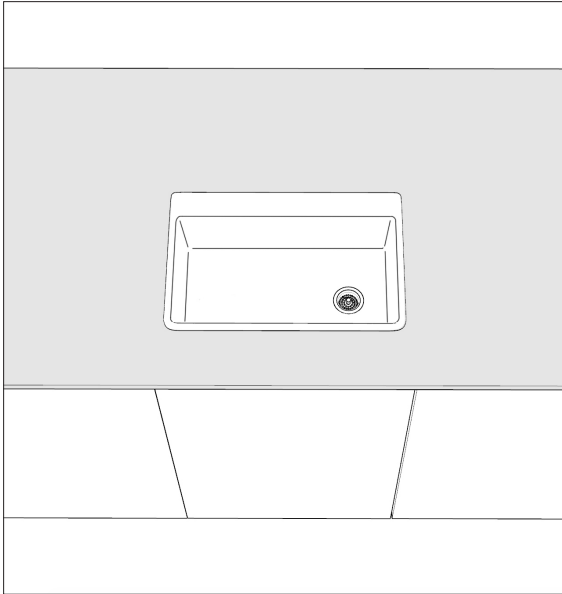

TOP MOUNT SINK

The sink is fully supported by the flange that rests on the countertop. Cut-out specs provided by the sink manufacturer.

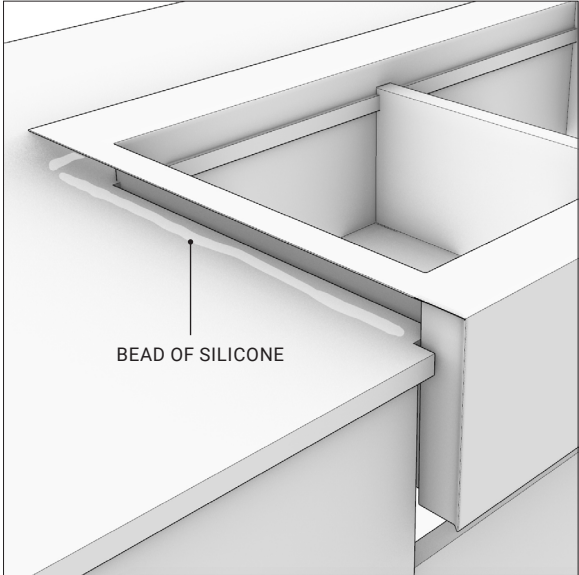
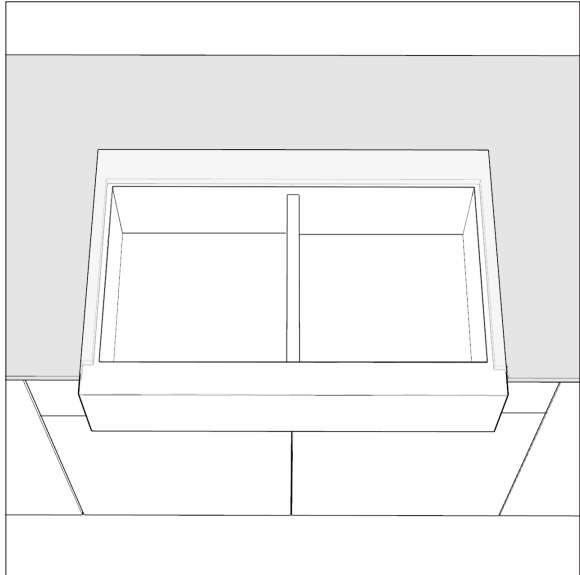

FARMHOUSE SINK SUPPORTED BY THE COUNTERTOP

The sink sits on the countertop, fully supported by the flange, and is fixed with a bead of silicone.

Undermount Sinks

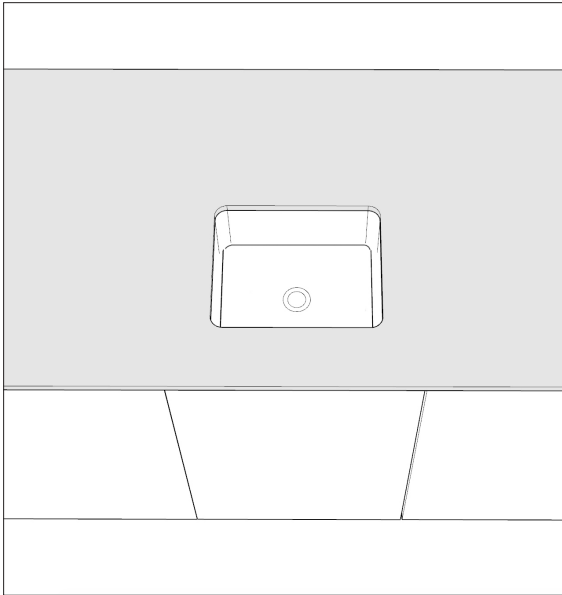

UNDERMOUNT SINK ATTACHED TO THE COUNTERTOP

The sink is fixed to the countertop from under with a bead of silicone and mounting hardware (provided by sink fabricator).

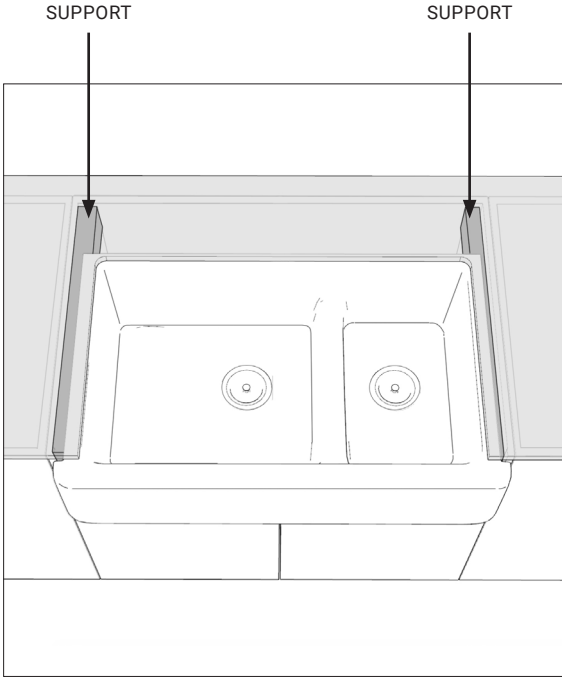

UNDERMOUNT SINK SUPPORTED BY THE BOTTOM

The sink require additional support from underneath. THESE MODELS ARE NOT COMPATIBLE WITH OUR CABINETY SYSTEM.

1. Top Mount Sink

Compatible with Urban Bonfire products. The sink is fully supported by the flange that rests on the countertop. Cut-out specs provided by the sink manufacturer.

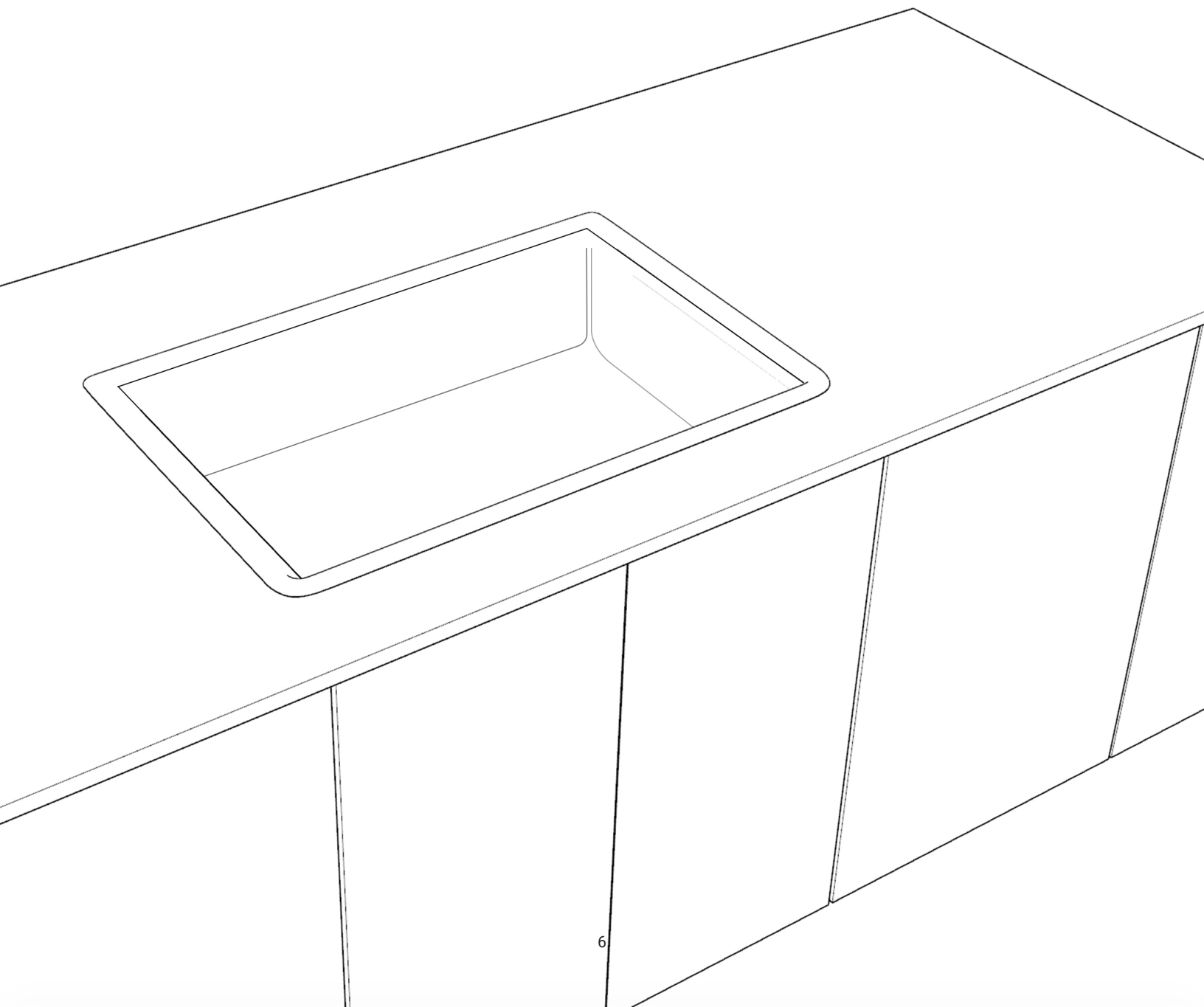

2. Undermount Sink Attached to Countertop

Compatible with *Utility Cabinets (BF-U)*, *Sink Cabinets (BF-S)* and *Grill Base Cabinets (GB)* with front panel. The sink is fixed to the countertop from under with a bead of silicone and mounting hardware (provided by sink fabricator).

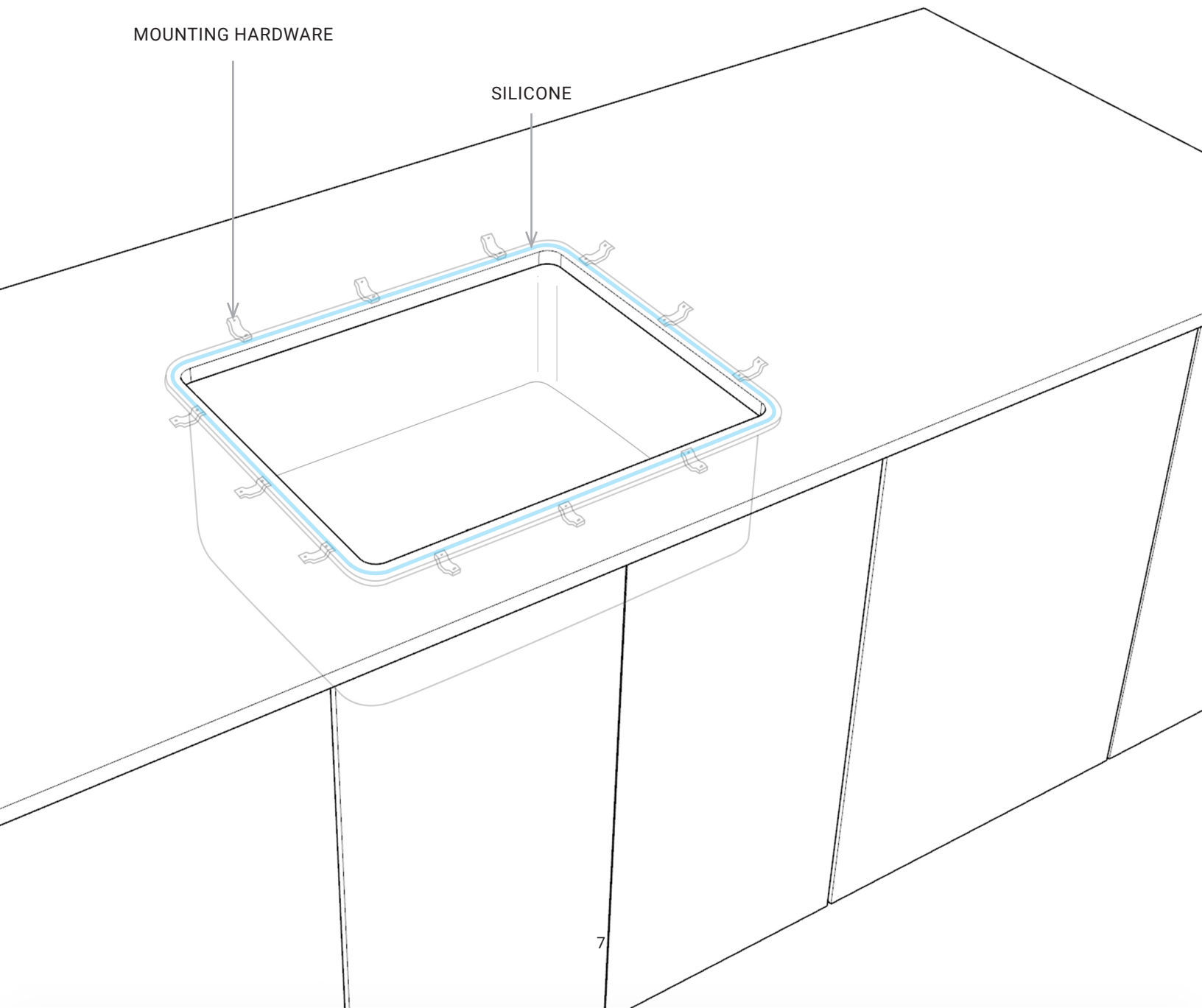

3. Farmhouse Sink Supported by the Countertop

Compatible with *Grill Base Cabinets (GB)*. The sink sits on the countertop, fully supported by the flange, and is fixed with a bead of silicone.

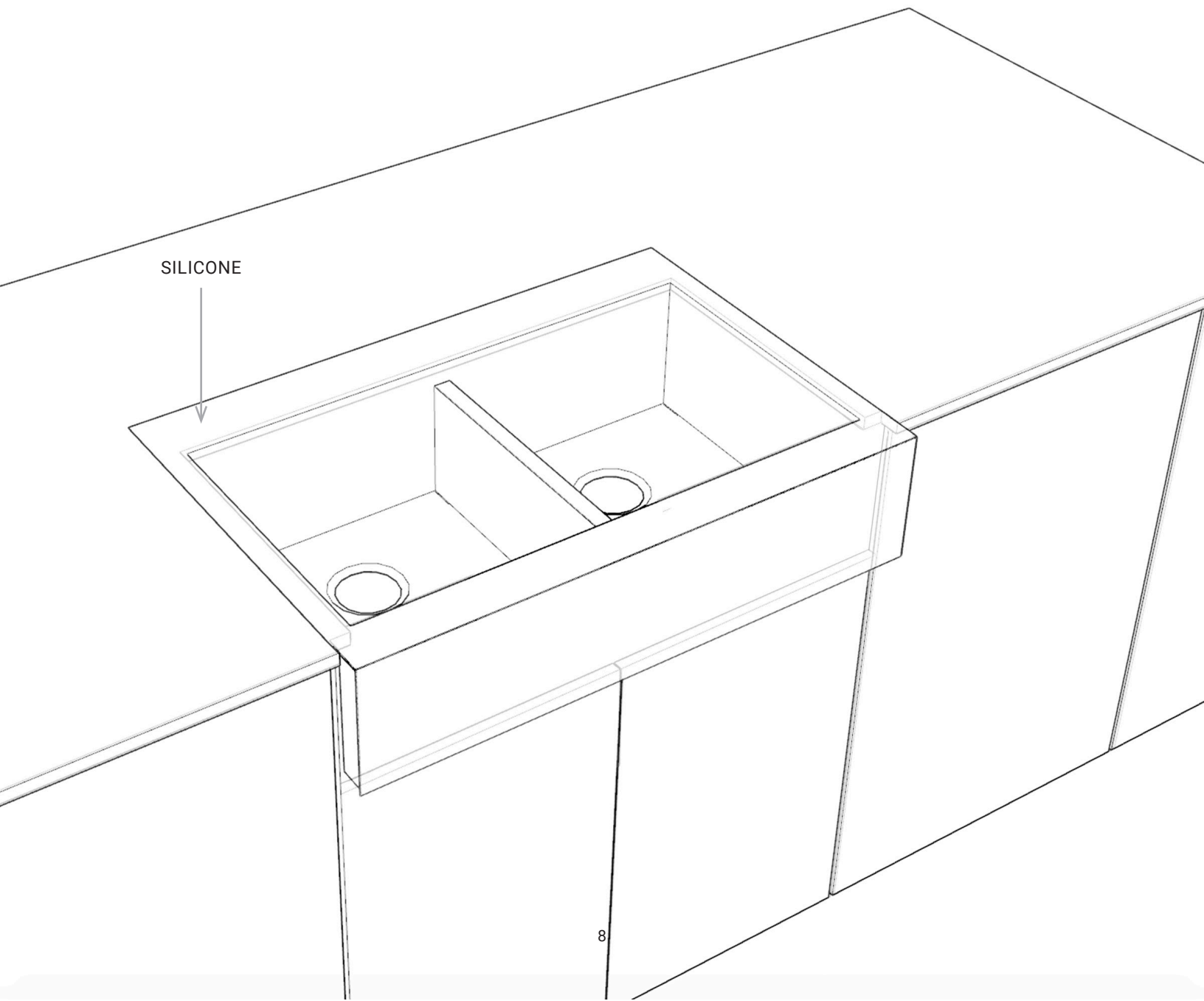

4. Undermount Sink Supported from the Bottom

Not compatible with Urban Bonfire's products. The sink needs to sit on supports from inside the cabinetry.

