

**YOU MUST READ
THE QUICK GUIDE
BEFORE YOU START**

K3R Series / DB-K015, DB-K022



For FAQs and more information, please visit:
xprousa.com/pages/support

STOP!MUST READ

PLEASE REMEMBER TO VIEW THE ASSEMBLY VIDEO BEFORE PROCEEDING!

For Assembly video and Troubleshooting Tips, please visit below link or scan the QR code below with your mobile phone. tinyurl.com/xpro210



We want to thank you for choosing us. We are committed to making sure you are happy with your purchase, so we would love to hear your experience with your new product!

Please give us a chance to make it right before you leave negative feedback. If you are not satisfied with your experience, we will do whatever needs to be done to make it right. Please visit our website for assembly guide, product maintenance, product support, replacement parts, and any other questions or concerns.

If you are missing a piece or there is shipping damage, need instructions or require help with other issues, please reach out to our customer care team by e-mailing us at support@motopro.freshdesk.com

If you have any question, please send us a video no less than 30 seconds showing the problem so that we can forward it to the manufacturer for tech support. We would also like to offer an additional 1 month warranty after receiving your video.

You can email us the video at support@motopro.freshdesk.com

Your engagement and support are our greatest motivation to provide the best customer service possible. We highly appreciate your cooperation. Hope you have a pleasant shopping experience.

Please register your warranty service by visiting our official website directly or scan the QR code below by mobile phone. Thank you and we are always here to help you!



Upon receiving your vehicle (and after reviewing the video) we recommend that you heed the following tips:

Tip 1 Helmet and Protective Gear

Never Ride without a Helmet and Protective Gear.

Helmets and Protective Gear will effectively reduce the severity of injuries in case of accident.

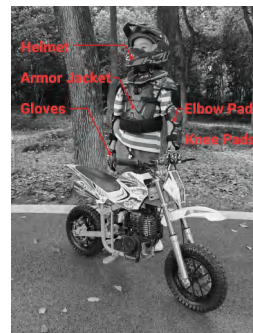

Tip 2 Gas flow

Make sure the gas tank has enough gasoline. Its better to use fresh unleaded gasoline with octane rating of 87 or above.

Check the gas lines for any leaks before riding, make sure there are no bends or knots in the tubing.

If the bike is going to be parked for some time, drain the gas and disconnect the battery.



Tip 3 Engine oil

Check engine oil level by dipstick marks, and add recommended oil to the specified level if necessary. Normally you are supposed to use 10W40 synthetic oil in the engine. However, 15W40 may be better for summer and 10W30 better for winter.

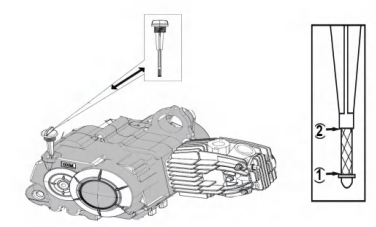

⚠ WARNING

Only add engine oil into the dipstick filler hole. Never pour engine oil anywhere else other than dipstick filler hole.

1. Minimum Oil Level Mark
2. Maximum Oil Level Mark

Tip 4 Throttle check

Make sure the throttle is working well before your ride, you can accelerate and decelerate smoothly, no sticky. Lubricate cable and lever housing if necessary.

If there is any stuck, you can adjust either throttle holder on handlebar or throttle cable connecting to carburetor.

You can control the maximum speed through the speed limiter on handlebar.

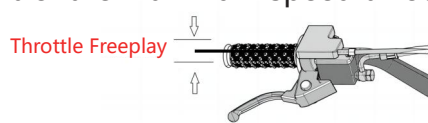

Upon receiving your vehicle (and after reviewing the video) we recommend that you heed the following tips:

Tip 5 Brake check

Check if the front brake and rear brake can work properly, no parts missing or stuck. Add brake fluid if needed.

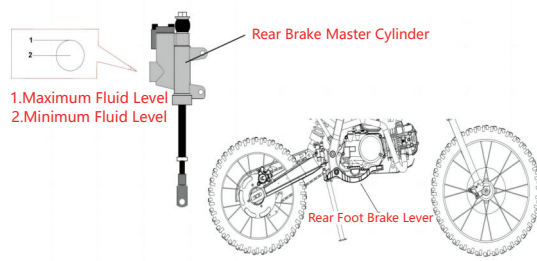
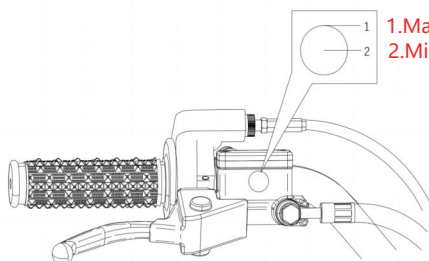

Tip 6 Wheel check

Make sure there is no air leak on wheels before your ride.
Double check if the stem valve is in good condition and to be tightened after pumping air.
Confirm if any spokes have punctured the tire or any loose.
No holes on tires and the rim is in good shape without bent.

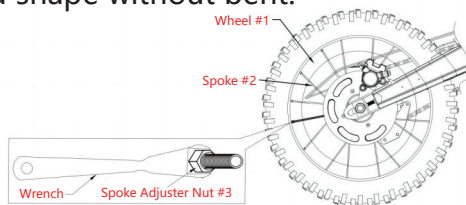

Tip 7 Mirror, horn and light check

If the model you purchased comes with lights and mirrors, please adjust the rearview mirror angles and check all lights and horn to be working. For some models, you may need to open the light switch.

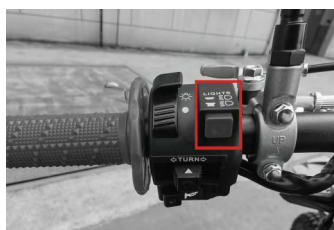

or



Tip 8 Fasteners check

Make sure that all nuts, bolts and screws are properly tightened before each ride.

