

## Required Tools

measuring  
tape

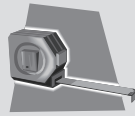

drill with  
2mm bit



phillips bit or  
screwdriver



pencil

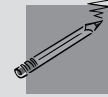

knife



## Included Hardware

The hardware can be found in the end of every box.



Installation  
Bracket



Hold Down  
Bracket



Child Safety  
Cleat



Medium & Long  
Screws for  
Wood



Wall Plugs for Brick  
or Cement using  
a 6mm bit  
(if requested)

Need HELP?

Customer Service

**1800 836 382**

"the best compliment  
you can give  
is a referral"

## 1

### Installation Brackets

#### Installing inside the window frame...

- At top of window frame, measure 70mm in from each side and 50mm back from front of window frame and mark with a pencil; this is the centre back of the outer brackets.
- Place brackets in position and mark where the 2 screws will go.
- We recommend drilling pilot holes for the screws using a 2mm bit.
- Fix the brackets into position using 2 long screws for each bracket.
- If more brackets are supplied, space them evenly between the first two brackets.

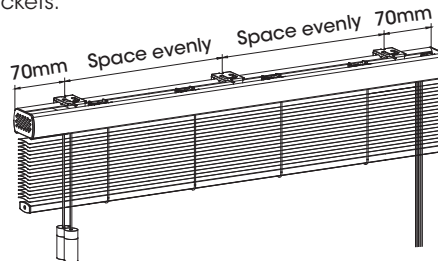
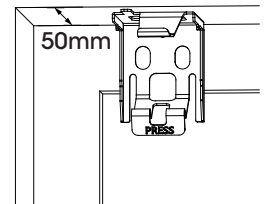

#### Installing outside the window frame...

- Measure 70mm in from top left and top right of where the blind will sit and mark with a pencil; this is the centre of where the brackets will go.
- Place brackets in position (normally flush with top of architrave) and mark where the screws will go.
- We recommend using a spirit level to align brackets if not installing on the architrave.
- We recommend drilling pilot holes for the screws using a 2mm bit.
- Fix the brackets into position using 2 long screws for each bracket.
- If more brackets are supplied, space them evenly between the first two brackets.

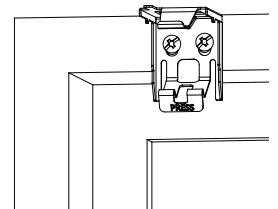

## 2

### Install Blind

- With the bottom of the blind angled slightly towards you, position the top front of the blind onto the top front lip of the brackets.
- Tilt the blind up at the back noticing it click into place.

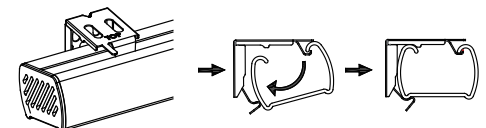
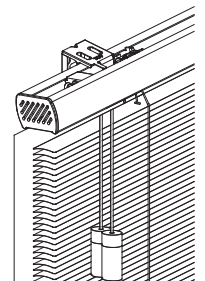

## 3

### Attach Wand (if ordered)

- Slide wand hook through eyelet on headrail.
- When wand length is longer than blind width, a connector will be used.

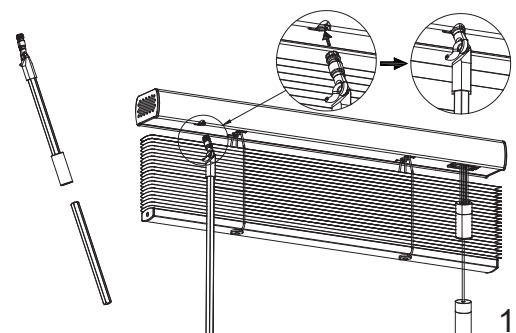

Installation continued...

## 4 Hold Down Brackets

### Installing inside the window frame...

- Position hold down bracket vertically inside window frame where the bottom rail hangs naturally, mark where the 2 screws will go.
- We recommend drilling pilot holes for the screws using a 2mm bit.
- Fix bracket into position using 2 medium screws.
- Insert bracket knob into bottom rail.
- Repeat for bracket at other end of bottom rail.

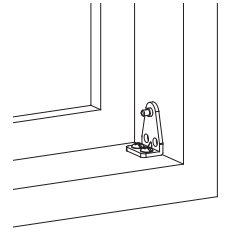

### Installing outside the window frame...

- Position hold down bracket horizontally outside window frame where the bottom rail hangs naturally, mark where the 2 screws will go.
- We recommend drilling pilot holes for the screws using a 2mm bit.
- Fix bracket into position using 2 medium screws.
- Insert bracket knob into the bottom rail.
- Repeat for bracket at other end of the bottom rail.

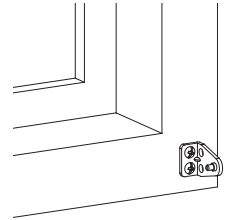

**! WARNING**  
ALL WINDOW COVERINGS WITH CORD OR CHAIN

To avoid creating a possible strangulation hazard for children, the corded or chained internal window covering must be installed in such a way that a loose cord or chain cannot form a loop 220 mm or longer at a height of less than 1600 mm above floor level.

- A cord/chain guide may be installed lower than 1600mm above floor level if the cord/chain is sufficiently secured or tensioned to prevent a loop 220 mm or longer from being formed.
- If a cord/chain guide is installed lower than 1600 mm above floor level, it must be designed to prevent a child from being able to remove the cord/chain.
- If a cleat is used to secure the cord, it must be at least 1600 mm above floor level because a child is capable of unwinding a cord from a cleat.

<https://venetablinds.com.au/pages/child-safety>

## 5 Child Safety Cleat

- Attach the Child Safety Cleats to the wall at least 1.6 metres off the ground using 2 medium screws for each cleat. Ensure the cleat is fixed firmly.
- Tie all the loose lift cord around the Child Safety Cleat at all times.

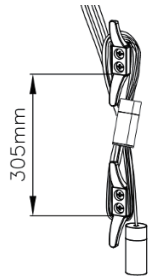

Great Job... Enjoy your new Veneta Blinds!

## Operating your Blind

- Tilt the slats by using the twin cords or the wand.
- Raise or lower your blind with the lift cord.
- Pull the cord down and to the centre of blind to unlock, then move to desired position.
- Move cord to the outside of blind to lock into position and release.

## Feedback?

We would love to know how you went with your installation...

Please write a review on our website at...

[www.venetablinds.com.au](http://www.venetablinds.com.au)

## Maintaining your Blind

- Dust can be removed using a feather duster or vacuum with brush attachment on low suction.
- Clean your Aluminium Venetians using a warm damp cloth. Do not use solvents or chemicals.

- If the **Safety Tassel** happens to break apart, simply gather the cords without twisting and place into the slot as per diagram. Close the cord release door and pull the cords to make sure the Tassel is closed tightly.

