

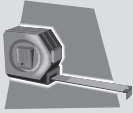





Required Tools	measuring tape	drill with 2mm bit	phillips bit or screwdriver	pencil	knife
					

Included Hardware

The hardware can be found in the end of every box.

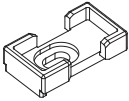
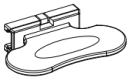
	Shoe Base (For Headrail and Bottom Rail)
	Shoe Slider (Attached to blind)
	Installation L Bracket (Outside Install)
	Magnet Catch (for larger blinds)
	Handle
	Short Bolt
	Short, Medium & Long Screws for Wood
	Wall Plugs for Brick or Cement using a 6mm bit (if requested)
	Extension Pole (if requested)

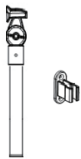
1 Installation Brackets



Installing inside the window frame...

- At top and bottom of window frame measure 12mm in from each end and 20mm back from the front of window frame and mark where the screws will go.
- We recommend drilling pilot holes for the screws using a 2mm bit.
- Fix the Shoe Bases into position using 1 medium screw for each Shoe ensuring the outer edge is to the outside of the window.

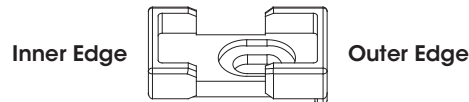

Installing outside the window frame...

- We recommend using a spirit level for vertical and horizontal alignment.
- Place the blind in position and mark the top corners of the blind.
- Measure 9mm in from the top corners and mark the location of the L bracket outer screws. Make sure to keep minimum distance between the edge of L bracket and the top/bottom window frame $\geq 9\text{mm}$.
- Meanwhile, it is also essential to assure the distance between the top / bottom of the shade to the edge of bottom / top of the L bracket equals shade drop subtracts 23mm.
- Place L Brackets in position and mark where the other screws will go.
- We recommend drilling pilot holes for the screws using a 2mm bit.
- Fix the L Brackets into position using 2 long screws for each bracket.
- Fix the Shoe Bases onto the L Brackets using 1 Short Bolt for each shoe, ensuring the outer edge is to the outside of the window.

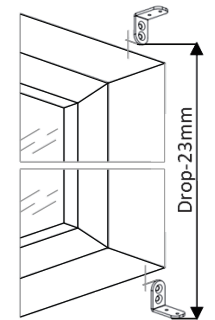
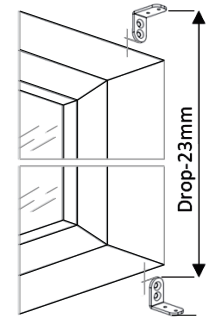

2 Install Magnet Catches (if supplied)

- On the top of the blind (top rail) note the measurements from the left of blind to each magnet.

Installing inside the window frame...

- At the top of the window frame measure from the left of Shoe Base and mark the same measurements on window frame. Place magnet catch in position and mark the screw hole with a pencil, keep the screw hole minimum 23mm from the edge of the window frame and align with the end shoe bases.
- We recommend drilling pilot holes for the screws using a 2mm bit.
- Fix the magnet catches into position using 1 short screw per catch.

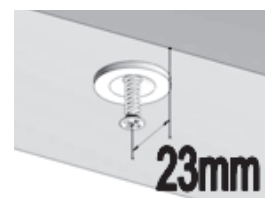

Installing outside the window frame...

- At the top of the architrave (or where blind will be positioned) measure from the left of Shoe Base and mark the same measurements on the architrave. Position the L Bracket to line up with the magnets at the top of the blind and mark the screw holes with a pencil.
- We recommend drilling pilot holes for the screws using a 2mm bit.
- Fix the L Brackets into position using 2 long screws per bracket.

Installation continued...

3 Attach Handle

- Attach the handle to the handle support pre-attached on the rail then slide against the handle support to the left until the handle can't move anymore.

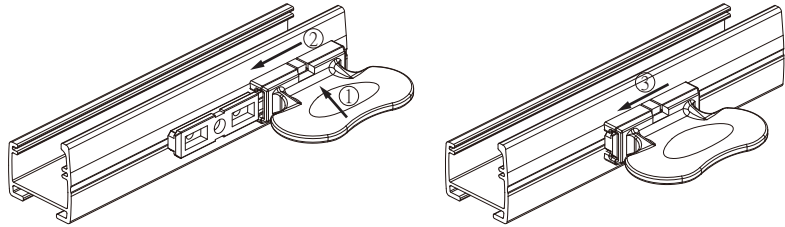

4 Install Blind

- When installing the Shoe Slider, it is suggested to secure the bottom shoe slider first, and then unfasten the top cord to secure the top shoe slider. Please do NOT untie the top cord until the bottom shoe slider is secured.
- Please note all blind cords are interconnected.
- Ensure the cords are not crossed or tangled.
- Place Shoe Sliders into centre of Shoe Bases and slide towards the outer edge of Shoe as per diagram to the right.

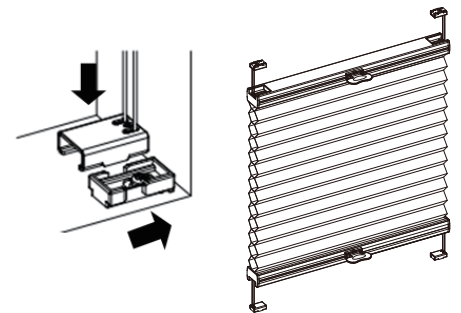

Great Job... Enjoy your new Veneta Blinds!

Operating your Blind

- Lower and raise the blind using the handles on the top and bottom rails.
- Note the blind will close firmly at the top utilising the inbuilt magnets.

Maintaining your Blind

1 Dusting

- Dust can be removed using a feather duster or vacuum with brush attachment on low suction.

Feedback?

We would love to know how you went with your installation...

Please write a review on our website at...

www.venetablinds.com.au

2 Spot Cleaning

- Use a warm damp cloth or a mild detergent for tougher stains.
- Dab the affected area, but do not rub the fabric. Finish with just a warm damp cloth.
- Allow the fabric to dry in the lowered position.

3 Ultrasonic

- If ultrasonically cleaning the blind please specify that a mild solution must be used.
- Note the rails should never be immersed in liquid.