



Round Flat Bollards

L70
25°C **147,000 Hours**



Glass
NHL-RBFP



LED Cone Reflector
Shown with Glare Shield
NHL-RBFC



Louvers
NHL-RBFIL

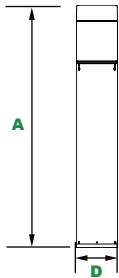

Dimensions	
Diameter (D)	7" (178mm)
Height (A)	41 1/2" (1,057mm)

The Round Flat LED Bollards with choice of optics are designed to replace HID lighting systems up to 70w MH or HPS. These fixtures are ideal for retail centers, industrial parks, schools and universities, public transit and airports, office buildings and medical facilities.

Specifications and Features:

Housing:

Extruded Aluminum Housing with Flush Mounting Base & Vandal-Resistant Screws, Flat Top, Internal Ballast Tray for Easy Maintenance. Bollards Can Be Cut to Custom Lengths Upon Request.

Listing & Ratings:

CSA: Listed for Wet Locations, ANSI/UL 1598, 8750
IP65 Sealed LED Compartment.

Finish:

Textured Architectural Bronze or Black Powdercoat Finish Over a Chromate Conversion Coating. Custom Colors Available Upon Request.

Style:

Clear Prismatic Borosilicate Glass Refractor, Specially Designed Aluminum Cone Reflector or Internal Louvers

Lens:

Clear Polycarbonate Vandal-Resistant Lens

Mounting Options:

Mounting Kit with 8" Anchor Bolts, Included.

Wattage:

Array: 14.5w, System: 17w; (70w HID Equivalent)

Driver:

Electronic Driver, 120-277V, 50/60Hz or 347V, 50/60Hz; Less Than 20% THD and PF>0.90. Standard Internal Surge Protection 2kV. 0-10V Dimming Standard for a Dimming Range of 100% to 10%; Dimming Source Current is 150 Microamps.

Warranty:

5-Year Warranty for -40°C to +40°C Environment.

See Page 2 for Projected Lumen Maintenance Table.

Order Information Example: NHL-RBFC-15W-50K-UNV-Z

Model	Optics	Wattage	CCT	Voltage	Color	Height	Options
NHL-RBFP=Round Flat Top Bollard with Glass NHL-RBFC=Round Flat Top Bollard with LED Cone Reflector NHL-RBFIL=Round Flat Top Bollard with Louvers	C=Type III* F=Wide Beam Spread **RBFP and RBFC only	15W=15w	30K=3000K 40K=4000K 50K=5000K	UNV=120-277V	Z=Bronze B=Black CC=Custom (Consult Factory)	(Leave Blank)= 42" Standard Height 36=36" Height 30=30" Height	SF=Single Fuse DF=Double Fuse SP=Surge Protection GF1=GFCI Outlet, 15A, 120V GS=180° Glare Shield, Black GS=180° Glare Shield, Bronze GS=180° Glare Shield, Custom Color, Consult Factory EM=Battery Backup, 90 Minutes

Project Information:

Project Name: _____ Fixture Type: _____
 Complete Catalog #: _____ Date: _____
 Comments: _____

Certification & Listings:



Specifications subject to change without notice. Rev. 031819

Accessories & Replacement Parts:

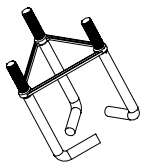

NHL-BOLAN

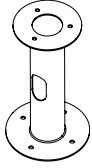

NHL-BOLRM



NHL-BREBASE*



NHL-BOLPC

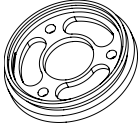

NHL-BORBASE



NHL-BOADP1

*Shown Mounted

Mounting Accessories (Order Separately, Field Installed)

BOLAN4 Mounting Kit, Includes Bracket & Three (3) 4" Anchor Bolts

BOLAN8 Mounting Kit, Includes Bracket & Three (3) 8" Anchor Bolts

BOLAN12 Mounting Kit, Includes Bracket & Three (3) 12" Anchor Bolts

BOLAN15 Mounting Kit, Includes Bracket & Three (3) 15" Anchor Bolts

BOLRM Root Mount Kit

BREBASE* Bollard Retrofit Base Kit Adapts New Bollards to Most Existing Bolt Patterns. Fits all LEPG Bollards. Die Cast with Powdercoat Finish, Hardware Included. 1 1/2" Dia. x 1 1/2" H

*Specify Color: Z=Bronze, B=Black, C=Custom (Consult Factory)

Replacement Parts (Order Separately, Field Installed)

BOLPC Replacement Round Polycarbonate Vandal-Resistant Lens

BORBASE* Die Cast Base Plate with Powdercoat Finish Over a Chromate Conversion Coating.

BOADP1 Adapter Plate with Gaskets for Outlet Boxes. Fits LEPG Round Bollards. Die Cast with Bronze Powdercoat Finish.

*Specify Color: Z=Bronze, B=Black

For Replacement Battery Backup, see the LEPG LED Battery Backup Specification Sheet.

Photometric Data

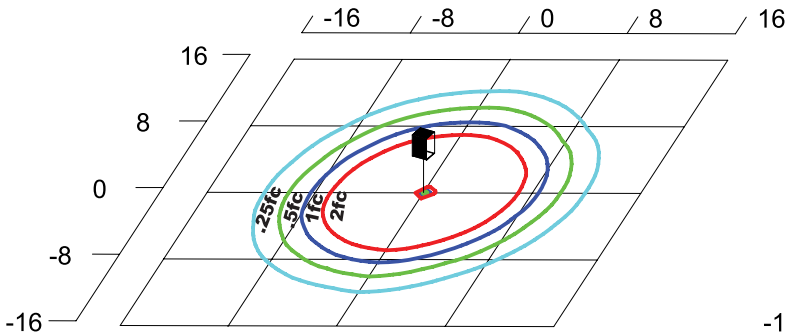

NHL-RBFP-F-15W-50K-UNV
Type V
Grid in feet, Mounting Height = 3.5 ft.

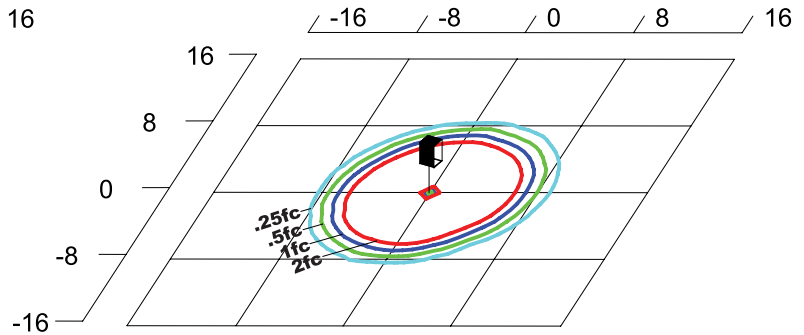

NHL-RBFC-F-15W-50L-UNV
Type V
Grid in feet, Mounting Height = 3.5 ft.

Photometric Performance

LED Board Watts	Drive Current (mA)	Input Watts	Optics	5000 CCT 80 CRI					4000 CCT 80 CRI					3000 CCT 80 CRI				
				Lumens	LPW	B	U	G	Lumens	LPW	B	U	G	Lumens	LPW	B	U	G
LED 15W	116	17	NHL-RBFP Glass	1,125	66	1	3	1	1,080	64	1	3	1	905	53	1	3	1
			NHL-RBFIL Louvers	778	46	1	2	1	747	44	1	2	1	689	41	1	2	1
			NHL-RBFC Cone Reflector	1,519	89	1	3	1	1,458	86	1	3	1	1,225	72	1	3	1
			NHL-RBFC Type III Optic	1,081	64	0	3	1	989	58	0	2	1	918	54	0	2	1

Projected Lumen Maintenance

Data shown for 5000 CCT			Compare to MH			
TM-21-11	Input Watts	Initial	25,000 Hrs	50,000 Hrs	100,000 Hrs	Calculated L70@ 25°C
L70 Lumen Maintenance @ 25°C / 77°F	17	1.00	0.95	0.90	0.80	147,000
Data shown for 50°C			Compare to MH			
TM-21-11	Input Watts	Initial	25,000 Hrs	50,000 Hrs	100,000 Hrs	Calculated L70@ 50°C
L70 Lumen Maintenance @ 50°C / 122°F	17	1.00	0.89	0.78	0.55	67,000
Data shown for 40°C			Compare to MH			
TM-21-11	Input Watts	Initial	25,000 Hrs	50,000 Hrs	100,000 Hrs	Calculated L80@ 40°C
L80 Lumen Maintenance @ 40°C / 104°F	17	1.00	0.92	0.85	0.70	66,000

NOTES:

1. Projected per IESNA TM-21-11. Data references the extrapolated performance projections for the 116mA base model in a 25°C ambient, based on 10,000 hours of LED testing per IESNA LM-80-08.
2. Compare to MH box indicates suggested Light Loss Factor (LLF) to be used when comparing to Metal Halide (MH) systems.

Specifications subject to change without notice. Rev. 031819