

## NHL-GNVP53AS

The NHL-GNVP53AS Vaporproof Gooseneck Angled Shade LEDlight luminaire is available with 5 Gooseneck arms of various lengths and is designed to replace HID lighting systems up to 175w MH or HPS. This vapor resistant fixture can withstand extreme physical and environmental abuse and is ideal for retail centers, industrial parks, schools and universities, public transit and airports, office buildings and medical facilities. Designed for architectural wall mounting up to heights of 20 feet based on light level and uniformity requirements.

### GNVP53AS Specifications and Features:

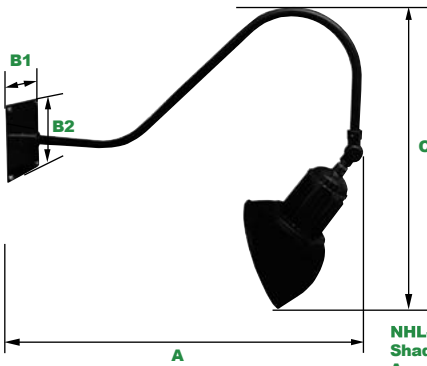

NHL-GNVP53AS with Angled Shade Shown with GNA01336 Arm and Black Color

#### Dimensions

Base Length (B1)	8" (203mm)
Base Height (B2)	8" (203mm)
Length (A)	41" (1044mm)
Height (C)	31" (787mm)

**See Page 2 for  
Fixture and Arm  
Dimensions**

### Step 1:

#### Order Information Example:

NHL-GNVP53AS-F-23W-50K-UNV-B-GNS-DF

GNVP53AS	F	23		U			
Model	Optics	Wattage	CCT	Voltage	Color	Mounting	Options
NHL-GNVP53AS= Pendant Mount Vaporproof	F=Type V	23W=23w	40K=4000K 50K=5000K	UNV= 120-277V	B=Black, RAL9011 P=Platinum, RAL9006 R=Red, RAL3020 W=White, RAL9016 CC=Custom (Consult Factory)	GNF=Fixed Downlight, Includes 72" of Wire for Arm Feed Through to Wall Box GNS=Adjustable Swivel Includes 72" of Wire for Arm Feed Through to Wall Box	SF=Single Fuse DF=Double Fuse

#### EasyLED LED:

Aluminum Boards

#### Wattage:

Array: 23w, System: 27w (175w HID Equivalent)

#### Driver:

Electronic Driver, 120-277V, 50/60Hz; Less Than 20% THD and PF>0.90. Standard Internal Surge Protection 2kV. 0-10V Dimming Standard for a Dimming Range of 100% to 10%; Dimming Source Current is 150 Microamps.

#### Warranty:

5-Year Warranty for -40°C to +50°C Environment.

See Page 3 for Projected Lumen Maintenance Table.

**L70**  
25°C

**187,000 Hours**

### Gooseneck Arm Specifications and Features:

#### Construction:

Heavy-Duty 3/4" Aluminum Arms with 3/4" NPS Threads on Fixture Mounting End.

#### Finish:

Powdercoat Finish Over a Chromate Conversion Coating. Custom Colors Available Upon Request.

#### Mounting Options:

Mount with 3/4" Square or Round Mounting Plates.

### Step 2:

#### Select Arm

#### Order Information Example:

GNA01336BS

Model	Length	Color	Mounting
GNA013 - Classic Hook	36=36" 30=30"	B=Black, RAL9011 P=Platinum, RAL9006 R=Red, RAL3020 W=White, RAL9016 CC=Custom (Consult Factory)	S=Square Oversized Wall Mount R=Round Wall Mount N=No Wall Mount
GNA023 - Straight	30=30" 24=24" 18=18" 12=12"		
GNA033 - Straight Offset	30=30" 24=24"		
GNA043 - Straight Rise	30=30"		
GNA053 - Round Hook	30=30" 24=24" 18=18"		

### Step 3:

#### Select Shade

#### Order Information Example:

VS30AB

Model	Color
VS30A=Angled Shade	B=Black, RAL9011 P=Platinum, RAL9006 R=Red, RAL3020

W=White, RAL9016  
CC=Custom (Consult Factory)

#### Specification Guide:

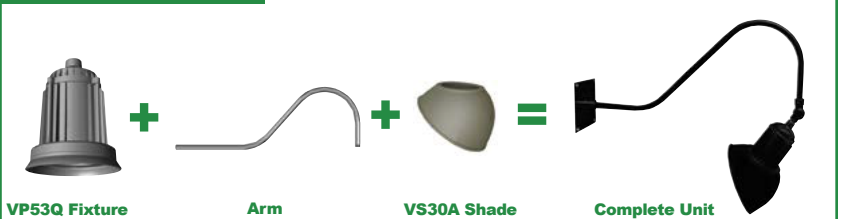

#### Project Information:

Project Name:

Fixture Type:

Complete Catalog #:

Date:

Comments:

#### Certification & Listings:



Specifications subject to change without notice. Rev. 060418

# Gooseneck LEDlights

## NHL-GNVP53AS

### Accessories & Replacement Parts



VS30A

#### Replacement Parts (Order separately, Field installed)

VS30A\* Angled Aluminum Shade, Powdercoat Finish

\*Specify Color: B=Black, P=Platinum, R=Red, W=White, C=Custom (Consult Factory)

### VP53Q Dimensions



LEDicated  
Vaporproof

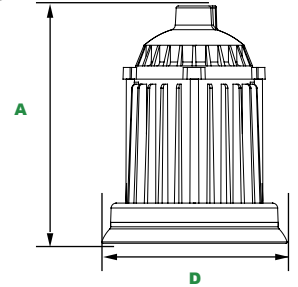

### Wall Plate Dimensions

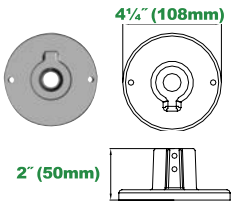

2" (50mm)

4 1/4" (108mm)

GNRMP3



1 3/4" (46mm)

GNSMP3

8" (203mm)

#### Replacement Wall Plates (Order separately, Field installed)

GNRMP3\* Round Wall Mount Plate, Powdercoat Finish.

GNSMP3\* Square Oversized Wall Mount Plate, Powdercoat Finish.

\*Specify Color: B=Black, P=Platinum, R=Red, W=White, C=Custom (Consult Factory)

### Dimensions

Diameter (D) 7 1/4" (184mm)  
Height (A) 9 1/4" (235mm)

### Gooseneck Dimensions

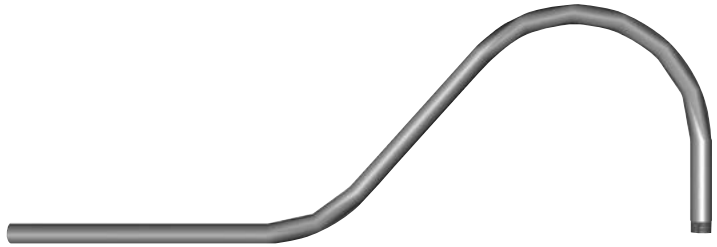

36" (915mm)

30" (762mm)

12" (305mm)

GNA01336P Classic Hook



30" (762mm)

24" (609mm)

6" (152mm)

GNA03330P Straight Offset



30" (762mm)

6" (152mm)

GNA04330P Straight Rise



30" (762mm)

24" (609mm)

18" (456mm)

8 1/2" (218mm)

GNA05336P Round Hook

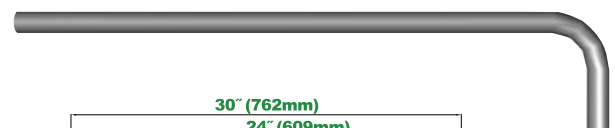

30" (762mm)

24" (609mm)

18" (456mm)

12" (304mm)

6" (152mm)

GNA02330P Straight

Specifications subject to change without notice. Rev. 103017



# Gooseneck LEDlights

## NHL-GNVP53AS

### Photometric Data

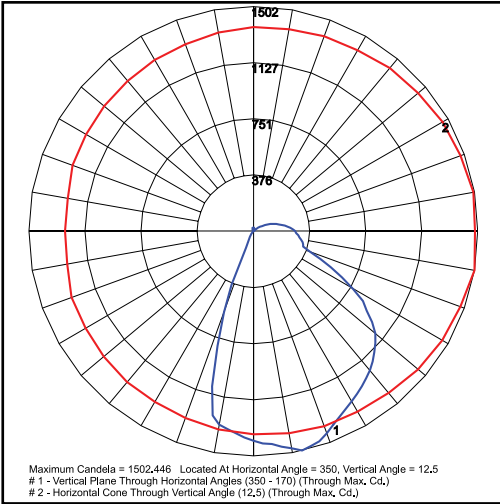

NHL-GNVP53AS-F-23W-50K-UNV  
Type V, Angled Shade  
Grid in MH  
MH=10 Feet

### Photometric Performance

LED Board Watts	Drive Current (mA)	Input Watts	Optics	5000 CCT 80 CRI					4000 CCT 80 CRI				
				Lumens	LPW	B	U	G	Lumens	LPW	B	U	G
LED 23w	116	27	Type V	2,741	102	1	3	2	2,508	93	1	3	1

### Projected Lumen Maintenance

Data shown for 5000 CCT	Compare to MH						
	TM-21-11	Input Watts	Initial	25,000 Hrs	50,000 Hrs	100,000 Hrs	Calculated L70@ 25°C
L70 Lumen Maintenance @ 25°C / 77°F	TM-21-11	27	1.00	0.96	0.92	0.84	187,000
L70 Lumen Maintenance @ 50°C / 122°F	TM-21-11	27	1.00	0.93	0.86	0.72	107,000
L80 Lumen Maintenance @ 40°C / 104°F	TM-21-11	27	1.00	0.94	0.88	0.76	82,000

**NOTES:**

1. Projected per IESNA TM-21-11. Data references the extrapolated performance projections for the 116mA base model in a 25°C ambient, based on 10,000 hours of LED testing per IESNA LM-80-08.
2. Compare to MH box indicates suggested Light Loss Factor (LLF) to be used when comparing to Metal Halide (MH) systems.

Specifications subject to change without notice. Rev. 020818