

## CHARACTERISTICS

- 20% less weight than that of a shower tray of the same thickness made of polyester resin.
- Anti-slip finish: class III (testing method: UNE-ENV 12633: 2003).
- Anti-bacteria and fungistatic properties.
- Installation available either on top of floor level or flush with floor.
- Totally flat on the underneath.
- 100% waterproof, does not require membrane coating.
- Easy installation using silicone, polyurethane putty or MS.
- Ultraviolet (UV) protection.
- Easy to repair.
- **2 year manufacturer's guarantee**

## MAINTENANCE

Follow these simple recommendations and you can enjoy your shower tray for many years to come.

For routine cleaning (after showering) simply rinse the tray with water and ensure that there is sufficient ventilation in the bathroom. For thorough cleaning, rinse the tray with water and any commercial product available for bathroom cleaning on the market and clean using a cloth or a non-abrasive sponge. It is advisable to avoid the use of cleaning or disinfecting products which contain alcohol. Abrasive products (e.g. scourers) are not suitable either as they may damage the shower tray surface.

In terms of maintenance, a descalant product in the form of a spray for cleaning shower screens can be used; these products should be applied to the tray and then rinsed. The use of these products is especially advisable in areas with very hard water (with a lot of lime).

## INCLUDED

- Shower tray
- Stainless steel grate
- Essential waste
- Assembly instructions
- Cardboard box

## PACKAGING

- Individually packaged in high-resistance box.
- Cardboard box with a plywood perimetral frame, adapted to the dimensions of each tray, with a screw-on lid to make it easier to open once it reaches its destination.

## COLOURS

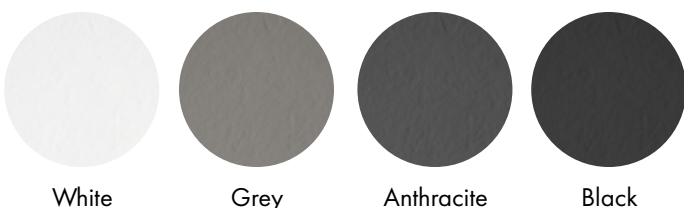

White

Grey

Anthracite

Black

## TEXTURE

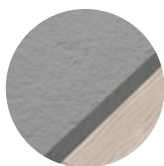

Full bodied texture with anti-bacteria and fungistatic properties.

## DIMENSIONS (see page 2)

Width: from 700 to 900 mm  
Length: from 800 to 2000 mm  
Thickness: 30 mm

## MATERIALS

**Tray:** Polyurethane resin and other minerals.  
**Grate:** Stainless steel finish.  
**Waste:** PVC plastic

## GRATES



Supplied with polished stainless steel grill (as standard)  
Colour matched grills (Available at an additional cost)

## SHOWER TRAY DIMENSIONS

SECTION A

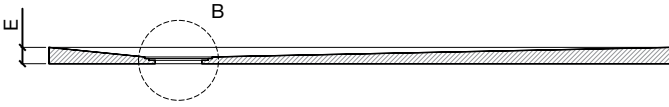

DETAIL B

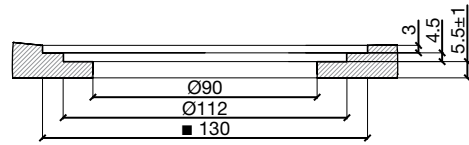

TOP VIEW

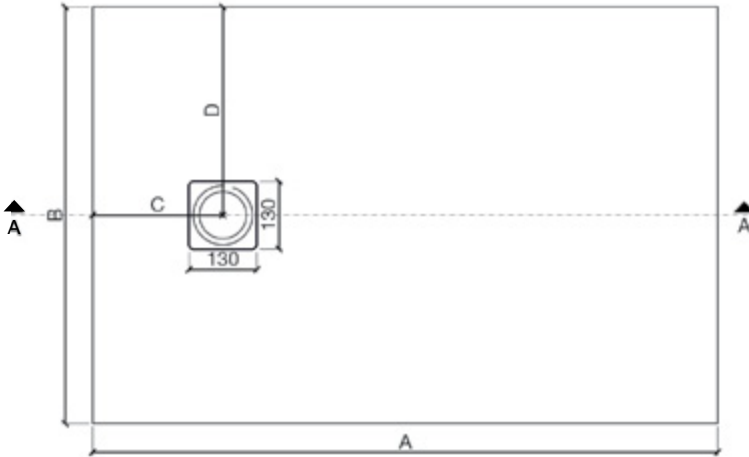

ESSENTIAL WASTE DIMENSIONS

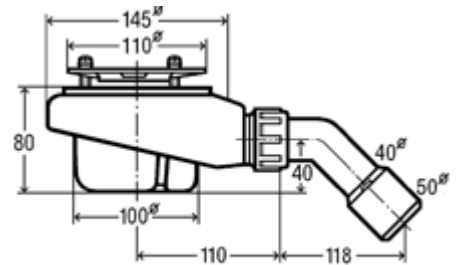

GRATE

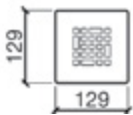

AVAILABLE MOULDS (measurements in mm)						
A	B	C	D	E		
900	700	200	350	25		
1000				250	27	
1100					300	28
1200		600				30
1300				26		
1400				28		
1500				29		
1600				31		
1700				32		
1800		34				
1900		800		200	400	23
2000						250
800	300		28			
1000			600	30		
1100				26		
1200	28					
1300	29					
1400	31					
1500	32					
1600	34					

AVAILABLE MOULDS (measurements in mm)						
A	B	C	D	E		
900	900	200	450	25		
1000				250	27	
1100					300	28
1200		600				30
1300				26		
1400				28		
1500				29		
1600				31		
1700				32		
1800		34				
1900		800		200	400	23
2000						250
800	300		28			
1000			600	30		
1100				26		
1200	28					
1300	29					
1400	31					
1500	32					
1600	34					

Approximate measurements, tolerance 5 mm.  
This tolerance may be modified without prior warning.