

UniSlope® 1K | 2K

Installation Instructions

1K UniSlope Kit



2K UniSlope Kit



Installation on wooden floor - Page 5
Installation on concrete floor - Page 6



Installation Videos

www.wetroommaterials.com and [YouTube](https://www.youtube.com)

Technical Support

UK: +44 (0) 1332 840 820 IRL: + 353 (0) 1 2973488



EN 1253



Quick Guide to Essentials

Drain and Sub floor

- Drain must be completely level and the 45 degree drain flange must sit on the subfloor.
- Drain must be secured to the wall using the screws supplied. They must be rust resistant screws.
- If very small tiles are being used it may be beneficial to increase the gradient of the fall to aid water traveling to the drain. This can be done by ensuring there is a slope on the sub floor or can be done at the point of tiling but reducing tile adhesive thickness as you tile closer to the drain.

Waterproofing

- All first fix plumbing must be in place and no voids allowed. All gaps must be filled.
- No moisture can be present in the walls or floor.
- Any floor pipework must be in a fixed set position. (ie. Radiator pipes)
- Use a degreasing agent on the metal flanges of the drain before waterproofing.
- Clean area thoroughly and ensure walls, floor and drain are free from dirt and dust.
- Always test the waterproofing prior to tiling. We recommend plugging drain and floor the area for 24 hours.
- It is highly recommend that the shower walls are waterproofed 2200mm high or above the shower head and the remaining bathroom floor with 100mm up all walls.

**No access to the area until waterproofing is completely dry
Floor must be protected with a sheet once dry**

Tiling

- Tile the walls first if you are not using a frame e.g. Highline Custom. If the drain cover does have a frame e.g. Highline Panel or a frame and grate option, then tile the floor first starting from the frame.
- A full bed of tile adhesive must be used under all tiles in the wet room. There should not be any voids under tiles.
- Use LIP Construction Glue to bond the tile to the panel or cassette. The construction glue must have a full and even bed of glue and not dotted with gaps.

Watch Installation Video



Installation Videos

www.wetroommaterials.com and [YouTube](https://www.youtube.com)

Technical Support

UK: +44 (0) 1332 840 820 IRL: + 353 (0) 1 2973488

Installation Instructions

Before installing

Watch the step by step installation videos - Ensure the drain and boards can fit into the wet room area

Important

Read all the pages of these instructions fully and thoroughly before you commence installation and keep in a safe location for future reference.

Plumbing

All plumbing works should be carried out by a fully qualified professional plumber. Use the adapter to connect the outlet to pipework.

Sub Floor

It is important that UniSlope is installed onto a strong, level, stable floor. Movement could affect the performance of your wet room. UniSlope is not load bearing, the sub floor must be able to support required weight.

Checklist/Safety Notes

- Check you have all components before installation. If you do not have all the components, do not install and contact your retailer.
- Check all the contents for damage. If any parts are damaged, do not install and contact your retailer.
- Use a spirit level to check that the sub-floor is level prior to installation.
- The linear drain must be installed flat and horizontal.
- Check the location of pipes, electrical cables and all other services prior to drilling, cutting and screwing into walls, ceilings and floors.
- Use drywall screws to fix the UniSlope to the floor.
- Ensure your tools for installation are fit for purpose and follow manufacturer's instructions provided with the tools.
- The area / room must be clean, dust free with first fix plumbing and electrics in place prior to applying the LIP waterproofing membrane.
- The LIP waterproofing membrane should be applied to at least the Main Drain Body, UniSlope Board, shower walls and 500mm outside the shower area. Area's that are not tanked will not be waterproofed.
- Always ensure that the Installation area is kept safe, especially from children and pets.
- Safety goggles and masks should be worn at all times.

Liability

The Manufacturer will not accept any liability for failure if the UniSlope has been installed incorrectly and with disregard to the instructions.

New Outlet

Check both pipes are capped inside. Knock out cap for pipe required - **DO NOT USE A DRILL**

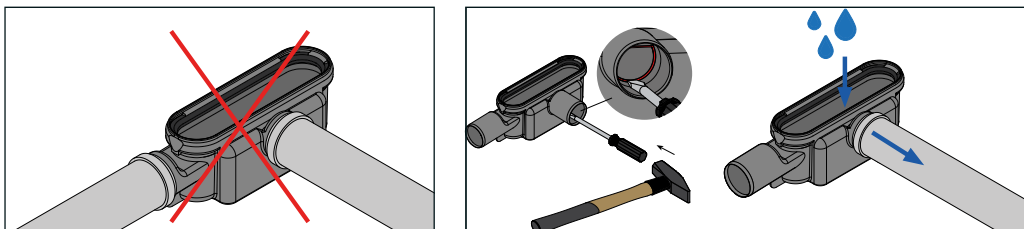

Kit Components

Kit contents will vary depending on what system has been purchased
 Larger UniSlope kits will have multiple UniSlope boards and Extension Boards

1 – Example of Wall Mounted Linear Drain



2- Unislope Boards and end fillers

Cut to suit wet room dimensions

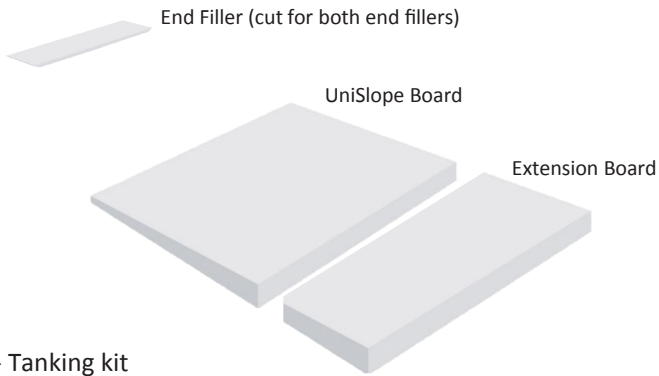

3 - Tanking kit



Liquid Membrane, Primer and Reinforcement Tape

Optional Installation Products

Approved and recommended for UniSlope

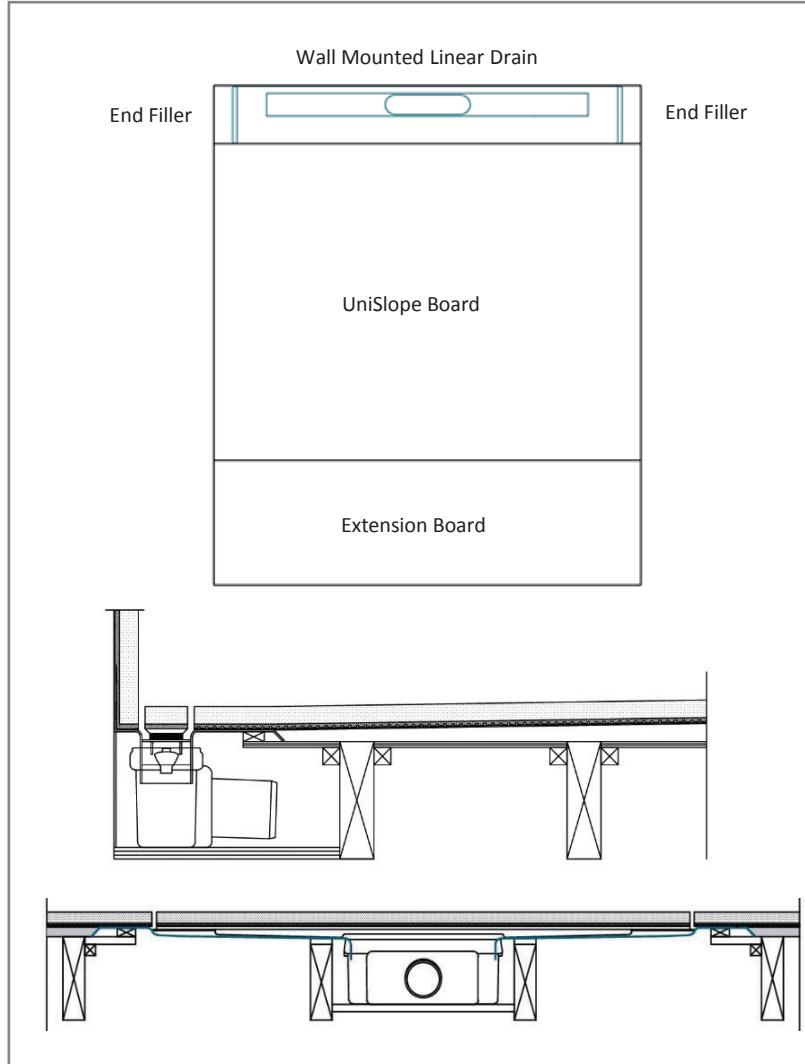

Larger UniSlope Kit Example

Larger UniSlope kit with multiple UniSlope and extension boards

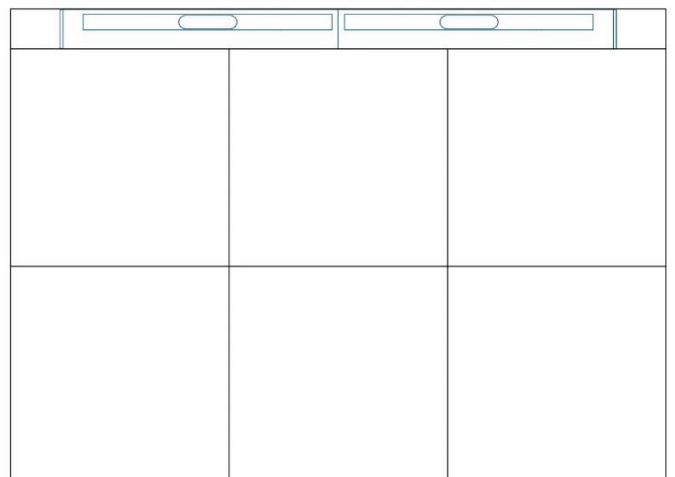

Drain and UniSlope Installation – Wooden Floor

Drain Assembly - New Outlet - See Page 3



Remove the trap from the top of the outlet.



Grease the rubber seal of the outlet.



Place outlet onto the main drain body and clip into position.



Attach push fit adapter into the outlet. Cut three battens to size.



Apply glue to the battens.



Place onto the bottom of the main drain body.

Drain Installation



Mark and cut out the wet room area.



Install battens between the joists.



Screw drain to wall using screws supplied and connect pipework.

Note: Ensure the drain is at the correct height to accommodate the gradient in the floor.

You may need to notch out a few millimetres from the top of the joists to accommodate the drain's internal drainage.

UniSlope Installation



Cut the ply wood and place on top of the battens between the joists.

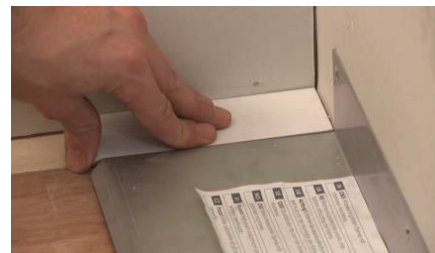

Place the UniSlope boards and end fillers into position.



Screw the UniSlope board and end fillers into position using dry wall screws.

Note: UniSlope boards can be cut down to the size required. Do not cut the board where it meets the drain.

Drain and UniSlope Installation – Concrete Floor

Recommended Installation Products



LIP 226 Screed



LIP Wet Room Adhesive

Drain Assembly - New Outlet - See Page 3



Remove the trap from the top of the outlet.



Grease the rubber seal of the outlet.



Place outlet onto the main drain body and clip into position. Attach push fit adapter into the outlet.

Drain Installation



Place drain into position ensuring it is level.



Screw drain to wall using screws supplied and connect pipework.



Pack the outlet and underside of the drain with screed making sure there are no air pockets.

Note: Ensure that the drain is at the correct height so it will not be higher/lower than the UniSlope board.

UniSlope Installation



Level the floor with screed taking into account the thickness of the UniSlope Board plus 2mm of tile adhesive.



Apply a 1-2mm bed of tile adhesive evenly onto the floor.



Place the UniSlope board and end fillers into position and screw down.

Note: Ensure the screed is completely dry before proceeding and place heavy items on top of the UniSlope board and allow for the adhesive to dry.

Kit Components

Kit contents will vary depending on what system has been purchased

1- Example of Wall Mounted Corner Drain



Other outlets available



2- Unislope Board Cut to suit wet room dimensions

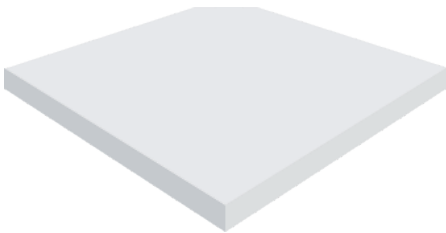

3 - Tanking kit



Liquid Membrane, Primer and Reinforcement Tape

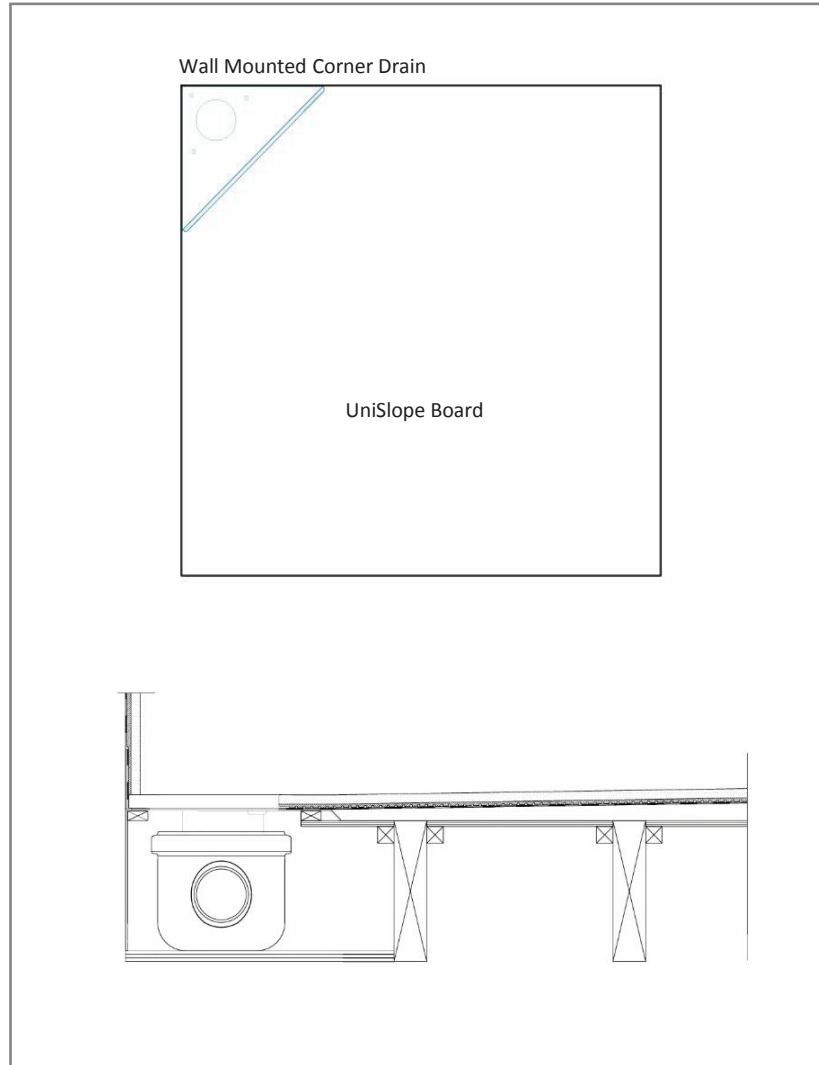

Optional Installation Products Approved and recommended for UniSlope



Drain and UniSlope Installation

Drain Assembly



Remove the trap from the top of the outlet. Attach push fit adapter into the outlet.



Grease the rubber seal of the outlet.



Place outlet onto the main drain body.



Cut three battens to size.

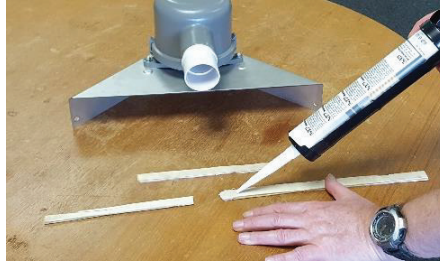

Apply glue to the battens.

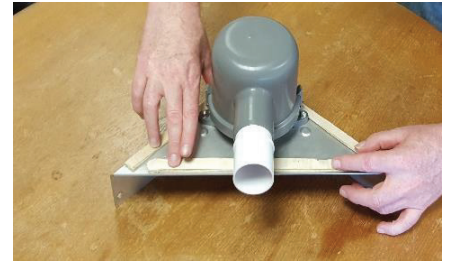

Place onto the bottom of the main drain body.

Drain Installation

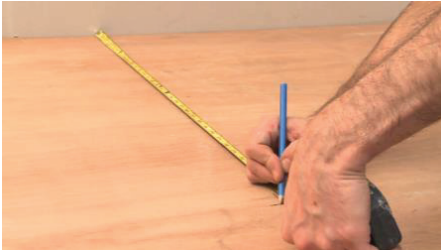

Mark and cut out the wet room area.



Install batons between the joist.



Screw drain to wall using screws supplied

Note: You may need to notch out a few millimetres from the top of the joists to accommodate the drain's internal drainage.

UniSlope Installation



Cut the ply wood and place on top of the battens between the joists.



Screw the Unislope board into position using dry wall screws.

Note: UniSlope boards can be cut down to the size required. Do not cut the board where it meets the drain.

Priming, Reinforcement and Tanking

The below images show the process on a screed floor but the process is the same for UniSlope. Any areas that are not tanked will not be waterproof. All major joints must be reinforced

Priming



Apply Primer using brush or roller. Follow dilution ratios and zones below.



Allow approximately 30 minutes for Primer to dry. Ensure it is touch dry.



Degrease the drain using a degreasing agent.

Note: Before priming ensure the room is free of debris and dust.

Tanking



Apply VS30 using a brush or roller to all major joints. Place reinforcement tape into position.



Apply another coat of VS30 over reinforcement tape.



Follow the same process for corner drain.

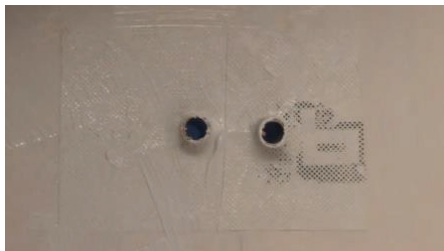

Reinforce around the first fix pipework ensuring there are no gaps.

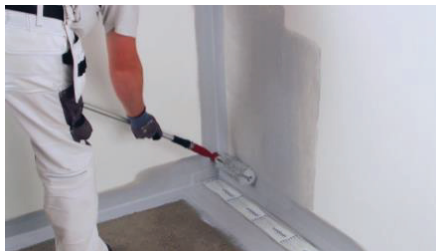

Apply first coat of LIP VS30 to all areas shown below using a roller.

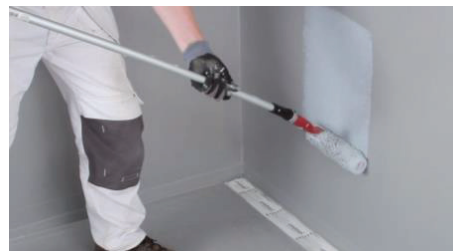

Allow to dry for 12 hours and ensure the first coat is touch dry. Once dry, apply second coat of VS30.

Note: When applying reinforcement tape to the drain, the tape must be at least 40mm on to the drain body on all sides. Ensure VS30 is dry before tiling.

Recommended Zones

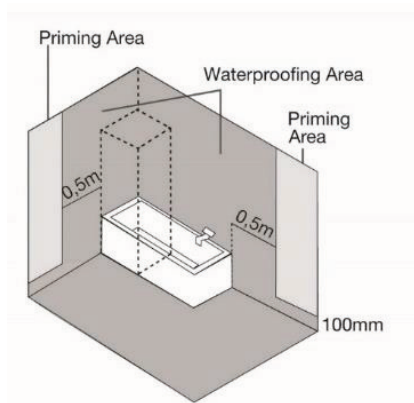

Primer Dilution Ratios

Materials	Ratio
Organic (Wood etc.)	Undiluted
Inorganic (e.g. Plasterboard, UniSlope board, Cement Board, Screed etc.)	Primer 1:10 Water

Tiling Instructions - Highline Custom

If you are installing a drain cover which has a frame, go to the next page.

Assembling the Highline Custom

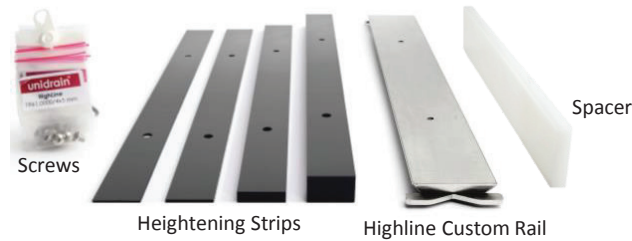
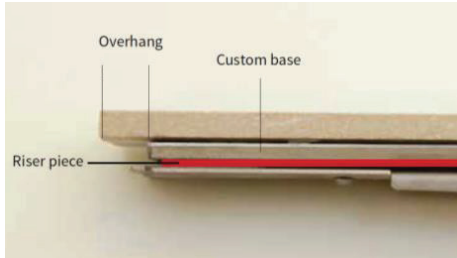

Note: The tile / stone can overhang the Highline Custom rail as shown in the above image. We do not recommend overhanging over 20mm. Some types of tile / stone can become weak and break if unsupported, we recommend speaking with the manufacturer if overhanging.

Using the 6mm Spacer



When cutting tiles, use the 6mm spacer to ensure there is a 6mm drainage gap on all sides.

Tiling for Highline Custom / No Frame.



Place the trap into the drain to help keep the drain clean.



Tile the floor using spacer to ensure you do not tile over the drainage gap.



Tile to wall from the drain up. Follow standard tiling guidelines



Degrease the Highline Custom rail.



Apply strong glue to tiles and place onto the Highline Custom Rail.



Place into position.

Tiling Instructions – With Frame

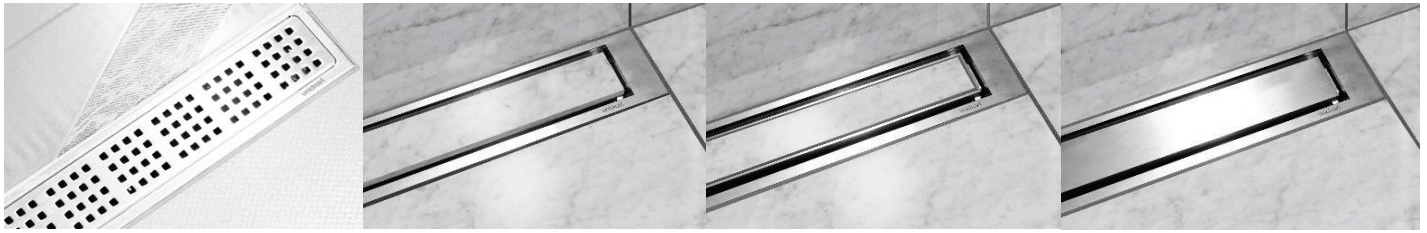

Tiling with Frame.



Place frame into position before you start tiling.



Tile to floor following standard tiling guidelines.



Ensure tiles come up to the frame but leaving a gap for grouting.



Tile the walls starting from the drain up making sure the tiles come down to the frame.



Apply grout between tiles.



Seal all major joints with an anti fungal silicone.



Installation Videos

www.wetroommaterials.com and [YouTube](https://www.youtube.com)

Technical Support

UK: +44 (0) 1332 840 820 IRL: + 353 (0) 1 2973488



EN 1253



WM | Wetroom Materials UK: 25 Town Street, Duffield, Belper, Derbyshire, DE56 4EH
WM | Wetroom Materials IRE: Unit E1 Ballymount Industrial Estate, Walkinstown, Dublin 12, D12 WR60

Cleaning and Maintenance



1. Lift the grating or tile covering the drain



2. Remove the water trap



3. Clean the water trap and place back into the drain

Cleaning Kit

Kit includes

- The hook allows you to lift the grate without causing any damage.
- The strainer helps keep the drain clear and is easy to wipe clean.
- WM Cleanser removes lime scale and grease.
- WM Polish treats chrome, stainless steel, tiles and sanitary ware to give a perfect finish.
- WM Grout Sealer should be regularly used to seal grout lines so they cannot absorb water.
- One cloth for cleaning the drain, sanitary ware and tiles.
- One cloth for streak free glass.

Do not use cleaning agents with a high concentration of fluorine, chlorine or hydrogen peroxide.

Order Ref
WMMK



NO HARMFUL CHEMICALS
100% ENVIRONMENTALLY FRIENDLY
BIODEGRADABLE



LINEAR DRAIN STRAINER

Prevents the drain from becoming clogged and makes it easier to clean as you don't have to remove the trap.

Order Ref
WM1810.0010



CORNER DRAIN STRAINER

Prevents the drain from becoming clogged and makes it easier to clean as you don't have to remove the trap.

Order Ref
WM2811.0010



HOOK

The hook is used to lift the grate out of the frame and the trap from the outlet. Can be used with all models.

Order Ref
WM1840.0000



Installation Videos

www.wetroommaterials.com and [YouTube](https://www.youtube.com)

Technical Support

UK: +44 (0) 1332 840 820 IRL: + 353 (0) 1 2973488



EN 1253

