



OPERATING INSTRUCTIONS

for the modular cap press TCC

Lite

Congratulations on the purchase of your Secabo heat press!

To ensure that you can start production smoothly with your machine, please read these operating instructions carefully.

Any form of reproduction of these operating instructions requires the written permission of Secabo GmbH. Technical data and product features are subject to change and errors excepted.

Secabo GmbH accepts no liability for direct or indirect damage resulting from the use of this product.

Version 1.0 (31.01.2023)



Precautions

Please read these notes and precautions carefully before operating the unit for the first time!

- Never reach your hands into the heat press when it is connected to the power supply, especially when it is switched on and heated up - risk of burns!
- Never open the housing and do not make any changes to the unit yourself.
- Should it be necessary to open the heating plate cover after explicit request by Secabo customer service, it is recommended to wear respiratory protection and to handle the insulation wool inside with gloves. The insulation wool should only be disposed of in a closed bag.
- Make sure that neither liquids nor metal objects get inside the heat press.
- Make sure that the socket outlet used is earthed. Note that a heat press may only be operated from a socket outlet that is protected by a residual current circuit breaker.
- Disconnect the heat press from the mains when not in use.
- Always operate the heat press out of the reach of children and never leave the machine switched on unattended.
- Make sure that the unit is only used in dry rooms.

If you are unable to meet one or more of the above safety requirements, or if you are unsure whether they all apply, please contact our technical support.

Scope of delivery

Mechanical base of the transfer press with heating element and base element

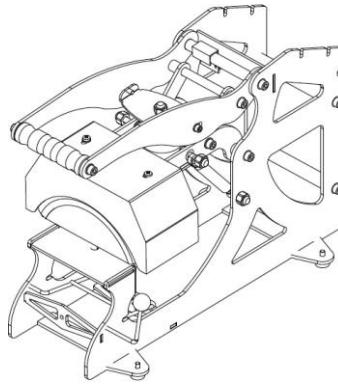

Controller Box
CL01

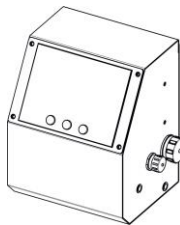

C13 cold
appliance
connection
cable

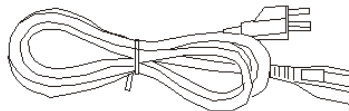

Device description



- a. Main switch (without illustration)
- b. Display
- c. Control panel with push buttons
- d. IEC socket and earth connection Controller (not shown), internal connections
- e. Clamping lever for transfer objects
- f. Exchangeable base element
- g. Cover heating element and heating element
- h. Press lever

Assembly and commissioning

- Place the base frame of the TCC Lite heat press securely on a stable table.
- Position the CL01 controller box above the rear centre of the TCC Lite transfer press base frame and slide the threaded bolts on the controller box into the slots on the base frame. Tighten the hand nuts securely.

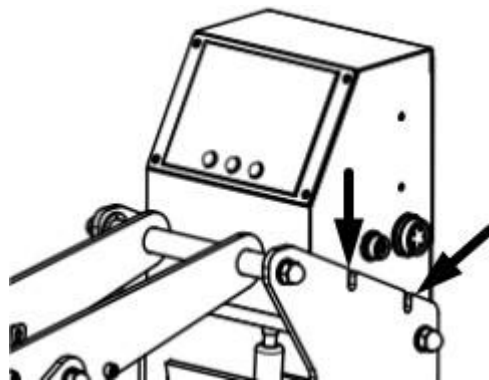

- Attach the small 6-pin connector from the back of the base rack to the matching socket on the outside right of the controller box.
- Attach the large 5-pin connector from the surface of the heater to the matching socket on the outside right of the controller box.

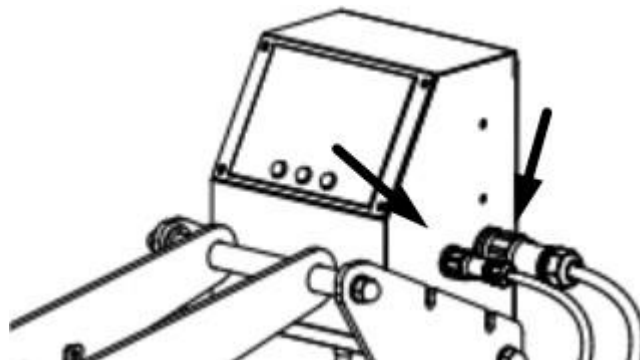

- Plug the protective earth cable from the HPC01 controller into the terminal provided at the rear of the base frame.

- Plug the supplied C13 IEC power cable into the back of the controller box and connect it to an earthed socket, which must have an earthed connection and be protected by a fuse and earth leakage circuit breaker.

The TCC Lite heat press is now ready for operation.

Controller components and operation

Digital controller

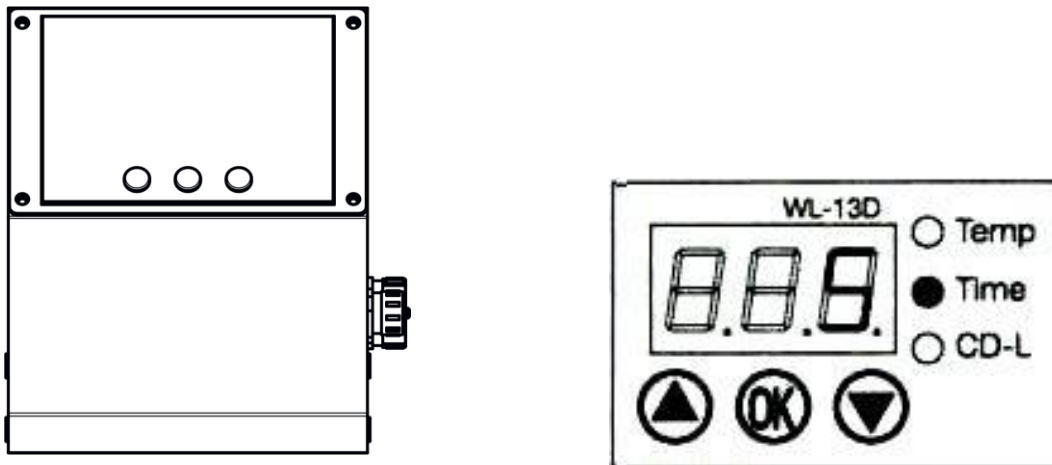

Operation

- Connect the TCC Lite Transfer Press to the mains using the power cable supplied.
- Switch on the TCC Lite heat press.
- "OFF" appears in the display.
- After switching on, "-f-" (Fahrenheit) or "-c-" (Celsius) appears.
- Use the arrow keys to select the desired temperature unit.
- Press the "OK" button. Now the "Temp" LED lights up.
- Use the arrow keys to select the desired temperature.
- Press the "OK" button. Now the "Time" LED lights up.
- Use the arrow keys to select the desired duration of the pressing process.
- Press the "OK" button. The display will initially show LO, and only as soon as the temperature has exceeded 100°C will the current temperature of the TCC Lite heat press be displayed. The press will now heat up to the set temperature.
- An acoustic signal sounds when the heat press is heated up.



- Now the transfer press can be closed via the press lever to carry out transfers.
- When the press is closed, the timer starts to count down, and about half a second later the magnet is activated, which is indicated by a flashing light at CDL in the display. Only then is the press locked.
- After the timer has expired, there is also an acoustic signal, after which the press opens automatically.

Carry out transfers

- Switch on the heat press via the main switch.
- Store the desired parameters for temperature and time and confirm each of them as described above. For information on how to change the settings on the controller, see the preceding paragraphs.
- You can regulate the contact pressure by increasing or decreasing the lever travel by turning the small hand screw on the underside of the press. Turning clockwise increases the contact pressure and turning anticlockwise decreases it.
- Tension the transfer object with the tension lever to the left of the base element as tightly and flat down as possible to avoid creases in the transfer.
- No setting can be changed during the pressing process.

Notes

- **Note that the heating plate and the transfer objects are hot and there is a risk of burns.**
- **Switch off the machine when it is not needed.**
- **Please note that it takes a certain amount of time for the press to cool down again after it has been switched off. There is a risk of burns until it has cooled down completely!**

Maintenance and cleaning

All maintenance work must be carried out when the press is switched off and has cooled down. The plug must be removed from the socket beforehand. Only carry out maintenance work after consulting our technical support.

The press should be cleaned regularly with a soft cloth and a mild household cleaner to remove adhesive residues, dust, etc. Do not use scouring pads, solvents or petrol!

Recommended times and temperatures

These values are only approximate, may vary from material to material and must be checked before pressing.

Material	Temperature	Print	Pressing time
Flock foil	170°C - 185°C 338°F - 365°F	light-medium	25s
Flex foil	160°C - 170°C 320°F - 338°F	medium-high	25s
Sublimation flex	180°C - 195°C 356°F - 383°F	medium-high	10s - 35s
Sublimation on cups	200°C 392°F	medium-high	150s - 180s
Sublimation on Tiles	200°C 392°F	high	120s - 480s (depending on the thickness of the material)
Sublimation on Piuzzles	200°C 392°F	light-medium	25s
Sublimation on mouse pads	200°C 392°F	medium	20s - 40s
Sublimation on textiles	200°C 392°F	medium-high	30s - 50s
Sublimation on Metal plates	200°C 392°F	high	10s - 50s (depending on the thickness of the material)

Important note: Before each production, own tests should be made with the respective transfer materials and carrier media. The above values and the manufacturer's specifications are only indicative. Washing resistance and behaviour during transfer must be determined in separate tests.



No guarantee can be derived from the recommended values. It is always up to the user to determine and apply the settings applicable under his or her specific conditions.

Note for textile finishes: After the pressing process, the textiles must cool down before any backing media can be removed from the transfer material. The hotmelt adhesive in the transfer material has only developed its adhesive strength when cold. If the adhesive does not adhere when cold, the pressing process may have been too cold or too short.



Technical data

Transfer press	Secabo TCC Lite
Type	automatic opening cap press
Size work surface	15cm x 8cm
Max. Opening angle	35°
Max. Temperature	225°C
Max. Time preselection	999s
Max. Working pressure	250g/cm ² / 3.56 psi
Pressure setting	Height adjustment of the base element by means of a hand wheel
Power supply	230V / 50Hz - 60Hz, 1.0kW
Surroundings	+ 5°C - +35°C / 30% - 70% humidity 41°F - 95°F - 70% humidity
Weight without packaging	15kg
Weight with packaging	22kg
Dimensions closed	24 cm x 59 cm x 53 cm
Dimensions open (W x H x D)	24 cm x 71 cm x 53 cm

Declaration of Conformity - Statement of Conformity

We hereby declare on our sole responsibility that the product described under "Technical data" complies with the provisions of the following EC directives and standards:



We herewith declare under sole responsibility that the under "technical data" mentioned product meet the provisions of the following EC Directives and Harmonized Standards:

EG-Richtlinien / EC directives:

2014/35/EC Low Voltage Directive / 2014/35/EC

Low Voltage Directive

98/37/EG Maschinenrichtlinie (2006/42/EG vom 12/29/2009) /

98/37/EC Directive on machinery (from 2009-12-29: 2006/42/EC)

Norm / Standard: EN 60204-1:2006

Technische Dokumente bei / Technical documents at:

Secabo GmbH, Hochstatt 6-8, 85283 Wolnzach, Germany

Dipl. Ing. Fabian Franke

Dipl. Ing.(FH) Bernhard Schmidt