



# Light Switch - 3 Way Single Setup Instructions

votion

## Step 1

Install **Votion Home App** in the Apple App Store or Google Play Store by scanning the **QR Code**.



## Step 2

Prepare the following tools for the wiring process.

**IMPORTANT NOTE: If you are unfamiliar with basic electrical wiring, please consult an electrician.**



Voltage  
Detector



Phillips  
Screwdriver



Slotted  
Screwdriver



Plier &  
Wire Stripper

## Step 3

Find the **circuit breaker** and **turn off** your desire light.  
(Make sure power is off by turning your light switch on and off a few times.)

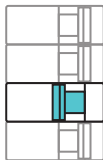

## Step 4

**Remove** the **screws** that secure your old **wallplate** and set it aside.

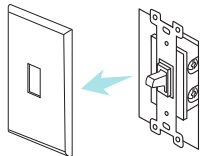

## Step 5

Remove the screws securing your old switch to the wall box. Gently pull the switch out but **do not disconnect the wires**.

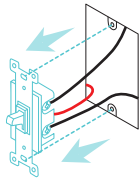

## Step 6

Use the **voltage detector** to make sure there is **no power going to the wires**.

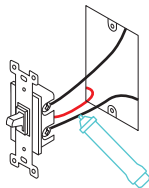

## Step 7

In the wall box, look for the **Neutral wires** which are a bundle of white wires secured with a wire nut. They may be folded up in the very back. **Add the Neutral label** to the wire.

**(Neutral wire is needed for Smart Switch, if there is no such wire, you may need to find a different location in your home.)**

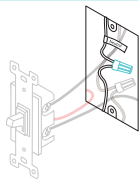

## Step 8

In the wall box, look for the **Ground wires** which is normally green or copper. They may or may not be attached to your current switch. **Add the Ground label** to the wire.

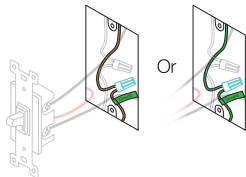

## Step 9

Identify the **Line wire** (black or red) and **Traveller wires** (black or red). Label the wires **Line**, **Traveler 1**, and **Traveler 2** label. If you do know which one is the Line wire, you can temporarily turn on the circuit breaker and use the voltage detector to detect which wire is the Line wire. (The one with the live current is the Line wire)

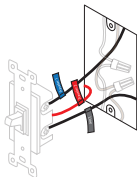

## Step 10

**IMPORTANT NOTE:** Be sure to turn the circuit breaker of the switch off. Once all wires have been identified, **disconnect all** of the **wires** from the old switch.

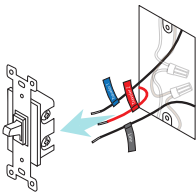

## Step 11

**Match** the **wires** to the connections of the Smart Switch and **connect** them using the **wire nut**.

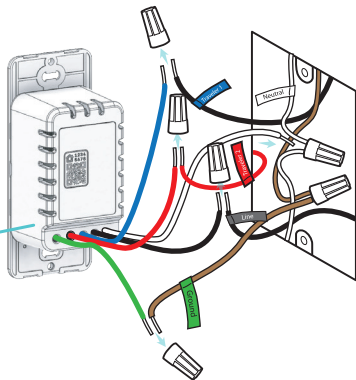
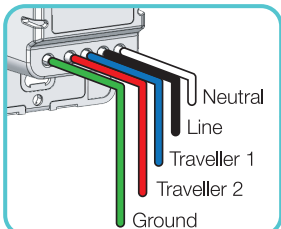

## Step 12

Check that **all wires** are **correct and secure**. Give it a light tug holding the wire nut to ensure everything is tightened.

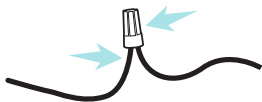

## Step 13

**Fold all the wires** back into the **wall box** and line up the switch with the mounting holes. Secure it with **screws**.

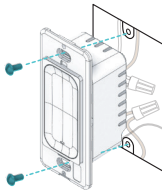

## Step 14

**Turn on** the light switch in the **circuit breaker**. Make sure the light is **turned on**. Using Votion Home app, open add device and **enter the code** from the **front of the switch**.

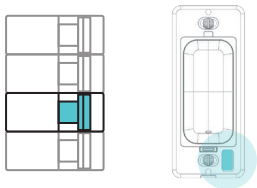

## Step 15

**Attach the wallplate** to the Smart Switch.

