

Light Switch Factory Reset

Step 1

Remove the **wallplate** of the Smart Switch.

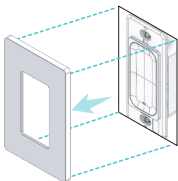

Step 2

Factory reset button is located just **below** **main switch**.

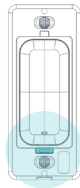

Step 3

While plugged into the socket, **hold** **down the button for 5 seconds**.

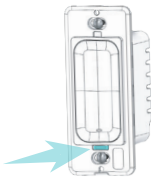

Step 4

Once the **LED light start flashing**, your factory reset will be completed.

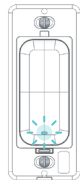

HomeKit



Support

For any support regarding our product, please visit votion.io or email us at support@votion.io.

Specification

Input: 120V~, 15A, 60Hz
Max Output: 120V,
15A Resistive Load,
600W Incandescent

