

# BELLATERRA HOME

Model: 400100-55

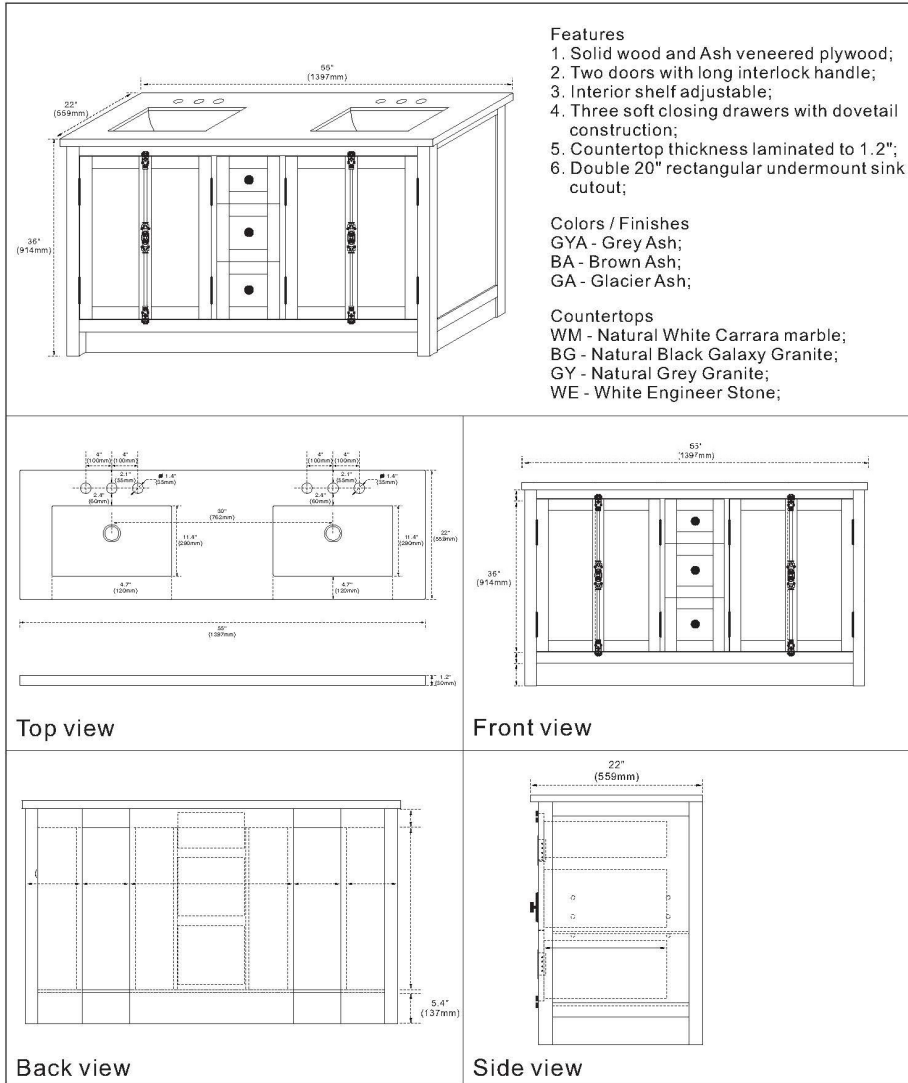

**Features**

1. Solid wood and Ash veneered plywood;
2. Two doors with long interlock handle;
3. Interior shelf adjustable;
4. Three soft closing drawers with dovetail construction;
5. Countertop thickness laminated to 1.2";
6. Double 20" rectangular undermount sink cutout;

**Colors / Finishes**

- GYA - Grey Ash;
- BA - Brown Ash;
- GA - Glacier Ash;

**Countertops**

- WM - Natural White Carrara marble;
- BG - Natural Black Galaxy Granite;
- GY - Natural Grey Granite;
- WE - White Engineer Stone;

Top view

Front view

Back view

Side view

**NOTE: SINK STYLE, SHAPE, FAUCET HOLES, CUTOUT ON TOP, VANITY MAY VARY FROM THE PICTURE ABOVE. INSTRUCTIONAL PURPOSE ONLY.**

Professional installation is recommended.  
[www.bellaterra-home.com](http://www.bellaterra-home.com)

Bellaterra Home LLC, All Rights Reserved 2018