



TRI-07 LFC Sports Chronograph Champions Edition

USER MANUAL



TRI-07 LFC Sports Chronograph Champions Edition

Your quartz chronograph is officially licensed by Liverpool FC and has been engineered to celebrate this legendary club. The Swiss-made movement inside provides stopwatch functionality, but it's the club crest on the dial that reminds you following Liverpool is a way of life.

Display elements

Second counter

Hour hand

Minute Counter

Minute hand

Second hand

Control buttons

Push button A

Crown

Push button B

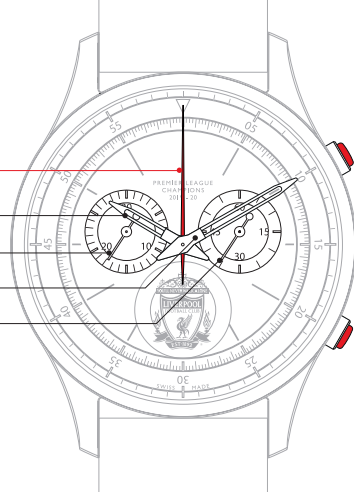

Setting the time

- 1** Pull out the crown to position **III** (the watch stops).
- 2** Turn the crown until you reach the correct time **8:45**.
- 3** Push the crown back into position **I**.

Please note:

* In order to set the time to the exact second, **1** must be pulled out when the second hand is in position «60». Once the hour and minute hands have been set, **3** must be pushed back into position **I** at the exact second.

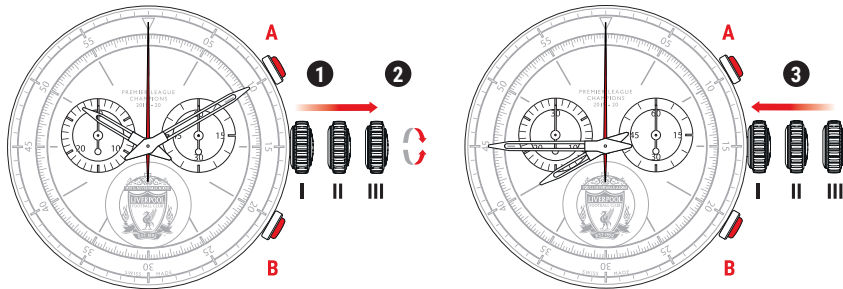

Chronograph: Basic function

(Start / Stop / Reset)

Example

- 1 Start:** Press push-button **A**.
- 2 Stop:** to stop the timing, press push-button A once more and read the chronograph hands:
1h / 20min / 38 sec.
- 3 Zero positioning:**  Press push-button **B**. (The chronograph hands will be reset to their zero positions.)

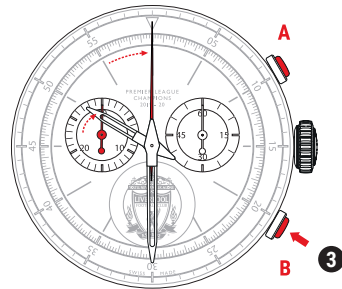
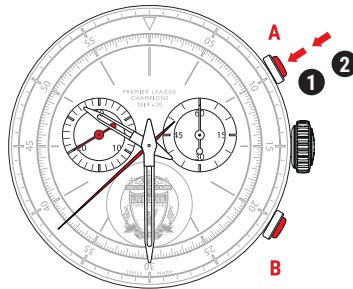

Chronograph: Accumulated timing

Example

- 1 Start:** (start timing)
- 2 Stop:** Stop: (e.g. 15 min 5 sec following **1**)
- 3 Restart:** (timing is resumed) **B**.
- 4 Stop:** (e.g. 5min 12 sec following **3**)
= **20 min 17 sec**
- 5 Reset:** 
The chronograph hands are returned to their zero positions.

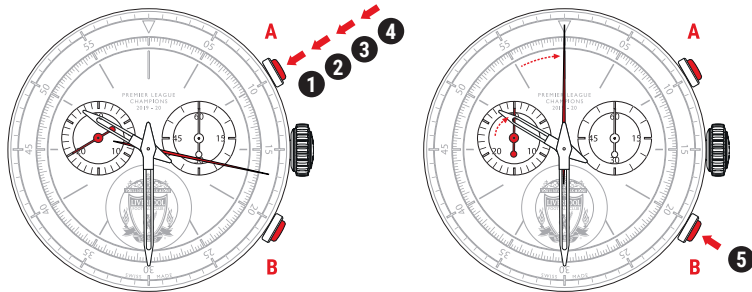

Chronograph: Intermediate or interval timing

Example

- **1 Start:** (start timing)
- 2 Display interval:** e.g. **20 minutes 17 seconds**
(timing continues in the background)
- 3 Making up the measured time:** (The chronograph hands are quickly advanced to the ongoing measured time.)
- 4 Stop:** (Final time is displayed)
- 5 Reset:** 
The chronograph hands are returned to their zero position.

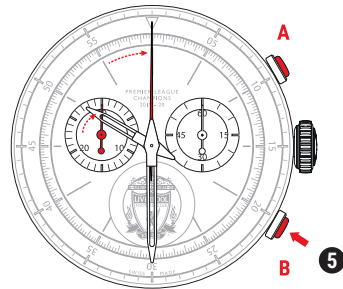
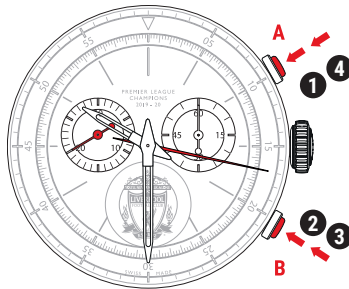

Adjusting the chronograph hands to zero position

Example

One or several chronograph hands are not in their correct zero positions and have to be adjusted (e.g. following a battery change).

- 1** Pull out the crown to position III (all chronograph hands are in their correct or incorrect zero position).
- 2 Stop:** Keep push-buttons A and B depressed simultaneously for at least 2 seconds (the second counter hand rotates by 360° → corrective mode is activated).

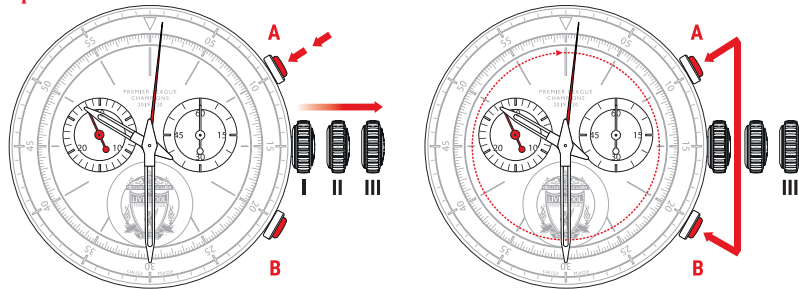



Adjusting the second counter hand

Single step



A

1 x short

Continuous



A

1 x short



Adjusting the next hand B



Adjusting the minute counter hand (position 9h)

Single step



A

1 x short

Continuous



A

long

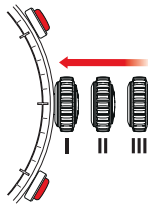

3

Returning the crown to position I

Termination of the chronograph hands adjustment
(can be carried out at any time).

A black and white photograph of Bill Shankly, a man with grey hair wearing a suit and tie, standing with his arms raised in a gesture of triumph or celebration. He is positioned in the center of the frame. Behind him is a massive, dense crowd of people, many of whom are looking towards him. In the background, a large, ornate building with many arched windows is visible. To the left, a flag with the name 'TOM SMITH' is partially visible. In the lower right foreground, several police officers in traditional British uniforms, including hats and sunglasses, are standing and observing the scene. The overall atmosphere is one of a significant public event or victory celebration.

**“ IF YOU ARE FIRST, YOU ARE FIRST.
IF YOU ARE SECOND... YOU ARE NOTHING ”**

BILL SHANKLY

Adjusting your strap

Replacing your strap

With in-built quick-release pins, your leather strap can be swapped over with a finger in seconds.

- A** To remove the strap, locate the quick-release pin and pull inwards to detach
- B** To reattach your strap, pull the pin inwards and align the spring bars so that they click securely into the lug holes on each side.

To replace your metal bracelet, you'll need a springbar tool to swap it on or off. If the thought of trying this gives you the fear, we recommend getting a local jeweller to do this to avoid any scratches.

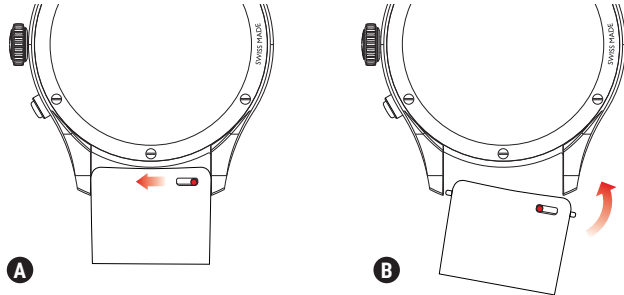

Care Guide

- Here are a few tips to help keep your watch working perfectly...
- Always ensure the crown is fully tightened before use in water.
 - Always adhere to the water resistance rating of your watch.
 - Thoroughly rinse your watch in fresh water after immersion in salt water.
 - Your watch is shock resistant to minor impacts but dropping from height onto a hard surface may damage the movement.

Water Resistance

Your watch is water proof to a depth of 150 metres. The water resistance rating of your watch (as shown) should only ever be considered a guideline and we strongly recommend that it is always adhered to.

Activity	15 ATM (150 metres)
Rain	✓
Shower, bath, surface water sports	✓
Swimming, snorkeling	✓
Scuba diving	✗

Your battery

Your chronograph watch functions by means of a battery lasting approximately two years. As the battery is fitted into the watch in our workshops, you may find its life reduced – please note any battery changes are not included with our guarantee.

Its life is also influenced by the frequency with which you use the chronograph functions. When you are not wearing your watch, battery life may be prolonged by unscrewing the crown and pulling it out to position III. Do not forget to push the crown back and to screw it in to position 0 before wearing your watch again.

We always recommend your battery is replaced by a qualified watchmaker. They can replace the seal and guarantee its continued water resistance.

Guarantee

Any well-made watch is designed to withstand a lifetime of active wear, and ours are no different. To ensure your TRIBUS watch continues to perform at its best, we recommend having it serviced every 3 years (think of it like taking your car to the garage to ensure it's kept in the best possible condition). If you have your watch serviced by us within 3 years of its initial purchase, its movement will be covered under warranty for another 3 years. To arrange a service, please speak to one of our Customer Services team, who will arrange a collection – they'll need an address, a date for collection and a contact number. You'll then be provided with instructions and a returns label to attach to your watch's packaging.

Your TRIBUS watch is guaranteed against all manufacturing defects for 3 years from the date of purchase. This means that in the unlikely event you encounter any problems, we'll repair or replace the movement or part in question as necessary. If the repair work/replacement does not fall under the terms of our guarantee (for example, our Swiss technicians diagnose the issue to be the result of user fault), a cost may be incurred. If you've purchased your TRIBUS watch directly from us, we'll have your details on record for if you need to speak to us about your guarantee. If you have purchased your TRIBUS from somebody else or have received it as a gift, to ensure the guarantee is transferred over to your name, please register your details with us at tribus-watches.com/warranty.

